

# ASSEMBLING & INSTALLATION INSTRUCTIONS PRODUCT# 6440

## For Wall Mount Light Fixture

**WARNING! SHUT POWER OFF AT FUSE OR CIRCUIT BREAKER .**

### MOUNTING THE FIXTURE

Installation (see fig.1)

1. Disconnect power at main electrical panel before installation.
2. Thread the two mounting screws about 1/4" into the pre-drilled holes in the mounting plate, spaced about the same distance apart as the holes in the fixture back plate. Attach the mounting plate to the junction box using two junction box screws. The side of the mounting plate marked "GND" must face out.
3. Guide fixture wires through hole in center of mounting plate.
4. Place the fixture body (D) over the mounting plate, aligning the holes with mounting screws, then screw the ball nuts(F) onto the mounting screws.
5. Attach the harp(C) to the cover of lamp holder, Place the center ring of the shade (B) over the threaded end of the harp (C) and lock it securely with loop(A) until snug. Attach the lobation crystal(E) to the end small ring of the arms.
6. Mount the short back plate(G) to the wall with the plastic anchors and the wood screw, feed the fixture wires into the short back plate, then attach the long back plate(H) to the short back plate.
7. **If you not need assembly the fixure lamp , please pause and Take out fixture wires nuts of the back plate , then follow wiring instructions carefully. (see fig.2 and fig.1.1)**
8. Install the light bulbs in accordance with the fixture's specifications. **DO NOT EXCEED THE MAXIMUM WATTAGE RATING!**

Wiring (see fig.2)

1. Connect the electrical wires as follows. Connect the Black wire from the fixture to the black house (hot) Wire. Connect the white wire from the fixture to the white (neutral) house wire. Make sure all wire nuts are secured. You may wrap the connections with electrical tape. If your outlet box has a ground wire (green or bare copper) connect fixture's ground wire to it. Otherwise attach the bare copper fixture wire to the green ground screw on the circular strap.
2. Tuck the wire connections neatly into the wall junction box.

Fig.1

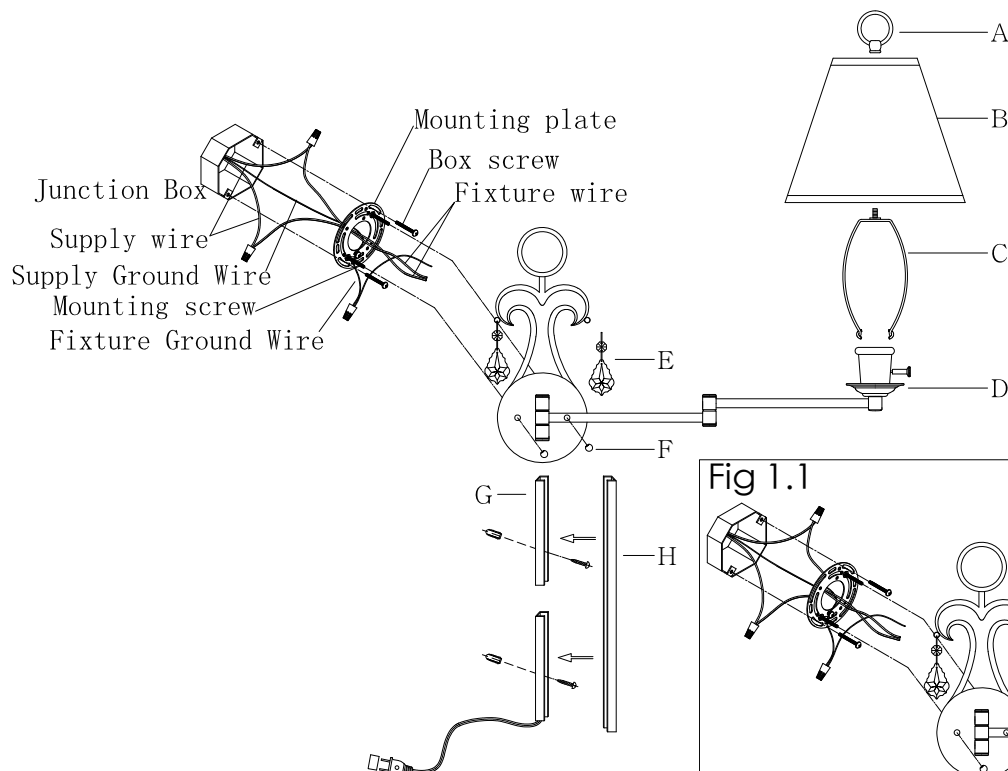

Fig 1.1

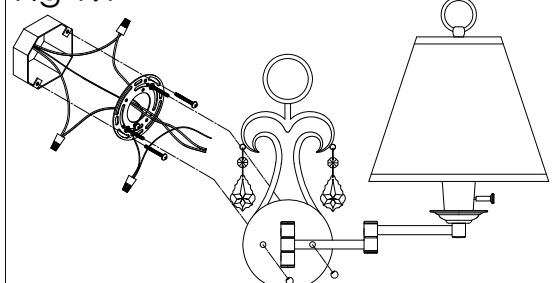

Fig.2

<b>FIXTURE WIRES</b> Black or Smooth		<b>FIXTURE WIRES</b> White or Ribbed		<b>FIXTURE WIRES</b> Bare Copper (Ground)	
<b>HOUSE WIRES</b> Black (Hot)		<b>HOUSE WIRES</b> White (Neutral)		<b>HOUSE WIRES</b> Green or Bare Copper (Ground)	

