

Assembly Instructions For

F2541/6+2 (E) 11/09

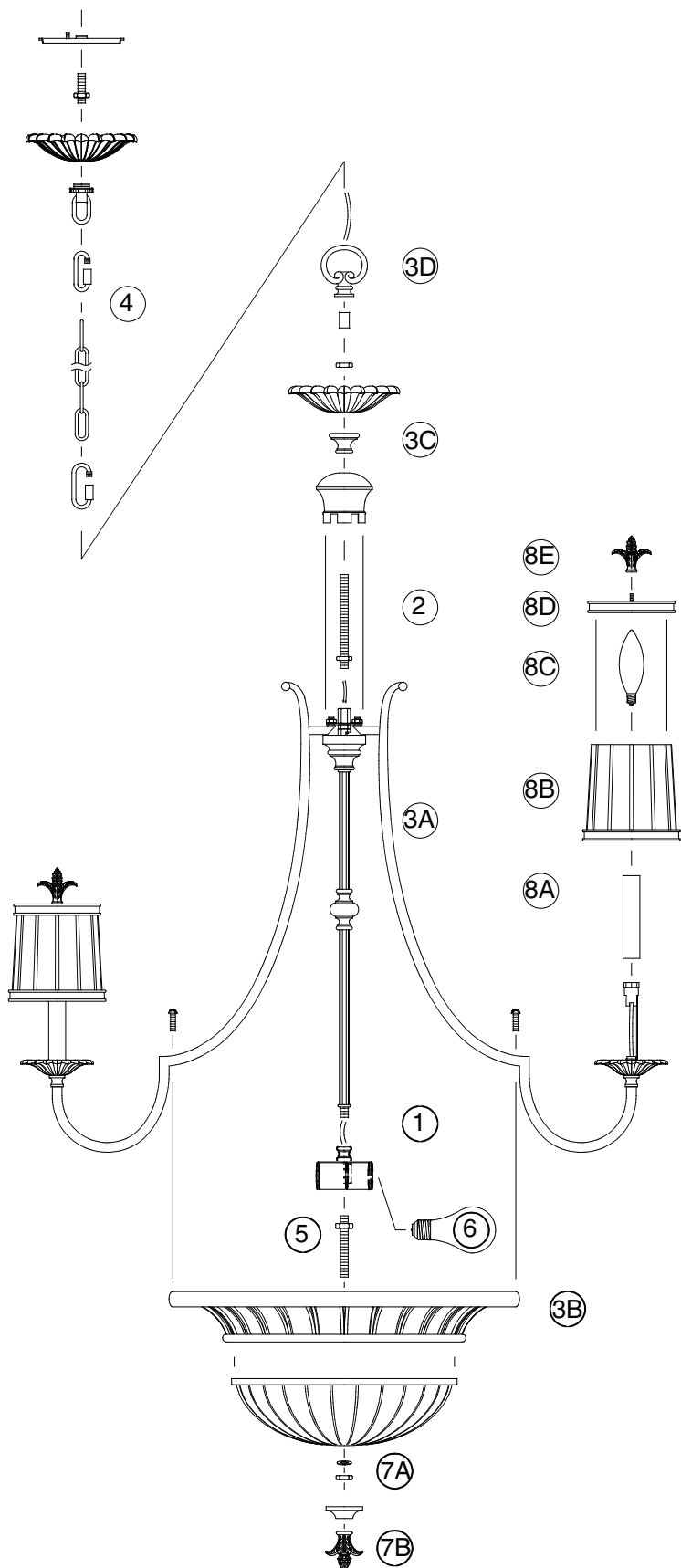

IMPORTANT TURN OFF THE POWER AT THE MAIN FUSE OR CIRCUIT BREAKER BOX BEFORE STARTING INSTALLATION

Carefully unpack and identify all parts before assembly. Bulbs not included.

1. While pulling fixture wires from above the fixture, install socket assembly by screwing onto bottom of fixture.
2. Fasten one hex nut about 3/8" (10 mm) down from one end of long threaded pipe. Slip long threaded pipe through fixture wires, then screw same end of threaded pipe into top of fixture. Tighten hex nut.
3. A. Spread open arms so they are equally spaced apart to each other.
B. Install crown onto bottom of arms by fastening with screws from above.
C. Thread fixture wires through upper notched cap, break, font, and a hex nut. Then slide down the notched cap until the arms are locked into it's notches. Then slide font and secure by fastening with hex nut.
D. Slip spacer tube and fixture loop, and secure by screwing the loop onto protruding threaded pipe.
4. Follow enclosed supplement installation instructions for electrical and fixture installation onto house outlet box. If you do not have an outlet box at desired location to attach the fixture then hire a qualified electrician to create one.
5. Install short threaded pipe into bottom of socket assembly. Note correct position of threaded pipe at illustration.
6. Install two 100 Watt maximum of medium base bulbs (not included) into sockets at center of fixture.
7. A. Slip center shade through short threaded pipe until it securely checks into bottom of crown. Then secure into position by fastening with a flat washer and hex nut. Important: Do not over tighten.
B. Slip cover and secure with finial.
8. A. Slip candle tube onto sockets.
B. Place side glass shade over candle tube.
C. Install type-B, candelabra base, of 60 Watt maximum bulbs (not included).
D. Install upper trim ring onto glass shade.
E. Install finial by screwing on top of upper trim ring.

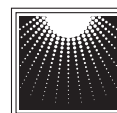

**MURRAY
FEISS**

GENERATION
BRANDS™