

# Assembly Instructions For

# FL6290 (E) 9/11

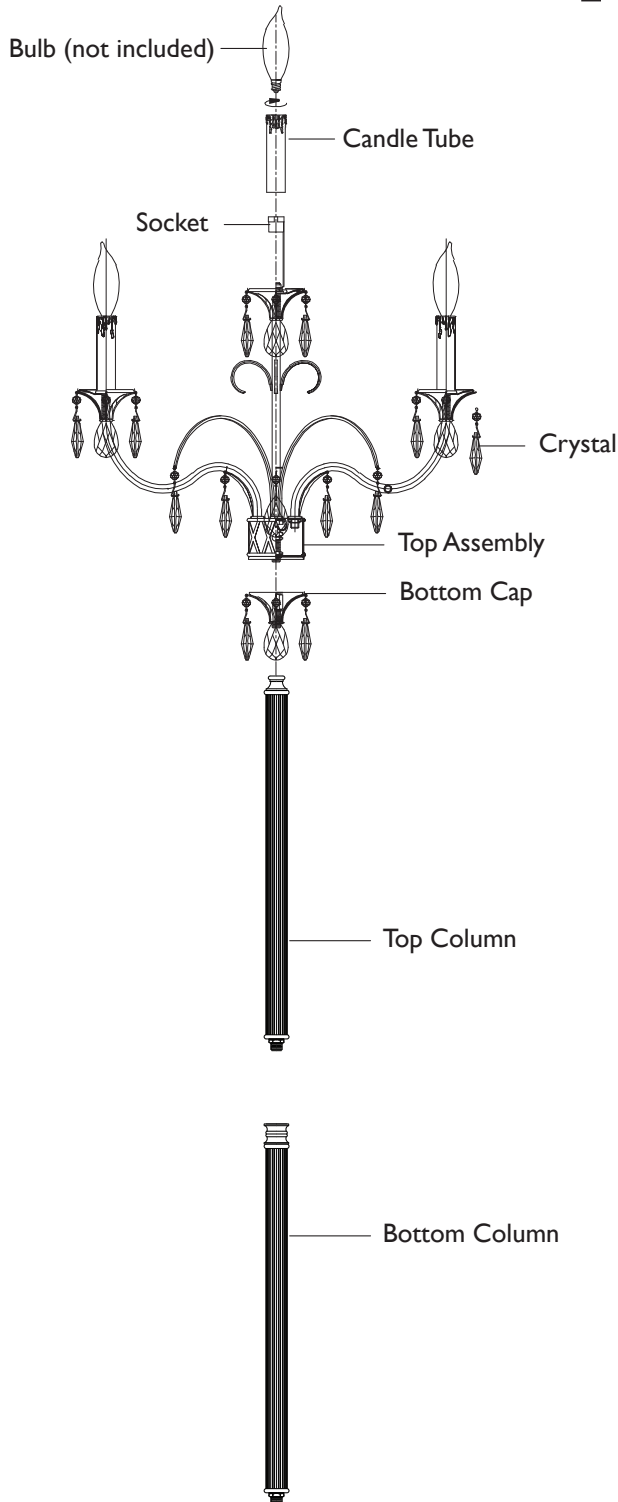

## READ ALL INSTRUCTIONS BEFORE ASSEMBLING LAMP

Carefully unpack lamp parts onto carpeted surface or blanket and identify all parts.

1. Thread the bottom column onto the base and turn to tighten.
2. Thread the top column onto the bottom column and turn to tighten.
3. Install the bottom cap onto the top assembly.
4. Thread the top assembly onto the top column and turn to tighten. Then pull the excess cord through cord hole and set lamp upright on base.
5. Install the candle tubes onto the sockets.
6. Install bulb (not included). See relamping label located at socket area for type and maximum allowed wattage.
7. Hang all crystal glass parts as shown on drawing by gently bending the open pin, hook, then close back the pin. Avoid bending the pin into a sharp angle.

## IMPORTANT SAFETY INSTRUCTIONS:

This portable lamp has a polarized plug (one blade is wider than the other) as a safety feature to reduce the risk of electric shock. This plug will fit in a polarized outlet only one way. If the plug does not fit fully in the outlet, reverse the plug. If it still does not fit contact a qualified electrician. Never use with an extension cord unless plug can be fully inserted. Do not attempt to defeat this safety feature.

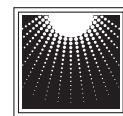

**MURRAY  
FEISS**

GENERATION  
BRANDS™