

Assembly Instructions For

OL6802

(E) 11/24/08

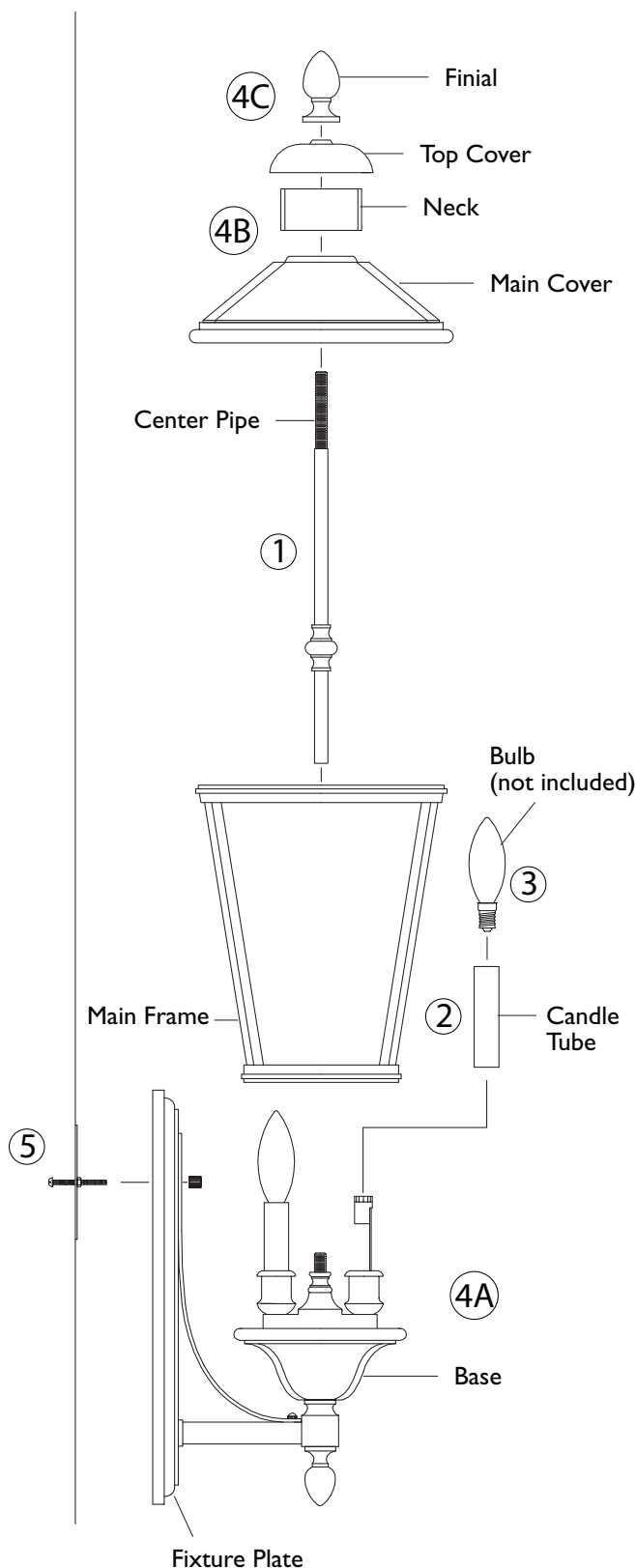

IMPORTANT TURN OFF THE POWER AT THE MAIN FUSE OR CIRCUIT BREAKER BOX BEFORE STARTING INSTALLATION

Carefully unpack and identify all parts before assembly.
Bulb not included.

1. Screw center pipe onto center body. Note correct position of center pipe as shown in illustration.
2. Slip candle tube onto sockets.
3. Install light bulb (not included). See relamping label at socket area for type and maximum allowed wattage.
4. A. Sit main frame securely inside of base.
B. Slip main cover, neck, and top cover through the installed center pipe.
C. Secure all together by fastening finial.
5. Follow enclosed supplement installation instructions for electrical and fixture installation onto house outlet box. If you do not have an outlet box at desired location to attach the fixture than hire a qualified electrician to create one.

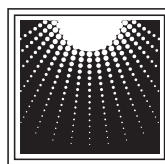

**MURRAY
FEISS**

Generation Brands™