

Assembly Instructions For

WB1553 (E) 9/10

Shade
Ring

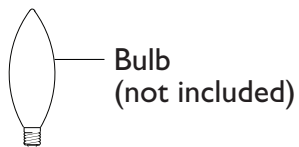

Counter Ring

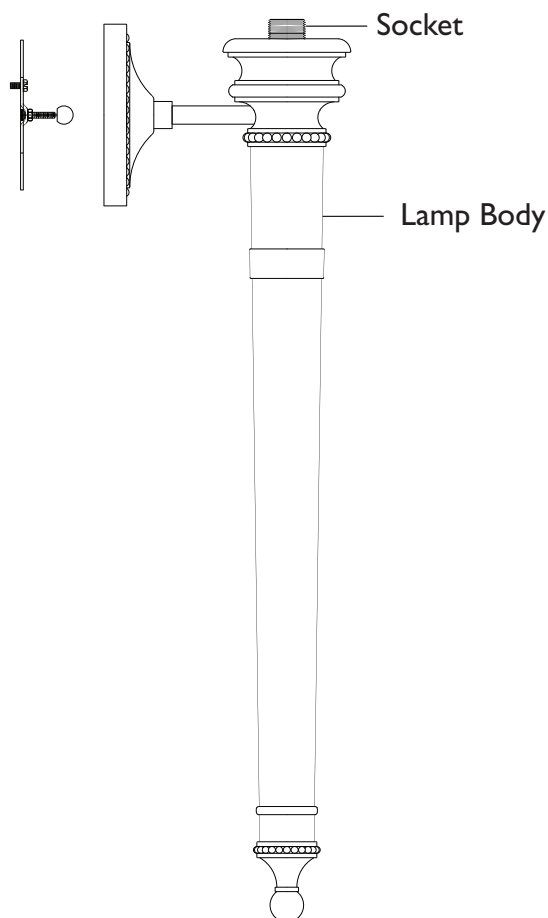
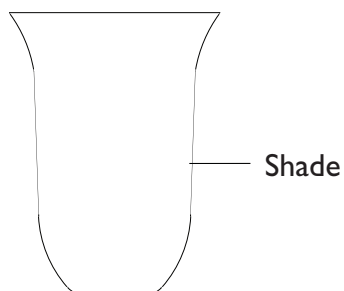

READ ALL INSTRUCTIONS BEFORE ASSEMBLING LAMP

Carefully unpack lamp parts onto carpeted surface or blanket and identify all parts.

1. Follow enclosed supplement installation instructions for electrical and fixture installation onto house outlet box. If you do not have an outlet box at desired location to attach the fixture than hire a qualified electrician to create one.
2. Place shade onto fitter. Secure by placing counter ring onto threaded socket.
3. Install shade ring onto top of glass shade.
4. Install bulb (not included). See relamping label located at socket area for type and maximum allowed wattage.

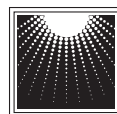

**MURRAY
FEISS**

GENERATION
BRANDS™