

ASSEMBLY INSTRUCTION

SKU#60/883/884

NOTE: Please consult a qualified electrician if you are not certain of the installation.

CAUTION: Before starting the installation, disconnect the power by turning off the circuit breaker or by removing the fuse at the fuse box.

1. Connect wires white to white and black to black, and then tie ground wires from the fixture and from the Post Cap together. Cover the connection using the Wire Connectors provided.
2. Fasten the Post to Post Cap by using the Lock Screws provided.
3. Screw the Nipple into the Bushing.
4. Install the bulbs. (Not included).
5. Place the Glass Shade, the Decorative Part B, the Bottom Cover, the Top Cover, the Decorative Part A, the Small Cover and the Small Cap over the Nipple and tighten them by screwing the Finial.
6. Turn on the power.

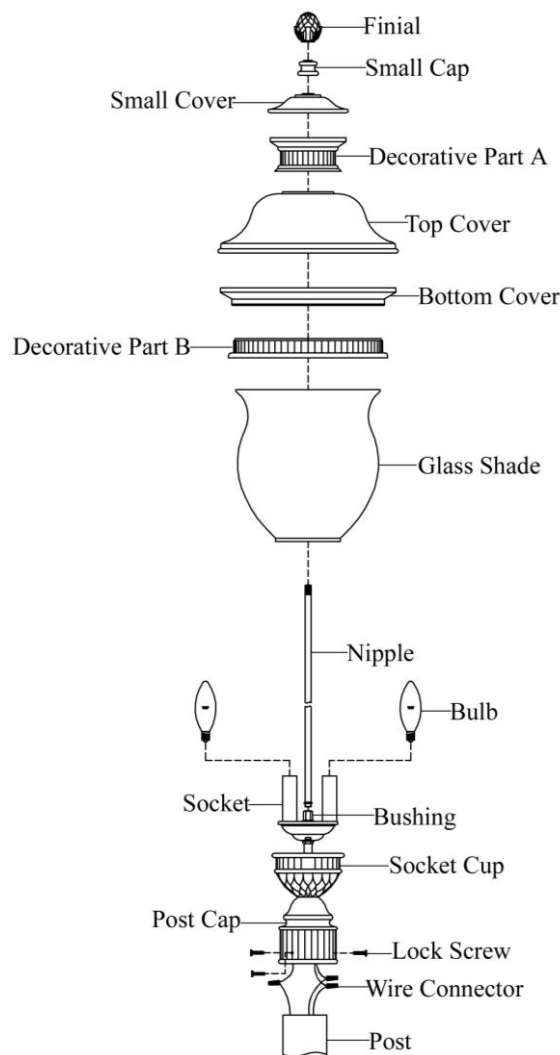

NUVO[®]
LIGHTING

A Satco Product

INSTRUCCIÓN DE ASAMBLEA

SKU#60/883/884

NOTE : Por favor, consulte con un electricista calificado en caso de que no esté seguro de la instalación.

CAUCIÓN : Antes de comenzar la instalación, cortar la electricidad mediante apagar el cortacircuitos o quitar el fusible desde la caja de fusible.

1. Conectar los cables blanco con blanco y negro con negro, y después atar juntos los cables de tierra desde la instalación y desde el Casquillo del Poste. Cubrir la conexión usando los Conectores de Cable que se proporcionan.
2. Colocar el Poste sobre el Casquillo del Poste, y abrocharlos usando los Tornillos de Cierre que se proporcionan.
3. Atornillar la Entrerrosca en el Buje.
4. Instalar la bombilla (No incluídas).
5. Colocar la Pantalla de Cristal, la Pieza Decorativa B, la Cubierta Inferior, la Cubierta Superior, la Pieza Decorativa A, la Cubierta Pequeña y el Casquillo Pequeño sobre la Entrerrosca y apretarlos atornillando el Embellecedor.
6. Apagar la alimentación.

INSTRUCTIONS DE MONTAGE

ASSEMBLY INSTRUCTION

SKU#60/883/884

NOTE: Please consult a qualified electrician if you are not certain of the installation.

CAUTION: Before starting the installation, disconnect the power by turning off the circuit breaker or by removing the fuse at the fuse box.

1. Connect wires white to white and black to black, and then tie ground wires from the fixture and from the Post Cap together. Cover the connection using the Wire Connectors provided.
2. Fasten the Post to Post Cap by using the Lock Screws provided.
3. Screw the Nipple into the Bushing.
4. Install the bulbs. (Not included).
5. Place the Glass Shade, the Decorative Part B, the Bottom Cover, the Top Cover, the Decorative Part A, the Small Cover and the Small Cap over the Nipple and tighten them by screwing the Finial.
6. Turn on the power.

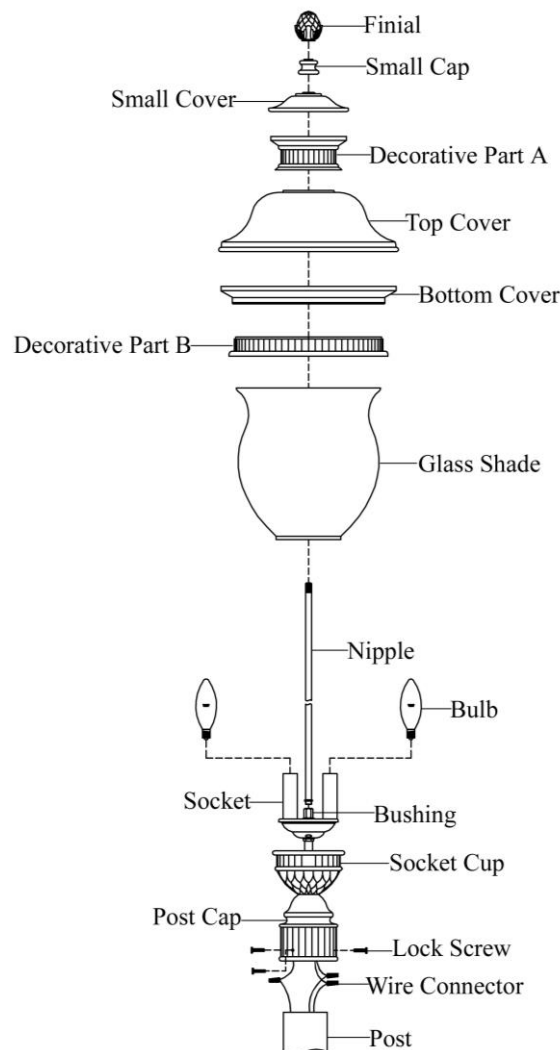

NUVO®
LIGHTING

A Satco Product

ASSEMBLY INSTRUCTION

SKU#60/875/876

NOTE: Please consult a qualified electrician if you are not certain of the installation.

CAUTION: Before starting the installation, disconnect the power by turning off the circuit breaker or by removing the fuse at the fuse box.

Fasten the Mounting Ring onto Outlet Box by using 2 Outlet Box Screws. (Make sure the thread of the Mounting Screws is facing outside when the Mounting Ring is attached to the Outlet Box).

Connect the wires white to white and black to black. Cover the connections using Wire Connectors provided. Tie ground wires from Outlet Box and from fixture to the Ground Screw on the Mounting Ring.

Place fixture body to the wall by aligning the protruding Mounting Screw all the way through the Wall Plate and tighten the fixture using 2 Lock Nuts provided until it is held firmly to the wall.

Screw the Nipple into the Bushing.

Install the bulbs. (Not included).

Place the Glass Shade, the Decorative Part B, the Bottom Cover, the Top Cover, the Decorative Part A, the Small Cover and the Rubber Washer over the Nipple and tighten them by screwing the Finial.

Turn on the power.

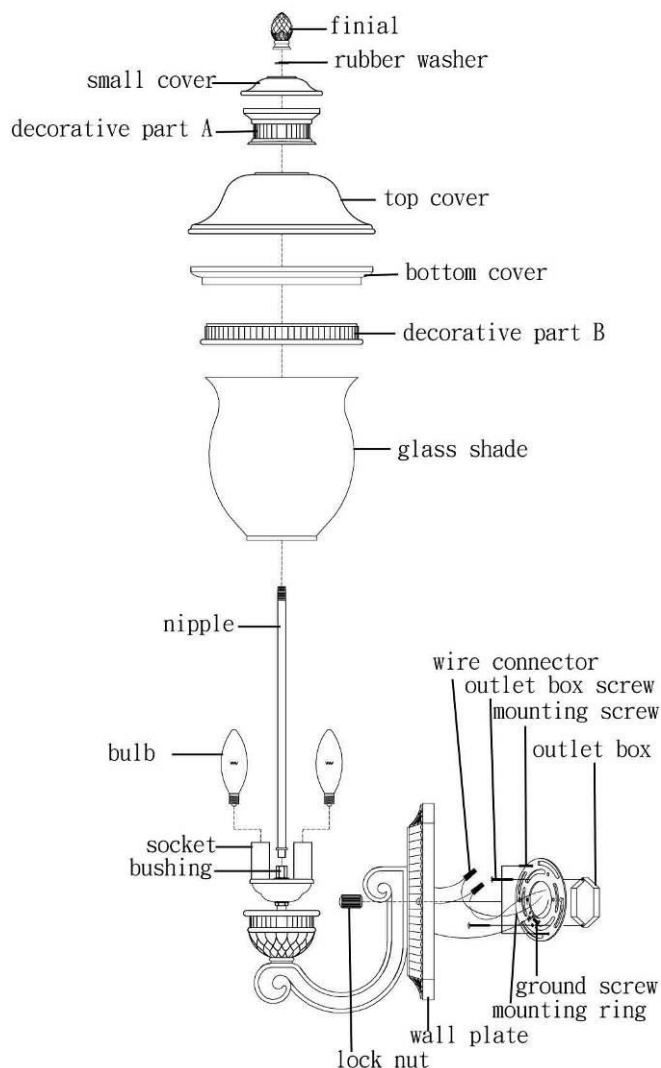

NUVO®
LIGHTING

A Satco Product

ASSEMBLY INSTRUCTION

SKU#60/875/876

NOTE: Please consult a qualified electrician if you are not certain of the installation.

CAUTION: Before starting the installation, disconnect the power by turning off the circuit breaker or by removing the fuse at the fuse box.

Fasten the Mounting Ring onto Outlet Box by using 2 Outlet Box Screws. (Make sure the thread of the Mounting Screws is facing outside when the Mounting Ring is attached to the Outlet Box).

Connect the wires white to white and black to black. Cover the connections using Wire Connectors provided. Tie ground wires from Outlet Box and from fixture to the Ground Screw on the Mounting Ring.

Place fixture body to the wall by aligning the protruding Mounting Screw all the way through the Wall Plate and tighten the fixture using 2 Lock Nuts provided until it is held firmly to the wall.

Screw the Nipple into the Bushing.

Install the bulbs. (Not included).

Place the Glass Shade, the Decorative Part B, the Bottom Cover, the Top Cover, the Decorative Part A, the Small Cover and the Rubber Washer over the Nipple and tighten them by screwing the Finial.

Turn on the power.

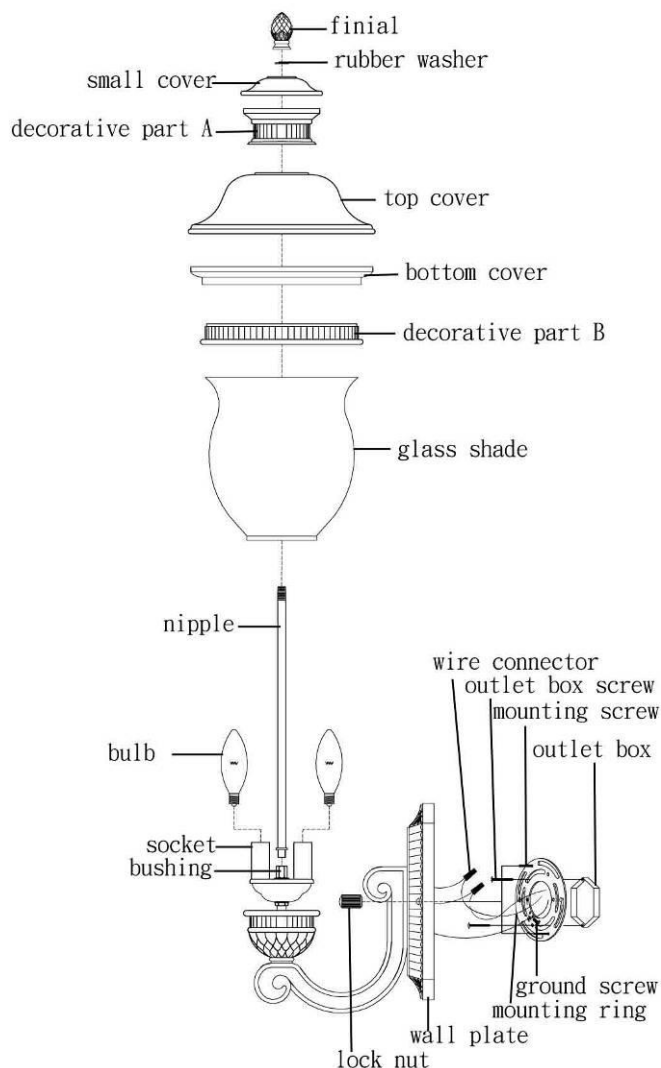

NUVO®
LIGHTING

A Satco Product

ASSEMBLY INSTRUCTION

SKU#60/877/878

NOTE: Please consult a qualified electrician if you are not certain of the installation.

CAUTION: Before starting the installation, disconnect the power by turning off the circuit breaker or by removing the fuse at the fuse box.

Fasten the Mounting Ring onto Outlet Box by using 2 Outlet Box Screws. (Make sure the thread of the Mounting Screws is facing outside when the Mounting Ring is attached to the Outlet Box).

Connect the wires white to white and black to black. Cover the connections using Wire Connectors provided. Tie the ground wires from Outlet Box and from fixture to the Ground Screw on the Mounting Ring.

Place fixture body to the wall by aligning the protruding Mounting Screw all the way through the Wall Plate and tighten the fixture using 2 Lock Nuts provided until it is held firmly to the wall.

Screw the Nipple into the Bushing.

Install the bulbs. (Not included).

Place the Glass Shade, the Decorative Part B, the Bottom Cover, the Top Cover, the Decorative Part A, the Small Cover and the Small Cap over the Nipple and tighten them by screwing the Finial.

Turn on the power.

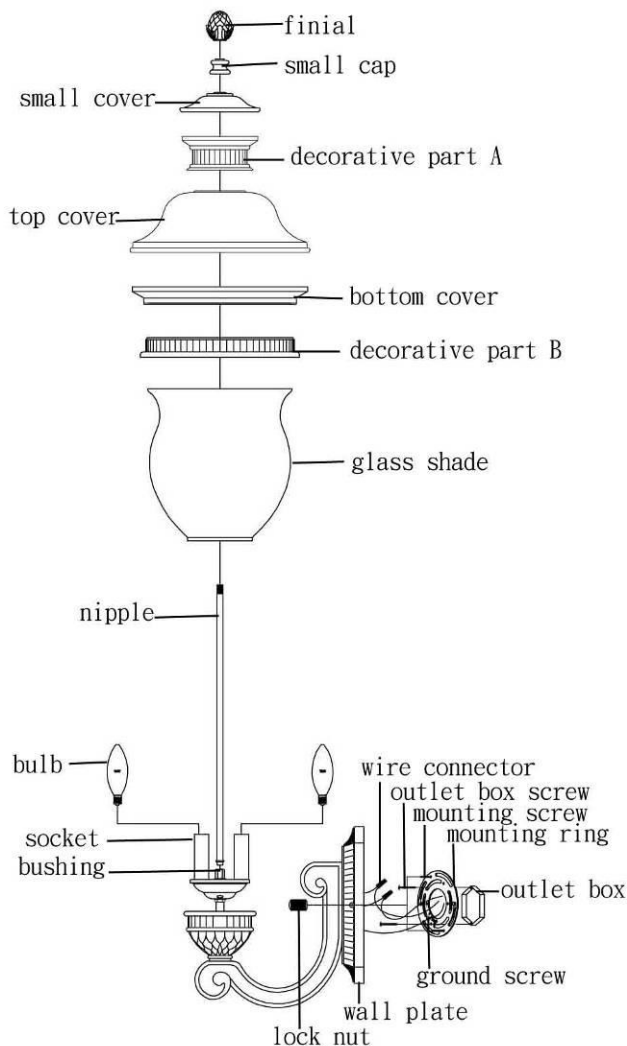

NUVO®
LIGHTING

A Satco Product

ASSEMBLY INSTRUCTION

SKU#60/877/878

NOTE: Please consult a qualified electrician if you are not certain of the installation.

CAUTION: Before starting the installation, disconnect the power by turning off the circuit breaker or by removing the fuse at the fuse box.

Fasten the Mounting Ring onto Outlet Box by using 2 Outlet Box Screws. (Make sure the thread of the Mounting Screws is facing outside when the Mounting Ring is attached to the Outlet Box).

Connect the wires white to white and black to black. Cover the connections using Wire Connectors provided. Tie the ground wires from Outlet Box and from fixture to the Ground Screw on the Mounting Ring.

Place fixture body to the wall by aligning the protruding Mounting Screw all the way through the Wall Plate and tighten the fixture using 2 Lock Nuts provided until it is held firmly to the wall.

Screw the Nipple into the Bushing.

Install the bulbs. (Not included).

Place the Glass Shade, the Decorative Part B, the Bottom Cover, the Top Cover, the Decorative Part A, the Small Cover and the Small Cap over the Nipple and tighten them by screwing the Finial.

Turn on the power.

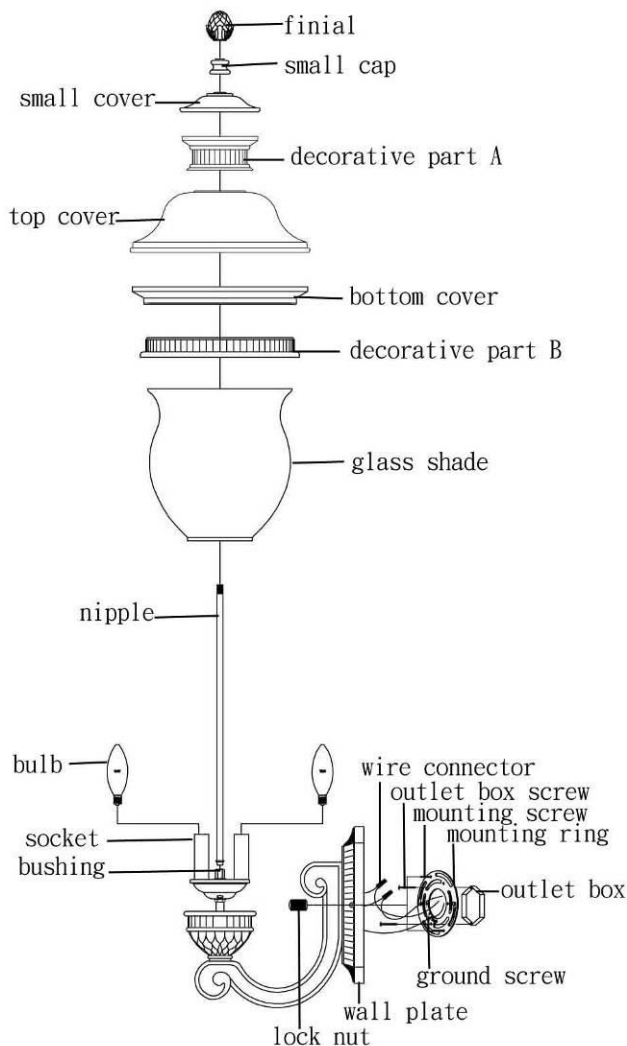

NUVO®
LIGHTING

A Satco Product

ASSEMBLY INSTRUCTION

SKU#60/879/880

NOTE: Please consult a qualified electrician if you are not certain of the installation.

CAUTION: Before starting the installation, disconnect the power by turning off the circuit breaker or by removing the fuse at the fuse box.

Fasten the Mounting Ring onto Outlet Box by using 2 Outlet Box Screws. (Make sure the thread of the Mounting Screws is facing outside when the Mounting Ring is attached to the Outlet Box).

Connect the wires white to white and black to black. Cover the connections using Wire Connectors provided. Tie the ground wires from Outlet Box and from fixture to the Ground Screw on the Mounting Ring.

Place fixture body to the wall by aligning the protruding Mounting Screw all the way through the Wall Plate and tighten the fixture using 2 Lock Nuts provided until it is held firmly to the wall.

Install the bulbs. (Not included).

Screw the Nipple into the Bushing.

Fasten the Glass Shade and Decorative Part to the Top Cover all the way through the Nipple and fasten them using the Hex Nut, Small Cap and Finial provided.

Turn on power.

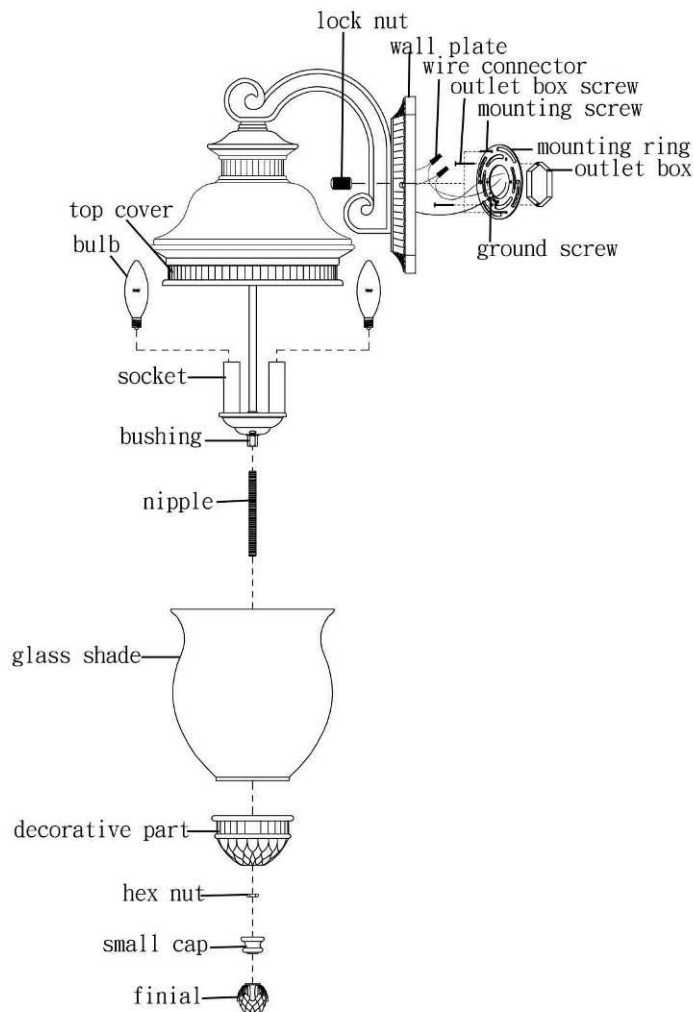

NUVO®
LIGHTING

A Satco Product

ASSEMBLY INSTRUCTION

SKU#60/879/880

NOTE: Please consult a qualified electrician if you are not certain of the installation.

CAUTION: Before starting the installation, disconnect the power by turning off the circuit breaker or by removing the fuse at the fuse box.

Fasten the Mounting Ring onto Outlet Box by using 2 Outlet Box Screws. (Make sure the thread of the Mounting Screws is facing outside when the Mounting Ring is attached to the Outlet Box).

Connect the wires white to white and black to black. Cover the connections using Wire Connectors provided. Tie the ground wires from Outlet Box and from fixture to the Ground Screw on the Mounting Ring.

Place fixture body to the wall by aligning the protruding Mounting Screw all the way through the Wall Plate and tighten the fixture using 2 Lock Nuts provided until it is held firmly to the wall.

Install the bulbs. (Not included).

Screw the Nipple into the Bushing.

Fasten the Glass Shade and Decorative Part to the Top Cover all the way through the Nipple and fasten them using the Hex Nut, Small Cap and Finial provided.

Turn on power.

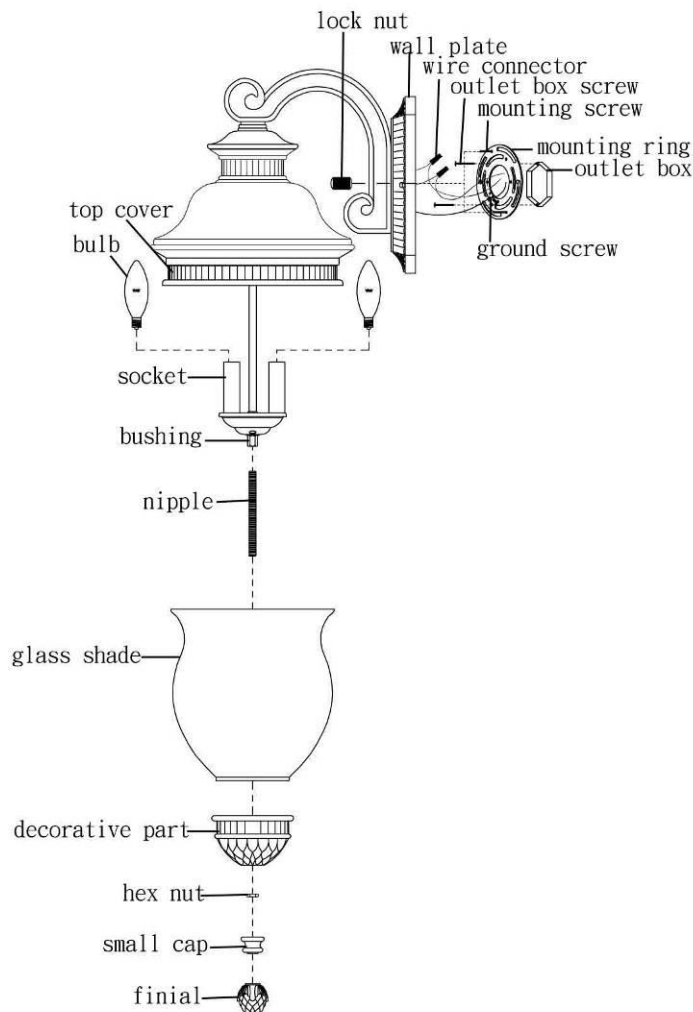

NUVO®
LIGHTING

A Satco Product

ASSEMBLY INSTRUCTION

SKU#60/881/882

NOTE: Please consult a qualified electrician if you are not certain of the installation.

CAUTION: Before starting the installation, disconnect the power by turning off the circuit breaker or by removing the fuse at the fuse box.

1. Unscrew the Screw Collar Loop from the Nipple in Mounting Strap.
2. Fasten the Mounting Strap onto Outlet Box by using 2 Outlet Box Screws.
3. Using two pliers twist open the links at the two ends of the Chain. Hook one link to the Loop and the other link to the Screw Collar Loop. Close the links.
4. Weave the fixture wires up through the Loop, through the chain, through the Ring, through the Screw Collar Loop, through the Canopy and through the Nipple in the Mounting Strap.
5. Connect the wire with writing on it to the black wire from the supply circuit. Connect the wire without writing on it to the white wire from the supply circuit. Cover the connections using Wire Connectors provided. Tie the ground wires from fixture and from Outlet Box to the Ground Screw on the Mounting Strap. Position wires back inside Outlet Box.
6. Place the Canopy over the Nipple all the way to the ceiling and tighten the Ring onto the Screw Collar Loop until the Canopy is held firmly against the ceiling.
7. Install the bulbs. (Not included).
8. Screw the Nipple into the Bushing.
9. Fasten the Glass Shade and Decorative Part to the Top Cover all the way through the Nipple and fasten them using the Hex Nut, Small Cap and Finial provided.
10. Turn on the power.

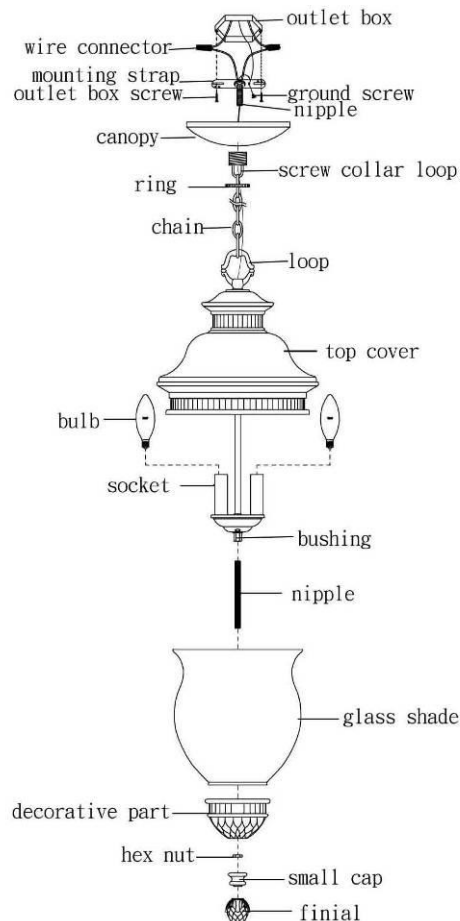

NUVO®
LIGHTING

A Satco Product

ASSEMBLY INSTRUCTION

SKU#60/881/882

NOTE: Please consult a qualified electrician if you are not certain of the installation.

CAUTION: Before starting the installation, disconnect the power by turning off the circuit breaker or by removing the fuse at the fuse box.

1. Unscrew the Screw Collar Loop from the Nipple in Mounting Strap.
2. Fasten the Mounting Strap onto Outlet Box by using 2 Outlet Box Screws.
3. Using two pliers twist open the links at the two ends of the Chain. Hook one link to the Loop and the other link to the Screw Collar Loop. Close the links.
4. Weave the fixture wires up through the Loop, through the chain, through the Ring, through the Screw Collar Loop, through the Canopy and through the Nipple in the Mounting Strap.
5. Connect the wire with writing on it to the black wire from the supply circuit. Connect the wire without writing on it to the white wire from the supply circuit. Cover the connections using Wire Connectors provided. Tie the ground wires from fixture and from Outlet Box to the Ground Screw on the Mounting Strap. Position wires back inside Outlet Box.
6. Place the Canopy over the Nipple all the way to the ceiling and tighten the Ring onto the Screw Collar Loop until the Canopy is held firmly against the ceiling.
7. Install the bulbs. (Not included).
8. Screw the Nipple into the Bushing.
9. Fasten the Glass Shade and Decorative Part to the Top Cover all the way through the Nipple and fasten them using the Hex Nut, Small Cap and Finial provided.
10. Turn on the power.

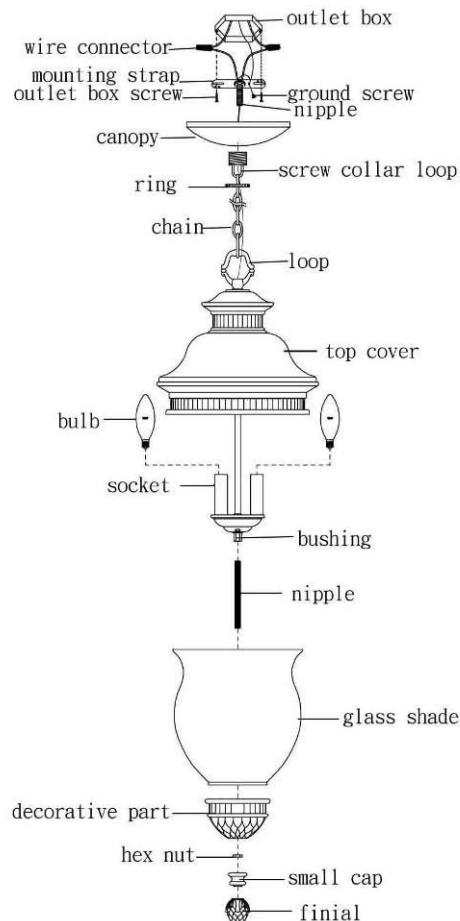

NUVO®
LIGHTING

A Satco Product

SKU#60/883/884

REMARQUE : Si vous avez des incertitudes quant à l'installation, demandez de l'aide à un électricien qualifié.

ATTENTION : Avant de commencer l'installation, déconnectez l'alimentation électrique avec le disjoncteur ou en retirant le fusible du disjoncteur. Calfeutrer la surface de montage au sommet et sur les côtés.

1. Connectez les fils blanc sur blanc et noir sur noir, puis attachez ensemble les fils de terre de la lampe et du Capuchon de montant. Couvrez les connexions à l'aide des Connecteurs de fils fournis.
2. Placez le Montant sur le Capuchon de montant, et attachez-les à l'aide des Contre-écrous fournis.
3. Vissez l'Embout dans la Douille.
4. Installez l'ampoule (non fournie).
5. Placez l'Abat-jour en verre, la Partie décorative B, le Capot inférieur, le Capot supérieur, la Partie décorative A, le Petit capot et le Petit capuchon sur l'Embout et fixez-les en vissant le Faîteau.
6. Allumez l'électricité.