

QUOIZEL

6 CORPORATE PARKWAY
GOOSE CREEK, SC. 29445
www. quoizel. com

Quoizel, Inc.
6 Corporate Parkway
Goose Creek, SC
29445

Customer Service
Phone 631.273.2700
Fax 631.231.7102
www.quoizel.com

Assembly Instruction Sheet #IS-ANS642NE For Style ANS642NE

Tools Required: Flathead screwdriver, Phillips screwdriver, pliers, wire cutters, wire strippers, electrical tape, safety glasses.

Bulb Recommended: (6) Candelabra Base 60W Maximum

Estimated Assembly Time: 20-30 minutes

Preparation: Identify and inspect all parts before beginning installation. Check package content list and diagrams below to be sure all parts are present. If any parts are missing or damaged, do not attempt to assemble, install, or operate the fixture. Contact customer service for replacement parts.



Warnings and Cautions

Turn off electricity at circuit breaker or main fuse box before installation. Consult a licensed electrician if in doubt.

These instructions are provided for your safety. It is very important you read them completely before installing the fixture. We strongly recommend that a licensed, professional electrician perform the installation.

Disconnect fixture from power source before replacing bulbs. Make sure bulbs are given sufficient time to cool before removal. Do not subject glass parts to any shock while in operation or shattering may result.

Package Contents

| Part | Description | Quantity |
|------|------------------|----------|
| A | Crossbar | 1 pc. |
| B | Nipple | 1 pc. |
| C | Lock Washer | 2 pcs. |
| D | Hex Nut | 2 pcs. |
| E | Lock Ball | 1 pc. |
| F | Shade | 6 pcs. |
| G | Ceiling Canopy | 1 pc. |
| H | Fixture Chain | 2 pcs. |
| I | Support Rods | 1 pc. |
| J | Fixture Assembly | 1 pc. |

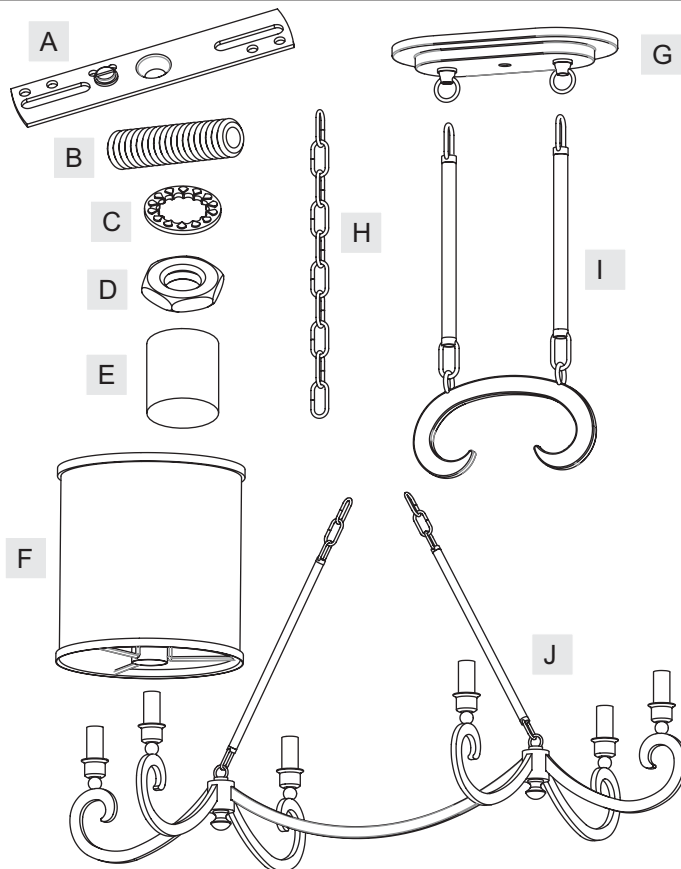

Thank you for purchasing a Quoizel product.

Need assistance with parts or assembly? Call Quoizel customer service at 1-631-273-2700
or visit us on-line at www.quoizel.com

ANS642NE

FINISH: NEO BRONZE

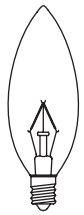
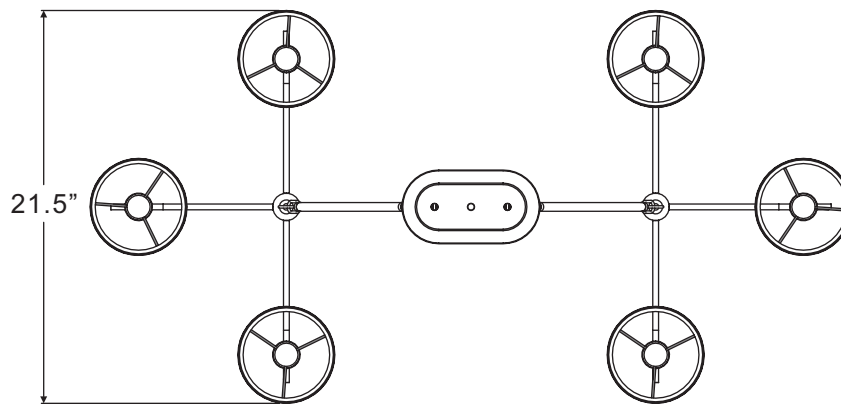
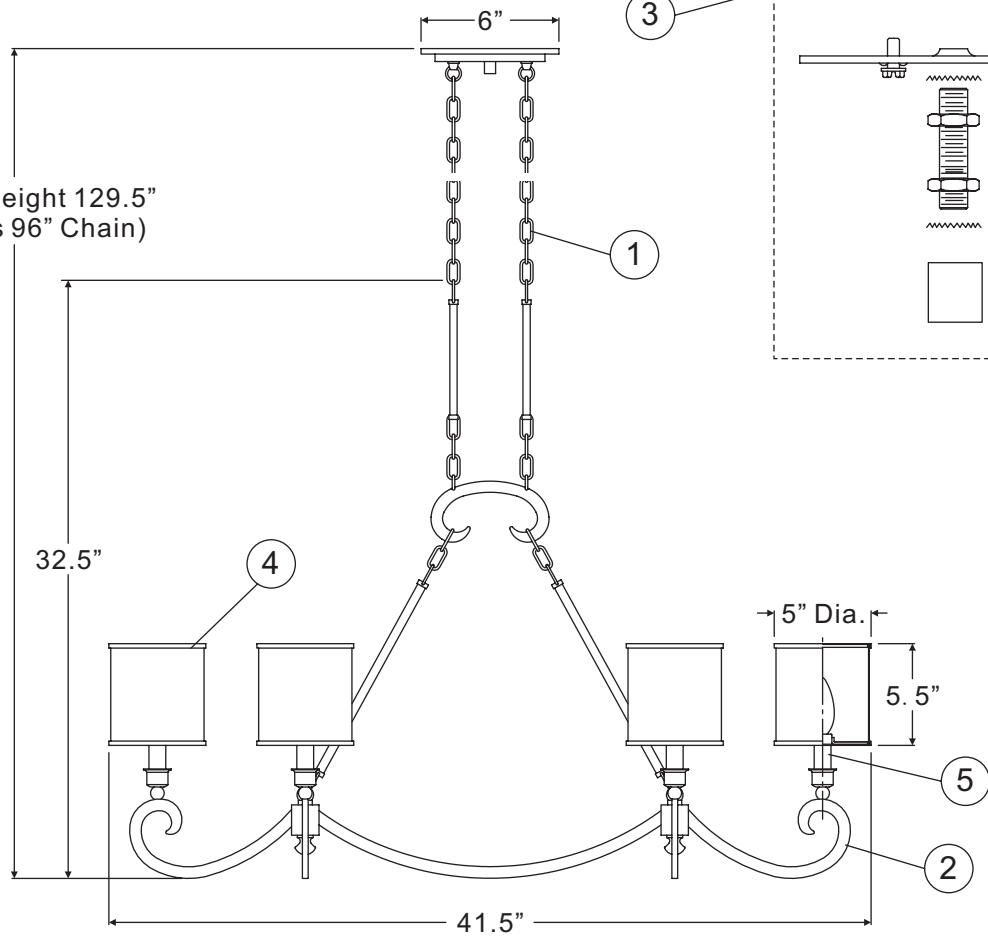
Overall Height 129.5"
(Includes 96" Chain)(6) 60W Candelabra
base bulbs
(not Supplied)

NOTE: ALL DIMENSIONS ARE ROUNDED UP TO THE NEAREST 1/2"

| NO. | PART NUMBER | REPLACEMENT PART DESCRIPTION | REQ. |
|-----|-------------|--|------|
| 1 | M2275CHNE | CHAIN NEO BRONZE 3.8MM X 4' | 2 |
| 2 | 9642NEANS | ISLAND FIXTURE NEO BRONZE 6 LIGHTS | 1 |
| 3 | 9492KIT | MOUNTING HARDWARE/CANOPY NEO BRONZE 4.75"L | 1 |
| 4 | S1329CF | SHADE CAPIZ FLAKES 5.5"H X 5"D | 6 |
| 5 | M2276HHNE | SHADE HARP HOLDER NEO BRONZE | 6 |

Assembly Instruction Sheet #IS-ANS642NE For Style ANS642NE

STEP 1 – Assemble Support Rods, Fixture Chains and Ceiling Canopy

- A. Attach one ends of Fixture Chains (H) to Ceiling Loops on the bottom of the Ceiling Canopy (G). Attach another ends of Fixture Chains (H) to Fixture Loops on the top ends of Support Rods (I).

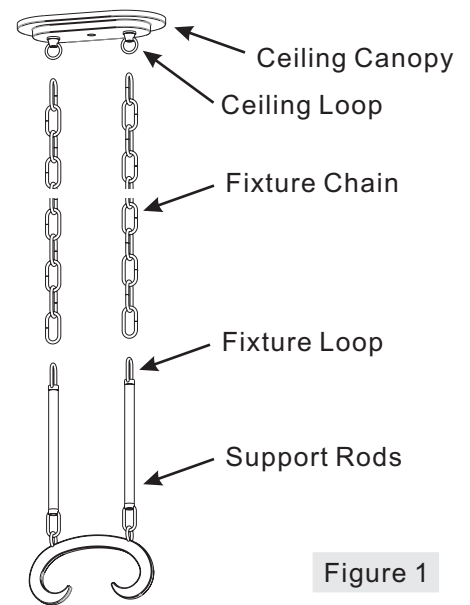

Figure 1

STEP 2 – Attach Support Rods to Fixture Assembly

- A. Attach Chain ends of the Fixture Assembly (J) to Scroll ends of the Support Rods (I).

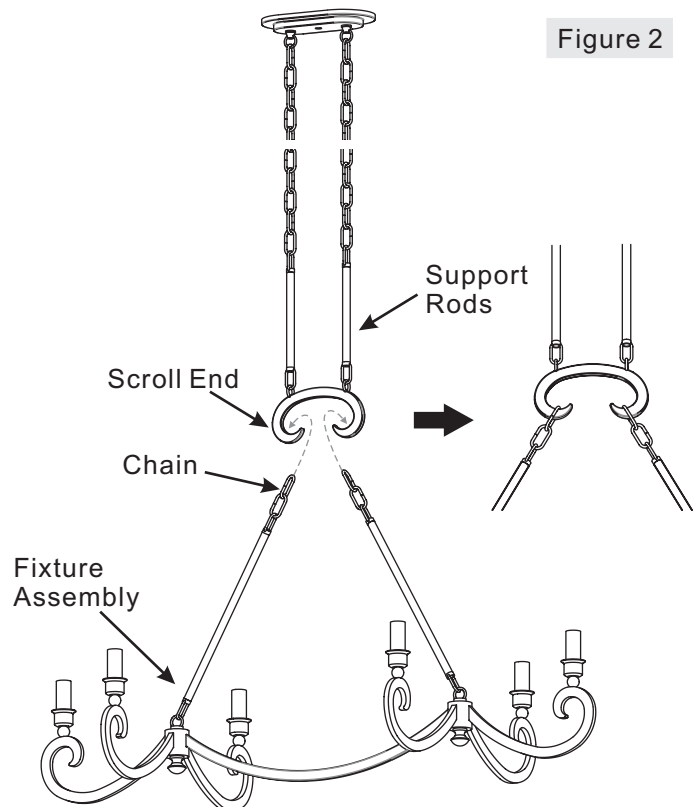

Figure 2

Thank you for purchasing a Quoizel product.

Need assistance with parts or assembly? Call Quoizel customer service at 1-631-273-2700
or visit us on-line at www.quoizel.com

Assembly Instruction Sheet #IS-ANS642NE

For Style ANS642NE

STEP 3 – Attach Crossbar to Outlet Box

- A. Secure the Crossbar (A) to the outlet box with outlet box screws (not supplied). Tighten until snug.

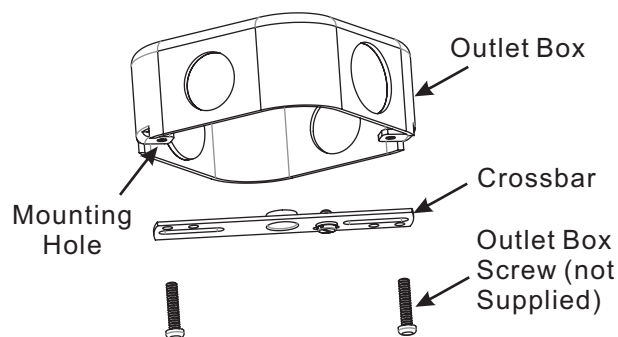

Figure 3

STEP 4 – Attach Nipple to Crossbar

- A. Thread one Hex Nut (D) onto the top end of the Nipple (B).
B. Place one Lock Washer (C) over the top end of the Nipple (B) and then thread the Nipple (B) into the center lock hole of the Crossbar (A).
C. Using pliers, thread the Hex Nut (D) against the Crossbar (A) and hand tighten until snug.

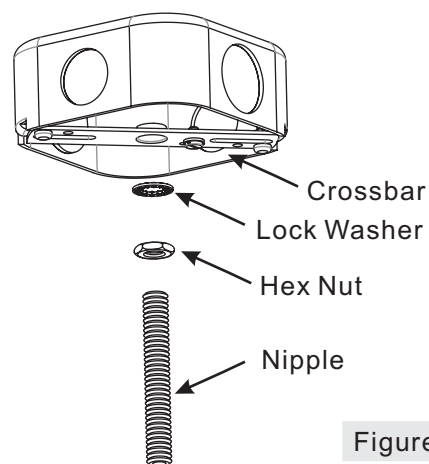

Figure 4

Thank you for purchasing a Quoizel product.

Need assistance with parts or assembly? Call Quoizel customer service at 1-631-273-2700
or visit us on-line at www.quoizel.com

Assembly Instruction Sheet #IS-ANS642NE For Style ANS642NE

STEP 5 – Make Wire Connections

- Use standard wire connectors to make all wire connections. (Connectors are not included with fixture.) Strip and prepare wire ends according to instructions supplied with connectors.
- Connect White Supply Wire from the Outlet Box to White Wire from fixture.
- Connect Black (or Red) Supply Wire from the Outlet Box to Black Wire from fixture.
- Connect Ground Wire from the Outlet Box to Ground Wire from fixture.
- Twist connectors until wires are tightly joined together.
- Wrap each connection with approved electrical tape and carefully stuff all the connected wires into the Outlet Box.

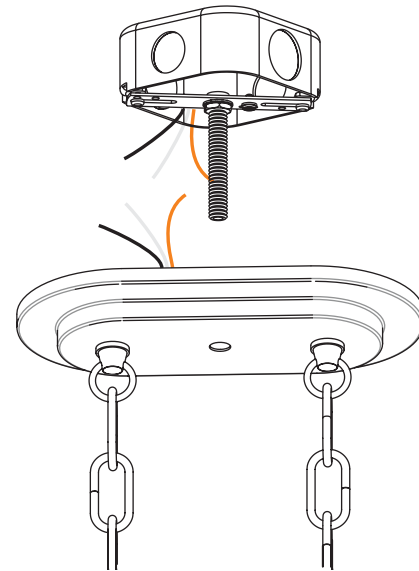

Figure 5

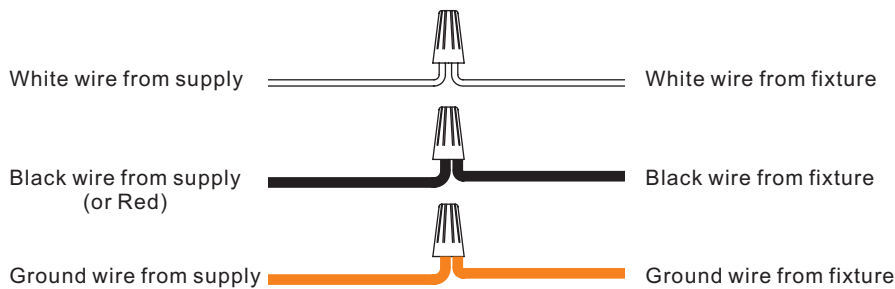

Figure 6

STEP 6 – Install Ceiling Canopy

- Thread another Hex Nut (D) onto the end of the Nipple (B). Place the Lock Washer (C) over the end of the Nipple (B) and then pass the Ceiling Canopy (G) over the end of the Nipple (B). Secure by threading the Lock Ball (E) onto the Nipple (B). Hand tighten until snug.

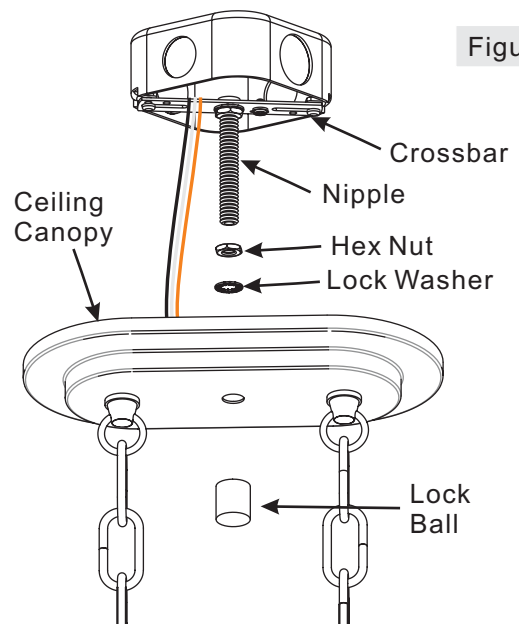

Figure 7

Thank you for purchasing a Quoizel product.

Need assistance with parts or assembly? Call Quoizel customer service at 1-631-273-2700
or visit us on-line at www.quoizel.com

Assembly Instruction Sheet #IS-ANS642NE For Style ANS642NE

STEP 7 – Install Shade

- A. Place the Shade (K) onto the top end of the Candle Cover as shown.

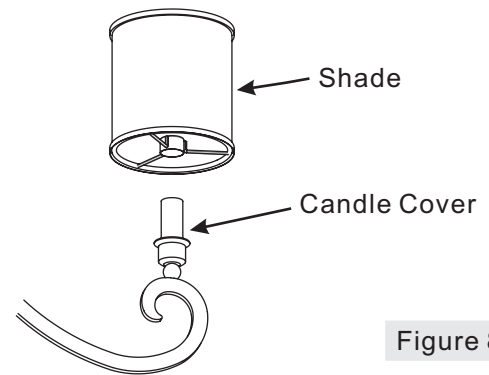

Figure 8

STEP 8 – Install Bulb

- A. This fixture uses candelabra bulb with a candelabra screw base. Maximum 60 watts.
B. Insert bulb and screw snugly into place.

Your fixture is now assembled and ready to use. Enjoy!

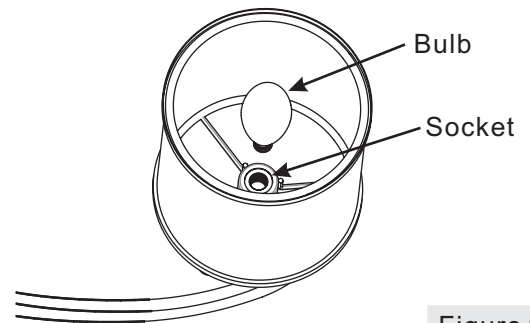

Figure 9

Thank you for purchasing a Quoizel product.

Need assistance with parts or assembly? Call Quoizel customer service at 1-631-273-2700
or visit us on-line at www.quoizel.com