

QUOIZEL

6 CORPORATE PARKWAY
GOOSE CREEK, SC. 29445
www. quoizel. com

Quoizel, Inc.
6 Corporate Parkway
Goose Creek, SC
29445

Customer Service
Phone 631.273.2700
Fax 631.231.7102
www. quoizel. com

Assembly Instruction Sheet #IS-AST5005C For Style AST5005C

Tools Required: Flathead screwdriver, Phillips screwdriver, pliers, wire cutters, wire strippers, electrical tape, safety glasses.

Bulb Recommended: (5) G16 1/2 Candelabra Base 60W Maximum

Estimated Assembly Time: 20-30 minutes

Preparation: Identify and inspect all parts before beginning installation. Check package content list and diagrams below to be sure all parts are present. If any parts are missing or damaged, do not attempt to assemble, install, or operate the fixture. Contact customer service for replacement parts.



Warnings and Cautions

Turn off electricity at circuit breaker or main fuse box before installation. Consult a licensed electrician if in doubt.

These instructions are provided for your safety. It is very important you read them completely before installing the fixture. We strongly recommend that a licensed, professional electrician perform the installation.

Disconnect fixture from power source before replacing bulbs. Make sure bulbs are given sufficient time to cool before removal. Do not subject glass parts to any shock while in operation or shattering may result.

Package Contents

Part	Description	Quantity
A	Crossbar	1 pc.
B	Mounting Screw	3 pcs.
C	Ceiling Canopy	1 pc.
D	Shade	5 pcs.
E	Socket Assembly	1 pc.
F	6" Rod	2 pcs.
G	12" Rod	2 pcs.
H	Center Rod	1 pc.

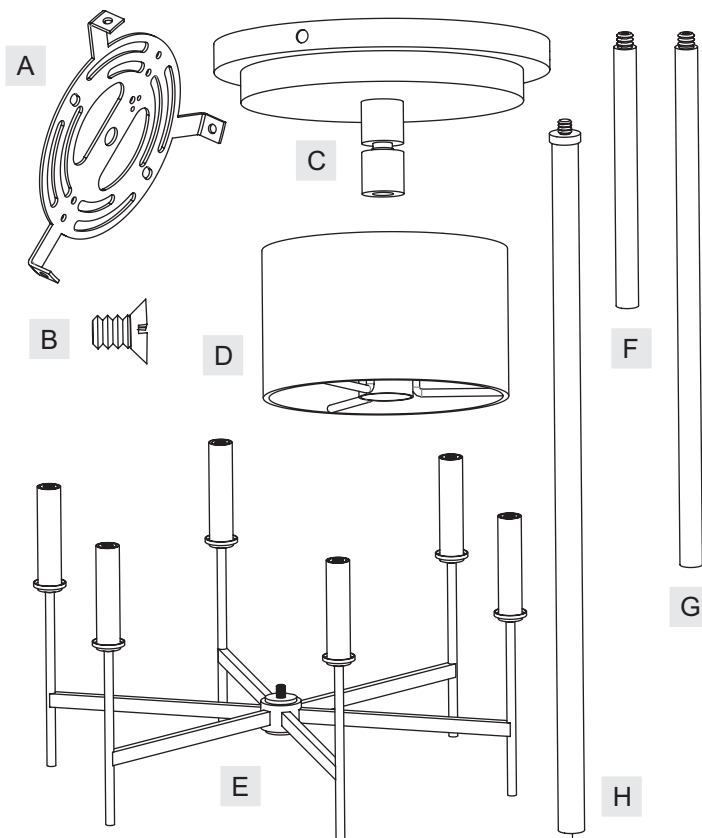

Thank you for purchasing a Quoizel product.

Need assistance with parts or assembly? Call Quoizel customer service at 1-631-273-2700
or visit us on-line at www. quoizel. com

AST5005C

FINISH: POLISHED CHROME

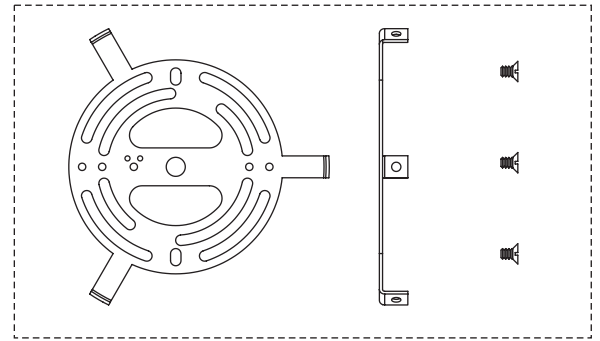
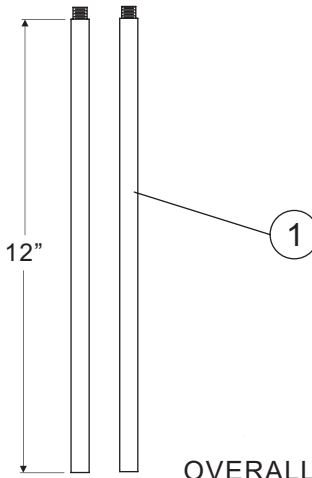
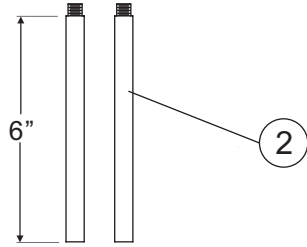

60"
OVERALL HEIGHT INCLUDES
(2) 6" AND (2) 12" RODS

NOTE: TWO LIGHTS SHOWN FOR
ILLUSTRATION PURPOSES ONLY.

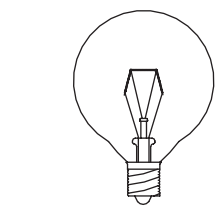
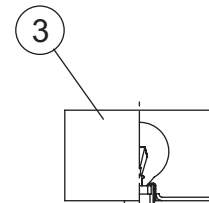
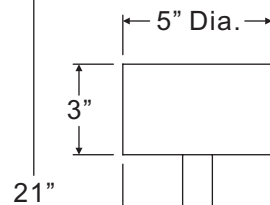

(5)60W G16 ½
Candelabra Base
Bulbs (Not Supplied)

NOTE: ALL DIMENSIONS ARE ROUNDED UP TO THE NEAREST 1/2"

NO.	PART NUMBER	REPLACEMENT PART DESCRIPTION	REQ.
1	9012EXC	ROD EXTENSION POLISHED CHROME 12"L X 0.5"D	2
2	9006EXC	ROD EXTENSION POLISHED CHROME 6"L X 0.5"D	2
3	S1146OW	SHADE OFF/WHITE POLISHED SILVER SPIDER	5

Assembly Instruction Sheet #IS-AST5005C

For Style AST5005C

STEP 1 – Assemble Center Rod to Socket Assembly

- A. Thread the end of the Center Rod (H) onto the nipple on the top center of the Socket Assembly (E). Hand tighten until snug.

Figure 1

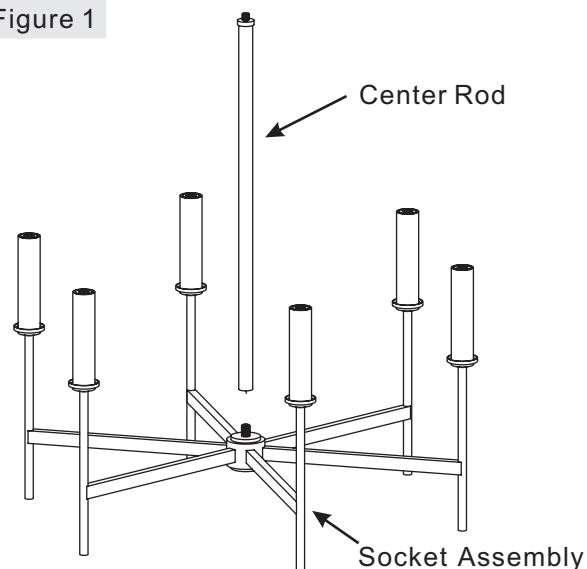

STEP 2 – Assemble Rods

- A. Determine the Rods (F/G) to be assembled to the Center Rod (H) according to your hanging height.
B. Pass Supply Wires and Ground Wire through the chosen Rods (F/G) and then thread the chosen Rods (F/G) and the Center Rod (H) together. Hand tighten until snug.

Figure 2

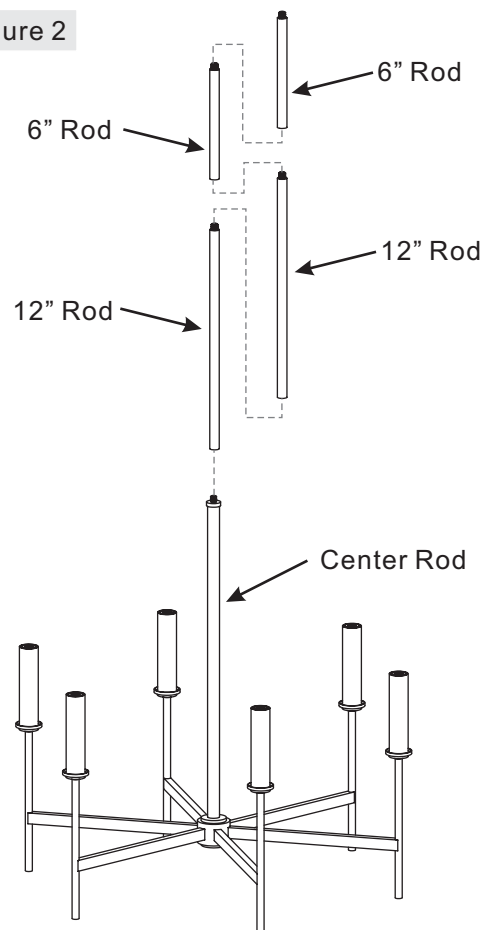

Thank you for purchasing a Quoizel product.

Need assistance with parts or assembly? Call Quoizel customer service at 1-631-273-2700
or visit us on-line at www.quoizel.com

Assembly Instruction Sheet #IS-AST5005C For Style AST5005C

STEP 3 – Attach Crossbar to Outlet Box

- A. Attach the Crossbar (A) to Outlet Box and secure by threading Outlet Box Screws (not supplied) into the Mounting Holes on the Outlet Box. Tighten until snug.

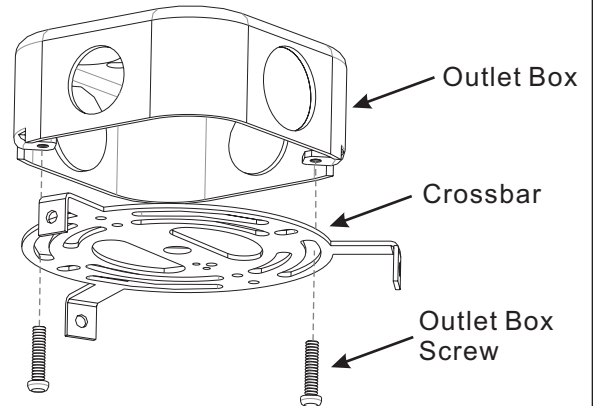

Figure 3

STEP 4 – Make Wire Connections

- A. Use standard wire connectors to make all wire connections. (Connectors are not included with fixture.) Strip and prepare wire ends according to instructions supplied with connectors.
- B. Connect White Supply Wire from the Outlet Box to White Wire from fixture.
- C. Connect Black (or Red) Supply Wire from the Outlet Box to Black Wire from fixture.
- D. Connect Ground Wire from the Outlet Box to Ground Wire from fixture.
- E. Twist connectors until wires are tightly joined together.
- F. Wrap each connection with approved electrical tape and carefully stuff all the connected wires into the Outlet Box.

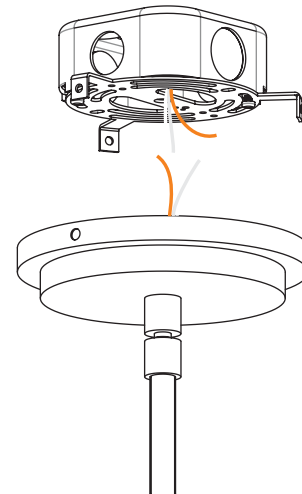

Figure 4

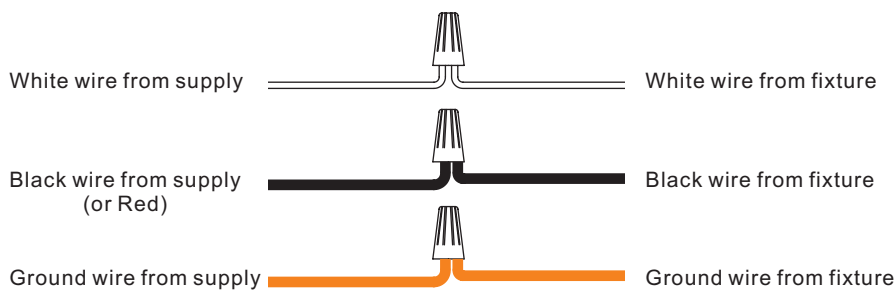

Figure 5

Thank you for purchasing a Quoizel product.

Need assistance with parts or assembly? Call Quoizel customer service at 1-631-273-2700
or visit us on-line at www.quoise.com

Assembly Instruction Sheet #IS-AST5005C For Style AST5005C

STEP 5 – Attach Ceiling Canopy to Crossbar

- A. Place the Ceiling Canopy (C) onto the Crossbar (A). Line up Mounting Holes on the Crossbar (A) and holes on the side of the Ceiling Canopy (C). Secure by threading Mounting Screws (B) into the mounting holes on the Crossbar (A). Hand tighten until snug.

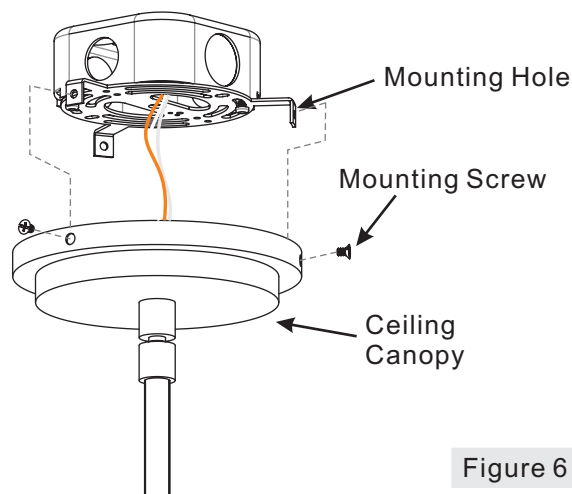

Figure 6

STEP 6 – Attach Shade

- A. Place the Shade (D) onto the top end of the Candle Cover as shown.

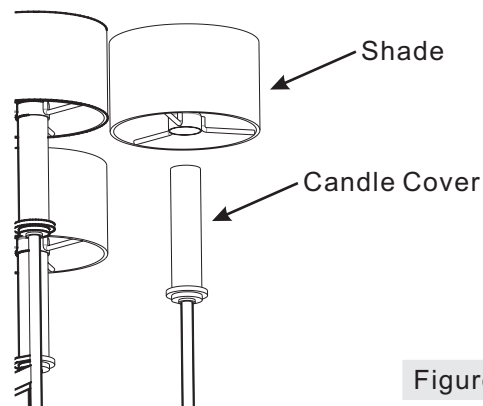

Figure 7

STEP 7 – Install Bulb

- A. This fixture uses G16 ½ bulb with a candelabra screw base. Maximum 60 watts.
B. Insert bulb and screw properly into place.

Your fixture is now assembled and ready to use. Enjoy!

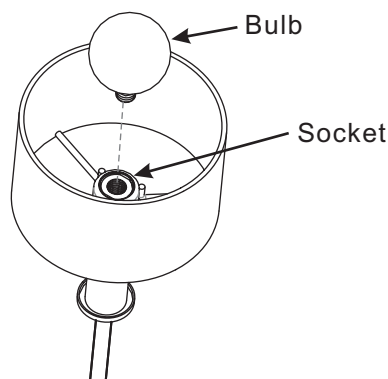

Figure 8

Thank you for purchasing a Quoizel product.
Need assistance with parts or assembly? Call Quoizel customer service at 1-631-273-2700
or visit us on-line at www. quoizel. com