

Quoizel, Inc.
6 Corporate Parkway
Goose Creek, SC
29445

Customer Service
Phone 631.273.2700
Fax 631.231.7102
www.quoizel.com

Assembly Instruction Sheet #IS-BRK9360C For Style BRK9360C

Tools Required: None

Bulb Recommended: (1) Medium Base 75 W Maximum

Estimated Assembly Time: 15-20 minutes

Preparation: Identify and inspect all parts before beginning installation. Check package content list and diagrams below to be sure all parts are present. If any parts are missing or damaged, do not attempt to assemble, install, or operate the fixture. Contact customer service for replacement parts.



Warnings and Cautions

Turn off electricity at circuit breaker or main fuse box before installation. Consult a licensed electrician if in doubt.

These instructions are provided for your safety. It is very important you read them completely before installing the fixture. We strongly recommend that a licensed, professional electrician perform the installation.

Disconnect fixture from power source before replacing bulbs. Make sure bulbs are given sufficient time to cool before removal. Do not subject glass parts to any shock while in operation or shattering may result.

Package Contents

Part	Description	Quantity
A	Socket Collar	1 pc.
B	Shade	1 pc.
C	Socket Assembly	1 pc.
D	Center Stem	2 pcs.
E	Base	1 pc.

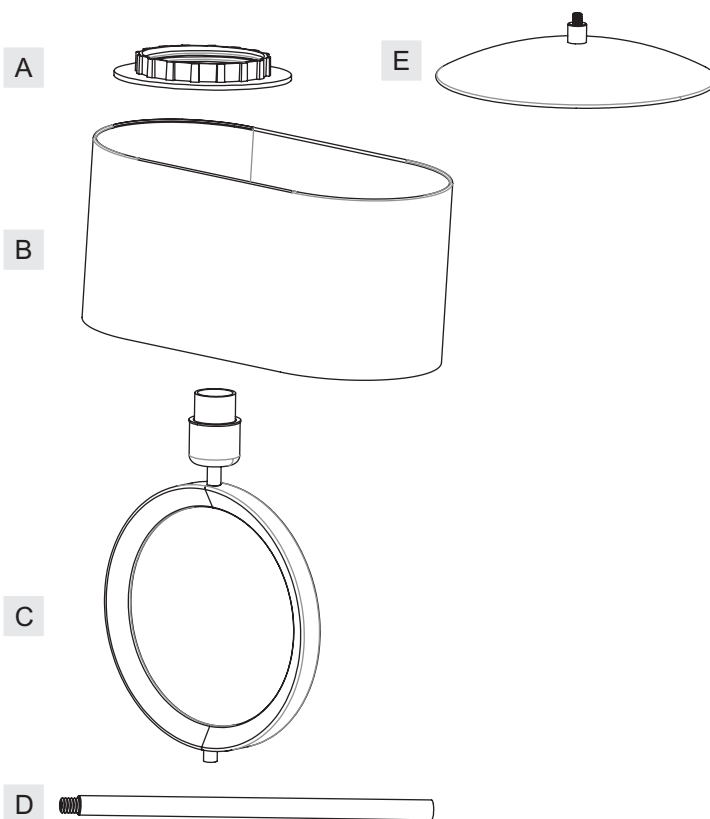

Thank you for purchasing a Quoizel product.
Need assistance with parts or assembly? Call Quoizel customer service at 1-631-273-2700
or visit us on-line at www.quoizel.com

BRK9360C

FINISH: POLISHED CHROME

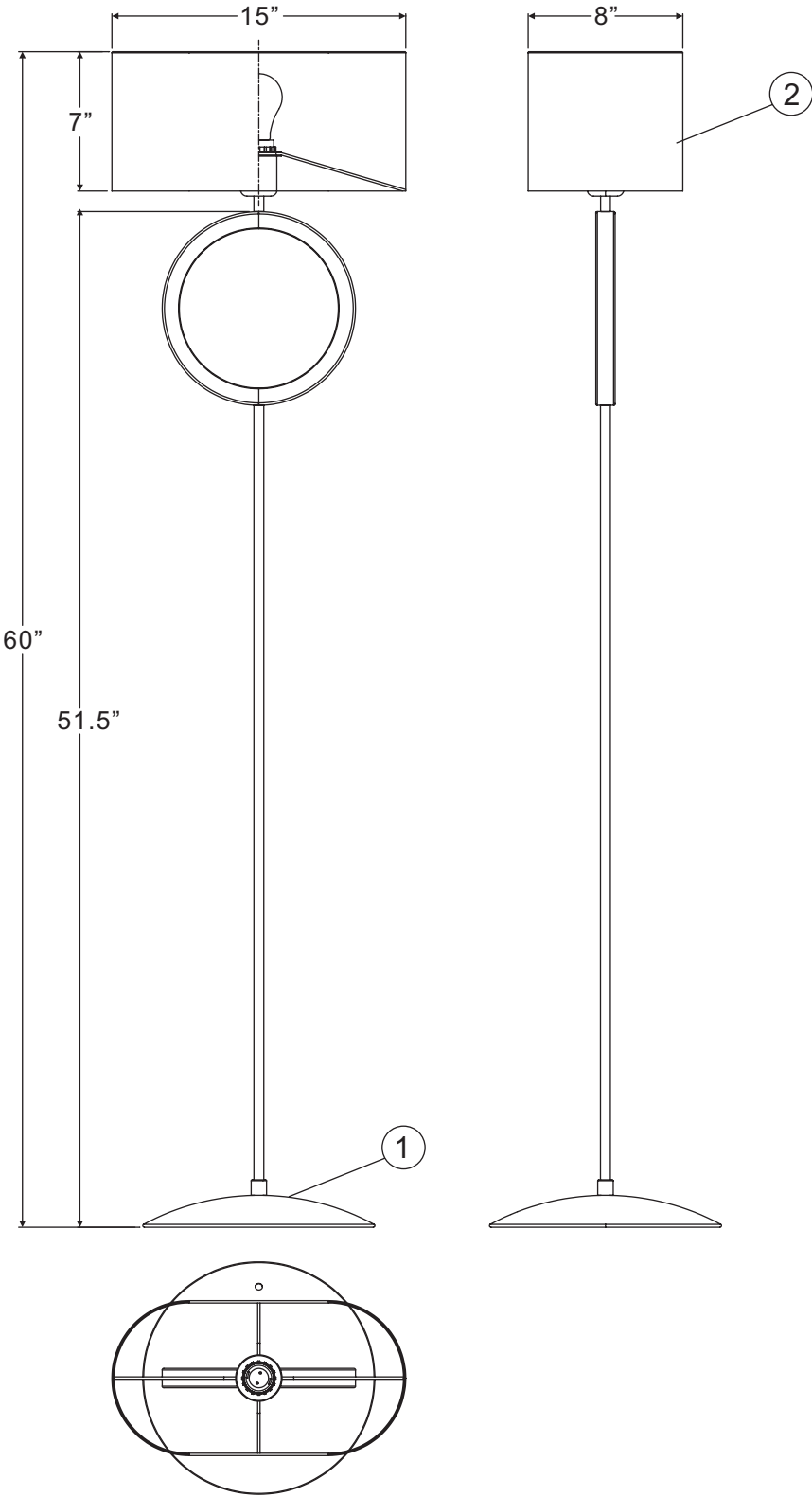

(1)75W Medium
Base Bulb
(Not Supplied)

NOTE: ALL DIMENSIONS ARE ROUNDED UP TO THE NEAREST 1/2"

NO.	PART NUMBER	REPLACEMENT PART DESCRIPTION	REQ.
1	19360CBRK	BASE POLISHED CHROME BRK9360C	1
2	S1401BE	BEIGE FABRIC SHADE BRK9360C	1

Assembly Instruction Sheet #IS-BRK9360C For Style BRK9360C

STEP 1 – Attach Center Stem and Socket Assembly to Base

- Remove the Bushings from the ends of the Center Stems (D) before assembly.
- Thread the Center Stems (D), the Socket Assembly (C) and the Base (E) as shown. Hand tighten until snug.

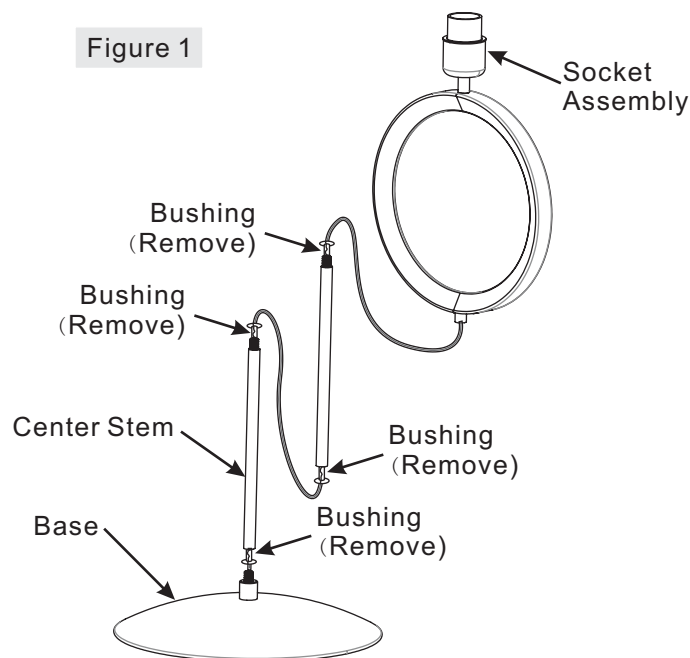

STEP 2 – Attach Shade to fixture

- Place Shade (B) over the Socket on the top of Base (C), secure by thread Socket Collar (A) onto Socket, hand tighten until snug.

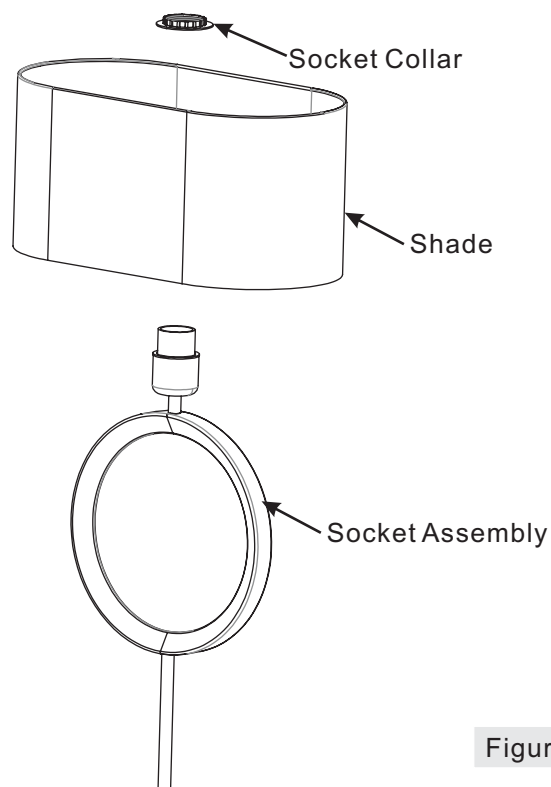

Figure 2

Thank you for purchasing a Quoizel product.

Need assistance with parts or assembly? Call Quoizel customer service at 1-631-273-2700
or visit us on-line at www.quoizel.com

Assembly Instruction Sheet #IS-BRK9360C For Style BRK9360C

STEP 2 – Attach Shade to fixture

- A. Place Shade (B) over the Socket on the top of Base (C) ,secure by thread Socket Collar (A) onto Socket, hand tighten until snug.

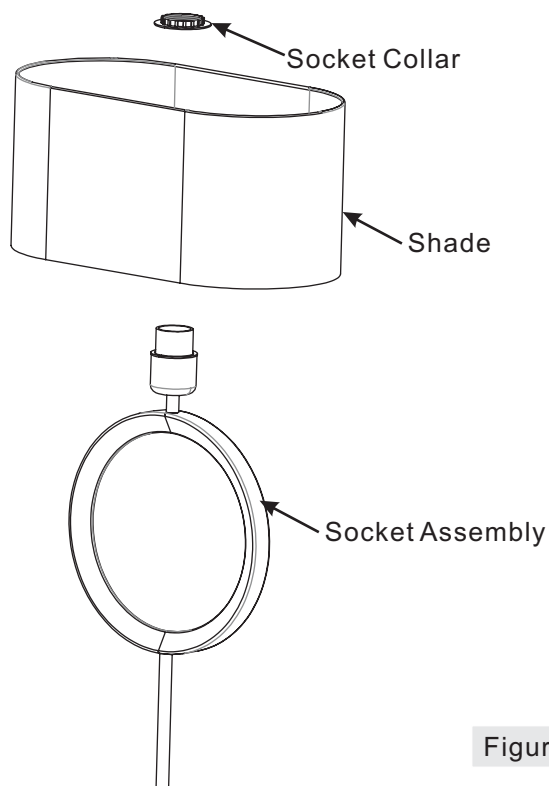

Figure 2

STEP 3 – Install Bulb

- A. This fixture uses standard bulb with standard screw base . Maximum 75 watts.
B. Insert bulb and screw snugly into place.

Your lamp is now assembled and ready to use.
Enjoy!

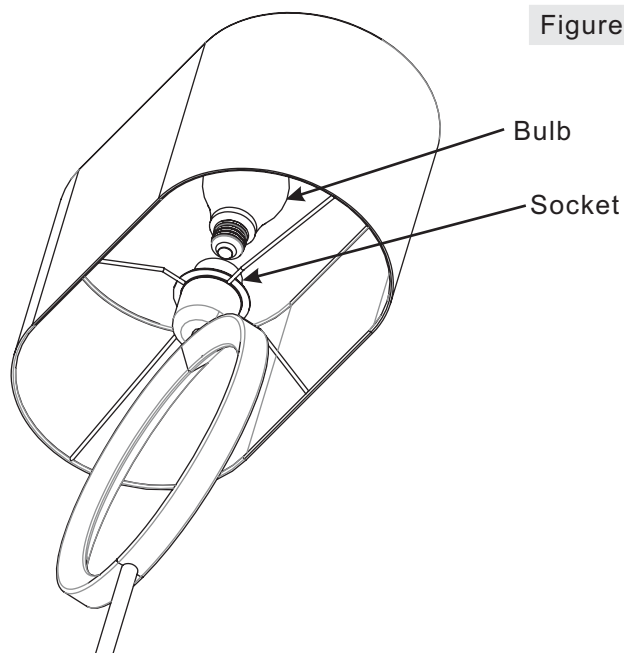

Figure 3

Thank you for purchasing a Quoizel product.

Need assistance with parts or assembly? Call Quoizel customer service at 1-631-273-2700
or visit us on-line at www. quoizel. com