

Quoizel, Inc.
6 Corporate Parkway
Goose Creek, SC
29445

Customer Service
Phone 631.273.2700
Fax 631.231.7102
www.quoizel.com

Assembly Instruction Sheet #IS-BWN2822TM For Style BWN2822TM

Tools Required: Flathead screwdriver, Phillips screwdriver, pliers, wire cutters, wire strippers, electrical tape, safety glasses.

Bulb Recommended: (3) Medium Base 100W Maximum

Estimated Assembly Time: 20-30 minutes

Preparation: Identify and inspect all parts before beginning installation. Check package content list and diagrams below to be sure all parts are present. If any parts are missing or damaged, do not attempt to assemble, install, or operate the fixture. Contact customer service for replacement parts.



Warnings and Cautions

Turn off electricity at circuit breaker or main fuse box before installation. Consult a licensed electrician if in doubt.

These instructions are provided for your safety. It is very important you read them completely before installing the fixture. We strongly recommend that a licensed, professional electrician perform the installation.

Disconnect fixture from power source before replacing bulbs. Make sure bulbs are given sufficient time to cool before removal. Do not subject glass parts to any shock while in operation or shattering may result.

Package Contents

Part	Description	Quantity
A	Crossbar	1 pc.
B	Mounting Screw	2 pcs.
C	Lock Washer	2 pcs.
D	Hex Nut	2 pcs.
E	Mounting Ball	2 pcs.
F	Center Stem Assembly	1 pc.
G	1/8 IP Hex Nut	1 pc.
H	Ceiling Canopy	1 pc.
I	Socket Collar	1 pc.
J	6" Rod	2 pcs.
K	12" Rod	2 pcs.
L	Shade	1 pc.
M	Shade Holder	1 pc.
N	Cap	1 pc.
O	Finial	1 pc.

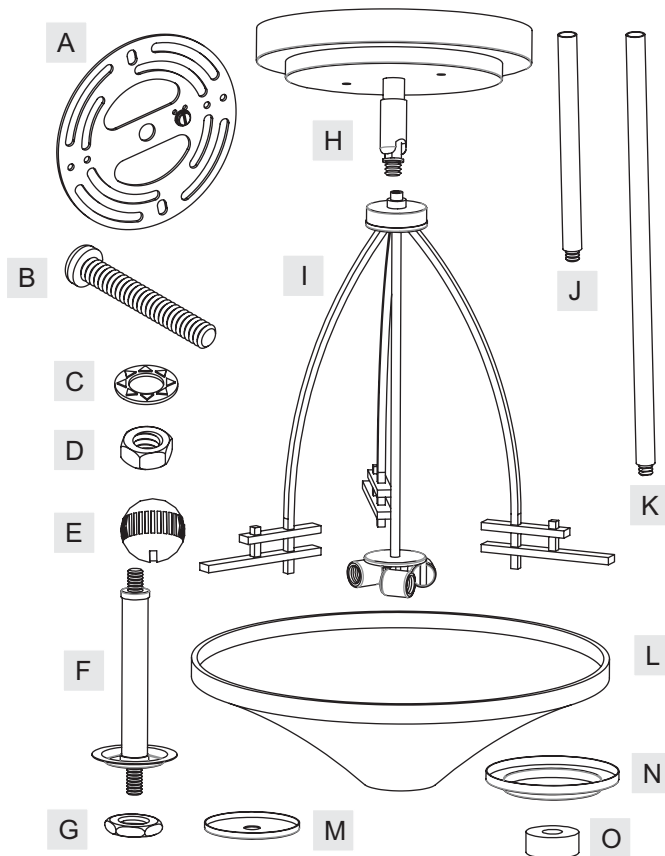

Thank you for purchasing a Quoizel product.

Need assistance with parts or assembly? Call Quoizel customer service at 1-631-273-2700
or visit us on-line at www.quoizel.com

BWN2822TM

FINISH: TECO MARRONE

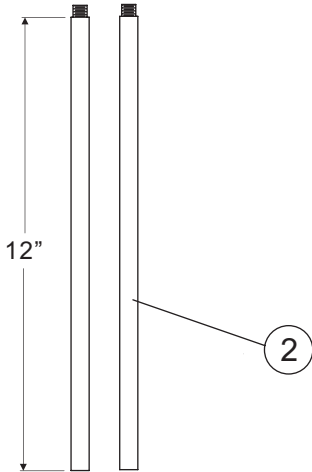
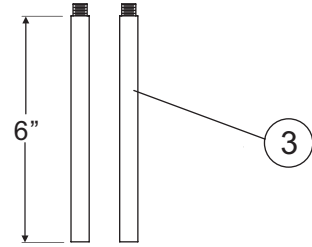

1

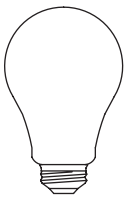
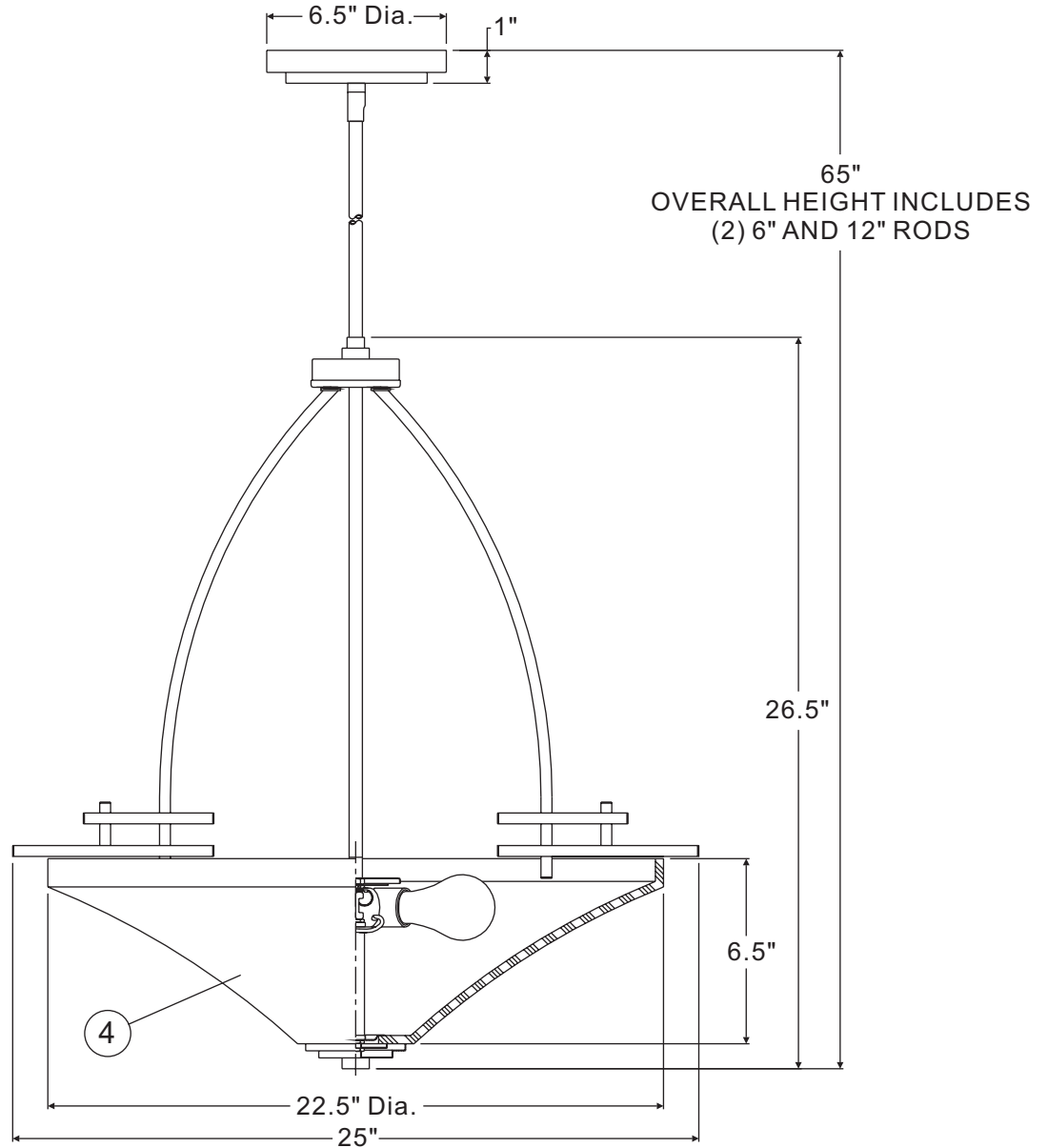
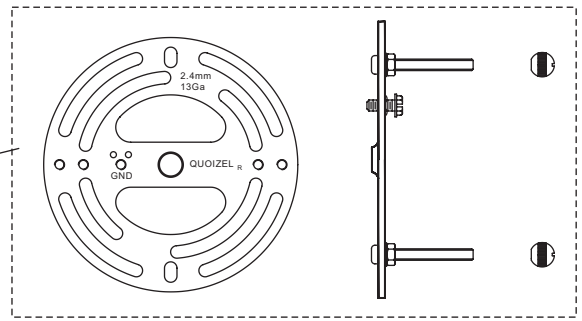

(3)100W A19
Medium Base Bulbs
(Not Supplied)

NOTE: ALL DIMENSIONS ARE ROUNDED UP TO THE NEAREST 1/2"

NO.	PART NUMBER	REPLACEMENT PART DESCRIPTION	REQ.
1	9473KIT	MTG HDW/CNPY TECO MARE 6.5"D	1
2	9012EXTM	ROD EXT TECO MARE 12"L X .5"D	2
3	9006EXTM	ROD EXT TECO MARE 6"L X .5"D	2
4	G2870SH	SHADE ACID ETCHED GLS PNTD/WHT	1

Assembly Instruction Sheet #IS-BWN2822TM For Style BWN2822TM

STEP 1 – Assemble Rods

- A. Determine the Rods (J/K) to be assembled to the Socket Assembly (I) according to your hanging height.
- B. Pass Supply Wires and Ground Wire through the chosen Rods (J/K) and then thread the chosen Rods (J/K) and the Socket Assembly (I) together. Hand tighten until snug.

Figure 1

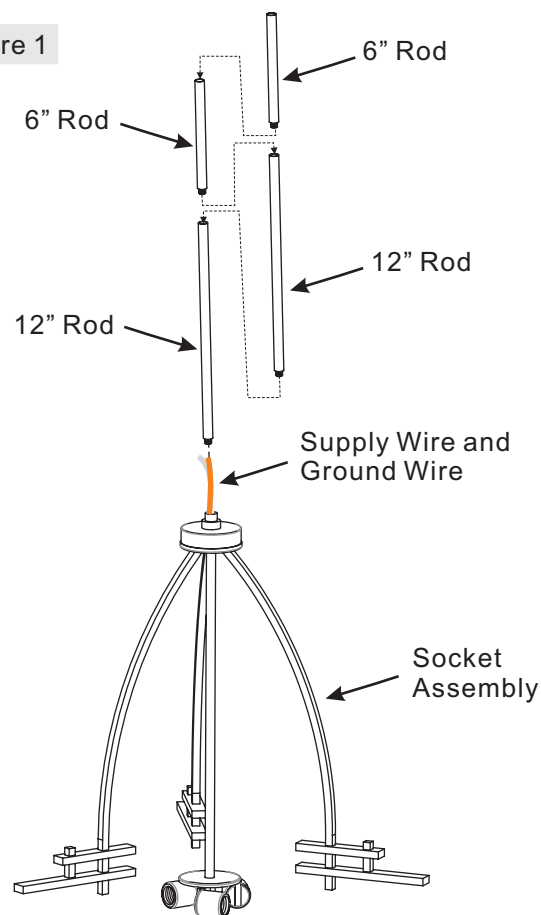

STEP 2 – Assemble Ceiling Canopy to Upper Rod

- A. Pass Supply Wires and Ground Wire through the Ceiling Canopy (H) and then thread the Ceiling Canopy (H) and the Upper Rod together. Hand tighten until snug.

Figure 2

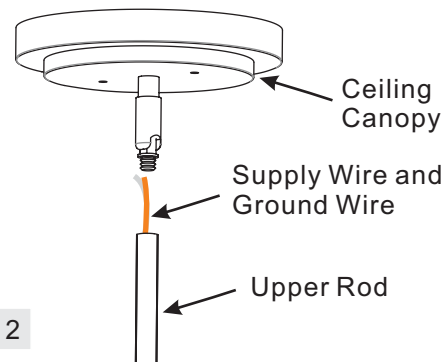

Thank you for purchasing a Quoizel product.
Need assistance with parts or assembly? Call Quoizel customer service at 1-631-273-2700
or visit us on-line at www.quoizel.com

Assembly Instruction Sheet #IS-BWN2822TM For Style BWN2822TM

STEP 3 – Attach Mounting Screws, Lock Washers and Hex Nuts to Crossbar

- A. Line up a set of holes on the Crossbar (A) and Holes on the Ceiling Canopy (H).
- B. Thread Mounting Screws (B) into the holes on the Crossbar (A), pass Lock Washers (C) and thread Hex Nut (D) onto the Mounting Screws (B). Hand tighten until snug.

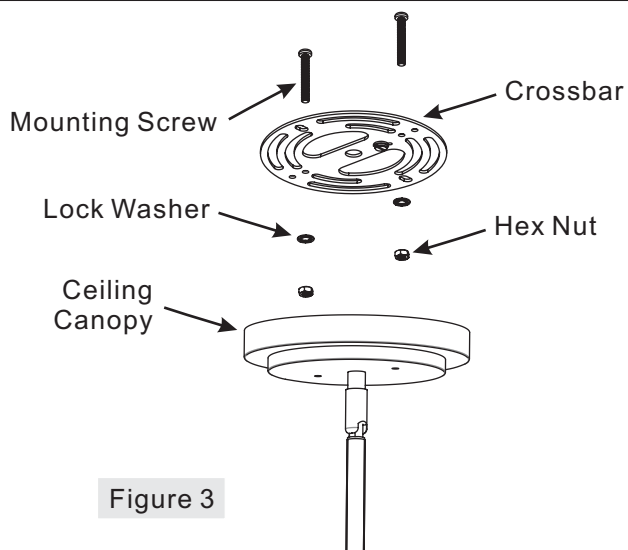

STEP 4 – Attach Crossbar to Outlet Box

- A. Attach the Crossbar (A) to Outlet Box and secure by threading Outlet Box Screws (not supplied) into the Mounting Holes on the Outlet Box. Tighten until snug.

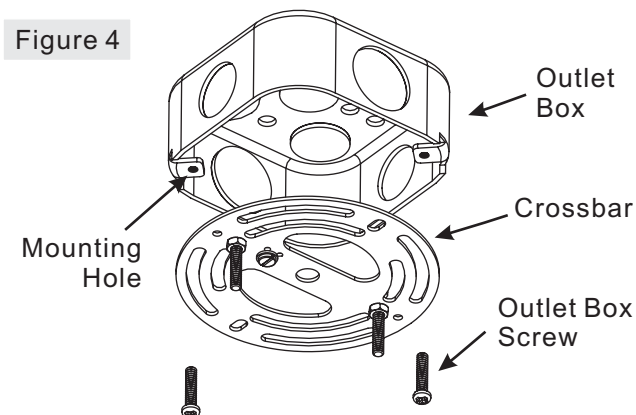

Thank you for purchasing a Quoizel product.
Need assistance with parts or assembly? Call Quoizel customer service at 1-631-273-2700
or visit us on-line at www.quoizel.com

Assembly Instruction Sheet #IS-BWN2822TM For Style BWN2822TM

STEP 5 – Make Wire Connections

- A. Use standard wire connectors to make all wire connections. (Connectors are not included with fixture.) Strip and prepare wire ends according to instructions supplied with connectors.
- B. Connect White Supply Wire from the Outlet Box to White Wire from fixture.
- C. Connect Black (or Red) Supply Wire from the Outlet Box to Black Wire from fixture.
- D. Connect Ground Wire from the Outlet Box to Ground Wire from fixture.
- E. Twist connectors until wires are tightly joined together.
- F. Wrap each connection with approved electrical tape and carefully stuff all the connected wires into the Outlet Box.

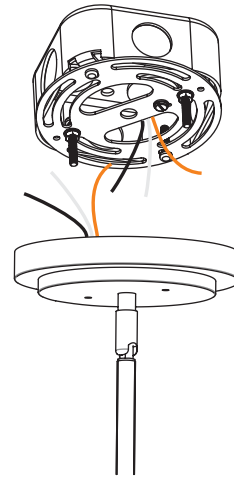

Figure 5

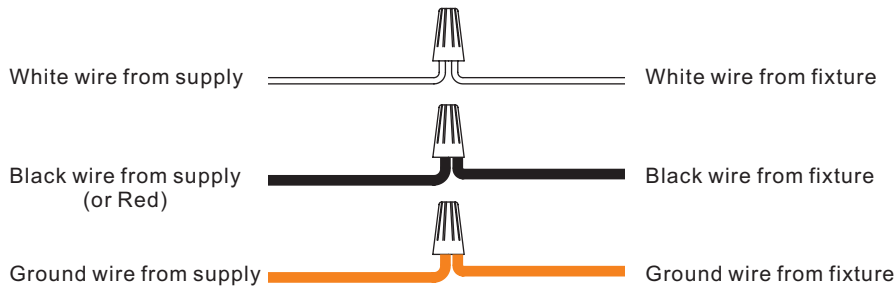

Figure 6

STEP 6 – Attach Ceiling Canopy to Mounting Screw

- A. Place the Ceiling Canopy (H) over the Mounting Screws (B) and secure with Mounting Balls (E). Hand tighten until snug.

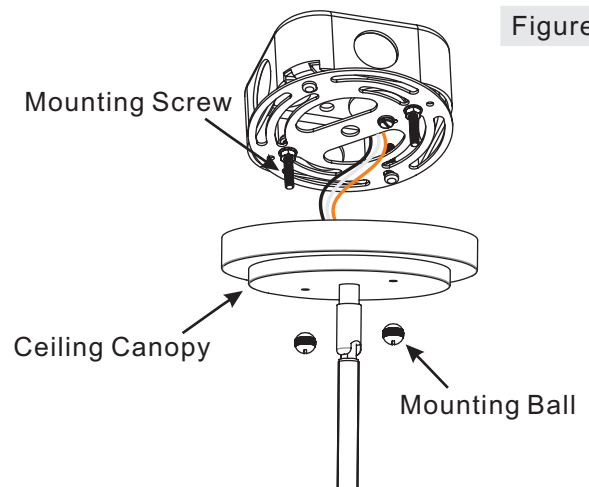

Figure 7

Thank you for purchasing a Quoizel product.

Need assistance with parts or assembly? Call Quoizel customer service at 1-631-273-2700
or visit us on-line at www.quoizel.com

Assembly Instruction Sheet #IS-BWN2822TM For Style BWN2822TM

STEP 7 – Attach Center Stem Assembly

- A. Thread top end of the Center Stem Assembly (F) into the Hex Coupling underside of the Socket Cluster. Hand tighten until snug.

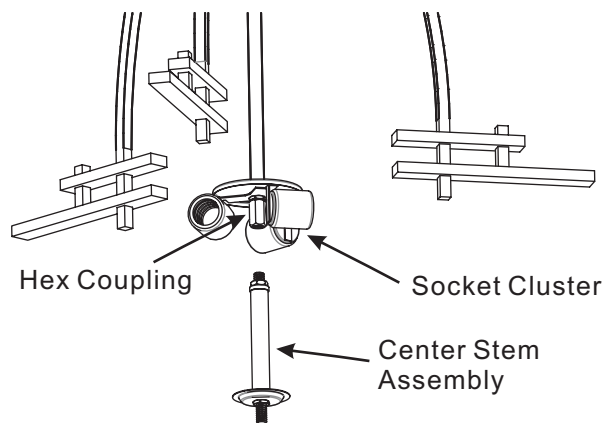

Figure 8

STEP 8 – Attach Shade

- A. Place the Shade (L) and the Shade Holder (M) over the end of the Center Stem Assembly (F), attach to the Shade Stop. Secure by threading the 1/8 IP Hex Nut (G) onto the Center Stem. Hand tighten until snug.

Note: Arms are design to sit on top of glass shade.
Minimum adjustment maybe needed to suit customer's needs.

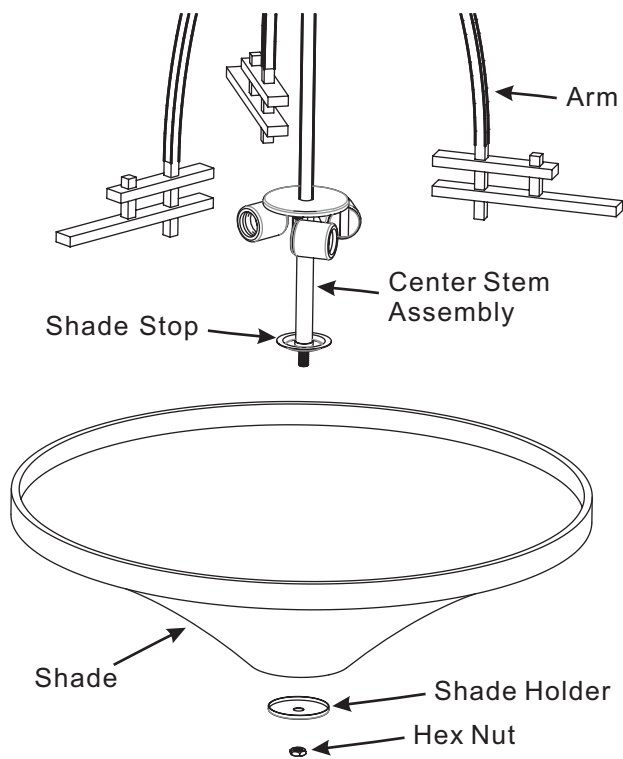

Figure 9

Thank you for purchasing a Quoizel product.
Need assistance with parts or assembly? Call Quoizel customer service at 1-631-273-2700
or visit us on-line at www.quoizel.com

Assembly Instruction Sheet #IS-BWN2822TM For Style BWN2822TM

STEP 9 – Attach Cap

- A. Place the Cap (N) over the Nipple extruding from the bottom center of the Shade (L). Secure by threading the Finial (O) onto the Nipple. Hand tighten until snug.

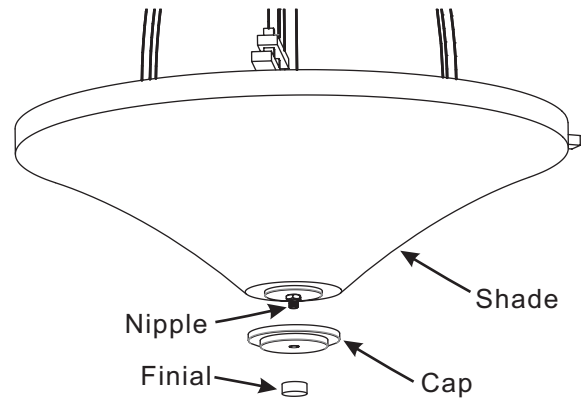

Figure 10

STEP 10 – Install Bulb

- A. This fixture uses standard bulb with a standard screw base. Maximum 100 watts.
B. Insert bulb and screw properly into place.

Your lamp pendant fixture is now assembled and ready to use. Enjoy!

Figure 11

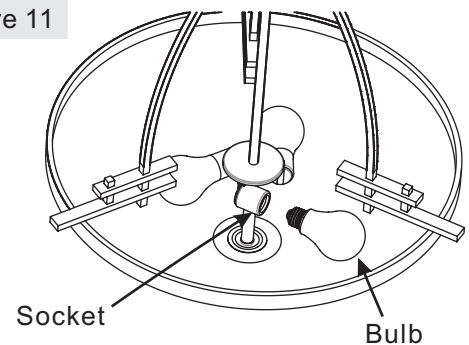

Thank you for purchasing a Quoizel product.
Need assistance with parts or assembly? Call Quoizel customer service at 1-631-273-2700
or visit us on-line at www. quoizel. com