

Quoizel, Inc.
6 Corporate Parkway
Goose Creek, SC
29445

Customer Service
Phone 631.273.2700
Fax 631.231.7102
www.quoizel.com

Assembly Instruction Sheet #IS-FMCN8612C For Style FMCN8612C

Tools Required: Flathead screwdriver, Phillips screwdriver, pliers, wire cutters, wire strippers, electrical tape, safety glasses.

Bulb Recommended: (2) G9 Base 75W Maximum

Estimated Assembly Time: 20-30 minutes

Preparation: Identify and inspect all parts before beginning installation. Check package content list and diagrams below to be sure all parts are present. If any parts are missing or damaged, do not attempt to assemble, install, or operate the fixture. Contact customer service for replacement parts.



Warnings and Cautions

Turn off electricity at circuit breaker or main fuse box before installation. Consult a licensed electrician if in doubt.

These instructions are provided for your safety. It is very important you read them completely before installing the fixture. We strongly recommend that a licensed, professional electrician perform the installation.

Disconnect fixture from power source before replacing bulbs. Make sure bulbs are given sufficient time to cool before removal. Do not subject glass parts to any shock while in operation or shattering may result.

Package Contents

Part	Description	Quantity
A	Inner Backplate	1 pc.
B	Mounting Screw	4 pcs.
C	Fixture Body	1 pc.
D	Bulb Shield	2 pcs.
E	Socket Collar	2 pcs.
F	Steel Collar	2 pcs.
G	G9 Bulb	2 pcs.
H	Socket Collar Tool	1 pc.
I	Shade	2 pcs.

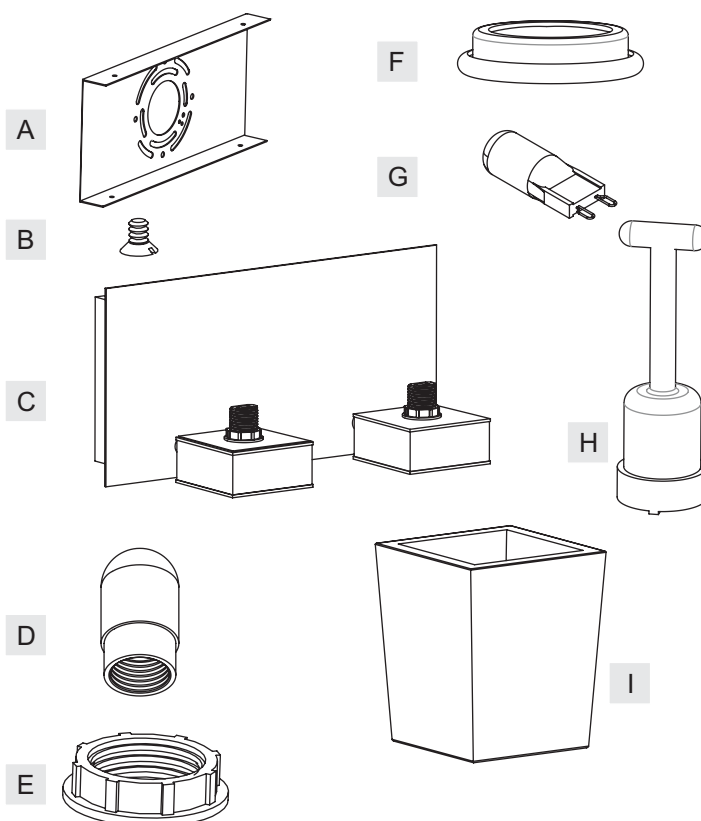

Thank you for purchasing a Quoizel product.

Need assistance with parts or assembly? Call Quoizel customer service at 1-631-273-2700
or visit us on-line at www.quoizel.com

FMCN8612C

FINISH: POLISHED CHROME

3

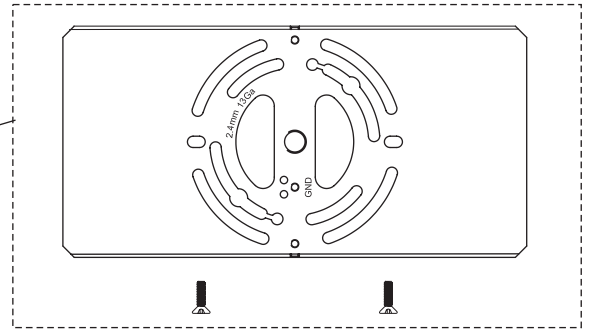

4

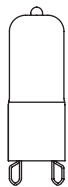
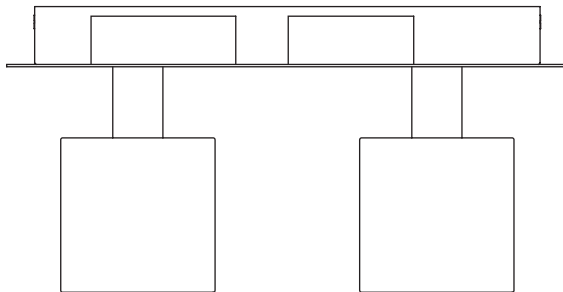
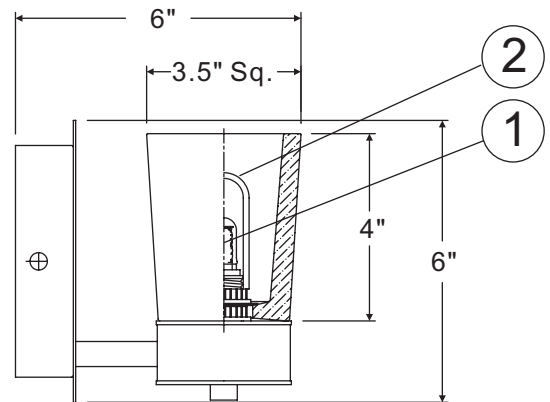
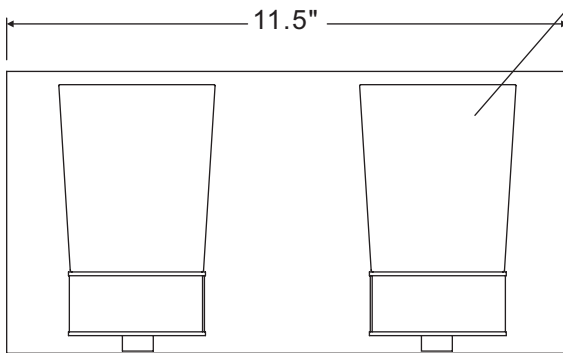

(2)75W Frosted G9
Halogen (Supplied)

NOTE: ALL DIMENSIONS ARE ROUNDED UP TO THE NEAREST 1/2"

NO.	PART NUMBER	REPLACEMENT PART DESCRIPTION	REQ.
1	I828SF	BULB 130V 75W HLGN G9 FROSTED	2
2	G2885BS	BULB SHIELD CLEAR 1"D X 2.5"H	2
3	9485KIT	MTG HARDWARE PLSH CHR 10"L	1
4	G2884SH	SHADE SQUARE CLEAR PRESSED GLS	2

Assembly Instruction Sheet #IS-FMCN8612C For Style FMCN8612C

STEP 1 – Attach Inner Backplate to Outlet Box

- A. Attach the Inner Backplate (A) to Outlet Box and secure by threading Outlet Box Screws (not supplied) into the Mounting Holes on the Outlet Box. Tighten until snug.

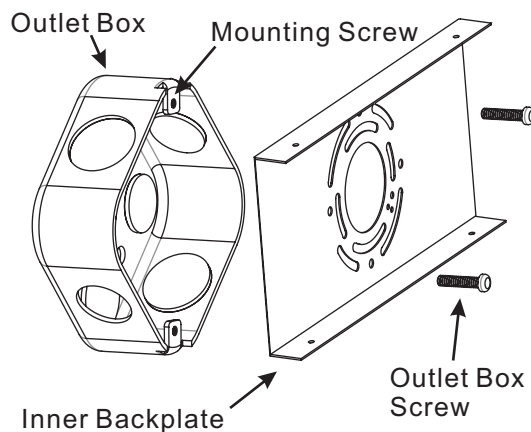

Figure 1

STEP 2 – Make Wire Connections

- A. Use standard wire connectors to make all wire connections. (Connectors are not included with fixture.) Strip and prepare wire ends according to instructions supplied with connectors.
- B. Connect White Supply Wire from the Outlet Box to White Wire from Flip Switch Device.
- C. Connect Black (or Red) Supply Wire from the Outlet Box to Black Wire from Flip Switch Device.
- D. Connect Ground Wire from the Outlet Box to Green Ground Screw on Fixture Body (B).
- E. Twist connectors until wires are tightly joined together.
- F. Wrap each connection with approved electrical tape and carefully stuff all the connected wires into the Outlet Box.

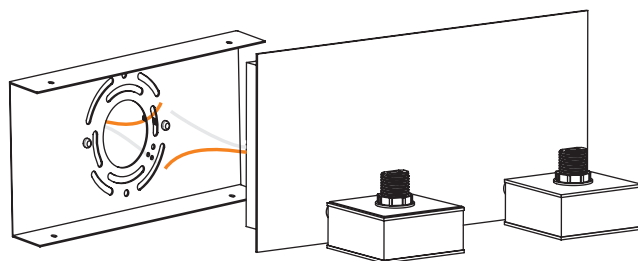

Figure 2

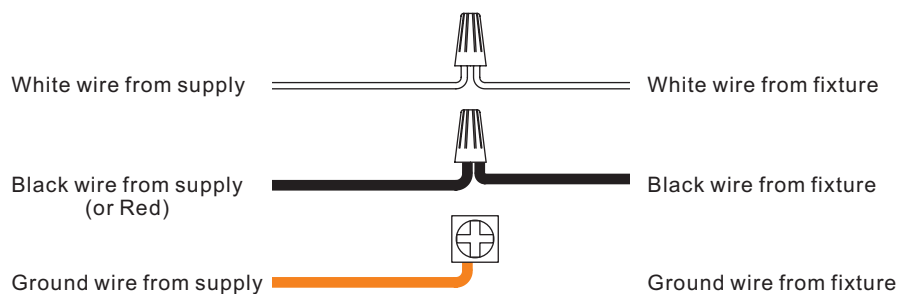

Figure 3

Thank you for purchasing a Quoizel product.

Need assistance with parts or assembly? Call Quoizel customer service at 1-631-273-2700
or visit us on-line at www. quozel. com

Assembly Instruction Sheet #IS-FMCN8612C For Style FMCN8612C

STEP 3 – Attach Fixture Body to Inner Backplate

- A. Place the Backplate of the Fixture Body (C) onto the Inner Backplate (A). Line up holes on both of them. Thread Mounting Screws (B) into the mounting holes on the Inner Backplate (A) and hand tighten until snug to secure them.

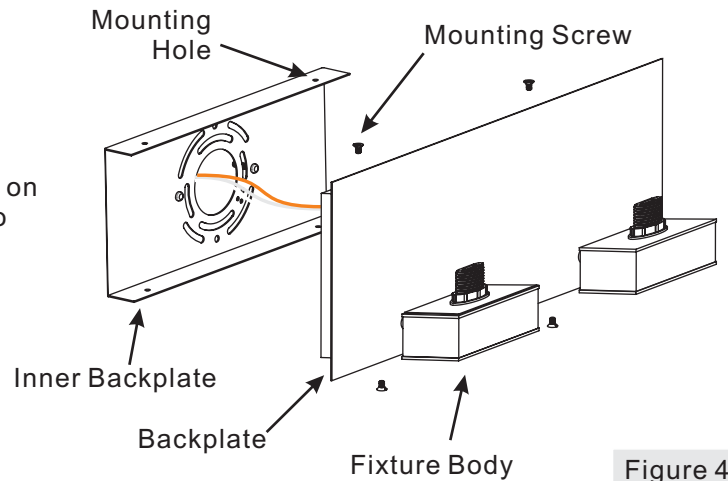

Figure 4

STEP 4 – Attach Shade to Socket

- A. Place the Shade (I) and the Steel Collar (F) over the Socket as shown. By using the Socket Collar Tool (H), thread the Socket Collar (E) onto the Socket to secure the Shade (I). Hand tighten until snug.

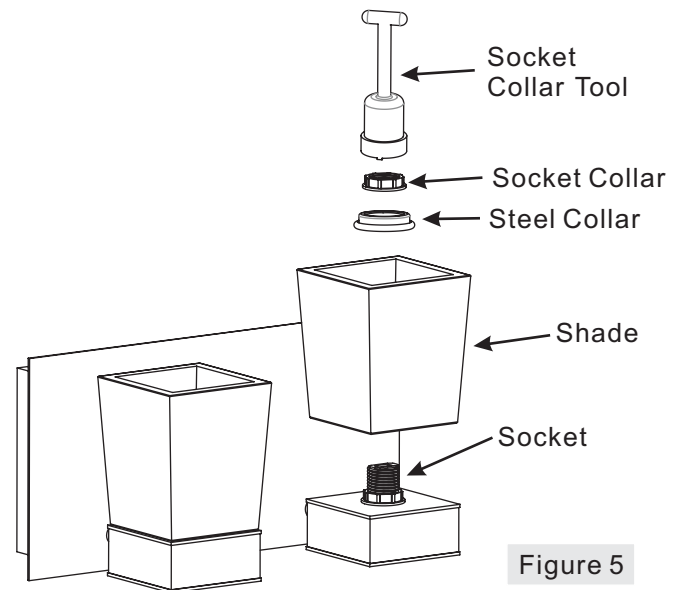

Figure 5

STEP 5 – Install Bulb and Bulb Shield

- A. This fixture uses Frosted G9 Halogen Bulbs. Maximum 75 watts.
B. Insert bulb and seat properly into place.
C. Screw Bulb Shield (D) onto the Socket and hand tighten until snug.

Your fixture is now assembled and ready to use.
Enjoy!

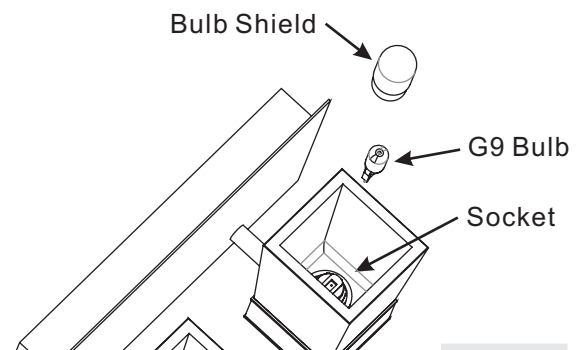

Figure 6

Thank you for purchasing a Quoizel product.

Need assistance with parts or assembly? Call Quoizel customer service at 1-631-273-2700
or visit us on-line at www. quoizel. com

Assembly Instruction Sheet #IS-FMCN8612C For Style FMCN8612C

SWITCHING MODE

The switching features of the product allows for you to change your lighting mode from halogen to LED.

STEP 6:

- a. Flip the switch "ON" and the halogen lamps illuminates.

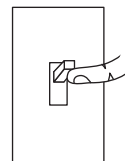

ON...

STEP 7:

- a. Flip the switch "OFF" to turn off the halogen lamps for one second.

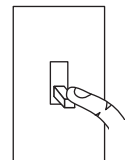

...One Second
OFF then...

STEP 8:

- a. Flip the switch "ON" to turn the LED lamps ON.

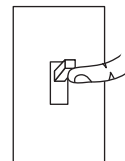

...Back ON...

STEP 9:

- a. Flip the switch "OFF" to turn off LED lamps.

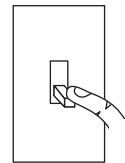

...OFF

STEP 10:

- a. Sequence begins over.

Note: When no switch has occurred for 30 minutes, the halogen lights are programmed to come on first.

CAUTION FOR BULB REPLACING

- A. When replace bulb, turn off power and allow lamp to cool. For safety purpose, wear gloves and eye protection.
- B. If bulb is scratched or cracked, DO NOT use the lamp to avoid breakage during use or installation.
- C. Use only in fixtures rated for lamps wattage and voltage.
- D. Lamp operate under high pressure generating intense heat. Prevent contact with liquid and combustible materials.

Thank you for purchasing a Quoizel product.

Need assistance with parts or assembly? Call Quoizel customer service at 1-631-273-2700
or visit us on-line at www.quoizel.com