

Quoizel, Inc.  
6 Corporate Parkway  
Goose Creek, SC  
29445

Customer Service  
Phone 631.273.2700  
Fax 631.231.7102  
www. quoizel. com

## Assembly Instruction Sheet #IS- FQ1914AW01 For Style FQ1914AW01

**Tools Required:** Flathead screwdriver, Phillips screwdriver, pliers, wire cutters, wire strippers, electrical tape, safety glasses.

**Bulb Recommended:** (4) Candelabra Base 60W Maximum,

**Estimated Assembly Time:** 20-30 minutes

**Preparation:** Identify and inspect all parts before beginning installation. Check package content list and diagrams below to be sure all parts are present. If any parts are missing or damaged, do not attempt to assemble, install, or operate the fixture. Contact customer service for replacement parts.



### Warnings and Cautions

Turn off electricity at circuit breaker or main fuse box before installation. Consult a licensed electrician if in doubt.

These instructions are provided for your safety. It is very important you read them completely before installing the fixture. We strongly recommend that a licensed, professional electrician perform the installation.

Disconnect fixture from power source before replacing bulbs. Make sure bulbs are given sufficient time to cool before removal. Do not subject glass parts to any shock while in operation or shattering may result.

Thank you for purchasing a Quoizel product.

Need assistance with parts or assembly? Call Quoizel customer service at 1-631-273-2700  
or visit us on-line at [www. quoizel. com](http://www. quoizel. com)

FQ1914AW01

FINISH: ANTIQUE BROWN

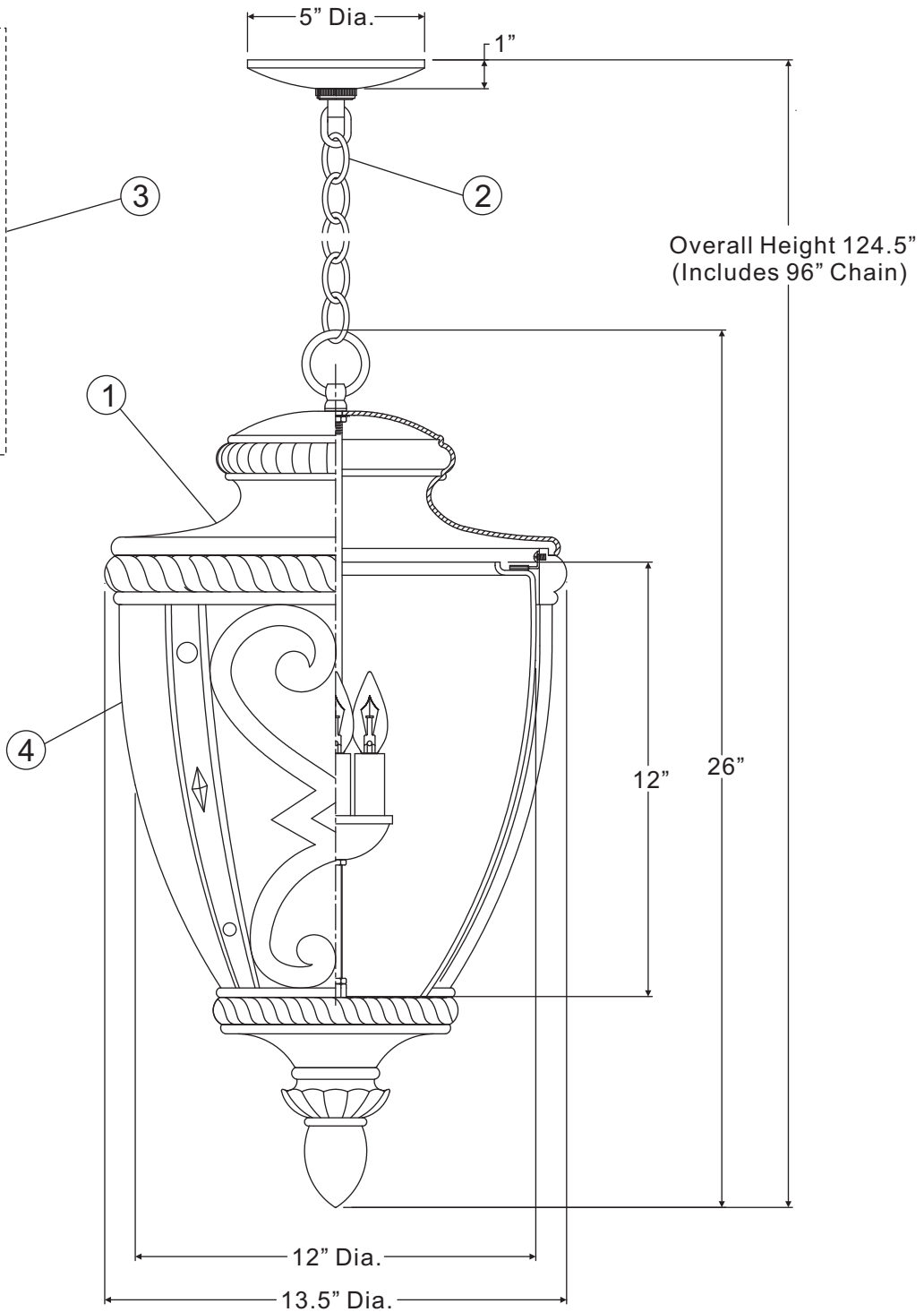
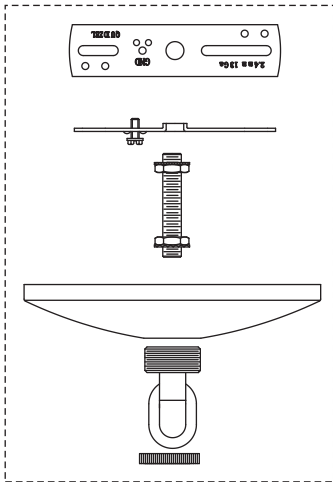

Overall Height 124.5"  
(Includes 96" Chain)

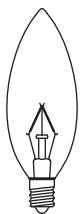

(4) 60W candelabra  
base bulbs  
(not supplied)

NOTE: ALL DIMENSIONS ARE ROUNDED UP TO THE NEAREST 1/2"

NO.	PART NUMBER	REPLACEMENT PART DESCRIPTION	REQ.
1	11914AW01FQ	BASE ANTIQUE BROWN FQ1914AW01	1
2	M1708CHAW	CHAIN ANTIQUE BROWN 3.8MM X 4'	1
3	9018KIT	MOUNTING HARDWARE ANTIQUE BROWN 5D	1
4	G2386SH	SHADE GLASS AMBER SEEDY 12"D	1

# Assembly Instruction Sheet #IS- FQ1914AW01

## For Style FQ1914AW01

### Package Contents

Part	Description	Quantity
A	Crossbar	1 pc.
B	Nipple(long)	1 pc.
C	Lock Washer	2 pcs.
D	Hex Nut	4 pcs.
E	Canopy Chain Loop	1 pc.
F	Canopy Lock Ring	1 pc.
G	Fixture Chain	1 pc.
H	Ceiling Canopy	1 pc.
I	Fixture Hood Assembly	1 pc.
J	Tab	4 pcs.
K	Screw	4 pcs.
L	Shade	1 pc.
M	Cage	1 pc.
N	Fixture Cover	1 pc.
O	Hex Coupling	1 pc.
P	Nipple (short)	1 pc.
Q	Finial	1 pc.

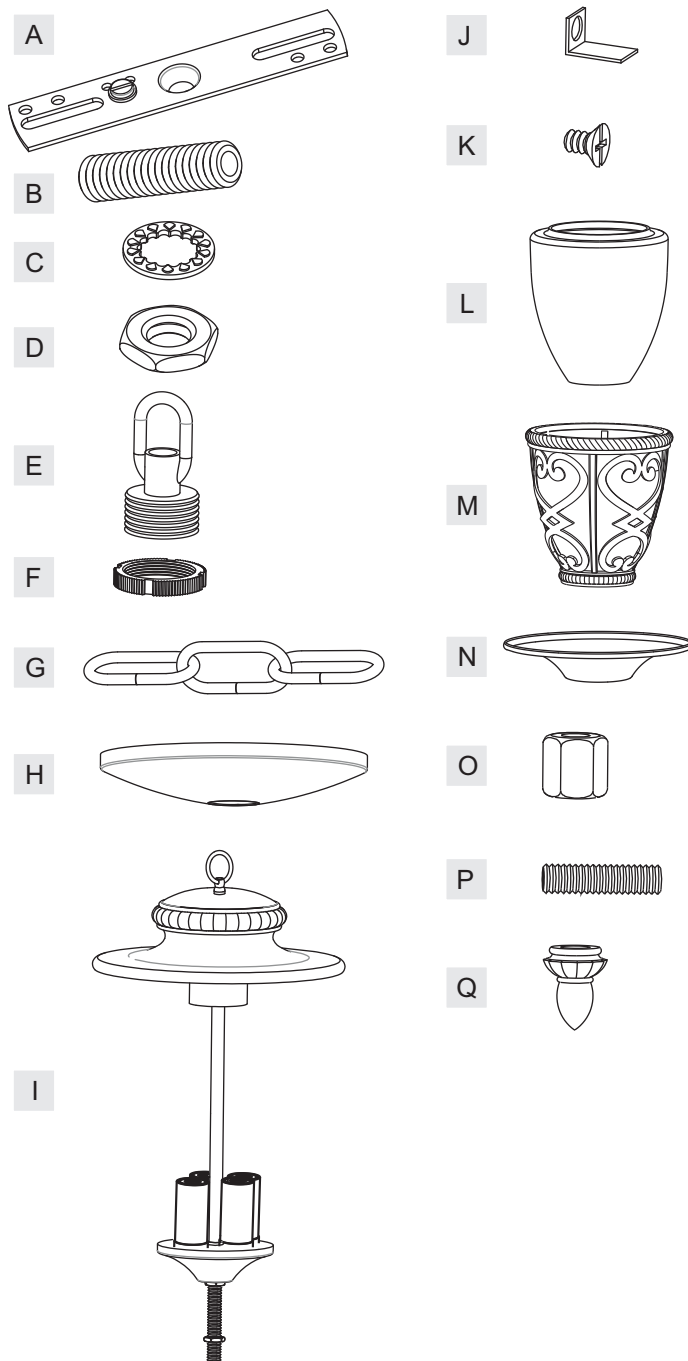

Thank you for purchasing a Quoizel product.

Need assistance with parts or assembly? Call Quoizel customer service at 1-631-273-2700  
or visit us on-line at [www. quoizel. com](http://www. quoizel. com)

# Assembly Instruction Sheet #IS- FQ1914AW01

## For Style FQ1914AW01

### STEP 1 – Attach Shade to Cage

- A. Place the Shade (L) inside of the Cage (M) properly. Place the Tab (J) pinned the Shade (L). By using the screwdriver, thread the Screw (K) into the lock hole inside of Cage (M) to secure the Shade (L). Tighten until snug.

Figure 1

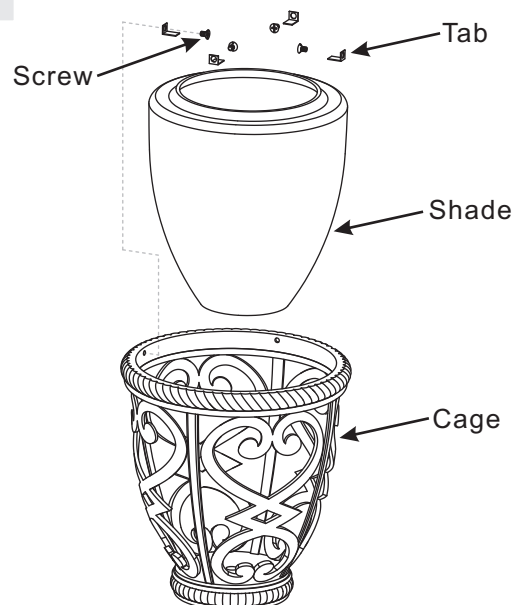

### STEP 2 – Install Bulb

- A. This fixture uses standard bulb with a candelabra screw base. Maximum 60 watts.  
B. Place the bulb from the bottom of the glass frame. Insert bulb and screw snugly into place.

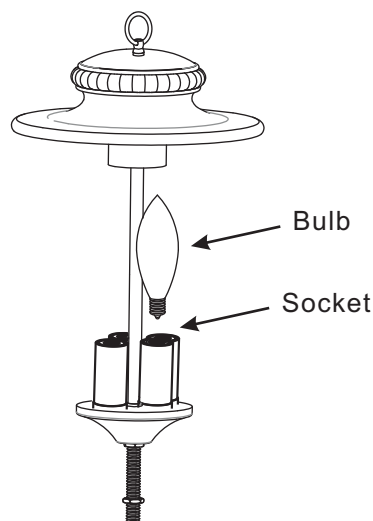

Thank you for purchasing a Quoizel product.

Need assistance with parts or assembly? Call Quoizel customer service at 1-631-273-2700  
or visit us on-line at [www.quoizel.com](http://www.quoizel.com)

# Assembly Instruction Sheet #IS- FQ1914AW01

## For Style FQ1914AW01

### STEP 3 – Attach Cage to Fixture Hood Assembly

- Adjust the Hex Nut on the Nipple to proper location for the Cage. Locate the Center Hole on the bottom bar of the Cage (M) over the Nipple on the bottom center of the Junction Box. Secure with Hex Nut (D). Tighten gently until snug.
- Locate the Fixture Cover (N) over the Nipple and secure with the Hex Coupling (O). Tighten until snug.

Figure 3

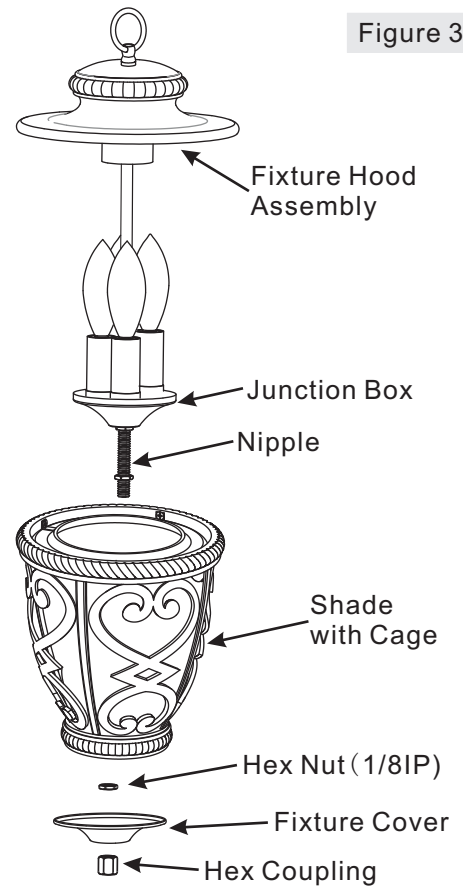

### STEP 4 – Attach Finial to Cage

- Thread the Hex Nut (D) onto one end of the Nipple .
- Thread the Nipple (P) into the Hex Coupling (O). By using pliers thread the Hex Nut (D) against the Hex Coupling (O) and hand tighten until snug.
- Thread the Finial (Q) onto the end of the Nipple (P) and hand tighten until snug.

Figure 4

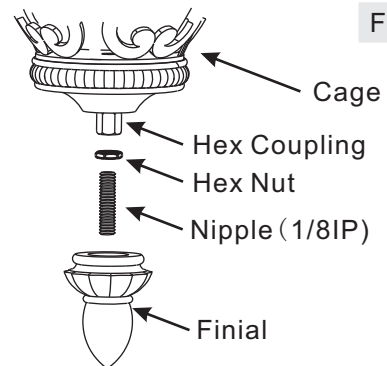

Thank you for purchasing a Quoizel product.

Need assistance with parts or assembly? Call Quoizel customer service at 1-631-273-2700  
or visit us on-line at [www.quoizel.com](http://www.quoizel.com)

# Assembly Instruction Sheet #IS- FQ1914AW01

## For Style FQ1914AW01

### STEP 5 – Attach Crossbar to Outlet Box

- A. Secure the Corssbar (A) to the outlet box with outlet box screws (not supplied). Tighten until snug.

Figure 5

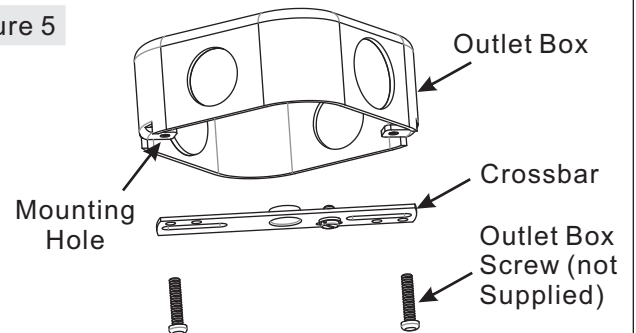

### STEP 6 – Attach Nipple to Crossbar

- A. Thread one Hex Nut (D) onto the top end of the Nipple (B).  
B. Place one Lock Washer (C) over the top end of the Nipple (B) and then thread the Nipple (B) into the center lock hole of the Crossbar (A).  
C. Using pliers, thread the hex Nut (D) against the Crossbar (A) and hand tighten until snug.

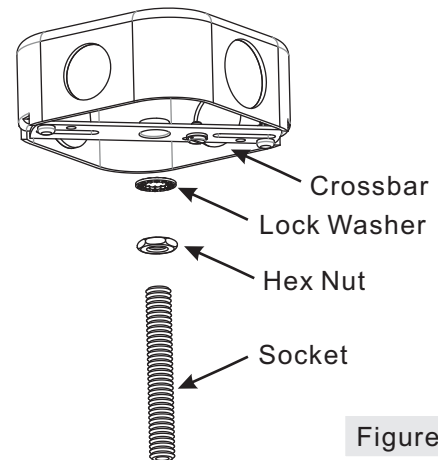

Figure 6

### STEP 7 – Attach Canopy Chain Loop to Nipple

- A. Thread another Hex Nut (D) onto the end of the Nipple (B).  
B. Place the Lock Washer (C) over the end of the Nipple (B) and then thread the Canopy Chain Loop (E) onto the end of the Nipple (B).  
C. Using pliers, thread the Hex Nut (D) against the Canopy Chain Loop (E) and hand tighten until snug.

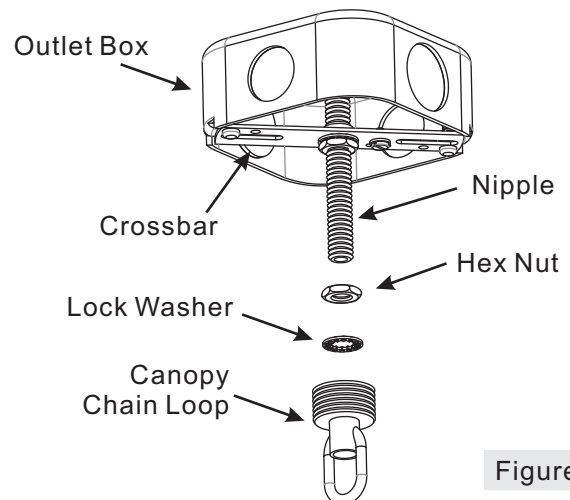

Figure 7

Thank you for purchasing a Quoizel product.

Need assistance with parts or assembly? Call Quoizel customer service at 1-631-273-2700  
or visit us on-line at [www.quoizel.com](http://www.quoizel.com)

## Assembly Instruction Sheet #IS- FQ1914AW01 For Style FQ1914AW01

### STEP 8 – Assemble Ceiling Canopy

- A. Push the Ceiling Canopy (H) upward over the Outlet Box. Thread the Canopy Lock Ring (F) onto the Canopy Chain Loop (E) and tighten until snug to secure the Ceiling Canopy (H).

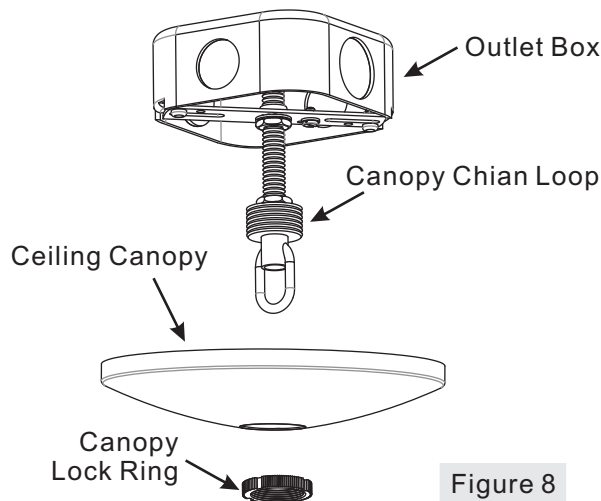

Figure 8

### STEP 9 – Attach Fixture Chain to Canopy Chain Loop and Fixture Loop

- A. Adjust the Fixture Chain (G) to your desired length by removing the links if needed. You may need to use plier to open the chain links. If so, put a cloth over the chain to protect the finish from the pliers.
- B. Attach one end of the Fixture Chain (G) onto the Canopy Chain Loop (E) and then attach the other end of the Fixture Chain (G) onto the Fixture Loop on the top of the fixture.

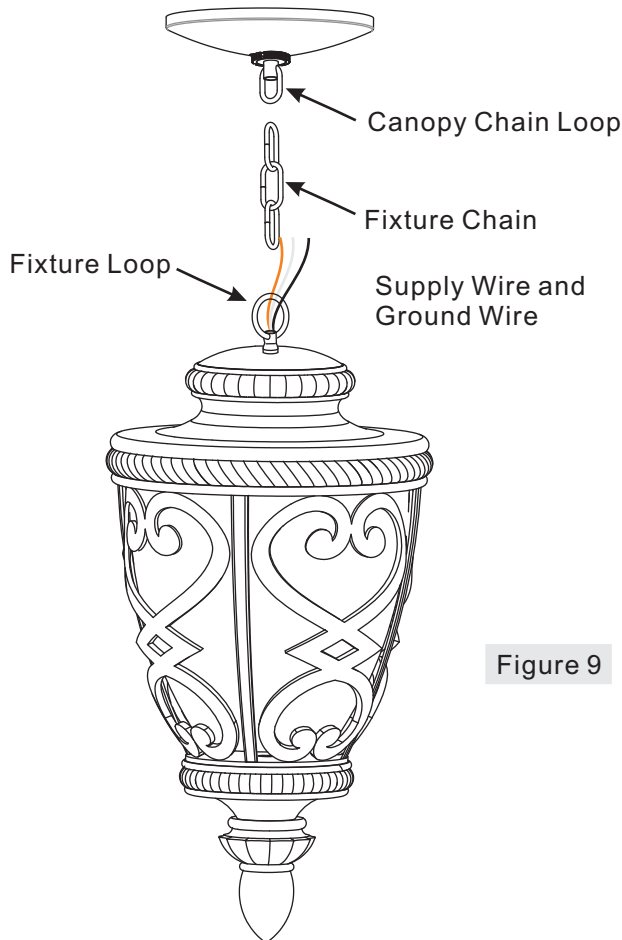

Figure 9

Thank you for purchasing a Quoizel product.  
Need assistance with parts or assembly? Call Quoizel customer service at 1-631-273-2700  
or visit us on-line at [www.quoizel.com](http://www.quoizel.com)

# Assembly Instruction Sheet #IS- FQ1914AW01

## For Style FQ1914AW01

### STEP 10 – Pass Supply Wires through Fixture Chain

- A. Pull the Supply Wires and Ground Wire up through the Fixture Chain (G) alternating links. Push the wires up through the Canopy Chain Loop (E) into the outlet box.

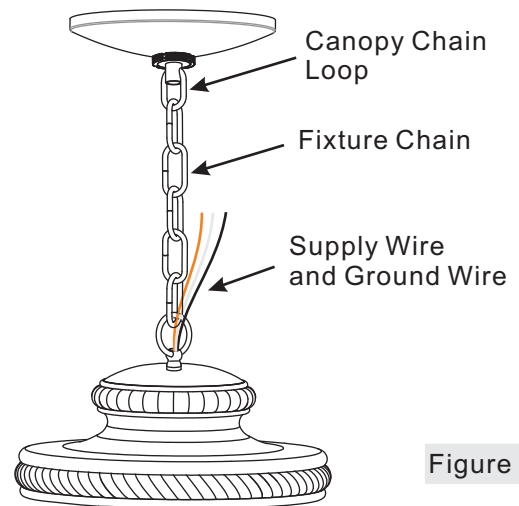

Figure 10

### STEP 11 – Make Wire Connections

- A. Un-thread the Canopy Lock Ring (F) and slide Canopy Lock Ring (F) and Ceiling Canopy (H) down the Fixture Chain (G).  
B. Push all slack fixture wire through Canopy Chain Loop (E) into Outlet Box. Trim excess fixture wire leaving a minimum of 6 inch. Hanging out of the Outlet Box.  
C. Use standard wire connectors to make all wire connections. (Connectors are not included with fixture.) Strip and prepare wire ends according to instructions supplied with connectors.  
D. Connect White Supply Wire from the Outlet Box to White Wire from fixture.  
E. Connect Black (or Red) Supply Wire from the Outlet Box to Black Wire from fixture.  
F. Connect Ground Wire from the Outlet Box to Ground Wire from fixture.  
G. Twist connectors until wires are tightly joined together.  
H. Wrap each connection with approved electrical tape and carefully stuff all the connected wires into the Outlet Box.  
G. Re-attach the Ceiling Canopy (H) as shown in Step 8.

Your fixture is now assembled and ready to use.  
Enjoy!

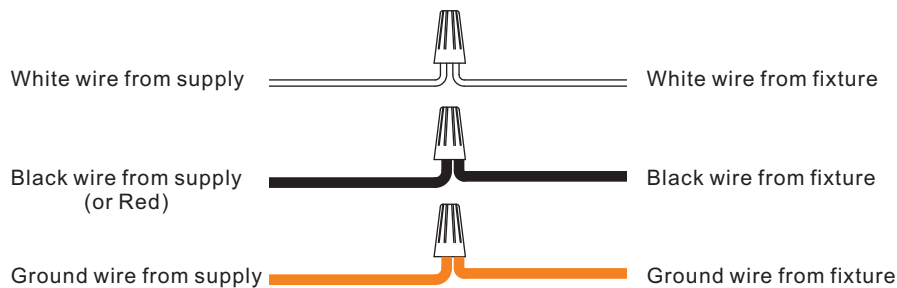

Figure 11

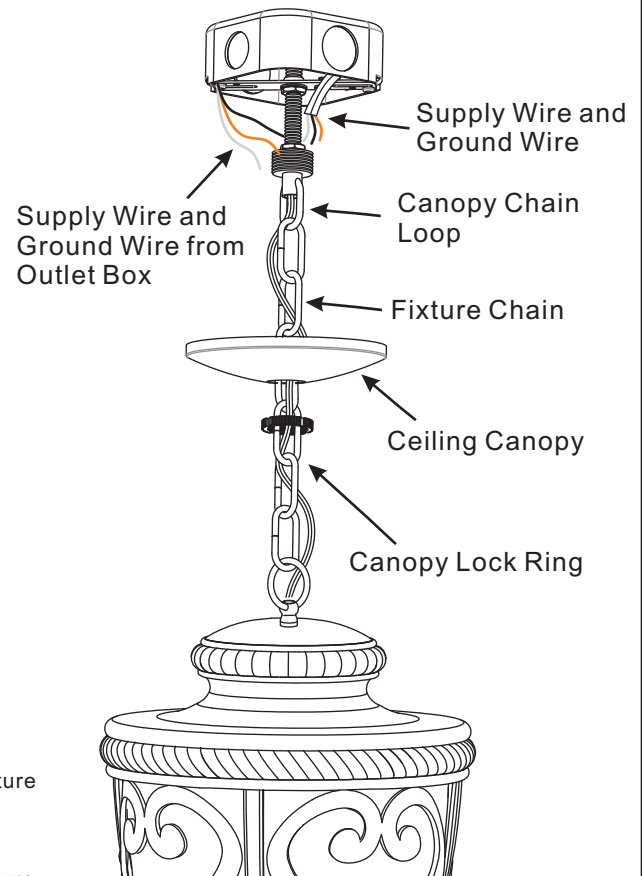

Figure 12

**Thank you for purchasing a Quoizel product.**

**Need assistance with parts or assembly? Call Quoizel customer service at 1-631-273-2700  
or visit us on-line at [www.quoizel.com](http://www.quoizel.com)**