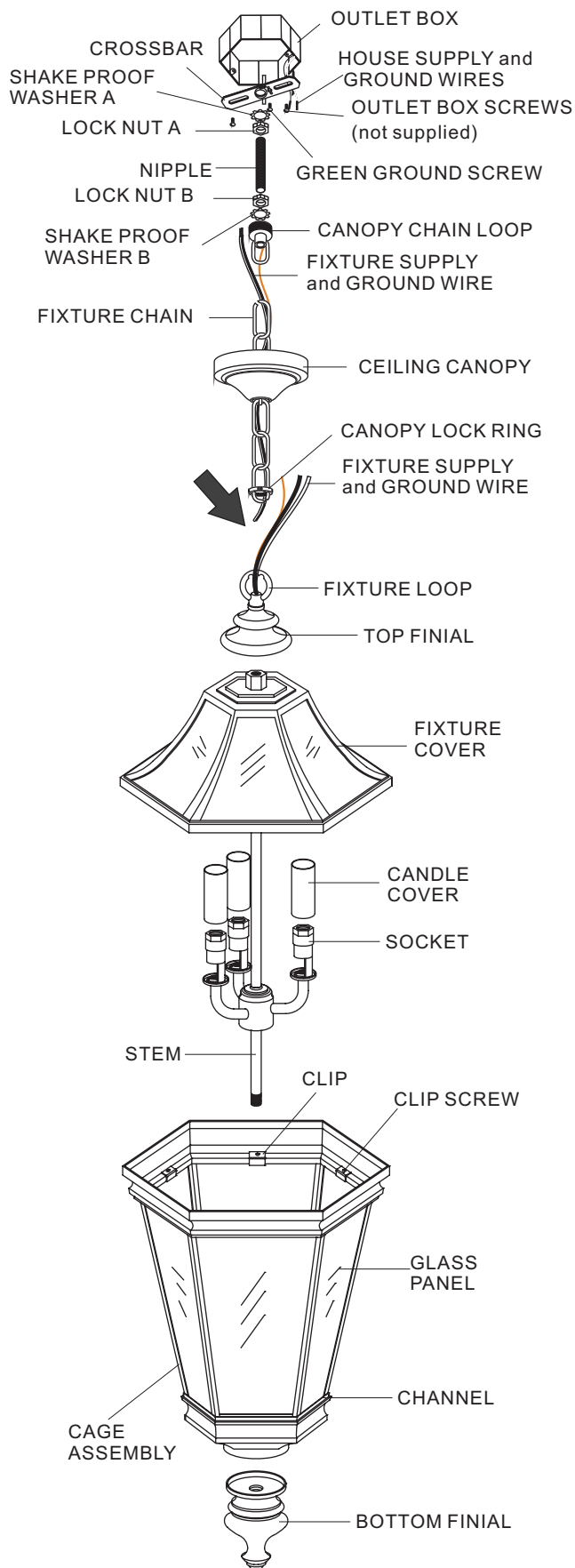

**FIGURE1**



## **INSTALLATION INSTRUCTIONS:**

1. Before beginning the installation, carefully unpack and identify all parts, referring to the illustration (FIGURE1).
2. Turn power to the installation point OFF at circuit breaker.
3. Unravel the FIXTURE GROUND SUPPLY and GROUND WIRE. Locate the TOP FINIAL and pass wires through center. Thread the TOP FINIAL into the center of COUPLING. Hand tighten until snug. Locate the CANDLE COVERS and pass over the SOCKETS. Install bulbs referring to fixture markings and/or labels for maximum wattage.
4. Locate the CAGE ASSEMBLY. Place the FIXTURE COVER over CAGE ASSEMBLY so that underside of cover engage top of assembly. Locate the BOTTOM FINIAL and thread onto the end of STEM protruding from the underside of CAGE ASSEMBLY. Hand tighten until snug to complete fixture assembly.
5. Fasten the CROSSBAR to the OUTLET BOX with (2) OUTLET BOX SCREWS (not supplied). Proceed to thread LOCK NUT A and SHAKE PROOF WASHER A onto the top end of NIPPLE. Thread NIPPLE into the center of CROSSBAR. Locate the LOCK NUT B onto the bottom end of the NIPPLE. Tighten LOCK NUT A against CROSSBAR with plier until snug.
6. Locate the FIXTURE CHAIN and determine desired hanging height of fixture. Adjust chain by removing links if needed. Please note that depending on chain material thickness, you might be required to use chain pliers to spread links open. Proceed to attach one end of chain to FIXTURE LOOP, attached to top of fixture. Pass the fixture wires through FIXTURE CHAIN alternating links. Proceed to pass the fixture wires through the following mounting components in this order: 1) CANOPY LOCK RING; 2) CEILING CANOPY; 3) CANOPY CHAIN LOOP; 4) SHAKE PROOF WASHER B and LOCK NUT B; 5) NIPPLE; 6) LOCK NUT A and SHAKE PROOF WASHER A.
7. **Making the connections:** (2 people recommended for the remaining steps) Position the fixture under the ceiling mounted outlet box. Pass SHAKE PROOF WASHER B over the NIPPLE. Thread CANOPY CHAIN LOOP onto NIPPLE. Thread LOCK NUT B down the NIPPLE, against the CANOPY CHAIN LOOP and snug with pliers. Pass the wires through the NIPPLE. Take up wire slack and trim wires so that approx. 6" will remain inside outlet box. Proceed to attach the top of the FIXTURE CHAIN to the bottom of the CANOPY CHAIN LOOP. Using wire connectors (not supplied) connect the HOUSE GROUND WIRE to the FIXTURE GROUND WIRE; connect the HOUSE WHITE WIRE to the FIXTURE SUPPLY WIRE (WHITE or RIBBED SIDE); connect the HOUSE BLACK (or RED) WIRE to the FIXTURE SUPPLY WIRE (BLACK or SMOOTH SIDE). Wrap each connection with approved electrical tape.
8. With the proper connections made, proceed to push the CEILING CANOPY upward over the OUTLET BOX. Be sure that all wires are carefully tucked into the OUTLET BOX cavity. Secure canopy against ceiling by threading CANOPY LOCK RING onto the CANOPY LOOP. Tighten until snug.
9. Restore power to the installation point ON. Retain this sheet for future reference.

## **GLASS PANEL and GLASS HALVES REPLACEMENTS:**

1. Turn power to the installation point OFF. Depending on extent of fixture damage, it may be advisable to remove fixture from installation point. **Be sure to wear safety gloves and eye protection when handling damaged fixtures.**
2. Remove the CAGE ASSEMBLY by loosening and removing the BOTTOM FINIAL. Using a screw driver, remove the CLIP SCREWS and CLIPS supporting GLASS PANEL that needs replacing. Place bottom end of REPLACEMENT GLASS PANEL into support CHANNEL. Re-install CLIP and CLIP SCREW. Note: CAGE ASSEMBLY must be removed for glass panel replacement in FIXTURE COVER.
3. (Refer to FIGURE2) Using a screw driver, loosen and remove the LOCK SCREWS and TABS supporting the GLASS.

**FIGURE2** (for replacement GLASS HALVES)

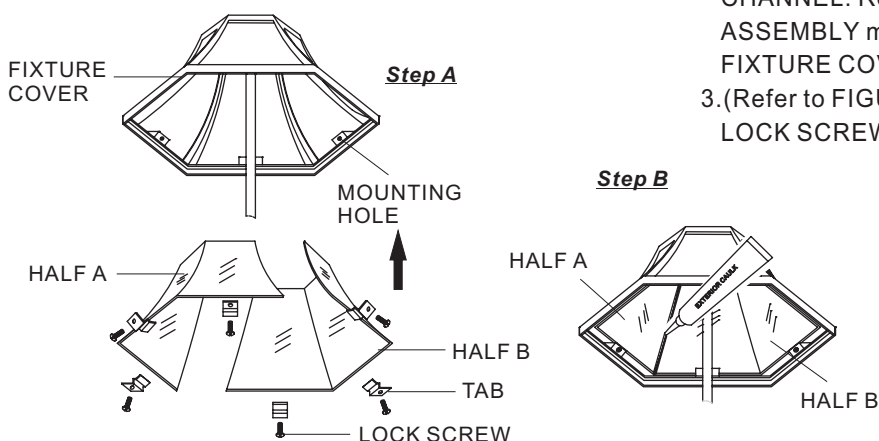

Place HALF A and HALF B upward inside the FIXTURE COVER. Re-install the TABS and LOCK SCREWS and hand tighten until snug.

4. Refer to STEP B, FIGURE2, using EXTERIOR GRADE CAULK, caulk over the seams between HALF A and HALF B.
5. Reinstall all parts and restore power to installation point ON. Note: If fixture was completely removed from installation point for service be sure to follow wiring instructions listed above.

**IF IN DOUBT ABOUT ELECTRICAL INSTALLATION, CONSULT A LICENSED ELECTRICIAN!**