

# QUOIZEL

6 CORPORATE PARKWAY  
GOOSE CREEK, SC. 29445  
www.quoizel.com

Quoizel, Inc.  
6 Corporate Parkway  
Goose Creek, SC  
29445

Customer Service  
Phone 631.273.2700  
Fax 631.231.7102  
www.quoizel.com

## Assembly Instruction Sheet #IS-MCDL2818PN For Style MCDL2818PN

**Tools Required:** Flathead screwdriver, Phillips screwdriver, pliers, wire cutters, wire strippers, electrical tape, safety glasses.

**Bulb Recommended:** (4) Medium Base 60W Maximum

**Estimated Assembly Time:** 20-30 minutes

**Preparation:** Identify and inspect all parts before beginning installation. Check package content list and diagrams below to be sure all parts are present. If any parts are missing or damaged, do not attempt to assemble, install, or operate the fixture. Contact customer service for replacement parts.



### Warnings and Cautions

Turn off electricity at circuit breaker or main fuse box before installation. Consult a licensed electrician if in doubt.

These instructions are provided for your safety. It is very important you read them completely before installing the fixture. We strongly recommend that a licensed, professional electrician perform the installation.

Disconnect fixture from power source before replacing bulbs. Make sure bulbs are given sufficient time to cool before removal. Do not subject glass parts to any shock while in operation or shattering may result.

### Package Contents

Part	Description	Quantity
A	Crossbar	1 pc.
B	Mounting Screw	2 pcs.
C	Lock Washer	2 pcs.
D	Hex Nut	2 pcs.
E	Mounting Ball	2 pcs.
F	Flat Washer	1 pc.
G	Rubber Washer	1 pc.
H	1/8 IP Hex Nut	1 pc.
I	Ceiling Canopy	1 pc.
J	Mica Shade Assembly	1 pc.
K	6" Rod	2 pcs.
L	12" Rod	2 pcs.
M	Metal Shade	1 pc.
N	Diffuser	1 pc.
O	Stem	1 pc.
P	Finial	1 pc.

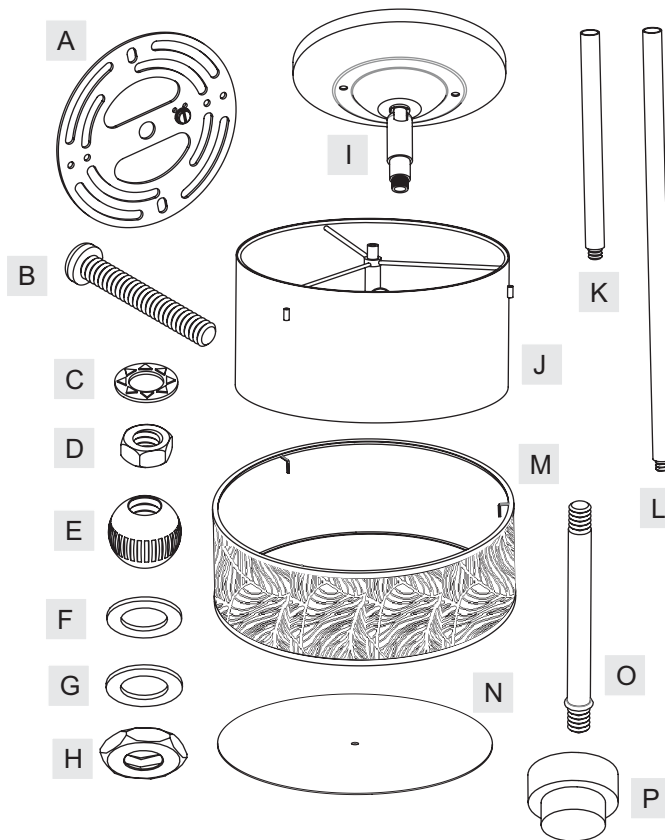

Thank you for purchasing a Quoizel product.

Need assistance with parts or assembly? Call Quoizel customer service at 1-631-273-2700  
or visit us on-line at [www.quoizel.com](http://www.quoizel.com)

MCDL2818PN

FINISH: PALLADIAN BRONZE

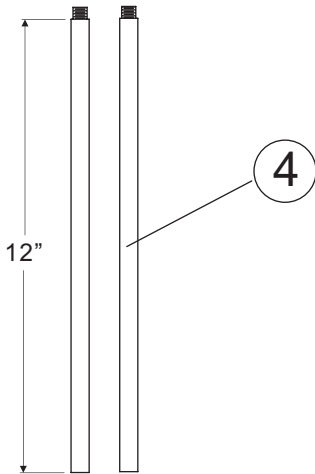
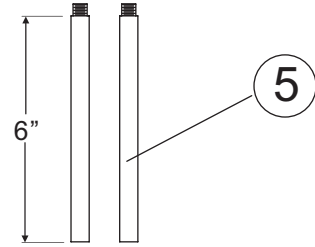

3

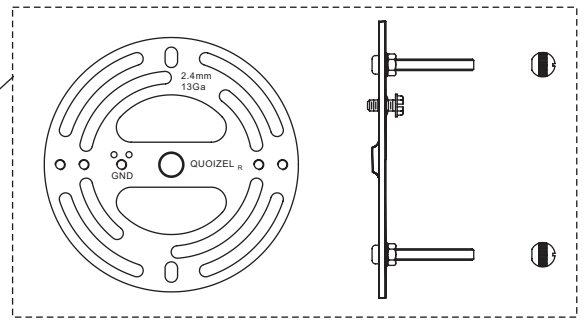

4

7

6

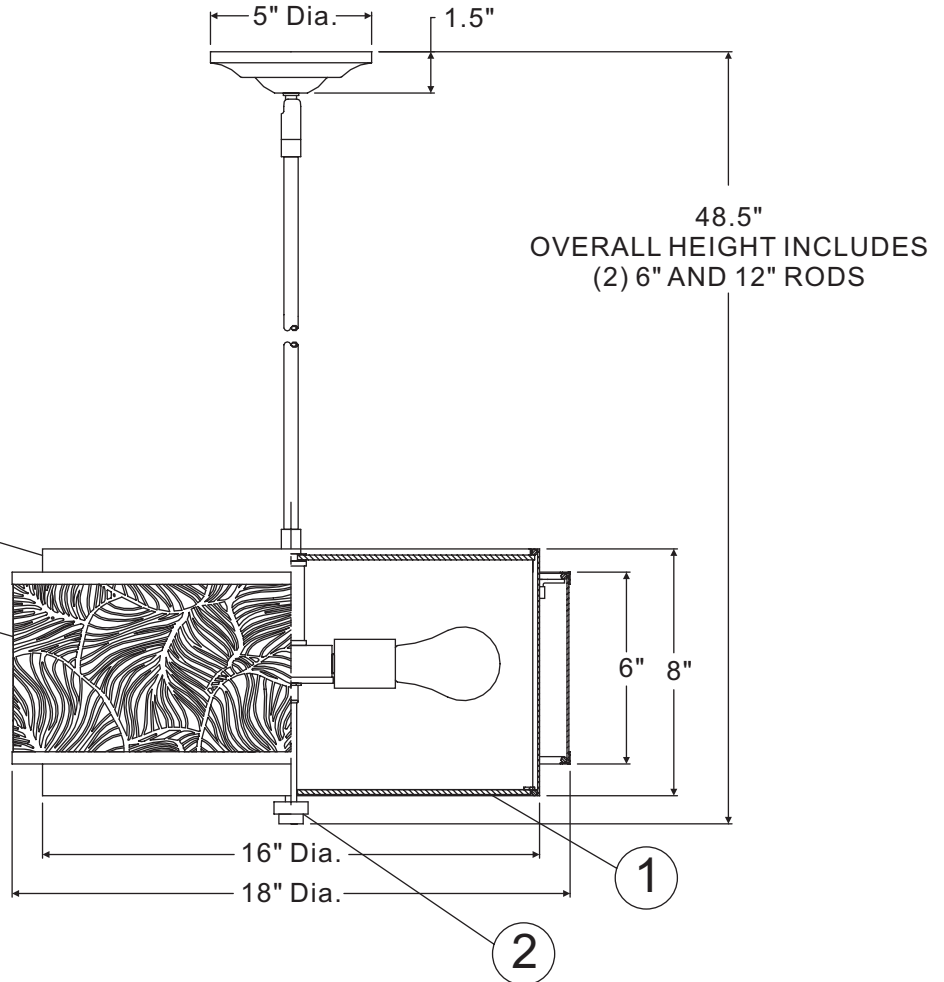

(4) 60W A19  
Medium Base Bulb  
(Not Supplied)

NOTE: ALL DIMENSIONS ARE ROUNDED UP TO THE NEAREST 1/2"

NO.	PART NUMBER	REPLACEMENT PART DESCRIPTION	REQ.
1	G2913DI	DIFFUSER GLS 16"D	1
2	M2279FIPN	FINIAL PLLDN BRNZ 1.125"D	1
3	9497KIT	MTG HDW/CNPY 5.25"D	1
4	9012EXP	ROD PALLADIAN BRNZ 12"L X .5"D	2
5	9006EXP	ROD EXT PLLDN BRNZ 6"L X .5"D	2
6	M2287SH	SHADE METAL 18"D X 6"H	1
7	S1337MC	SHADE MICA 16"D X 8"H	1

# Assembly Instruction Sheet #IS-MCDL2818PN For Style MCDL2818PN

## STEP 1 – Assemble Rods

- A. Determine the Rods (K/L) to be assembled to the Mica Shade Assembly (J) according to your hanging height.
- C. Pass Supply Wires and Ground Wire through the chosen Rods (K/L) and then thread the chosen Rods (K/L) and the Mica Shade Assembly (J) together. Hand tighten until snug.

Figure 1

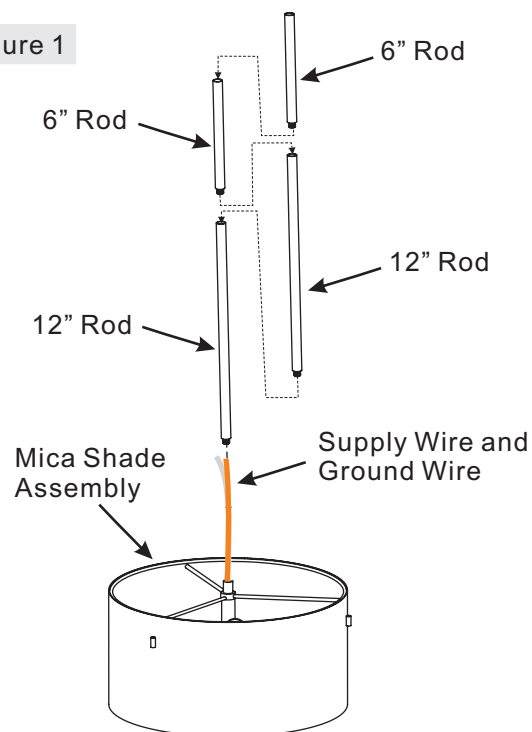

## STEP 2 – Assemble Ceiling Canopy to Upper Rod

- A. Pass Supply Wires and Ground Wire through the Ceiling Canopy (I) and then thread the Ceiling Canopy (I) and the Upper Rod together. Hand tighten until snug.

Figure 2

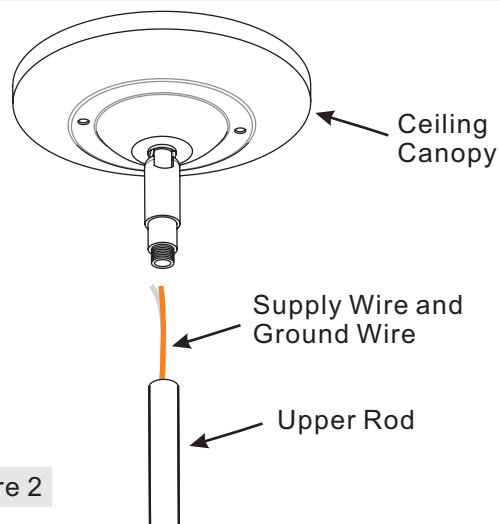

Thank you for purchasing a Quoizel product.

Need assistance with parts or assembly? Call Quoizel customer service at 1-631-273-2700  
or visit us on-line at [www. quoizel. com](http://www. quoizel. com)

# Assembly Instruction Sheet #IS-MCDL2818PN For Style MCDL2818PN

## STEP 3 – Attach Mounting Screws, Lock Washers and Hex Nuts to Crossbar

- Line up a set of holes on the Crossbar (A) and Holes on the Ceiling Canopy (I).
- Thread Mounting Screws (B) into the holes on the Crossbar (A), pass Lock Washers (C) and thread Hex Nut (D) onto the Mounting Screws (B). Hand tighten until snug.

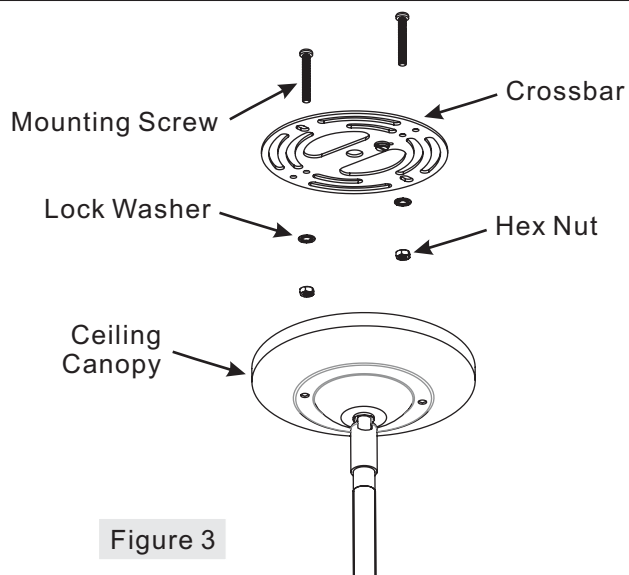

Figure 3

## STEP 4 – Attach Crossbar to Outlet Box

- Attach the Crossbar (A) to Outlet Box and secure by threading Outlet Box Screws (not supplied) into the Mounting Holes on the Outlet Box. Tighten until snug.

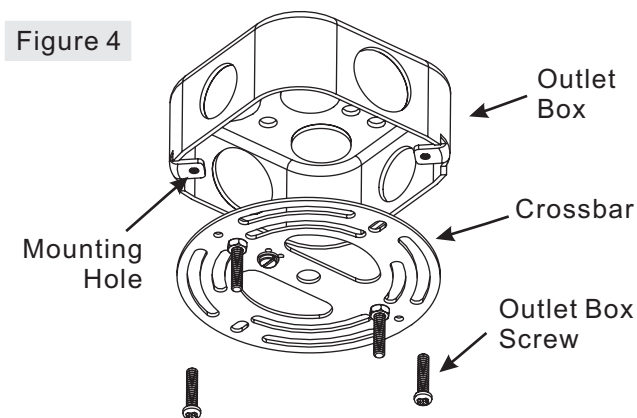

Figure 4

Thank you for purchasing a Quoizel product.

Need assistance with parts or assembly? Call Quoizel customer service at 1-631-273-2700  
or visit us on-line at [www.quoizel.com](http://www.quoizel.com)

# Assembly Instruction Sheet #IS-MCDL2818PN For Style MCDL2818PN

## STEP 5 – Make Wire Connections

- Use standard wire connectors to make all wire connections. (Connectors are not included with fixture.) Strip and prepare wire ends according to instructions supplied with connectors.
- Connect White Supply Wire from the Outlet Box to White Wire from fixture.
- Connect Black (or Red) Supply Wire from the Outlet Box to Black Wire from fixture.
- Connect Ground Wire from the Outlet Box to Ground Wire from fixture.
- Twist connectors until wires are tightly joined together.
- Wrap each connection with approved electrical tape and carefully stuff all the connected wires into the Outlet Box.

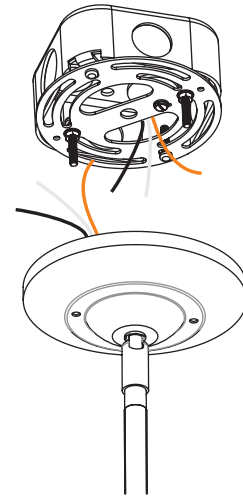

Figure 5

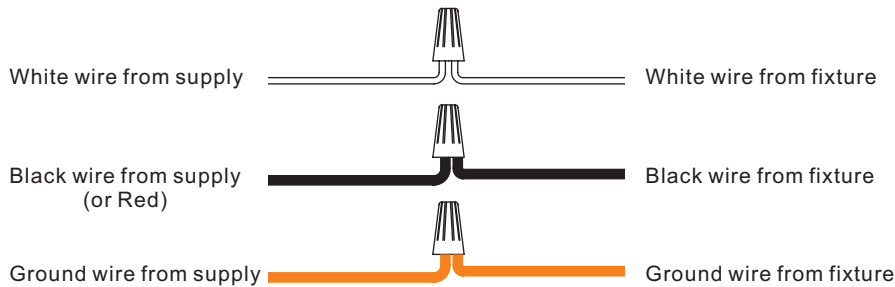

Figure 6

## STEP 6 – Attach Ceiling Canopy to Mounting Screw

- Place the Ceiling Canopy (I) over the Mounting Screws (B) and secure with Mounting Balls (E). Hand tighten until snug.

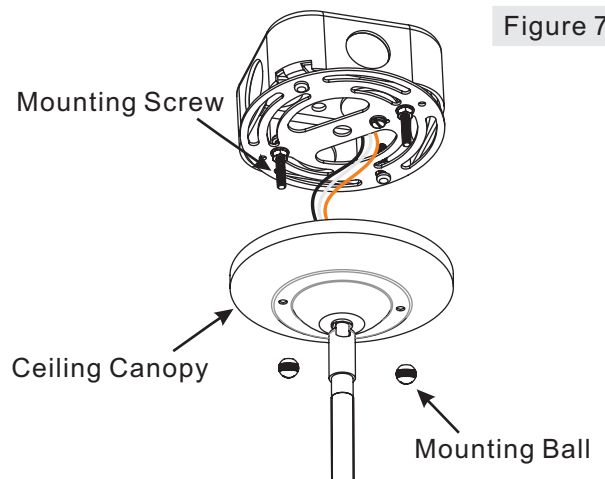

Figure 7

Thank you for purchasing a Quoizel product.

Need assistance with parts or assembly? Call Quoizel customer service at 1-631-273-2700  
or visit us on-line at [www.quoizel.com](http://www.quoizel.com)

# Assembly Instruction Sheet #IS-MCDL2818PN For Style MCDL2818PN

## STEP 7 – Assemble Stem, Diffuser and Finial

- Screw the beaded end of the Stem (O) into the Coupling in the bottom center of the Mica Shade Assembly (J) and hand tighten until snug.
- Place the Diffuser (N) over the end of the Stem (O), attach to the Tabs in the bottom edge of the Mica Shade. Attach the Rubber Washer (G) and the Flat Washer (F) over the end of the Stem (O). Thread the 1/8 IP Hex Nut (H) onto the Stem (O) to secure the above parts. Tighten until snug.
- Thread the Finial (P) onto the Stem (O) and hand tighten until snug.

Figure 8

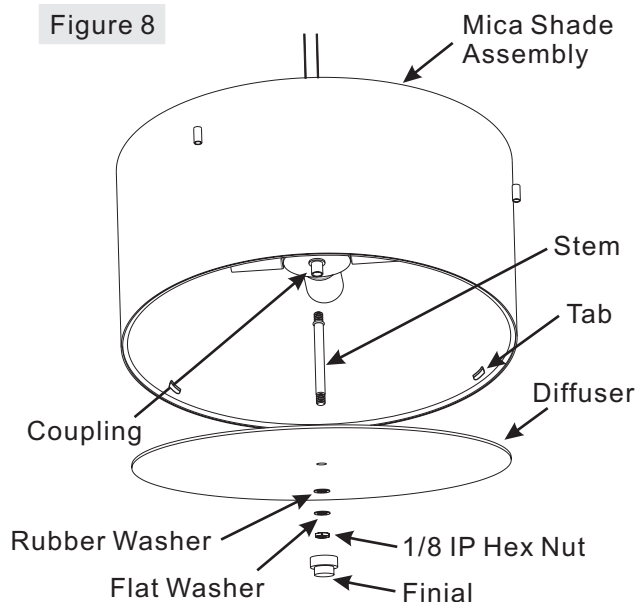

## STEP 8 – Assemble Metal Shade

- Lift the Metal Shade (M) upward and place the Hangers in the top edge of the Metal Shade (M) inside of the Small Pipe outside of the Mica Shade.

Figure 9

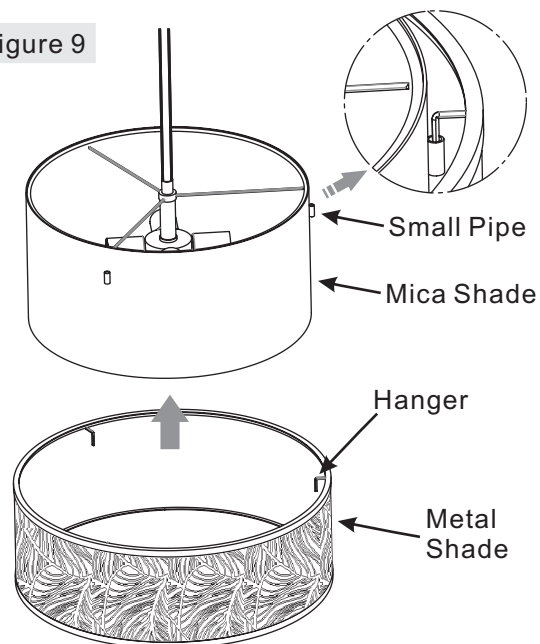

Thank you for purchasing a Quoizel product.

Need assistance with parts or assembly? Call Quoizel customer service at 1-631-273-2700  
or visit us on-line at [www.quoizel.com](http://www.quoizel.com)

# Assembly Instruction Sheet #IS-MCDL2818PN For Style MCDL2818PN

## STEP 8 – Install Bulb

- A. This fixture uses standard bulb with a standard screw base. Maximum 60 watts.
- B. Insert bulb and screw snugly into place.

Your lamp pendant fixture is now assembled and ready to use. Enjoy!

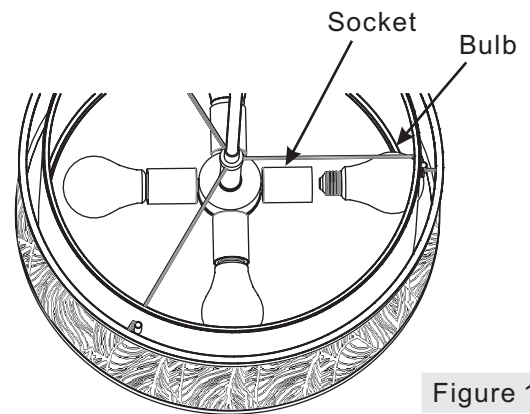

Figure 10

Thank you for purchasing a Quoizel product.

Need assistance with parts or assembly? Call Quoizel customer service at 1-631-273-2700  
or visit us on-line at [www.quoizel.com](http://www.quoizel.com)