

Quoizel, Inc.
6 Corporate Parkway
Goose Creek, SC
29445

Customer Service
Phone 631.273.2700
Fax 631.231.7102
www. quoizel. com

Assembly Instruction Sheet #IS-NN5006WT For Style NN5006WT

Tools Required: Flathead screwdriver, Phillips screwdriver, pliers, wire cutters, wire strippers, electrical tape, safety glasses.

Bulb Recommended: (6) Frosted G9 Halogen 75W Maximum

Estimated Assembly Time: 30-45 minutes

Preparation: Identify and inspect all parts before beginning installation. Check package content list and diagrams below to be sure all parts are present. If any parts are missing or damaged, do not attempt to assemble, install, or operate the fixture. Contact customer service for replacement parts.



Warnings and Cautions

Turn off electricity at circuit breaker or main fuse box before installation. Consult a licensed electrician if in doubt.

These instructions are provided for your safety. It is very important you read them completely before installing the fixture. We strongly recommend that a licensed, professional electrician perform the installation.

Disconnect fixture from power source before replacing bulbs. Make sure bulbs are given sufficient time to cool before removal. Do not subject glass parts to any shock while in operation or shattering may result.

Thank you for purchasing a Quoizel product.

Need assistance with parts or assembly? Call Quoizel customer service at 1-631-273-2700
or visit us on-line at www. quoizel. com

NN5006WT

FINISH: WESTERN BRONZE

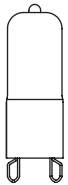
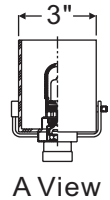
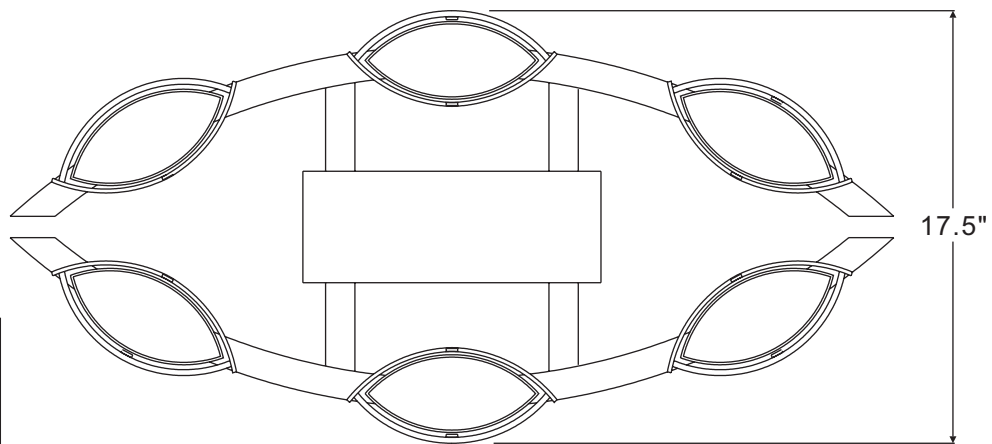
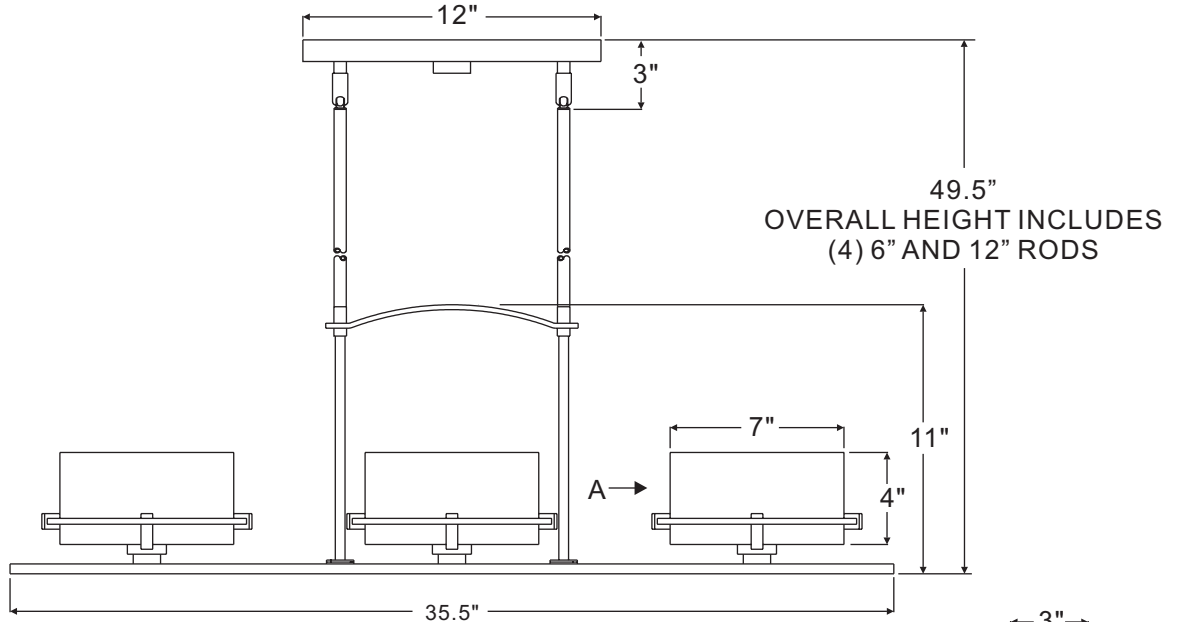
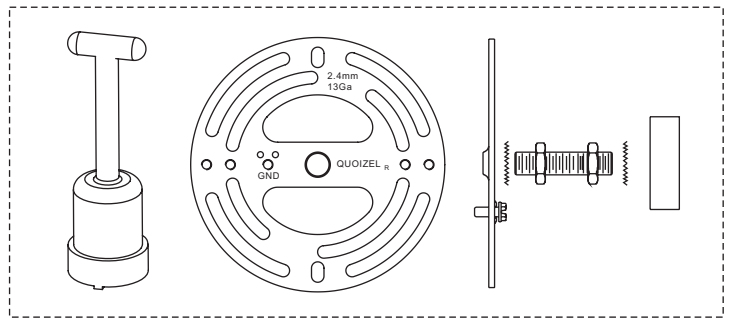
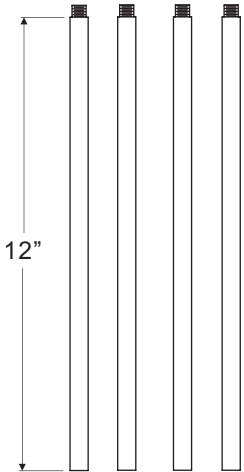
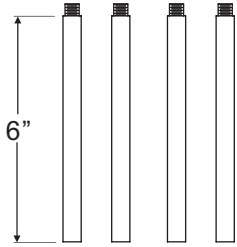

(6)75W Frosted
G9 Halogen Bulbs
(Supplied)

NOTE: ALL DIMENSIONS ARE ROUNDED UP TO THE NEAREST 1/2"

| NO. | PART NUMBER | REPLACEMENT PART DESCRIPTION | REQ. |
|-----|-------------|--|------|
| 1 | I828SF | BULB 120V 75W HALOGEN G9 FROSTED | 6 |
| 2 | G2641BS | BULB SHIELD GLASS 1"D X 2"H | 6 |
| 3 | 9012EXWT | ROD EXTENSION WESTERN BRONZE 12"L X .5"D | 2 |
| 4 | 9006EXWT | ROD EXTENSION WESTERN BRONZE 6"L X .5"D | 2 |
| 5 | G2955SH | SHADE OPAL ETCHED GLASS 7"L X 4" | 6 |

Assembly Instruction Sheet #IS-NN5006WT For Style NN5006WT

Package Contents

| Part | Description | Quantity |
|------|--------------------|----------|
| A | Crossbar | 1 pc. |
| B | Nipple | 1 pc. |
| C | Lock Washer | 3 pcs. |
| D | Hex Nut | 3 pcs. |
| E | Lock Ball | 1 pc. |
| F | Flat Washer | 1 pc. |
| G | Lanyard | 1 pc. |
| H | Ceiling Canopy | 1 pc. |
| I | Swivel | 2 pcs. |
| J | Lock Screw | 4 pcs. |
| K | G9 Bulb | 6 pcs. |
| L | Bulb Shield | 6 pcs. |
| M | Socket Collar | 6 pcs. |
| N | Steel Collar | 6 pcs. |
| O | 6" Rod | 4 pcs. |
| P | 12" Rod | 4 pcs. |
| Q | Bracket | 1 pc. |
| R | Shade | 6 pcs. |
| S | Shade Holder | 6 pcs. |
| T | Socket Assembly | 1 pc. |
| U | U-Shape Plate | 1 pc. |
| V | Socket Collar Tool | 1 pc. |

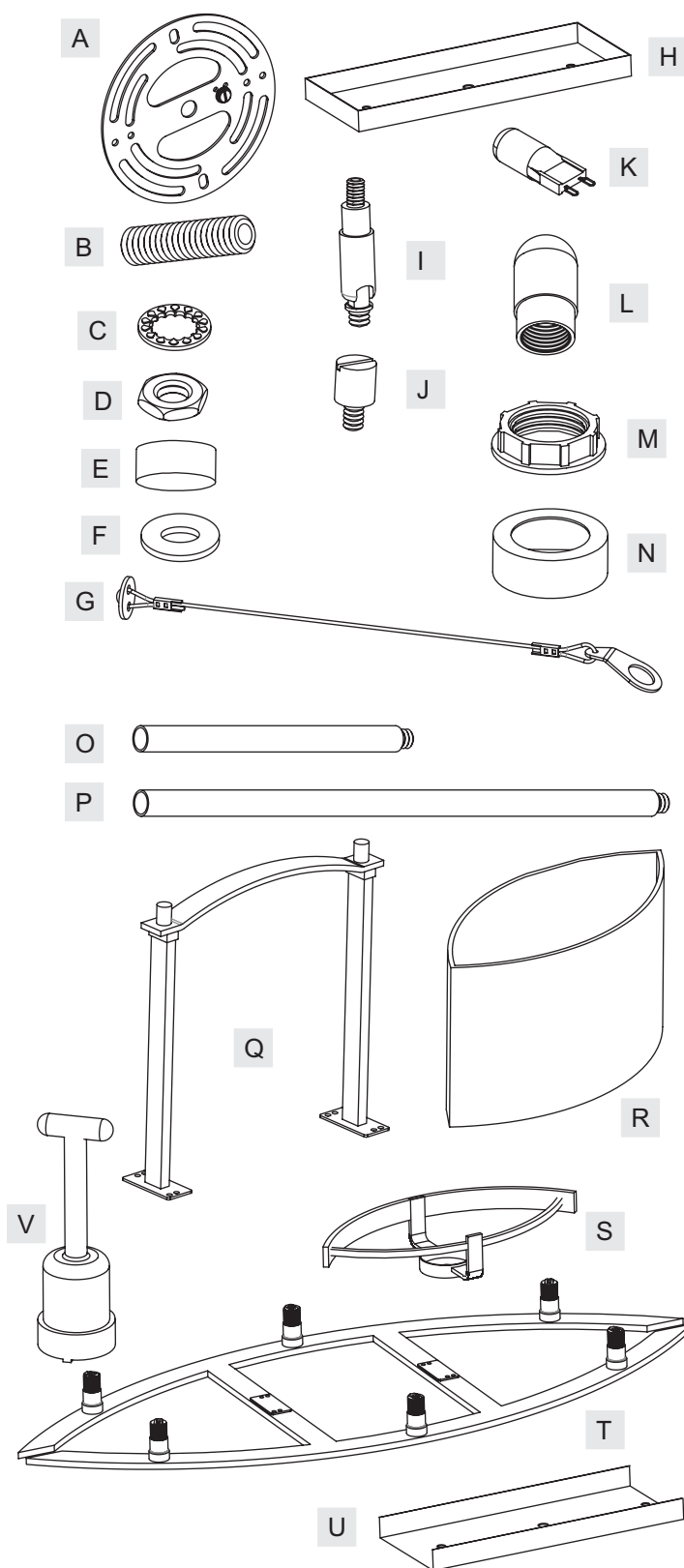

Thank you for purchasing a Quoizel product.

Need assistance with parts or assembly? Call Quoizel customer service at 1-631-273-2700
or visit us on-line at www. quozel. com

Assembly Instruction Sheet #IS-NN5006WT For Style NN5006WT

STEP 1 – Attach Bracket to Socket Assembly

- A. Attach the Bracket (Q) to the Socket Assembly (T), line up holes on the Tabs of the Bracket (Q) and the mounting holes on the Bars of the Socket Assembly (T). Secure by threading the Lock Screws (J) into the mounting holes on the Bars. Hand tighten until snug.

Figure 1

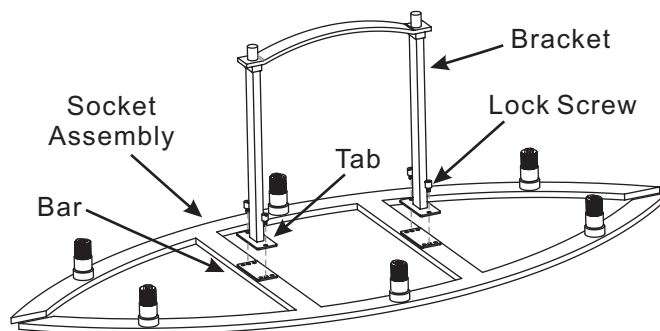

STEP 2 – Assemble Rods

- A. Determine the Rods (O/P) to be assembled according to your hanging height.
B. Pass Supply Wires and Ground Wire through the chosen Rods (O/P). Thread the chosen Rods (O/P) and the Bracket (Q) together. Hand tighten until snug.

Figure 2

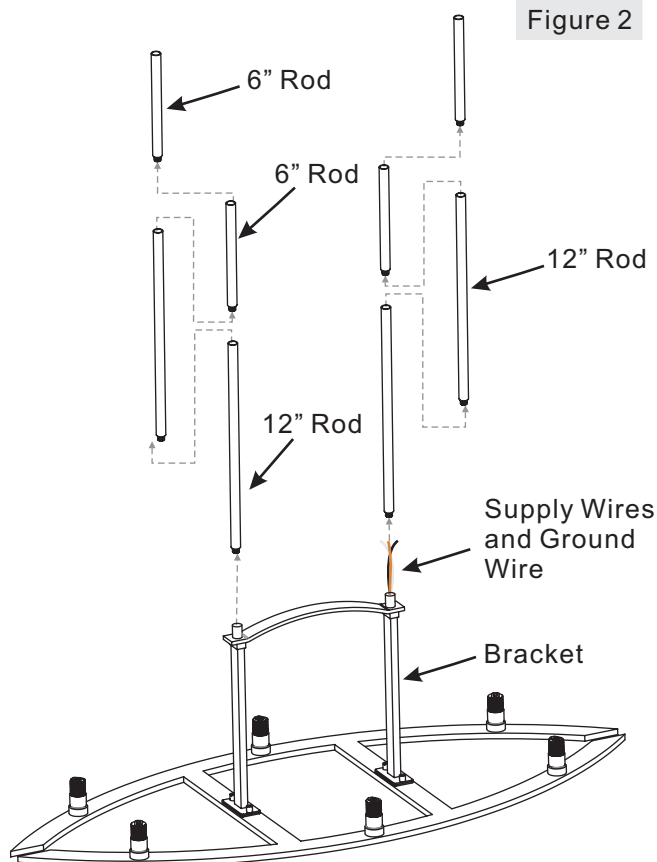

Thank you for purchasing a Quoizel product.

Need assistance with parts or assembly? Call Quoizel customer service at 1-631-273-2700
or visit us on-line at www. quozel. com

Assembly Instruction Sheet #IS-NN5006WT For Style NN5006WT

STEP 3 – Assemble Ceiling Canopy

- Pass the Supply Wires and Ground Wires through Swivel (I), the Ceiling Canopy (H), U-shape Plate (U), Lanyard (G), Flat Washer (F), Lock Washer (C) and Hex Nut (D).
- Screw Swivels (I) into the top end of the Upper Rod. Hand tighten until snug.
- Pass the Ceiling Canopy (F) and U-shape Plate (U) over the top ends of the Swivel (I). Place one Lock Washer (C) over one Swivel (I) and secure with one Hex Nut (D). Tighten until snug.
- Place the Lanyard (G), the Flat Washer (F) and one Lock Washer (C) over the top end of the Swivel (I). Secure by threading one Hex Nut (D) onto the Swivel (I). Tighten until snug.

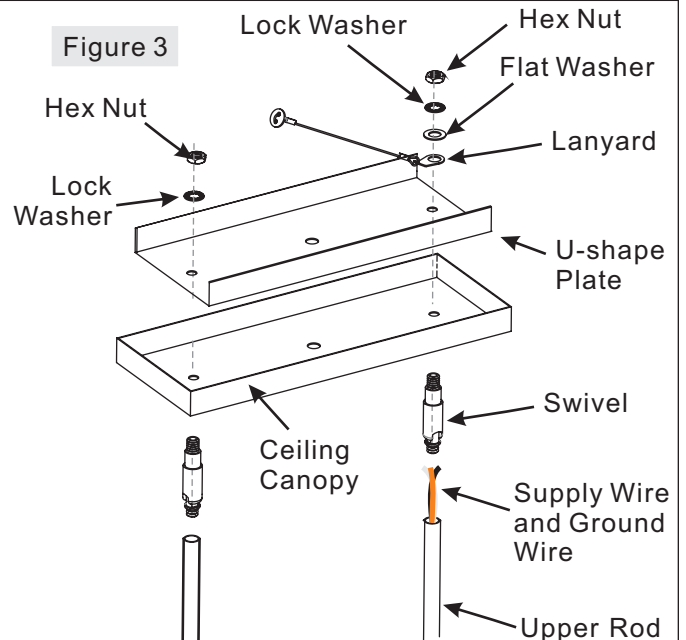

STEP 4 – Attach Crossbar to Outlet Box

- Secure the Crossbar (A) to the outlet box with outlet box screws (not supplied). Tighten until snug.

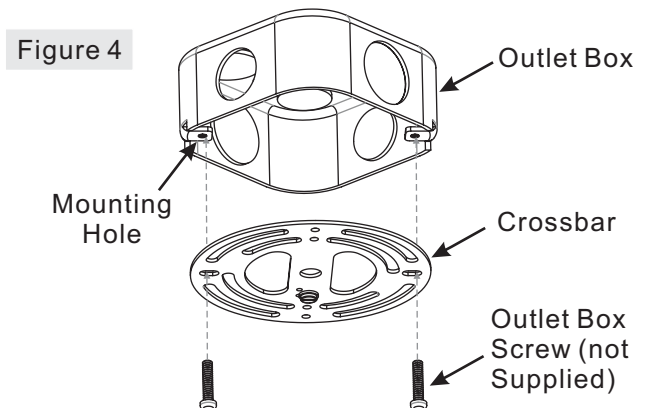

STEP 5 – Attach Nipple to Crossbar

- Thread one Hex Nut (D) onto the top end of the Nipple (B).
- Place one Lock Washer (C) over the top end of the Nipple (B) and then thread the Nipple (B) into the center lock hole of the Crossbar (A).
- Using pliers, thread the Hex Nut (D) against the Crossbar (A) and hand tighten until snug.

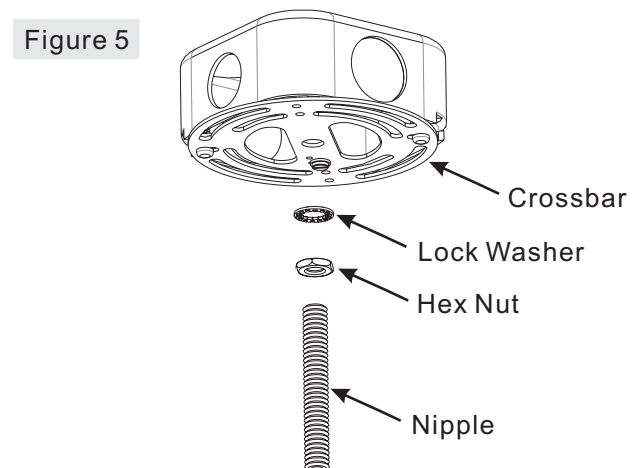

Thank you for purchasing a Quoizel product.

Need assistance with parts or assembly? Call Quoizel customer service at 1-631-273-2700
or visit us on-line at www.quoise.com

Assembly Instruction Sheet #IS-NN5006WT For Style NN5006WT

STEP 6 – Attach Lanyard

- A. The purpose of the lanyard is to provide the installer a means to support the fixture from the junction box while connecting the electrical wires. This enables the fixture to hang from the junction box and your hands are free to make the wire connections.
- B. Turn the Button Stop so it may be inserted into the crossbar slot. Make sure the Button Stop is completely inside the crossbar. Slowly release the fixture to make sure it is supported by the Button Stop. Proceed to the wiring steps. Once you are complete with the wiring there is nothing to do with Lanyard. The Lanyard will push into the junction box when the fixture is placed for final mounting.

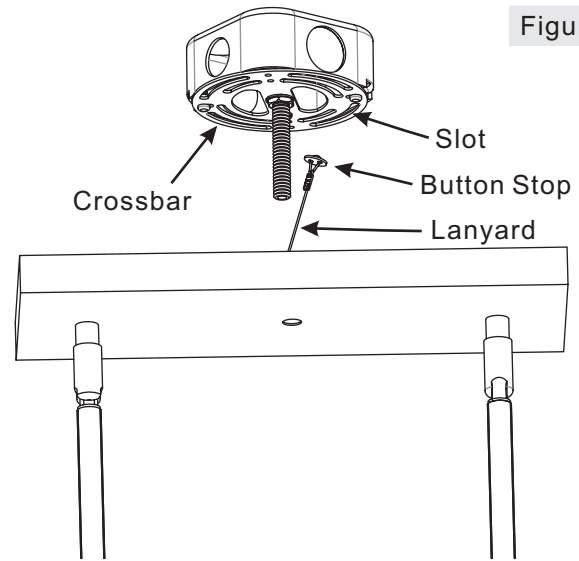

Figure 6

STEP 7 – Make Wire Connections

- A. Use standard wire connectors to make all wire connections. (Connectors are not included with fixture.) Strip and prepare wire ends according to instructions supplied with connectors.
- B. Connect White Supply Wire from the Outlet Box to White Wire from fixture.
- C. Connect Black (or Red) Supply Wire from the Outlet Box to Black Wire from fixture.
- D. Connect Ground Wire from the Outlet Box to Ground Wire from fixture.
- E. Twist connectors until wires are tightly joined together.
- F. Wrap each connection with approved electrical tape and carefully stuff all the connected wires into the Outlet Box.

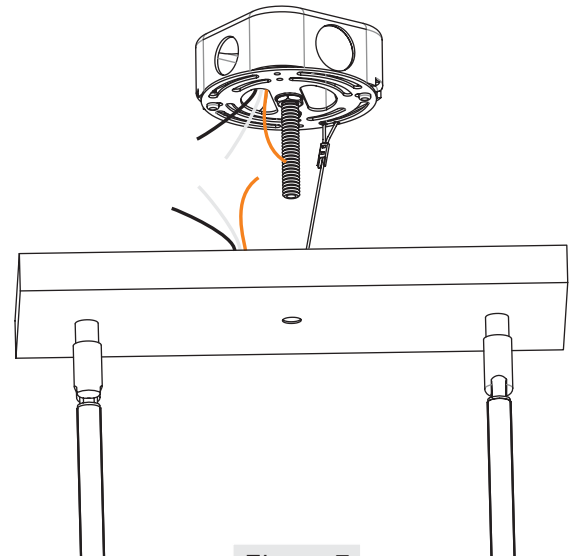

Figure 7

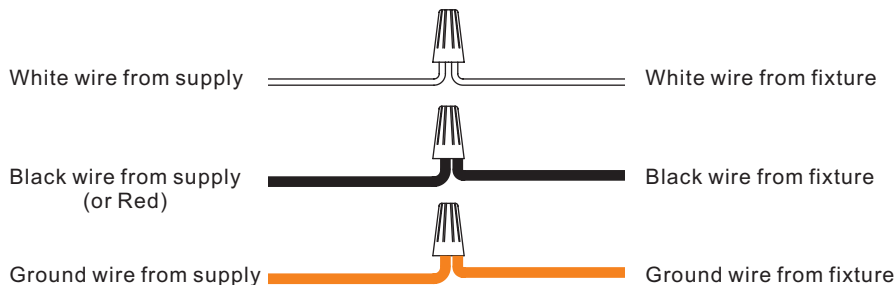

Figure 8

Thank you for purchasing a Quoizel product.

**Need assistance with parts or assembly? Call Quoizel customer service at 1-631-273-2700
or visit us on-line at www.quoizel.com**

Assembly Instruction Sheet #IS-NN5006WT For Style NN5006WT

STEP 8 – Install Ceiling Canopy

- A. Pass the Ceiling Canopy (H) over the end of the Nipple (B). Secure by threading the Lock Ball (E) onto the Nipple (B). Hand tighten until snug.

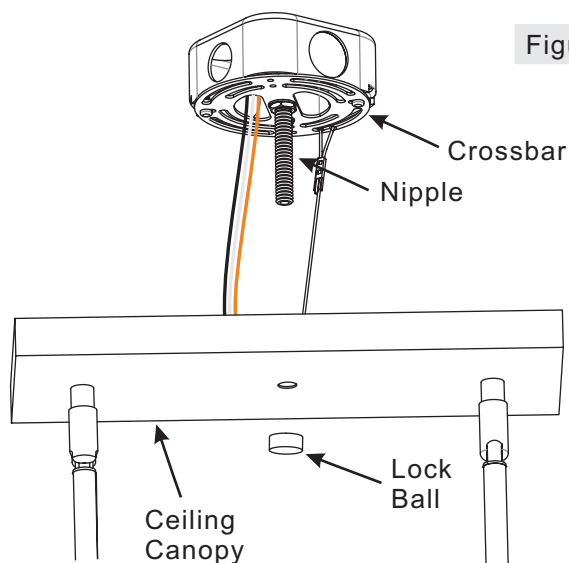

STEP 9 – Attach Shade Holder and Shade to Socket

- A. Place the Shade Holder (S), the Shade (R) and the Steel Collar (N) over the Socket in turn. By using the Socket Collar Tool (V), thread the Socket Collar (M) onto the Socket. Hand tighten until snug.

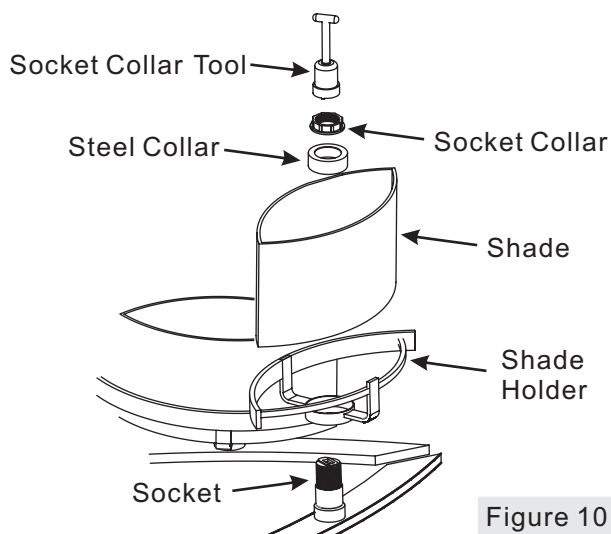

STEP 10 – Install Bulb and Bulb Shield

- A. This fixture uses frosted G9 halogen bulb with a G9 base. Maximum 75 watts.
- B. Insert bulb and push snugly into place.
- C. Thread the Bulb Shield (L) onto the Socket. Hand tighten until snug.

Your fixture chandelier lamp is now assembled and ready to use. Enjoy!

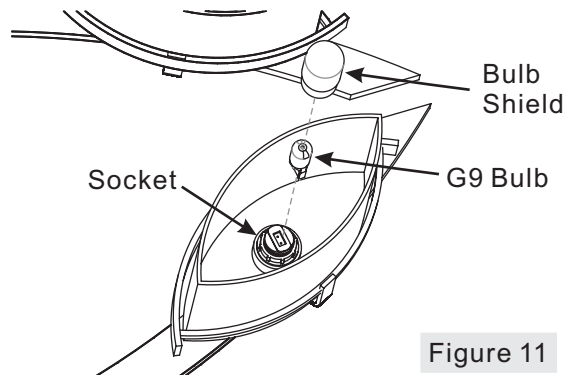

Thank you for purchasing a Quoizel product.

Need assistance with parts or assembly? Call Quoizel customer service at 1-631-273-2700
or visit us on-line at www. quozel. com

Assembly Instruction Sheet #IS-NN5006WT For Style NN5006WT

CAUTION FOR BULB REPLACING

- A. When replace bulb, turn off power and allow lamp to cool. For safety purpose, wear gloves and eye protection.
- B. If bulb is scratched or cracked, DO NOT use the lamp to avoid breakage during use or installation.
- C. Use only in fixtures rated for lamps wattage and voltage.
- D. Lamp operate under high pressure generating intense heat. Prevent contact with liquid and combustible materials.

Thank you for purchasing a Quoizel product.

**Need assistance with parts or assembly? Call Quoizel customer service at 1-631-273-2700
or visit us on-line at www.quoizel.com**