

## PACKAGE CONTENTS

ISSUED 03-2011

REVISED 2011-04-21

Part	Description	Quantity
A	Crossbar	1pc
B	Green Ground Screw	1pc
C	Mounting Screw	2pcs
D	Lock Washer	2pcs
E	Hex Nut (for Mounting Screw)	2pcs
F	Mounting Ball	2pcs
G	Steel Washer	3pcs
H	Plastic Washer	3pcs
I	Allen Wrench	1pc
J	Lock Screw with Washer	3pcs
K	Fixture Body	1pc
L	Shade	1pc

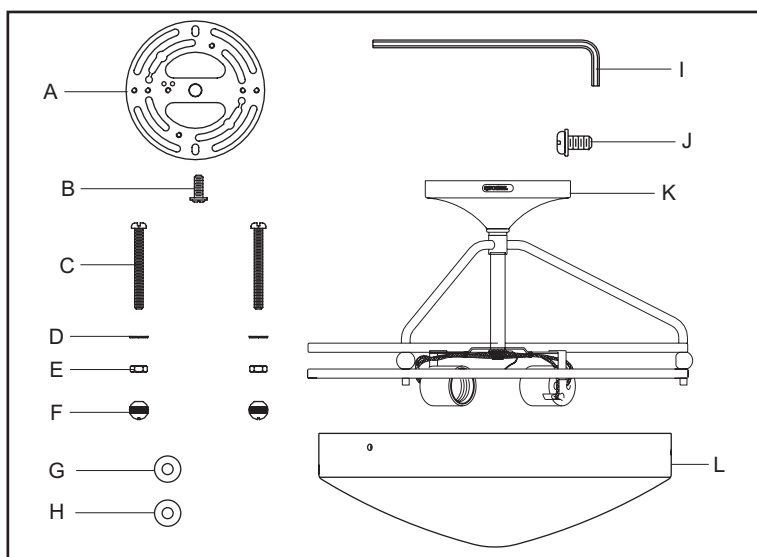

## WARNINGS AND CAUTIONS

### WARNING:

- Before beginning the installation, turn off electricity at the circuit breaker box or the main fuse box by switching off the circuit breaker or removing the fuse.

### CAUTIONS:

- These instructions are provided for your safety. It is very important that they are read completely before the installation of your fixture. We strongly recommend that a professional electrician install the fixture.
- Disconnect fixture from the power source before replacing the bulb(s), making sure the bulb(s) had sufficient time to cool down. DO NOT subject the lamp to any shock while lit as shattering of lamp may result.

## PREPARATION

- Before beginning installation of product, make sure all parts are present. Compare parts with package contents list and diagram above. If any part is missing or damaged, do not attempt to assemble, install or operate the product. Contact customer service for replacement part.
- Estimated Assembly Time: 15 - 30 minutes
- Tools Required for Assembly (not included): Flathead screwdriver, Phillips screwdriver, pliers, electrical tape, wire cutters, safety glasses & 2, 100 Watt, Type-A Medium Base Bulbs.
- Helpful Tools (not included): Wire Strippers.

## INSTALLATION INSTRUCTIONS:

### STEP 1:

- a. Place the Frame over the Shade, line up Mounting Holes on the Balls and holes on the side of the Shade.
- b. Pass the Steel Washer and the Plastic Washer over the Lock Screw. Then place the Lock Screw through the holes on the side of the Shade, thread into the Mounting Holes on the Balls. Tighten until snug by using Allen Wrench to secure the Shade.

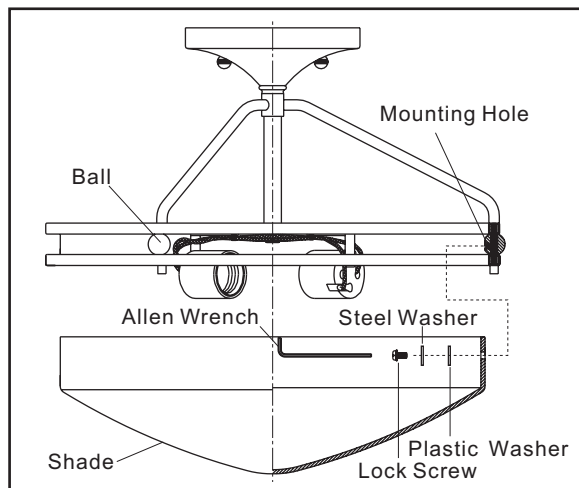

## STEP 2:

- Screw the Mounting Screws into the Crossbar, place the Lock Washers over the Mounting Screws and thread the Hex Nuts onto the Mounting Screws as shown. Secure the position of the Mounting Screws by tightening the Hex Nuts against the Crossbar.
- Secure the Crossbar to the Outlet Box with Outlet Box Screws.

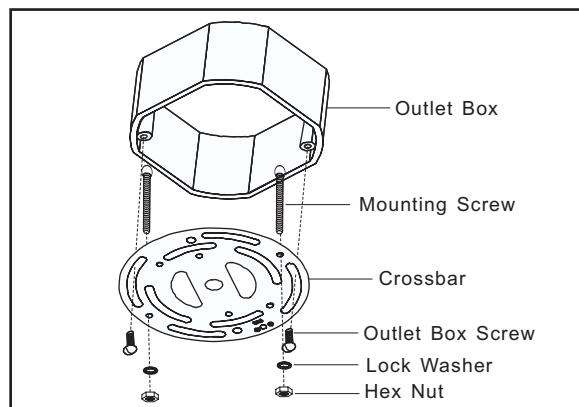

## STEP 3:

\*Use Wire Connectors (not supplied) to connect the wires.

- Connect the House Ground Wire to the Fixture Ground Wire.
- Connect the House White (or Ribbed) Wire to the Fixture Supply Wire (White or Ribbed Side).
- Connect the House Black (or Red) Wire to the Fixture Supply Wire (Black or Smooth Side).
- Wrap each connection with approved electrical tape and carefully stuff all of the connected wires into the Outlet Box.

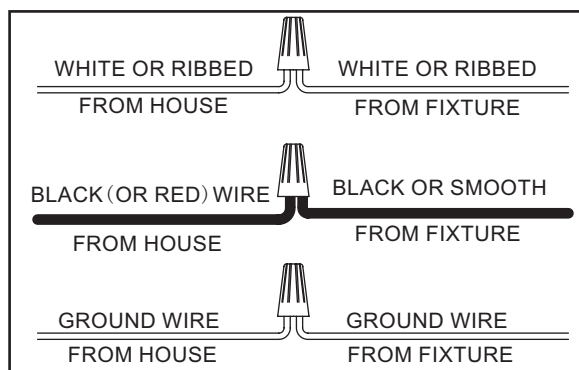

## STEP 4:

- Carefully tuck all wires into the wall mounted outlet box and position the fixture over the outlet box.
- Align the holes in the Ceiling Canopy with the Mounting Screws attached to the Crossbar.
- Pass the fixture over the Mounting Screws and secure by threading Mounting Balls onto end of screw. Tighten until snug.

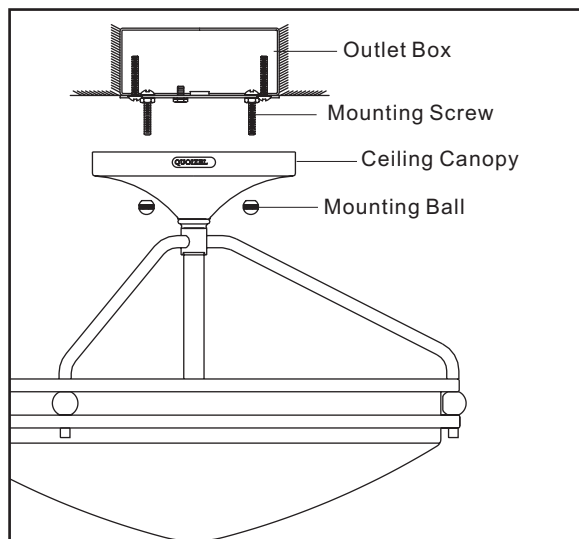

## STEP 5:

- Install correct bulbs referring to the fixture markings and/or labels for maximum wattage.

Your installation is completed now. Restore electricity. Keep this sheet for future reference.