

Quoizel, Inc.
6 Corporate Parkway
Goose Creek, SC
29445

Customer Service
Phone 631.273.2700
Fax 631.231.7102
www.quoizel.com

Assembly Instruction Sheet #IS-QF1212SBN For Style QF1212SBN

Tools Required: Flathead screwdriver, Phillips screwdriver, pliers, wire cutters, wire strippers, electrical tape, safety glasses.

Bulb Recommended: (3) Medium Base 100W Maximum

Estimated Assembly Time: 20-30 minutes

Preparation: Identify and inspect all parts before beginning installation. Check package content list and diagrams below to be sure all parts are present. If any parts are missing or damaged, do not attempt to assemble, install, or operate the fixture. Contact customer service for replacement parts.



Warnings and Cautions

Turn off electricity at circuit breaker or main fuse box before installation. Consult a licensed electrician if in doubt.

These instructions are provided for your safety. It is very important you read them completely before installing the fixture. We strongly recommend that a licensed, professional electrician perform the installation.

Disconnect fixture from power source before replacing bulbs. Make sure bulbs are given sufficient time to cool before removal. Do not subject glass parts to any shock while in operation or shattering may result.

Package Contents

Part	Description	Quantity
A	Crossbar	1 pc.
B	Mounting Screw	2 pcs.
C	Lock Washer	2 pcs.
D	Hex Nut	2 pcs.
E	Mounting Ball	2 pcs.
F	1/8 IP Hex Nut	1 pc.
G	Socket Assembly	1 pc.
H	Center Stem Assembly	1 pc.
I	Shade	1 pc.
J	Shade Holder	1 pc.
K	Cap	1 pc.
L	Side Arm	3 pcs.
M	Big Finial	1 pc.
N	Small Finial	3 pcs.
O	Nipple	3 pcs.

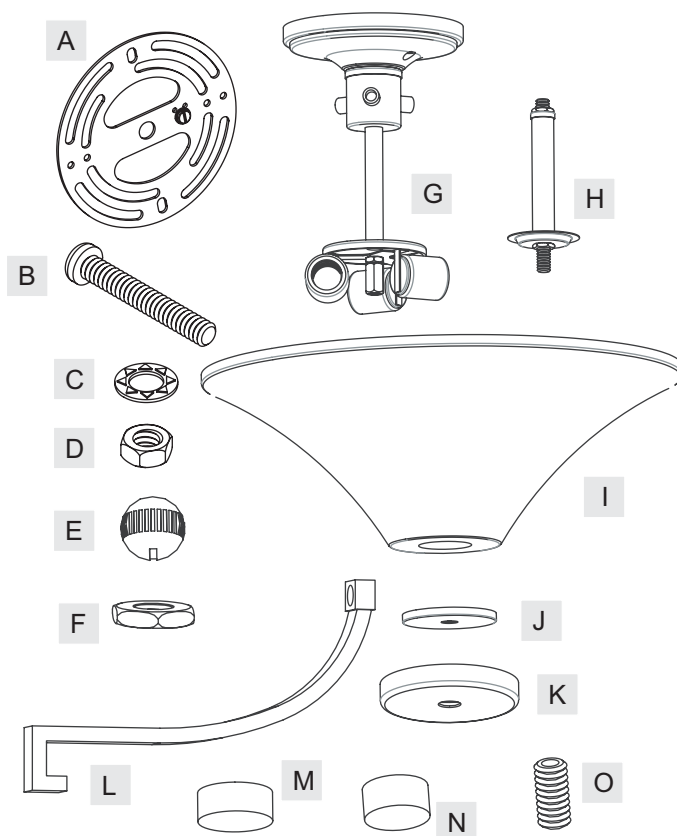

Thank you for purchasing a Quoizel product.

Need assistance with parts or assembly? Call Quoizel customer service at 1-631-273-2700
or visit us on-line at www.quoizel.com

QF1212SBN

FINISH: BRUSHED NICKEL

2

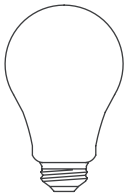
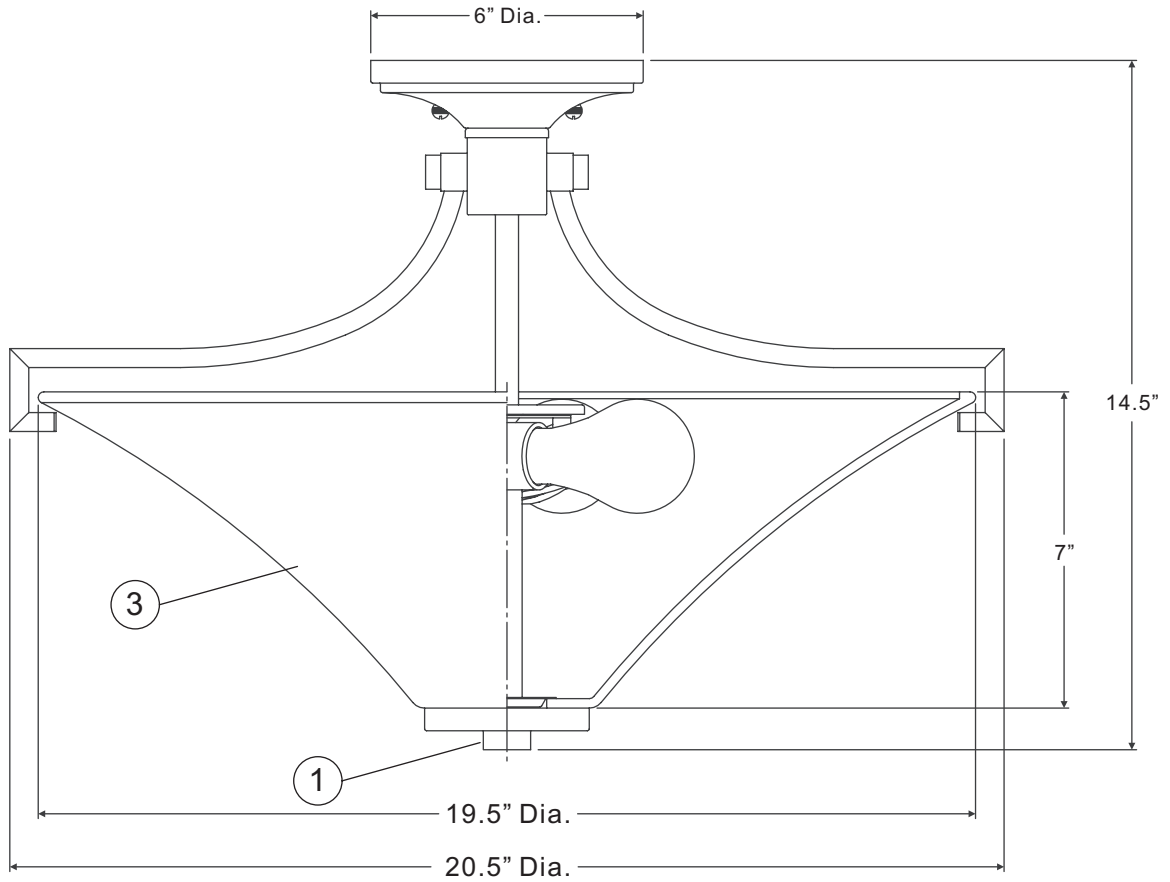
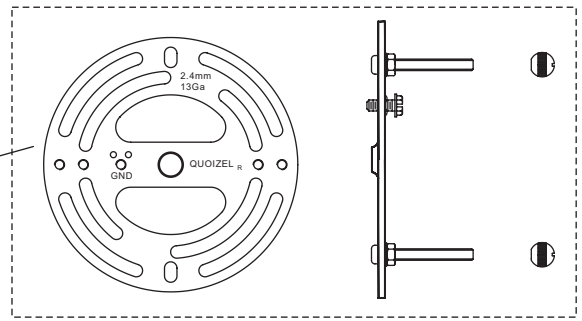

(3)100W Medium
Base Bulbs
(Not Supplied)

NOTE: ALL DIMENSIONS ARE ROUNDED UP TO THE NEAREST 1/2"

NO.	PART NUMBER	REPLACEMENT PART DESCRIPTION	REQ.
1	M2267FIBN	FINIAL BRSH NIKL 0.38"H X 1"D	1
2	9310KIT	MTG HARDWARE 4"D RPL AV1717BN	1
3	G2489SH	SHADE OPAL ETCHED GLASS 19.5"D	1

Assembly Instruction Sheet #IS-QF1212SBN For Style QF1212SBN

STEP 1 – Attach Mounting Screws, Lock Washers and Hex Nuts to Crossbar

- A. Line up a set of holes on the Crossbar (A) and Holes on the Ceiling Canopy of the Socket Assembly (G).
- B. Thread Mounting Screws (B) into the holes on the Crossbar (A), pass Lock Washers (C) and thread Hex Nut (D) onto the Mounting Screws (B). Hand tighten until snug.

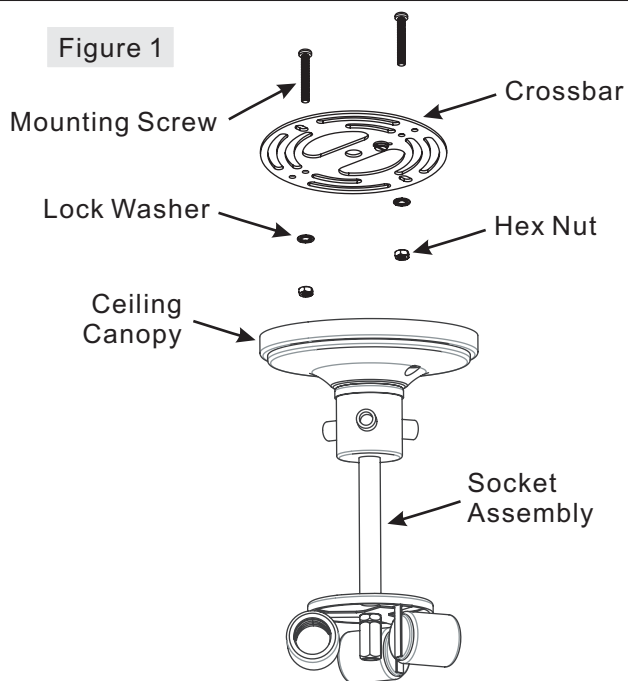

STEP 2 – Attach Crossbar to Outlet Box

- A. Attach the Crossbar (A) to Outlet Box and secure by threading Outlet Box Screws (not supplied) into the Mounting Holes on the Outlet Box. Tighten until snug.

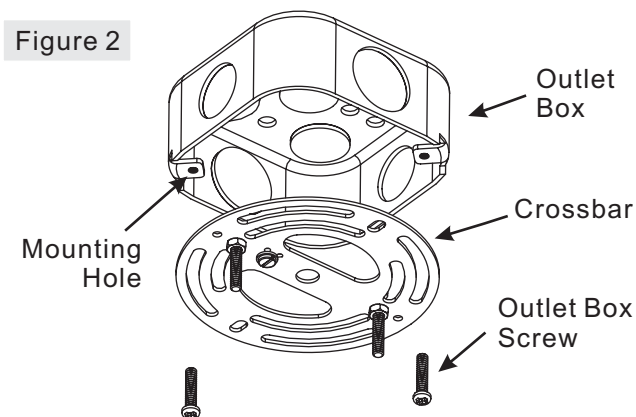

Thank you for purchasing a Quoizel product.
Need assistance with parts or assembly? Call Quoizel customer service at 1-631-273-2700
or visit us on-line at www.quoizel.com

Assembly Instruction Sheet #IS-QF1212SBN For Style QF1212SBN

STEP 3 – Make Wire Connections

- Use standard wire connectors to make all wire connections. (Connectors are not included with fixture.) Strip and prepare wire ends according to instructions supplied with connectors.
- Connect White Supply Wire from the Outlet Box to White Wire from fixture.
- Connect Black (or Red) Supply Wire from the Outlet Box to Black Wire from fixture.
- Connect Ground Wire from the Outlet Box to Ground Wire from fixture.
- Twist connectors until wires are tightly joined together.
- Wrap each connection with approved electrical tape and carefully stuff all the connected wires into the Outlet Box.

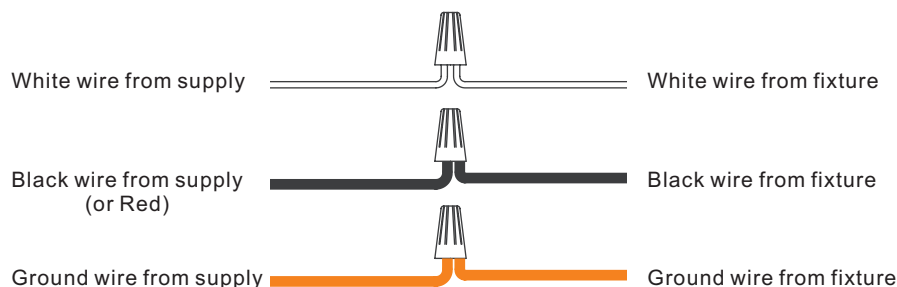

Figure 4



Figure 3

STEP 4 – Attach Ceiling Canopy to Mounting Screw

- Place the Ceiling Canopy on the Socket Assembly (G) over the Mounting Screws (B) and secure with Mounting Balls (E). Hand tighten until snug.

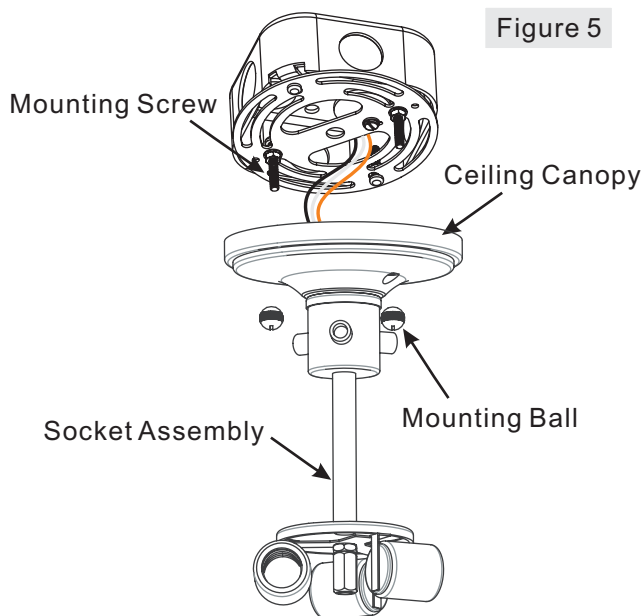

Figure 5

Thank you for purchasing a Quoizel product.

Need assistance with parts or assembly? Call Quoizel customer service at 1-631-273-2700
or visit us on-line at www.quoizel.com

Assembly Instruction Sheet #IS-QF1212SBN For Style QF1212SBN

STEP 5 – Attach Center Stem Assembly

- A. Thread top end of the Center Stem Assembly (H) into the Hex Coupling underside of the Socket Assembly (G). Hand tighten until snug.

Figure 6

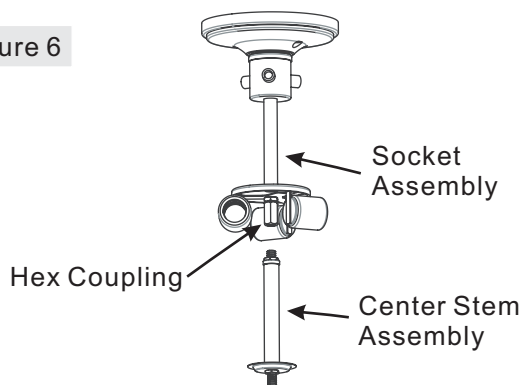

STEP 6 – Attach Shade

- A. Place the Shade (I) and the Shade Holder (J) over the end of the Center Stem Assembly (H), attach to the Shade Stop. Secure by threading the 1/8 IP Hex Nut (F) onto the Center Stem. Hand tighten until snug.

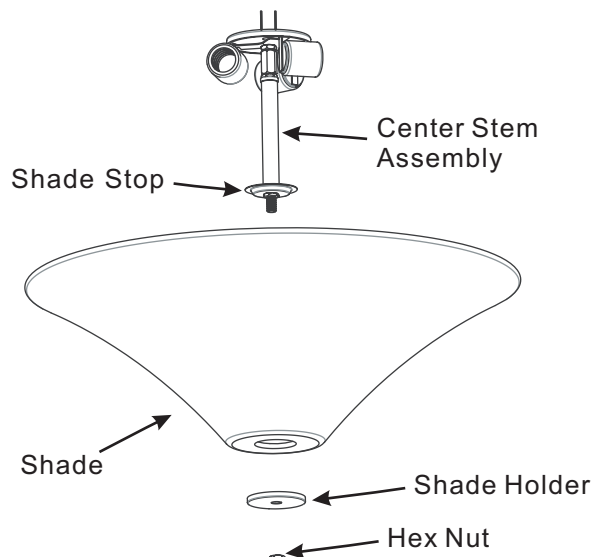

Figure 7

STEP 7 – Attach Side Arm

- A. Screw one end of the Nipple (O) into the Mounting Hole on the side of the Socket Assembly (G). Hand tighten until snug.
B. Place the hole end of the Side Arm (L) over the Nipple (O). The another end of the Side Arm (L) should catch the lip of the Shade (I) as shown.
C. Thread the Small Finial (N) onto the Nipple (O) and hand tighten until snug to secure the Side Arm (L).

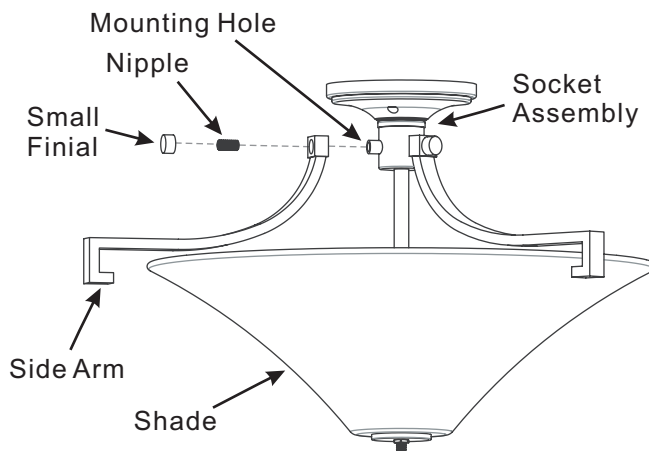

Figure 8

Thank you for purchasing a Quoizel product.

Need assistance with parts or assembly? Call Quoizel customer service at 1-631-273-2700
or visit us on-line at www.quoizel.com

Assembly Instruction Sheet #IS-QF1212SBN For Style QF1212SBN

STEP 8 – Attach Cap

- A. Place the Cap (K) over the nipple extruding from the bottom center of the Shade (I). Secure by threading the Big Finial (M) onto the nipple. Hand tighten until snug.

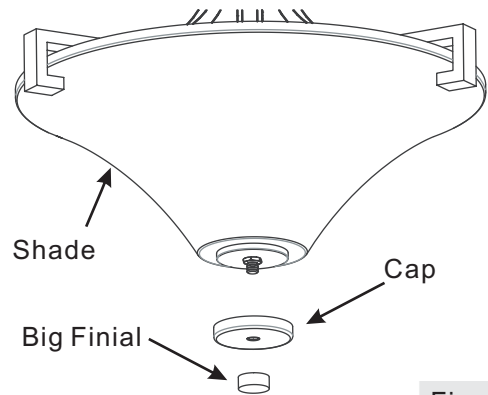

Figure 9

STEP 9 – Install Bulb

- A. This fixture uses standard bulb with a standard screw base.
Maximum 100 watts.
B. Insert bulb and screw properly into place.

Your lamp semi-flush fixture is now assembled and ready to use. Enjoy!

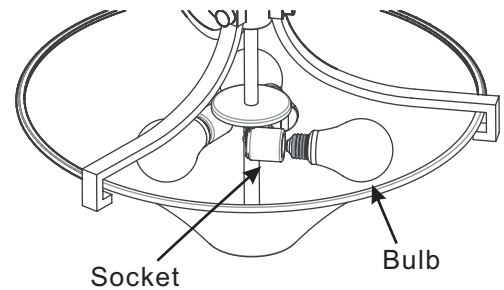

Figure 10

Thank you for purchasing a Quoizel product.
Need assistance with parts or assembly? Call Quoizel customer service at 1-631-273-2700
or visit us on-line at www.quoizel.com