

Quoizel, Inc.
6 Corporate Parkway
Goose Creek, SC
29445

Customer Service
Phone 631.273.2700
Fax 631.231.7102
www.quoizel.com

Assembly Instruction Sheet #IS-SPH8702PN For Style SPH8702PN

Tools Required: Flathead screwdriver, Phillips screwdriver, pliers, wire cutters, wire strippers, electrical tape, safety glasses.

Bulb Recommended: (2) Medium Base 100W Maximum

Estimated Assembly Time: 20-30 minutes

Preparation: Identify and inspect all parts before beginning installation. Check package content list and diagrams below to be sure all parts are present. If any parts are missing or damaged, do not attempt to assemble, install, or operate the fixture. Contact customer service for replacement parts.



Warnings and Cautions

Turn off electricity at circuit breaker or main fuse box before installation. Consult a licensed electrician if in doubt.

These instructions are provided for your safety. It is very important you read them completely before installing the fixture. We strongly recommend that a licensed, professional electrician perform the installation.

Disconnect fixture from power source before replacing bulbs. Make sure bulbs are given sufficient time to cool before removal. Do not subject glass parts to any shock while in operation or shattering may result.

Package Contents

| Part | Description | Quantity |
|------|--------------------|----------|
| A | Inner Backplate | 1 pc. |
| B | Fixture Body | 1 pc. |
| C | Mounting Screw | 3 pcs. |
| D | Shade | 2 pcs. |
| E | Socket Collar | 2 pcs. |
| F | Socket Collar Tool | 1 pc. |

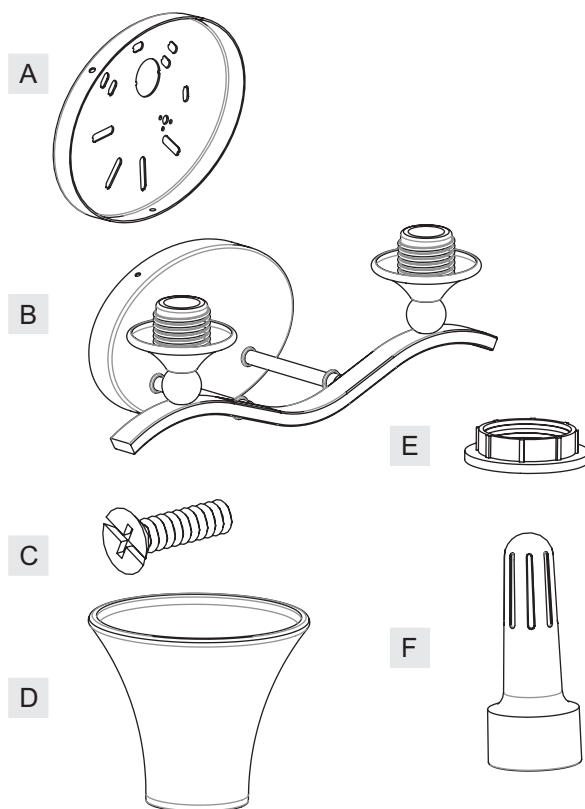

Thank you for purchasing a Quoizel product.

Need assistance with parts or assembly? Call Quoizel customer service at 1-631-273-2700
or visit us on-line at www.quoizel.com

SPH8702PN

FINISH: PALLADIAN BRONZE

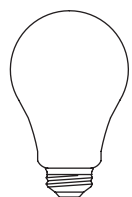
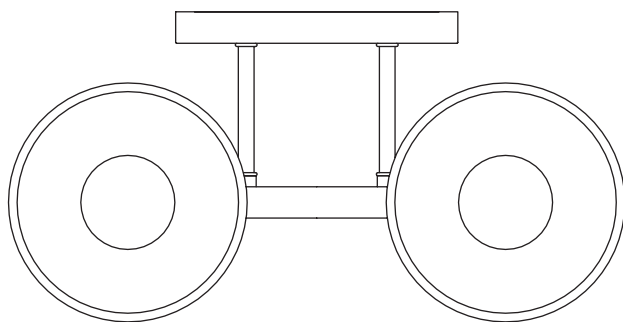
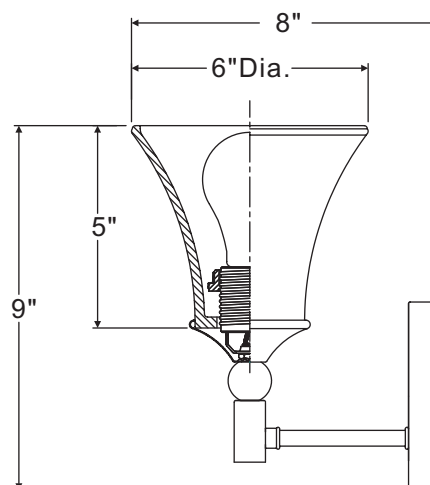
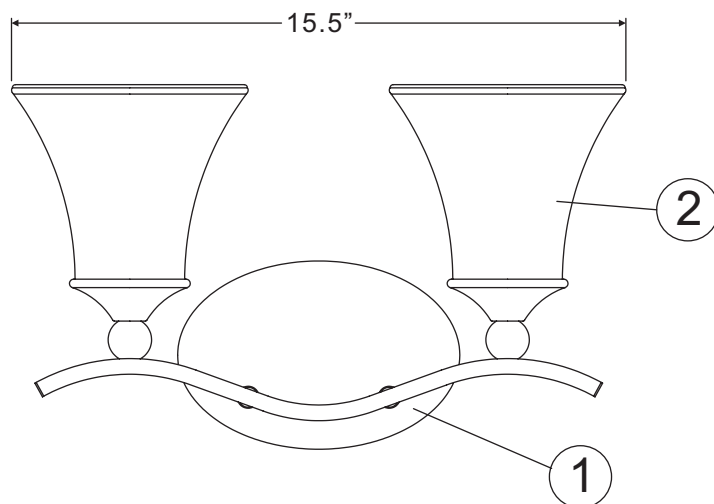
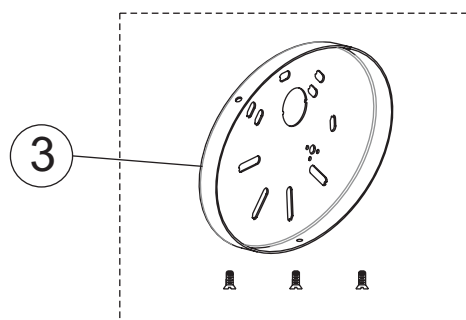

(2)100W A19
Medium Base Bulb
(Not Supplied)

NOTE: ALL DIMENSIONS ARE ROUNDED UP TO THE NEAREST 1/2"

| NO. | PART NUMBER | REPLACEMENT PART DESCRIPTION | REQ. |
|-----|-------------|---------------------------------|------|
| 1 | 18702PNSPH | BASE PALLADIAN BRONZE SPH8702PN | 1 |
| 2 | G3281SH | GLASS PAINTED WHITE 6"D X 5"H | 2 |
| 3 | 9545KIT | MOUNTING HARDWARE | 1 |

Assembly Instruction Sheet #IS-SPH8702PN

For Style SPH8702PN

STEP 1 – Attach Inner Backplate to Outlet Box

- A. Attach the Inner Backplate (A) to Outlet Box and secure by threading Outlet Box Screws (not supplied) into the Mounting Holes on the Outlet Box. Tighten until snug.

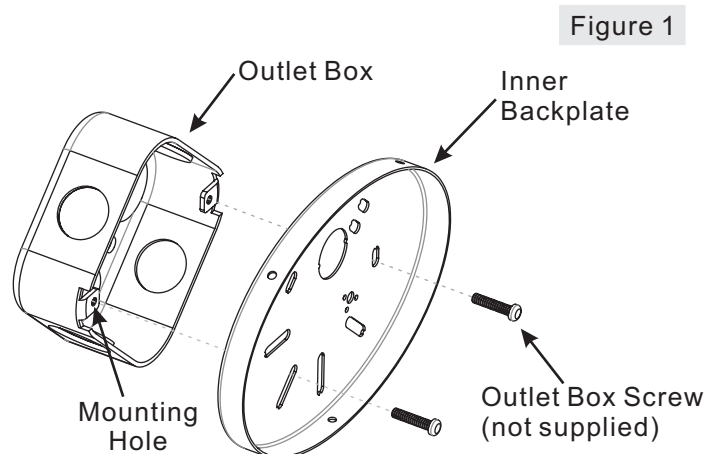

STEP 2 – Make Wire Connections

- A. Use standard wire connectors to make all wire connections. (Connectors are not included with fixture.) Strip and prepare wire ends according to instructions supplied with connectors.
- B. Connect White Supply Wire from the Outlet Box to White Wire from fixture.
- C. Connect Black (or Red) Supply Wire from the Outlet Box to Black Wire from fixture.
- D. Connect Ground Wire from the Outlet Box to Ground Wire from fixture.
- E. Twist connectors until wires are tightly joined together.
- F. Wrap each connection with approved electrical tape and carefully stuff all the connected wires into the Outlet Box.

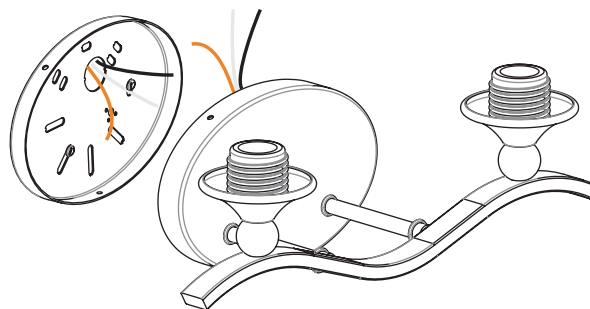

Figure 2

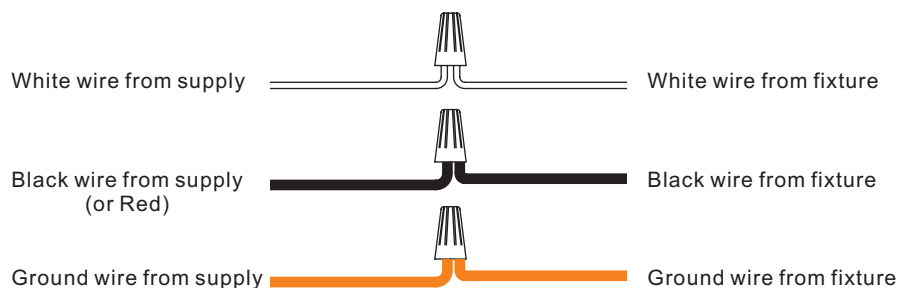

Figure 3

Thank you for purchasing a Quoizel product.

Need assistance with parts or assembly? Call Quoizel customer service at 1-631-273-2700
or visit us on-line at www.quoizel.com

Assembly Instruction Sheet #IS-SPH8702PN For Style SPH8702PN

STEP 3 – Attach Fixture Body to Outlet Box

- A. Attach the Backplate over the Inner Backplate (A) and secure with the Mounting Screws (F). Flathead screwdriver tighten until snug.

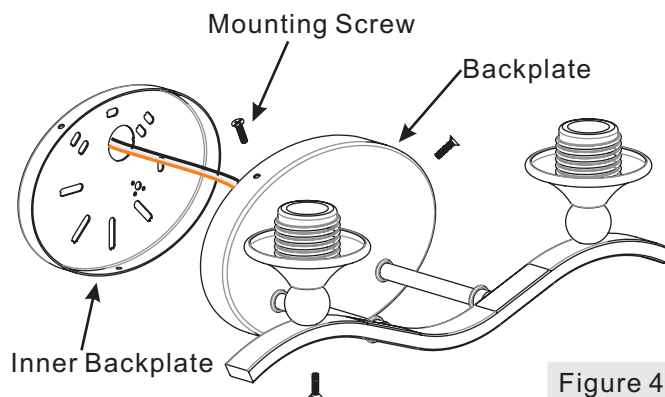

Figure 4

STEP 4 – Attach Shade to Fixture Body

- A. Place the Shade (D) over the Socket as shown. By using the Socket Collar Tool (F), thread the Socket Collar (E) onto the Socket to secure the Shade (D). Hand tighten until snug.

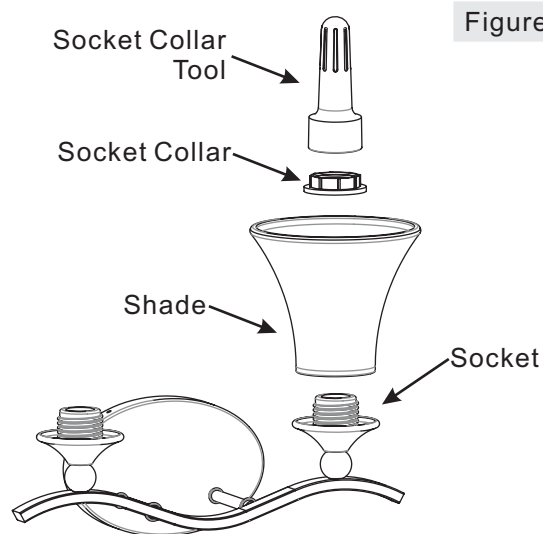

Figure 5

STEP 5 – Install Bulb

- A. This fixture uses standard bulbs with a standard screw base. Maximum 100 watts.
B. Insert bulb and screw properly into place.

Your fixture is now assembled and ready to use.
Enjoy!

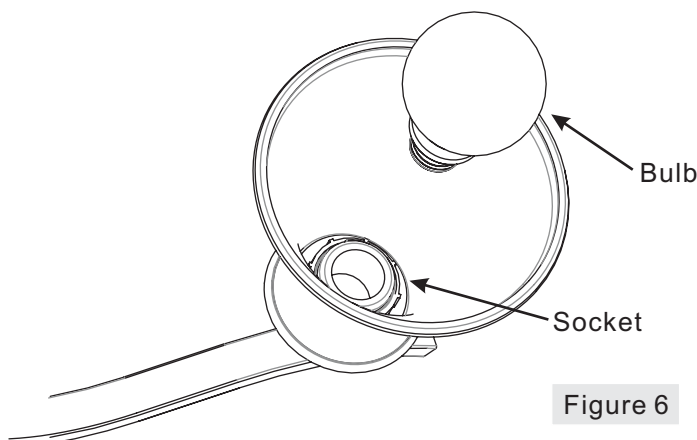

Figure 6

Thank you for purchasing a Quoizel product.

Need assistance with parts or assembly? Call Quoizel customer service at 1-631-273-2700
or visit us on-line at www.quoizel.com