

# QUOIZEL

6 CORPORATE PARKWAY  
GOOSE CREEK, SC. 29445  
[www.quoizel.com](http://www.quoizel.com)

Quoizel, Inc.  
6 Corporate Parkway  
Goose Creek, SC  
29445

Customer Service  
Phone 631.273.2700  
Fax 631.231.7102  
[www.quoizel.com](http://www.quoizel.com)

## Assembly Instruction Sheet #IS-TF8156Z For Style TF8156Z

**Tools Required:** Flathead screwdriver, Phillips screwdriver, pliers, wire cutters, wire strippers, electrical tape, safety glasses.

**Bulb Recommended:** (1) T3 Bi Pin Bulb 50W Maximum (Supplied)

**Estimated Assembly Time:** 20-30 minutes

**Preparation:** Identify and inspect all parts before beginning installation. Check package content list and diagrams below to be sure all parts are present. If any parts are missing or damaged, do not attempt to assemble, install, or operate the fixture. Contact customer service for replacement parts.



### Warnings and Cautions

Turn off electricity at circuit breaker or main fuse box before installation. Consult a licensed electrician if in doubt.

These instructions are provided for your safety. It is very important you read them completely before installing the fixture. We strongly recommend that a licensed, professional electrician perform the installation.

Disconnect fixture from power source before replacing bulbs. Make sure bulbs are given sufficient time to cool before removal. Do not subject glass parts to any shock while in operation or shattering October result.

Do not touch the bulb with bare hands use a cloth or glove.

### Package Contents

Part	Description	Quantity
A	Inner Backplate	1 pc.
B	Mounting Ball	2 pcs.
C	Fixture Body	1 pc.
D	Shade	1 pc.
E	Lock Ball	2 pcs.
F	Diffuser	1 pc.
G	T3 Bulb	1 pc.
H	Wall Anchor	10 pcs.
I	Self-tapping Screw	10 pcs.
J	Cord Cover Backplate	2 pcs.
K	Cord Cover	2 pcs.

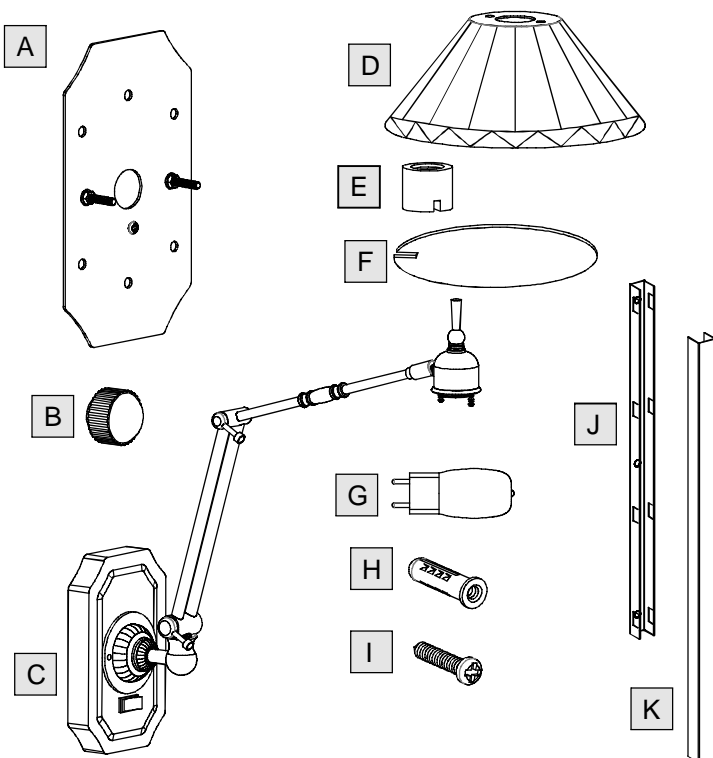

Thank you for purchasing a Quoizel product.

Need assistance with parts or assembly? Call Quoizel customer service at 1-631-273-2700  
or visit us on-line at [www.quoizel.com](http://www.quoizel.com)

TF8156Z

FINISH: MEDICI BRONZE

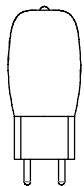
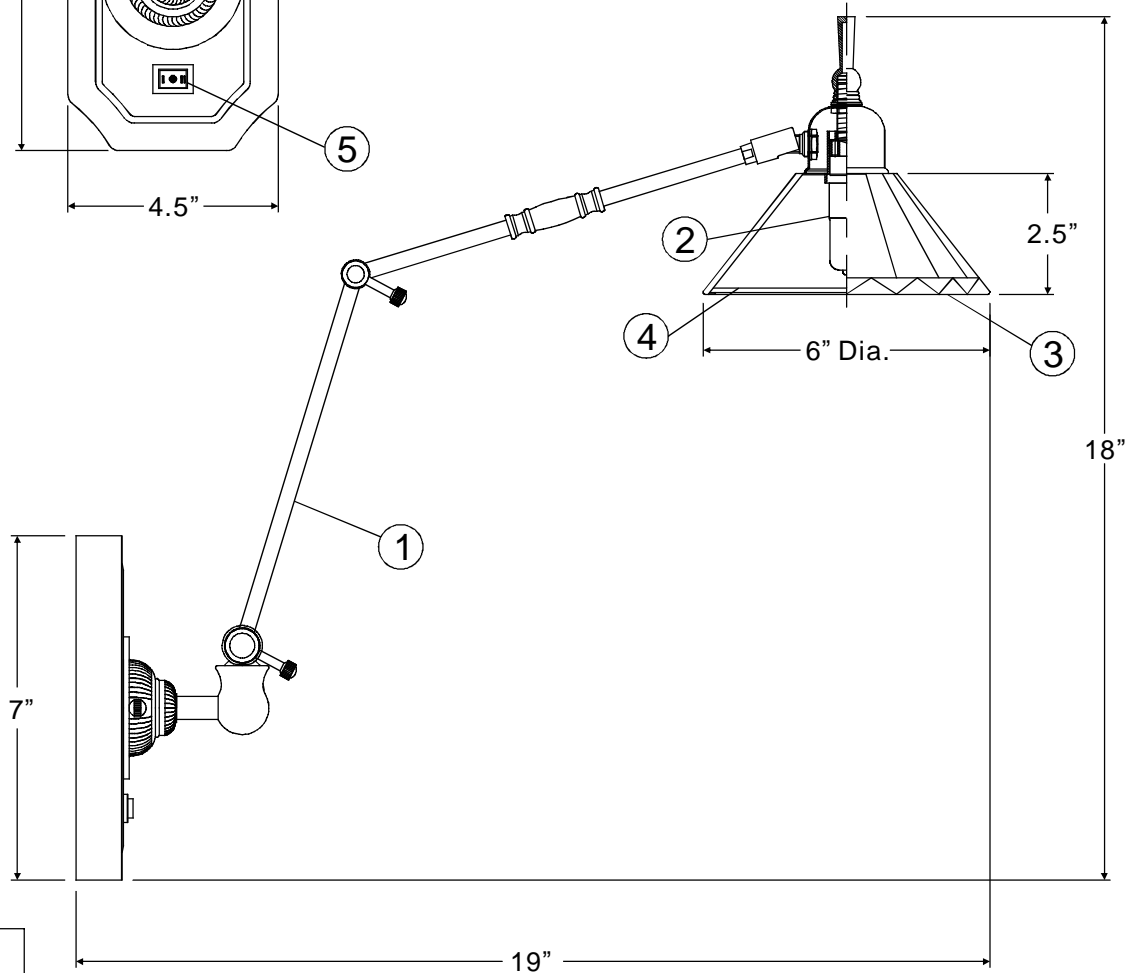
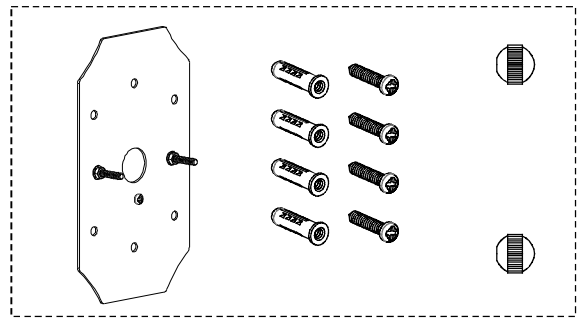
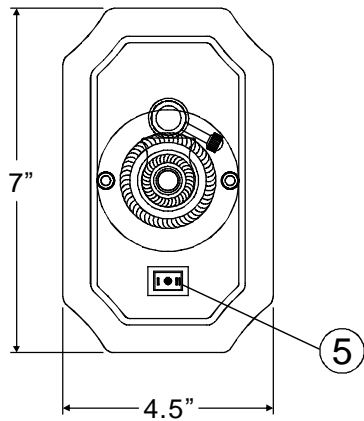
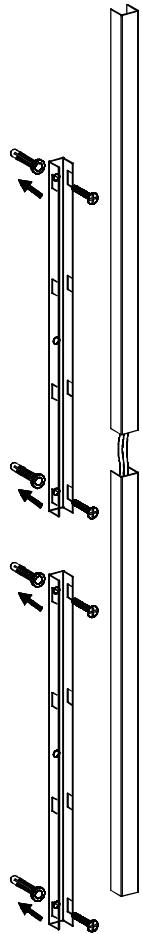

(1)50W T3 BI  
PIN BULB  
(Supplied)

NOTE: ALL DIMENSIONS ARE ROUNDED UP TO THE NEAREST 1/2"

NO.	PART NUMBER	REPLACEMENT PART DESCRIPTION	REQ.
1	98156ZTF	BASE HALOGEN WALL LIGHT BRONZE	1
2	I816SC	BULB 50W 120V HALOGEN GY6.35 CLEAR	1
3	G6220SH1	GLASS TIFFANY TASK W/TABS	1
4	G262LEX	LENS GLASS 4-7/8X1/8 SAFETY	1
5	K729SWK	SWITCH REPLACEMENT Tf7110	1

# Assembly Instruction Sheet #IS-TF8156Z For Style TF8156Z

## For Wall Mount Portable

### STEP 1 - Mark Points on the Wall

- A. Attach the Inner Backplate (A) onto the desired location on the wall surface. Mark four points on the wall surface from the holes on the Inner Backplate (A) that you would like to pass Self-tapping Screws (I).

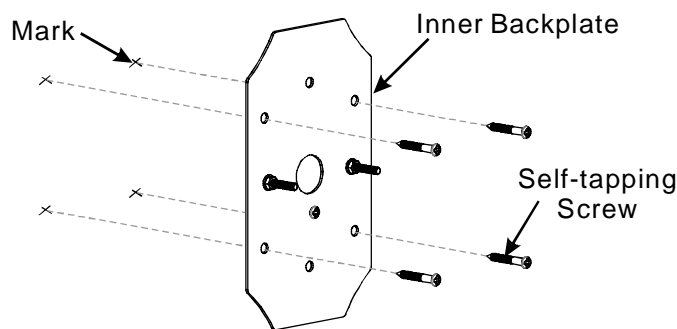

Figure 1

### STEP 2 - Install Inner Backplate

- A. Drill proper holes for Wall Anchors (H) on the marked points on the wall surface.  
B. Insert the Wall Anchors (H) into the drilled holes on the wall surface. Attach the Inner Backplate (A) onto the wall surface. Secure by threading Self-tapping Screws (I) into the Wall Anchors (H). Hand tighten until snug.

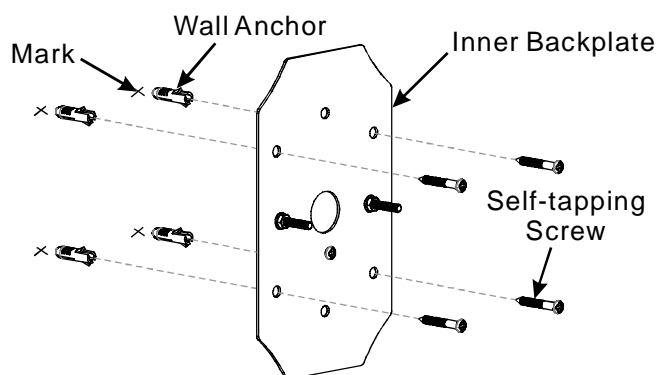

Figure 2

### STEP 3 - Attach Fixture Body to Mounting Screw

- A. Place the Backplate of the Fixture Body (C) over the Mounting Screws on the Inner Backplate (A) and secure with Mounting Balls (B). Hand tighten until snug.

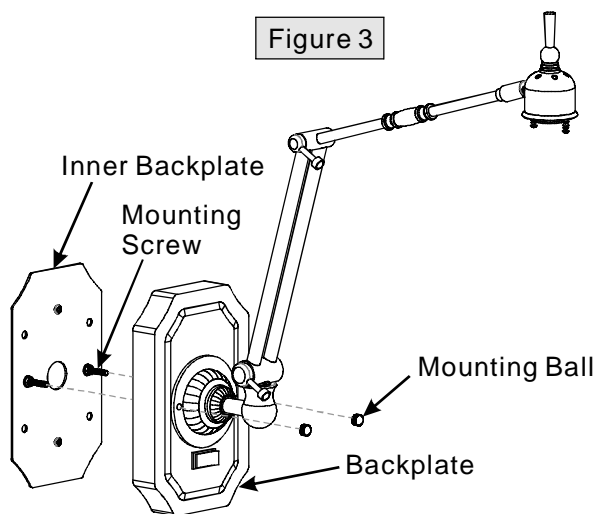

Figure 3

Thank you for purchasing a Quoizel product.

Need assistance with parts or assembly? Call Quoizel customer service at 1-631-273-2700  
or visit us on-line at [www.quoizel.com](http://www.quoizel.com)

# Assembly Instruction Sheet #IS-TF8156Z For Style TF8156Z

## STEP 4 - Attach Cord Cover Backplate and Cord Cover

- Locate the Cord Cover Backplate (K). To position the Cord Cover Backplate (J) measure approx. 12 1/2" inches down from the base of the Backplate. Mark the points from the holes on the Cord Cover Backplate (J) for Wall Anchors (H).
- Using a portable hand drill, drill proper holes from the marks in the wall surface for the Wall Anchors (H). Locate the Wall Anchors (H) and place into the holes in the wall surface.
- Place the Cord Cover Backplate (J) and match the holes with the Wall Anchors (H). Secure it by threading the Self-tapping Screws (I) into the Wall Anchors (H). Hand tighten until snug.
- Position the Supply Wire inside of the Cord Cover Backplate (J) so that it will not be pinched. Locate the Cord Cover (K) and secure it to the Cord Cover Backplate (J) by pressing it over the Backplate.

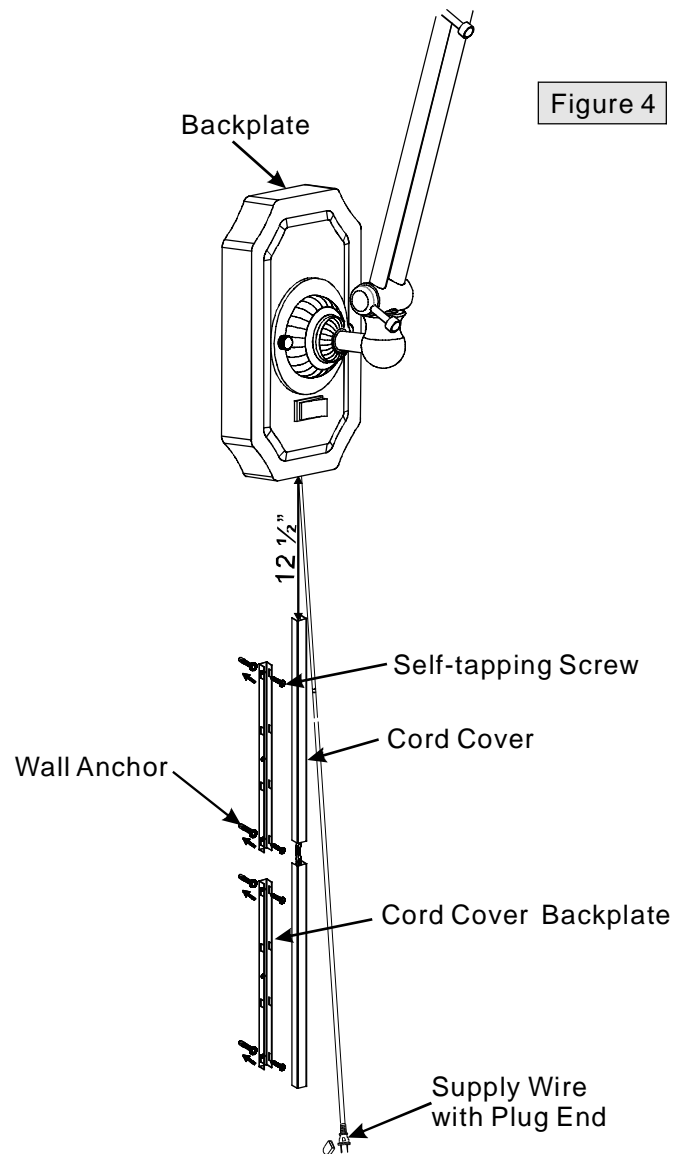

## STEP 5 - Install Shade

- Attach the Shade (D) to the Socket Assembly. Pass the Bolts on the Socket Assembly through the Small Holes on the bottom of the Shade (D). Secure by threading the Lock Balls (E) onto the Bolts. Hand tighten until snug.

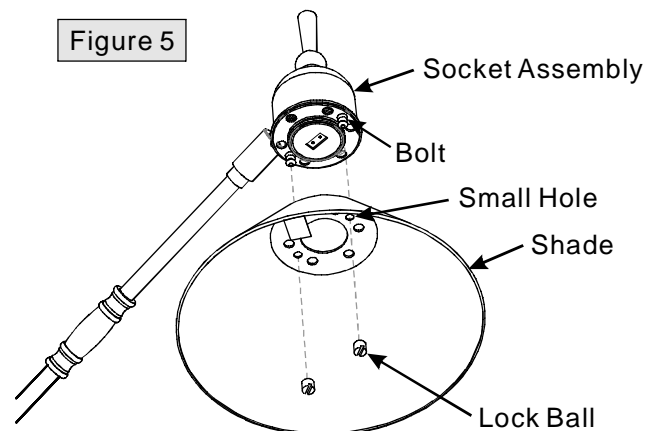

Thank you for purchasing a Quoizel product.

Need assistance with parts or assembly? Call Quoizel customer service at 1-631-273-2700  
or visit us on-line at [www.quoizel.com](http://www.quoizel.com)

# Assembly Instruction Sheet #IS-TF8156Z

## For Style TF8156Z

### STEP 6 - Install Bulb

- This fixture uses T3 Bi Pin bulb. Maximum 50 watts.
- Insert bulb and push snugly into place.

**IMPORTANT:** Do not touch the bulb with bare hands use a cloth or glove.

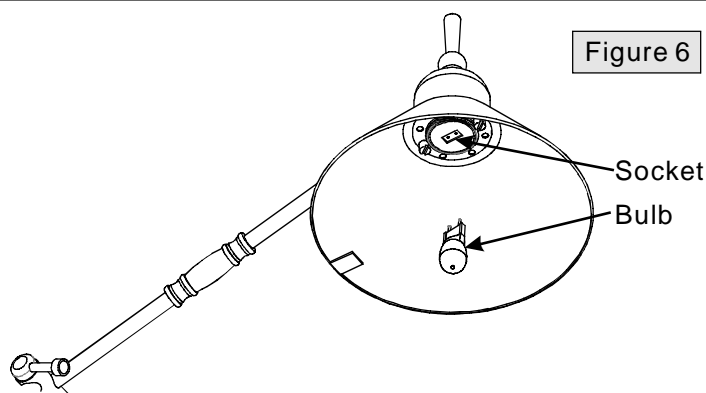

### STEP 7 - Install Diffuser to Shade

- Pass the Gaps on the Diffuser (I) over the Tabs on the Shade (G) and then rotate the Diffuser (I). Do not free your hands until the diffuser is seated onto the tabs.

Your fixture is now assembled and ready to use.  
Enjoy!

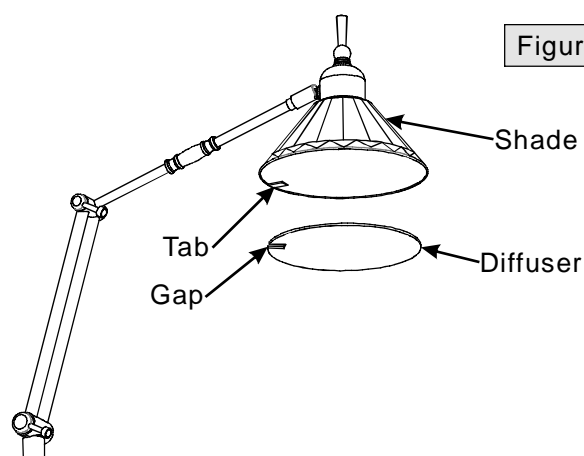

## For Fixed Wall Mount

### STEP 8 - Install Inner Backplate

- Attach the Inner Backplate (A) over the Outlet Box on the wall surface. Mark four points on the wall surface from the holes on the Inner Backplate (A) that you would like to pass Self-tapping Screws (I).
- Drill proper holes for Wall Anchors (H) on the marked points on the wall surface.
- Insert the Wall Anchors (H) into the drilled holes on the wall surface. Attach the Inner Backplate (A) onto the wall surface. Secure by threading Self-tapping Screws (I) into the Wall Anchors (H). Hand tighten until snug.

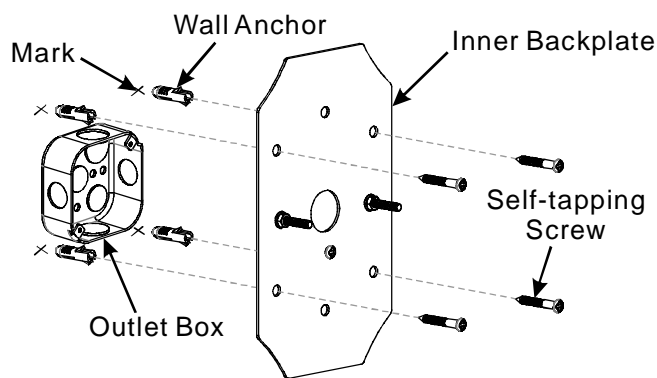

Figure 8

Thank you for purchasing a Quoizel product.

Need assistance with parts or assembly? Call Quoizel customer service at 1-631-273-2700  
or visit us on-line at [www.quoizel.com](http://www.quoizel.com)

# Assembly Instruction Sheet #IS-TF8156Z

## For Style TF8156Z

### STEP 9 - Make Wire Connections

- Pull out the Supply Wire with Plug End and cut down it, left 6" cord for the Wire Connection.
- Use standard wire connectors to make all wire connections. (Connectors are not included with fixture.) Strip and prepare wire ends according to instructions supplied with connectors.
- Connect White Supply Wire from the Outlet Box to Ribbed side from fixture.
- Connect Black (or Red) Supply Wire from the Outlet Box to Smooth side from fixture.
- Twist connectors until wires are tightly joined together.
- Wrap each connection with approved electrical tape and carefully stuff all the connected wires into the Outlet Box.

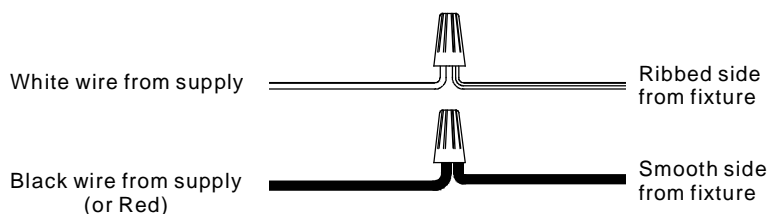

Figure 10

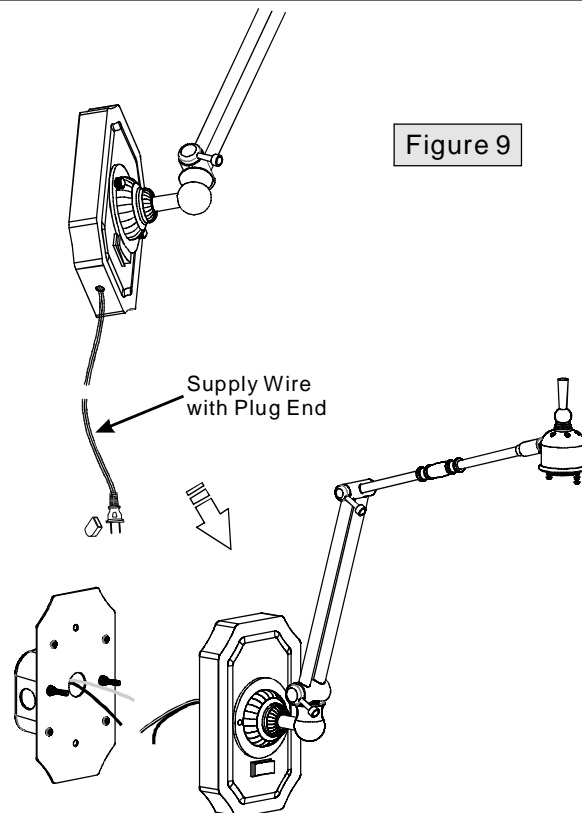

Figure 9

### STEP 10 - Attach Fixture Body to Mounting Screw

- Place the Backplate of the Fixture Body (C) over the Mounting Screws on the Inner Backplate (A) and secure with Mounting Balls (B). Hand tighten until snug.
- Assembly Shade as step 5.
- Install bulb as step 6.
- Install Diffuser as step 7.

Your fixture is now assembled and ready to use.  
Enjoy!

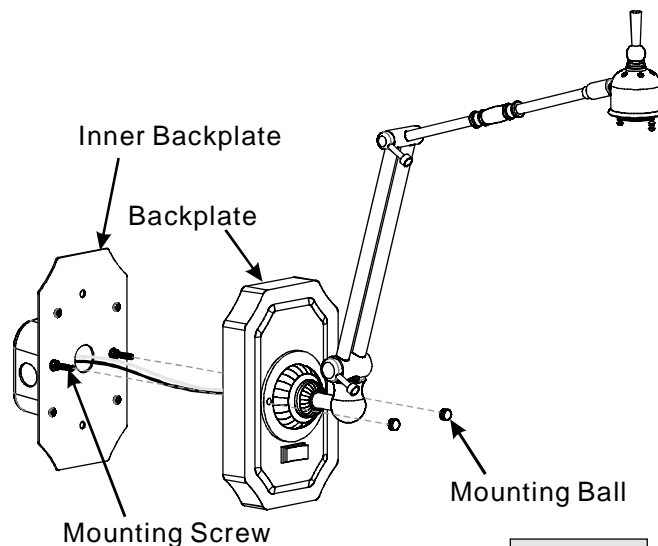

Figure 11

Thank you for purchasing a Quoizel product.

Need assistance with parts or assembly? Call Quoizel customer service at 1-631-273-2700  
or visit us on-line at [www.quoizel.com](http://www.quoizel.com)