

Quoizel, Inc.  
6 Corporate Parkway  
Goose Creek, SC  
29445

Customer Service  
Phone 631.273.2700  
Fax 631.231.7102  
www.quoizel.com

## Assembly Instruction Sheet #IS-TFZA2818WT For Style TFZA2818WT

**Tools Required:** Flathead screwdriver, Phillips screwdriver, pliers, wire cutters, wire strippers, electrical tape, safety glasses.

**Bulb Recommended:** (3) Medium Base 100W Maximum

**Estimated Assembly Time:** 30-45 minutes

**Preparation:** Identify and inspect all parts before beginning installation. Check package content list and diagrams below to be sure all parts are present. If any parts are missing or damaged, do not attempt to assemble, install, or operate the fixture. Contact customer service for replacement parts.



### Warnings and Cautions

Turn off electricity at circuit breaker or main fuse box before installation. Consult a licensed electrician if in doubt.

These instructions are provided for your safety. It is very important you read them completely before installing the fixture. We strongly recommend that a licensed, professional electrician perform the installation.

Disconnect fixture from power source before replacing bulbs. Make sure bulbs are given sufficient time to cool before removal. Do not subject glass parts to any shock while in operation or shattering may result.

### Package Contents

Part	Description	Quantity
A	Crossbar	1 pc.
B	Nipple	1 pc.
C	Lock Washer	1 pc.
D	Hex Nut	2 pcs.
E	Finial	2 pcs.
F	Quick Link	2 pcs.
G	Center Stem Assembly	1 pc.
H	6" Rod	2 pcs.
I	6" Rod with Loop	2 pcs.
J	12" Rod	4 pcs.
K	Ceiling Canopy	1 pc.
L	Socket Assembly	1 pc.
M	Shade	1 pc.
N	Cap	1 pc.
O	Flat Washer	2 pcs.

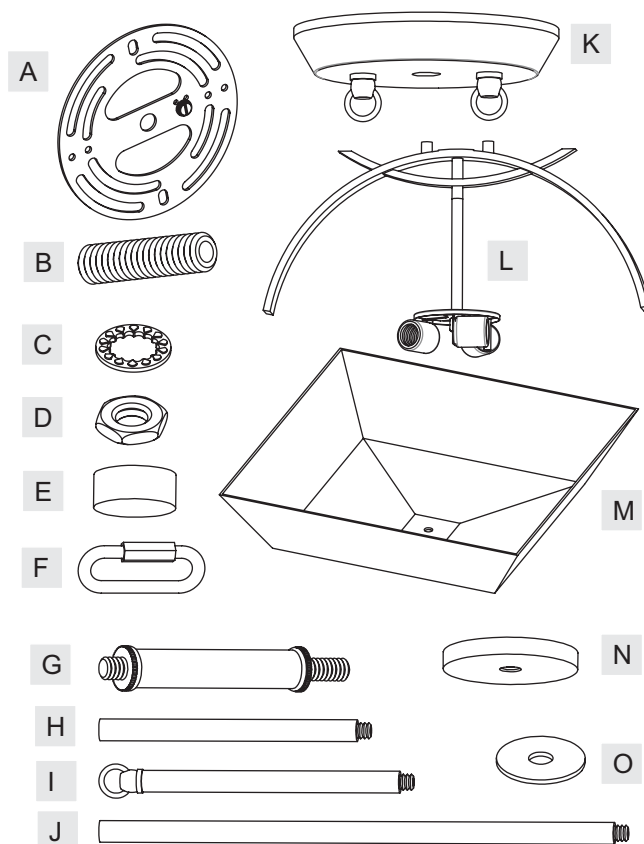

Thank you for purchasing a Quoizel product.

Need assistance with parts or assembly? Call Quoizel customer service at 1-631-273-2700  
or visit us on-line at [www.quoizel.com](http://www.quoizel.com)

TFZA2818WT

FINISH: WESTERN BRONZE

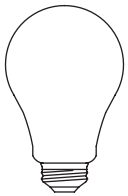
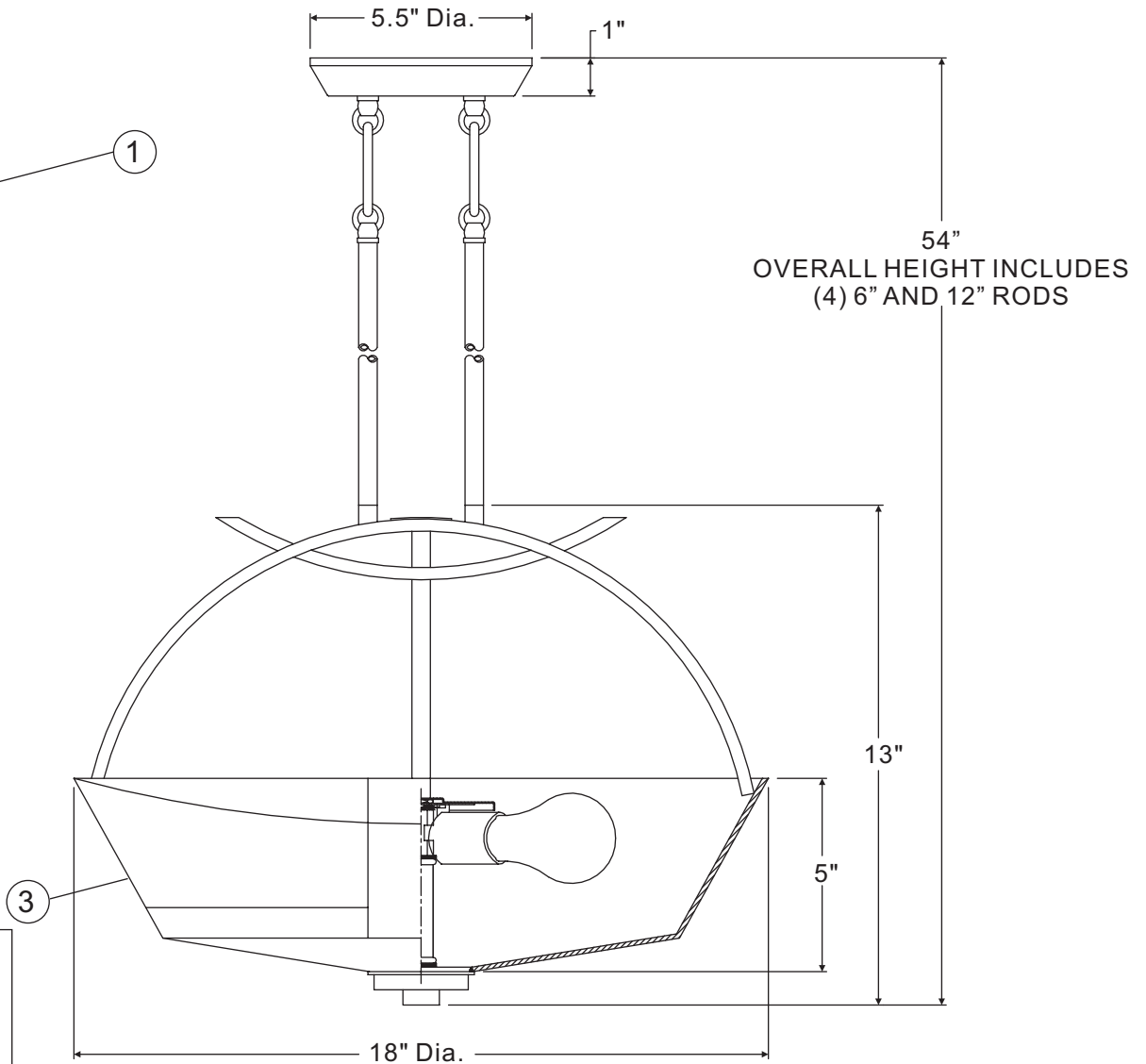
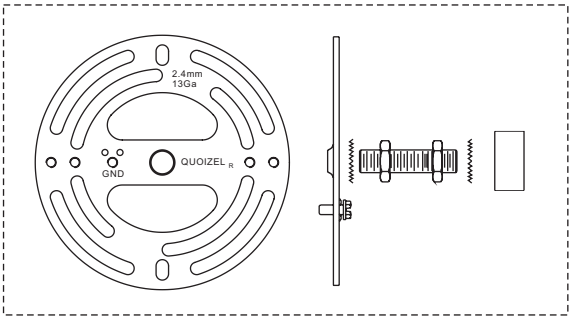
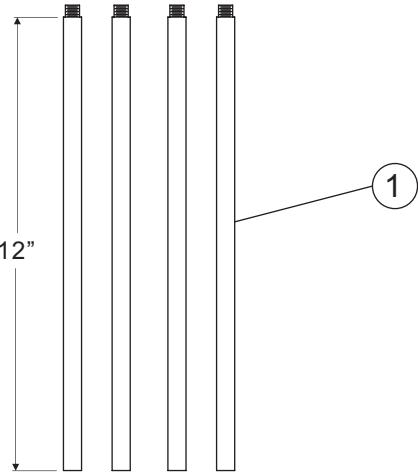
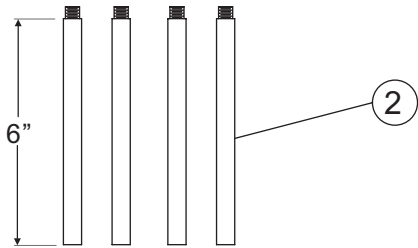

(3) 100W A19  
Medium Base Bulbs  
(Not Supplied)

NOTE: ALL DIMENSIONS ARE ROUNDED UP TO THE NEAREST 1/2"

NO.	PART NUMBER	REPLACEMENT PART DESCRIPTION	REQ.
1	9012EXWT	ROD EXT WESTERN BRONZE 12"L X 0.5"D	2
2	9006EXWT	ROD EXT WESTERN BRONZE 6"L X 0.5"D	2
3	G2980SH	SHADE TIFFANY BODY 18"SQ X 5.5"H	1

## Assembly Instruction Sheet #IS-TFZA2818WT For Style TFZA2818WT

### STEP 1 – Assemble Rods

- A. Determine the Rods (H/I/J) to be assembled to the Socket Assembly (L) according to your hanging height.
- B. Pass Supply Wires and Ground Wire through the chosen Rods (H/I/J) and then thread the chosen Rods (H/I/J) and the Socket Assembly (L) together. Hand tighten until snug.

Figure 1

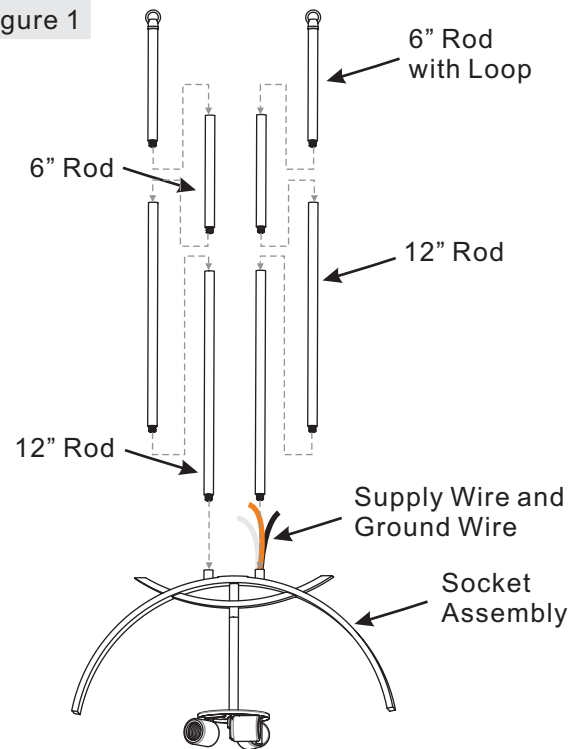

### STEP 2 – Assemble Ceiling Canopy to 6" Rod with Loop

- A. Pass Supply Wires and Ground Wire through the Quick Link (F) and the Ceiling Canopy (K). Connect the Ceiling Canopy (K) and the 6" Rod with Loop (I) with the Quick Link (F).

Figure 2

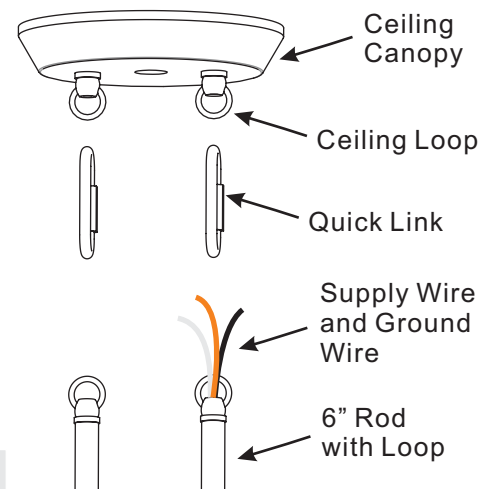

Thank you for purchasing a Quoizel product.  
Need assistance with parts or assembly? Call Quoizel customer service at 1-631-273-2700  
or visit us on-line at [www. quoizel. com](http://www. quoizel. com)

## Assembly Instruction Sheet #IS-TFZA2818WT For Style TFZA2818WT

### STEP 3 – Attach Crossbar to Outlet Box

- A. Secure the Crossbar (A) to the outlet box with outlet box screws (not supplied). Tighten until snug.

Figure 3

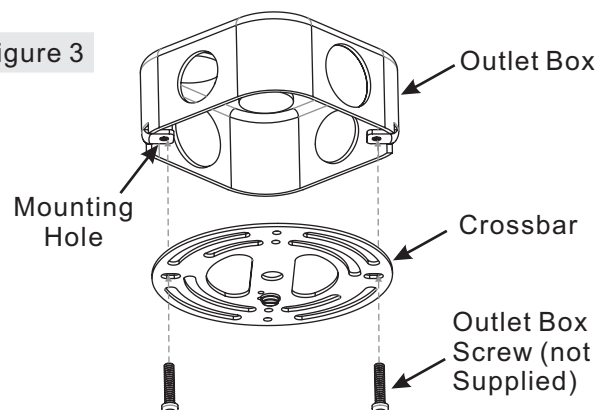

### STEP 4 – Attach Nipple to Crossbar

- A. Thread one Hex Nut (D) onto the top end of the Nipple (B).  
B. Place one Lock Washer (C) over the top end of the Nipple (B) and then thread the Nipple (B) into the center lock hole of the Crossbar (A).  
C. Using pliers, thread the hex Nut (D) against the Crossbar (A) and hand tighten until snug.

Figure 4

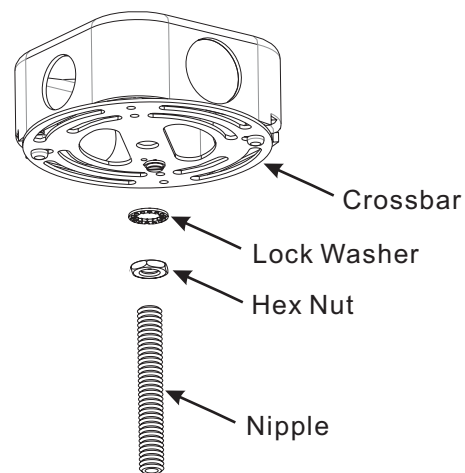

### STEP 5 – Attach Lanyard

- A. The purpose of the lanyard is to provide the installer a means to support the fixture from the junction box while connecting the electrical wires. This enables the fixture to hang from the junction box and your hands are free to make the wire connections.  
B. Turn the Button Stop so it may be inserted into the crossbar slot. Make sure the Button Stop is completely inside the crossbar. Slowly release the fixture to make sure it is supported by the Button Stop. Proceed to the wiring steps. Once you are complete with the wiring there is nothing to do with Lanyard. The Lanyard will push into the junction box when the fixture is placed for final mounting.

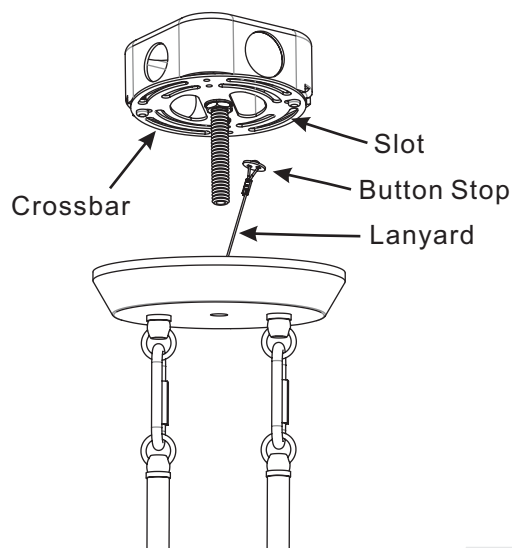

Figure 5

**Thank you for purchasing a Quoizel product.**  
**Need assistance with parts or assembly? Call Quoizel customer service at 1-631-273-2700**  
**or visit us on-line at [www.quoizel.com](http://www.quoizel.com)**

## Assembly Instruction Sheet #IS-TFZA2818WT For Style TFZA2818WT

### STEP 6 – Make Wire Connections

- A. Use standard wire connectors to make all wire connections. (Connectors are not included with fixture.) Strip and prepare wire ends according to instructions supplied with connectors.
- B. Connect White Supply Wire from the Outlet Box to White Wire from fixture.
- C. Connect Black (or Red) Supply Wire from the Outlet Box to Black Wire from fixture.
- D. Connect Ground Wire from the Outlet Box to Ground Wire from fixture.
- E. Twist connectors until wires are tightly joined together.
- F. Wrap each connection with approved electrical tape and carefully stuff all the connected wires into the Outlet Box.

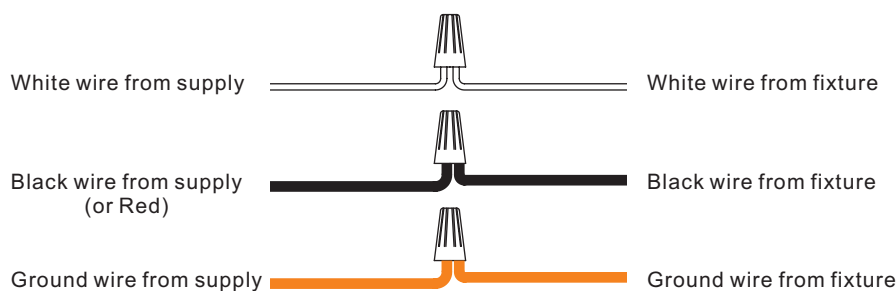

Figure 7

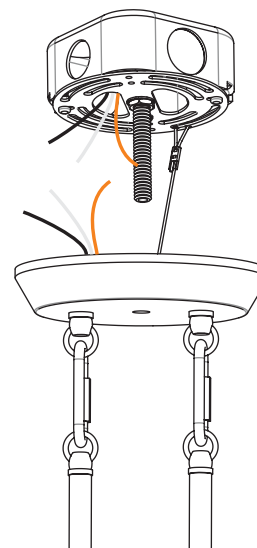

Figure 6

### STEP 7 – Attach Ceiling Canopy

- A. Pass the Ceiling Canopy (K) over the end of the Nipple (B). Secure by threading the Finial (E) onto the Nipple (B). Hand tighten until snug.

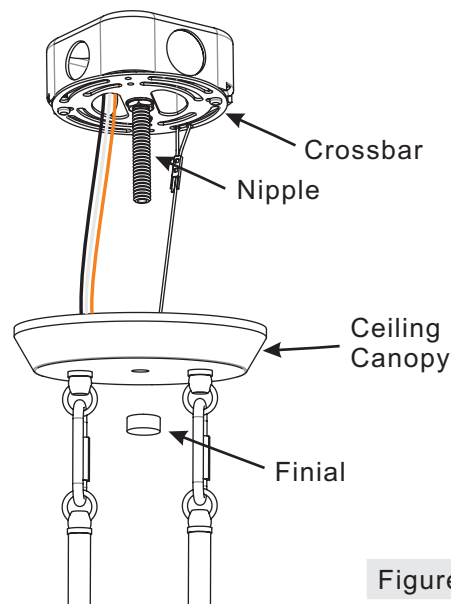

Figure 8

**Thank you for purchasing a Quoizel product.**  
**Need assistance with parts or assembly? Call Quoizel customer service at 1-631-273-2700**  
**or visit us on-line at [www.quoizel.com](http://www.quoizel.com)**

## Assembly Instruction Sheet #IS-TFZA2818WT For Style TFZA2818WT

### STEP 8 – Thread Center Stem Assembly to Socket Assembly

- A. Thread short nipple end of the Center Stem Assembly (G) to the hex coupling underside of the Socket Assembly (L). Hand tighten until snug.

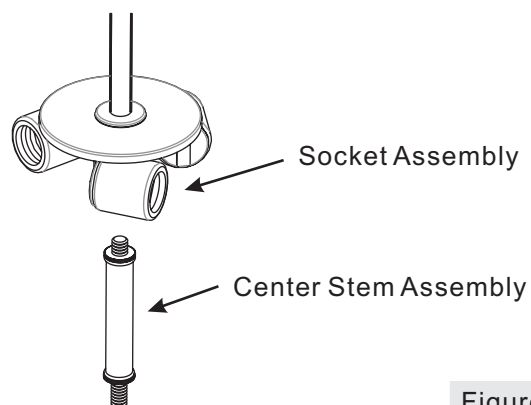

Figure 9

### STEP 9 – Attach Shade

- A. Pass the Flat Washers (O) and the Shade (M) over the end of the Center Stem Assembly (G) as shown. Secure by threading the Hex Nut (D) onto the Center Stem Assembly (G). Tighten until snug.

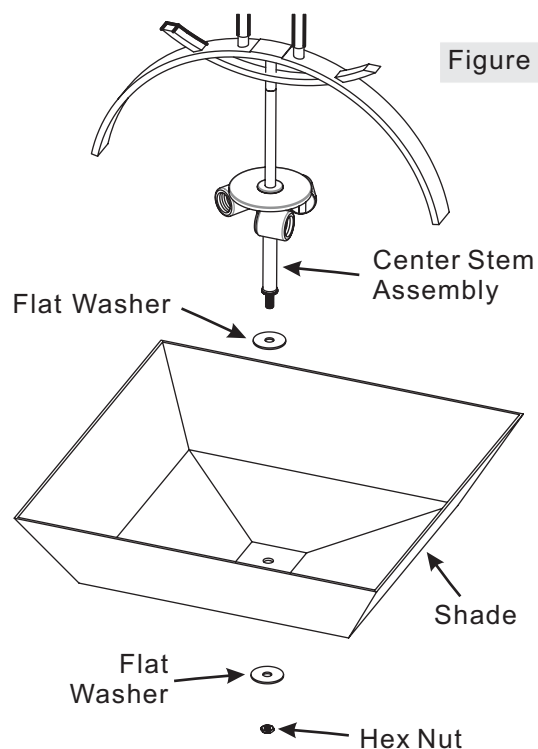

Figure 10

Thank you for purchasing a Quoizel product.

Need assistance with parts or assembly? Call Quoizel customer service at 1-631-273-2700  
or visit us on-line at [www. quoizel. com](http://www. quoizel. com)

## Assembly Instruction Sheet #IS-TFZA2818WT For Style TFZA2818WT

### STEP 10 – Attach Cap

- A. Place the Cap (N) over the Nipple extruding from the Shade (M). Secure by threading the Finial (E) onto the Nipple. Hand tighten until snug.

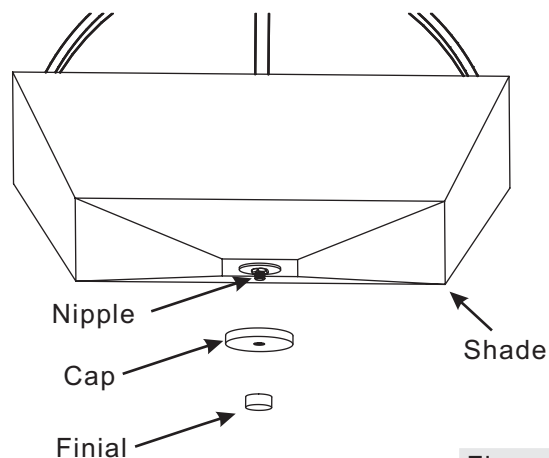

Figure 11

### STEP 11 – Install Bulb

- A. This fixture uses standard bulb with a medium screw base. Maximum 100 watts.  
B. Insert bulb and screw snugly into place.

Your fixture pendant lamp is now assembled and ready to use. Enjoy!

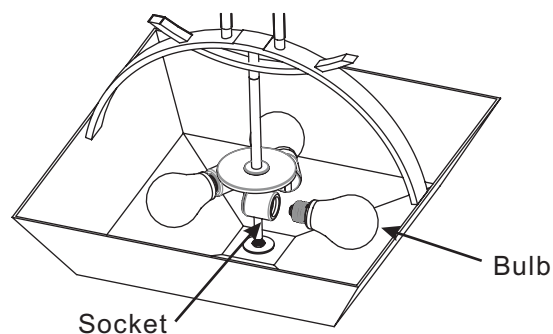

Figure 12

**Thank you for purchasing a Quoizel product.**  
**Need assistance with parts or assembly? Call Quoizel customer service at 1-631-273-2700**  
**or visit us on-line at [www.quoizel.com](http://www.quoizel.com)**