

Quoizel, Inc.
6 Corporate Parkway
Goose Creek, SC
29445

Customer Service
Phone 631.273.2700
Fax 631.231.7102
www.quoizel.com

Assembly Instruction Sheet #IS-UPAR5008C For Style UPAR5008C

Tools Required: Flathead screwdriver, Phillips screwdriver, pliers, wire cutters, wire strippers, electrical tape, safety glasses.

Bulb Recommended: (8) Frosted G9 Halogen 75W Maximum (supplied)

Estimated Assembly Time: 30-45 minutes

Preparation: Identify and inspect all parts before beginning installation. Check package content list and diagrams below to be sure all parts are present. If any parts are missing or damaged, do not attempt to assemble, install, or operate the fixture. Contact customer service for replacement parts.



Warnings and Cautions

Turn off electricity at circuit breaker or main fuse box before installation. Consult a licensed electrician if in doubt.

These instructions are provided for your safety. It is very important you read them completely before installing the fixture. We strongly recommend that a licensed, professional electrician perform the installation.

Disconnect fixture from power source before replacing bulbs. Make sure bulbs are given sufficient time to cool before removal. Do not subject glass parts to any shock while in operation or shattering may result.

Do not touch the bulb with bare hands use a cloth or glove.

Package Contents

Part	Description	Quantity
A	Crossbar	1 pc.
B	Nipple	1 pc.
C	Lock Washer	1 pc.
D	Hex Nut	1 pc.
E	Finial	1 pc.
F	6" Rod	6 pcs.
G	12" Rod	6 pcs.
H	Ceiling Canopy	1 pc.
I	Shade	4 pcs.
J	Socket Collar	8 pcs.
K	Steel Collar	8 pcs.
L	Bulb Shield	8 pcs.
M	G9 Bulb	8 pcs.
N	Socket Assembly	1 pc.

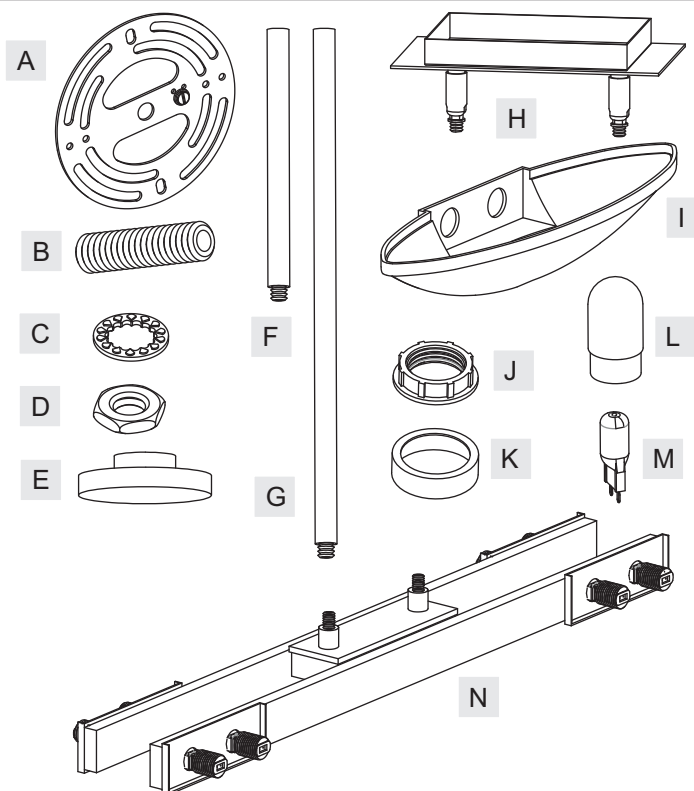

Thank you for purchasing a Quoizel product.

Need assistance with parts or assembly? Call Quoizel customer service at 1-631-273-2700
or visit us on-line at www.quoizel.com

UPAR5008C

FINISH: POLISHED CHROME

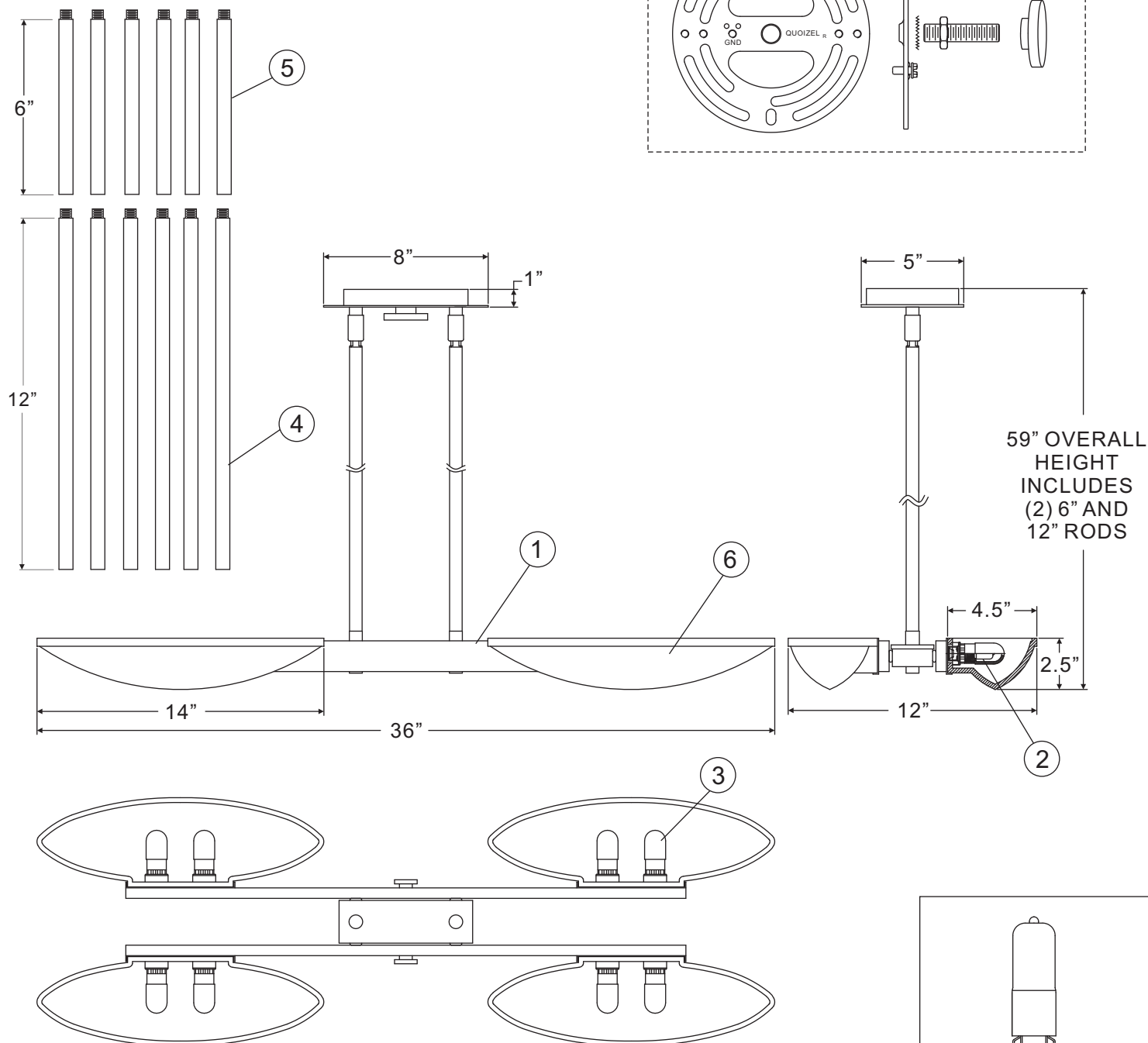
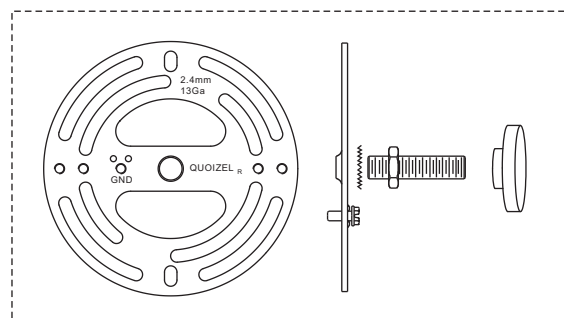

NOTE: ALL DIMENSIONS ARE ROUNDED UP TO THE NEAREST 1/2"

(8) 75W Frosted
G9 Halogen Bulbs
(Supplied)

NO.	PART NUMBER	REPLACEMENT PART DESCRIPTION	REQ.
1	15008CUPAR	BASE CHROME UPAR5008C	1
2	I828SF	BULB 130V 75W HALOGEN G9 FROSTED	8
3	G3293BS	BULB SHIELD FROSTED GLASS 26MM D X 49MM H	8
4	9008EXC	ROD EXTENSION POLISHED CHROME 12"L X 0.63"D	2
5	9007EXC	ROD EXTENSION POLISHED CHROME 6"L X 0.63"D	2
6	G2945SH	SHADE ETCHED W/PNTD WHITE INSIDE	4

Assembly Instruction Sheet #IS-UPAR5008C For Style UPAR5008C

STEP 1 – Assemble Rods

- Determine the Rods (F/G) to be assembled to the Socket Assembly (N) according to your hanging height.
- Pass Supply Wires and Ground Wire through the chosen Rods (F/G) and then thread the chosen Rods (F/G) and the Socket Assembly (N) together. Hand tighten until snug.

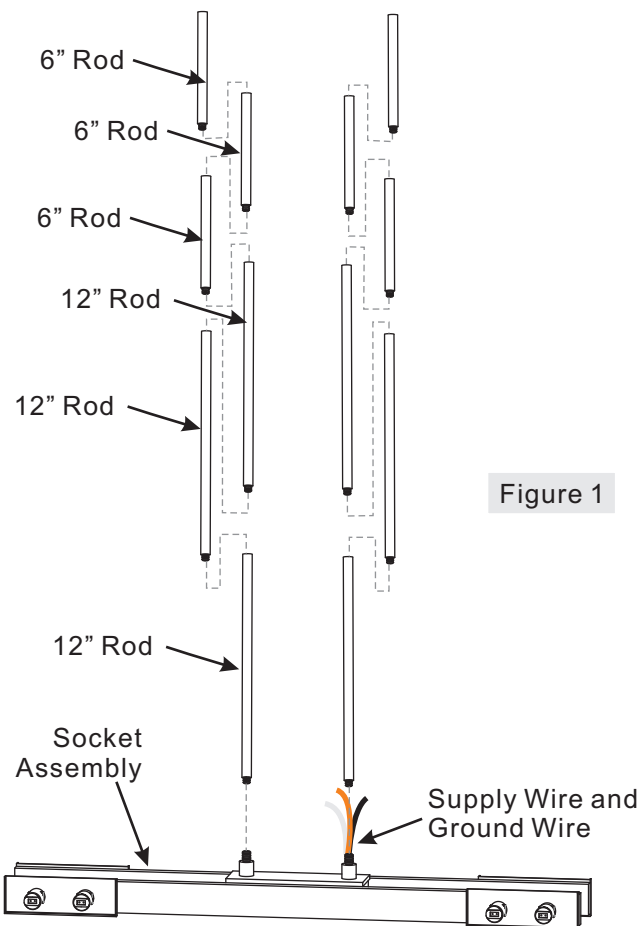

STEP 2 – Disassemble Ceiling Canopy

- Disassemble every single parts pre-assembled on the Ceiling Canopy as shown in the illustration.

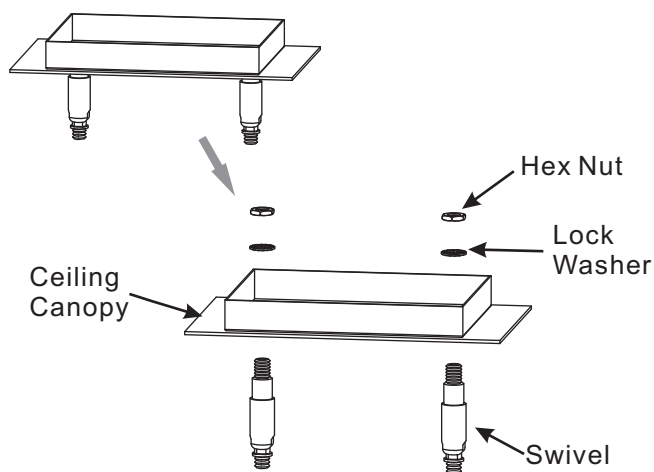

Thank you for purchasing a Quoizel product.
Need assistance with parts or assembly? Call Quoizel customer service at 1-631-273-2700
or visit us on-line at www.quoizel.com

Assembly Instruction Sheet #IS-UPAR5008C For Style UPAR5008C

STEP 3 – Assemble Ceiling Canopy

- Pass the Supply Wires and Ground Wires through Swivels, the Ceiling Canopy, Lock Washers and Hex Nuts.
- Screw the Swivels into the top end of the Upper Rod. Please be sure the directions of two Swivels are the same before hand tighten until snug. This allows the lamp to adjust angles after assembly. (Refer to Figure 3)
- Pass the Ceiling Canopy and Lock Washers over the top end of the Swivels. Secure by threading Hex Nuts onto Swivels. Tighten until snug.

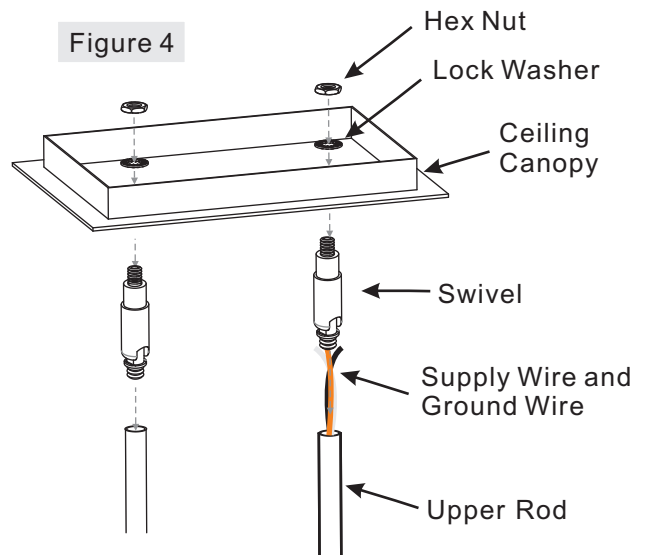
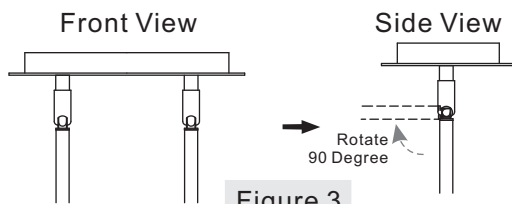

STEP 4 – Attach Crossbar to Outlet Box

- Secure the Crossbar (A) to the outlet box with outlet box screws (not supplied). Tighten until snug.

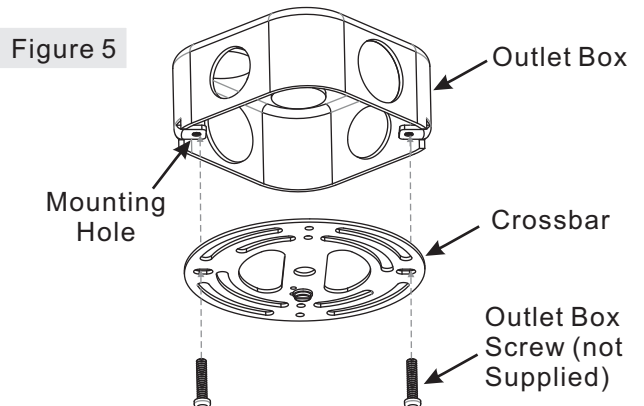

STEP 5 – Attach Nipple to Crossbar

- Thread one Hex Nut (D) onto the top end of the Nipple (B).
- Place one Lock Washer (C) over the top end of the Nipple (B) and then thread the Nipple (B) into the center lock hole of the Crossbar (A).
- Using pliers, thread the hex Nut (D) against the Crossbar (A) and hand tighten until snug.

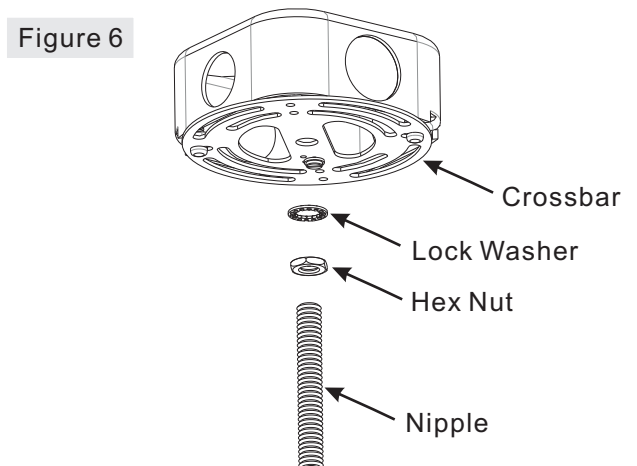

Thank you for purchasing a Quoizel product.

Need assistance with parts or assembly? Call Quoizel customer service at 1-631-273-2700
or visit us on-line at www.quoizel.com

Assembly Instruction Sheet #IS-UPAR5008C For Style UPAR5008C

STEP 6 – Make Wire Connections

- A. Use standard wire connectors to make all wire connections. (Connectors are not included with fixture.) Strip and prepare wire ends according to instructions supplied with connectors.
- B. Connect White Supply Wire from the Outlet Box to White Wire from fixture.
- C. Connect Black (or Red) Supply Wire from the Outlet Box to Black Wire from fixture.
- D. Connect Ground Wire from the Outlet Box to Ground Wire from fixture.
- E. Twist connectors until wires are tightly joined together.
- F. Wrap each connection with approved electrical tape and carefully stuff all the connected wires into the Outlet Box.

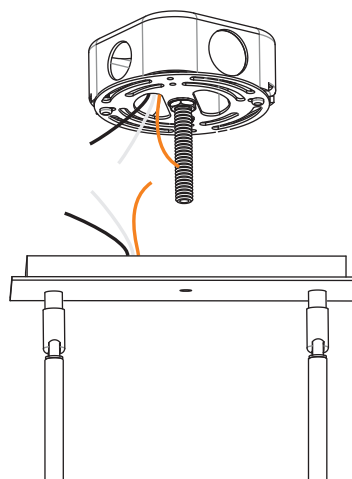

Figure 8

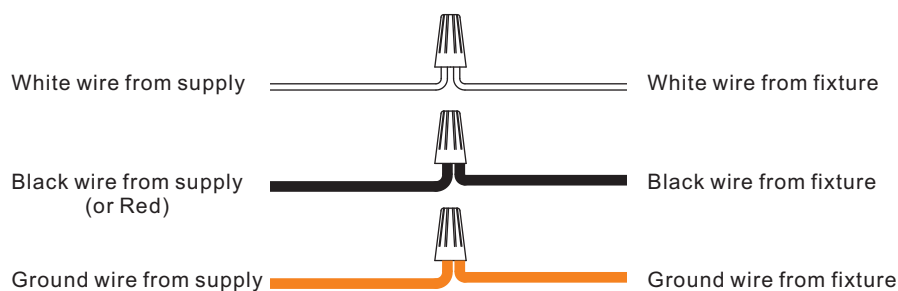

Figure 7

STEP 7 – Attach Ceiling Canopy

- A. Place the Ceiling Canopy (H) over the end of the Nipple (B) and secure with the Finial (E). Hand tighten until snug.

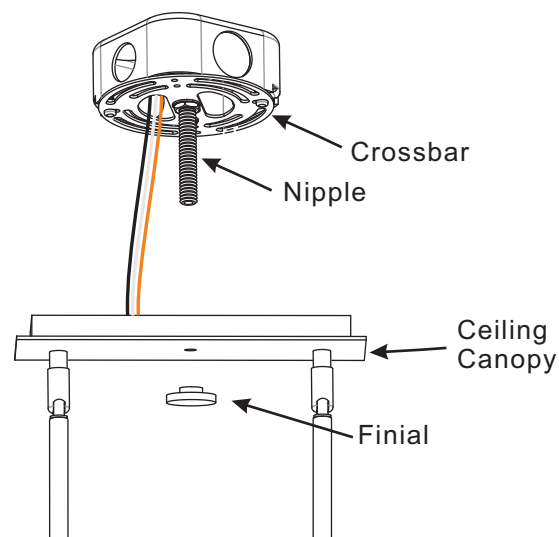

Figure 9

Thank you for purchasing a Quoizel product.
Need assistance with parts or assembly? Call Quoizel customer service at 1-631-273-2700
or visit us on-line at www.quoizel.com

Assembly Instruction Sheet #IS-UPAR5008C For Style UPAR5008C

STEP 8 – Assemble Shade

- A. Place the Shade (I) and Steel Collars (K) over Sockets as shown. Secure by threading Socket Collars (J) onto Sockets. Hand tighten until snug.

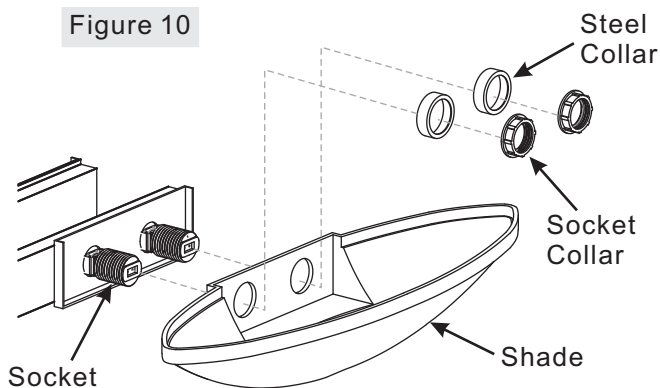

STEP 9 – Install Bulb and Bulb Shield

- A. This fixture uses Frosted G9 Halogen Bulbs (supplied). Maximum 75 watts.
B. Insert bulb and seat properly into place.
C. Screw Bulb Shield (L) onto the Socket and hand tighten until snug.
IMPORTANT: Do not touch the bulb with bare hands use a cloth or glove.

Your fixture is now assembled and ready to use. Enjoy!

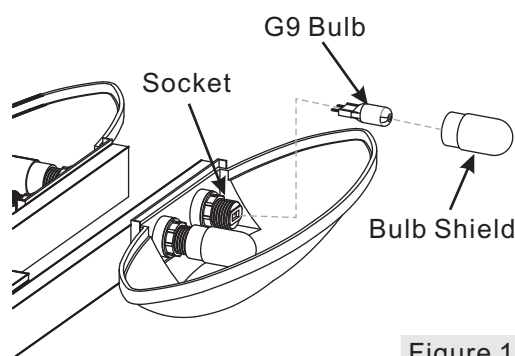

Figure 11

CAUTION FOR BULB REPLACING

- A. When replace bulb, turn off power and allow lamp to cool. For safety purpose, wear gloves and eye protection.
B. If bulb is scratched or cracked, DO NOT use the lamp to avoid breakage during use or installation.
C. Use only in fixtures rated for lamps wattage and voltage.
D. Lamp operate under high pressure generating intense heat. Prevent contact with liquid and combustible materials.

Thank you for purchasing a Quoizel product.

Need assistance with parts or assembly? Call Quoizel customer service at 1-631-273-2700
or visit us on-line at www. quoizel. com