

# QUOIZEL

6 CORPORATE PARKWAY  
GOOSE CREEK, SC. 29445  
[www.quoizel.com](http://www.quoizel.com)

Quoizel, Inc.  
6 Corporate Parkway  
Goose Creek, SC  
29445

Customer Service  
Phone 631.273.2700  
Fax 631.231.7102  
[www.quoizel.com](http://www.quoizel.com)

## Assembly Instruction Sheet #IS-WSN8604Z For Style WSN8604Z

**Tools Required:** Flathead screwdriver, Phillips screwdriver, pliers, wire cutters, wire strippers, electrical tape, safety glasses.

**Bulb Recommended:** (4) G9 Frosted Halogen Bulbs 60W Maximum

**Estimated Assembly Time:** 20-30 minutes

**Preparation:** Identify and inspect all parts before beginning installation. Check package content list and diagrams below to be sure all parts are present. If any parts are missing or damaged, do not attempt to assemble, install, or operate the fixture. Contact customer service for replacement parts.



### Warnings and Cautions

Turn off electricity at circuit breaker or main fuse box before installation. Consult a licensed electrician if in doubt.

These instructions are provided for your safety. It is very important you read them completely before installing the fixture. We strongly recommend that a licensed, professional electrician perform the installation.

Disconnect fixture from power source before replacing bulbs. Make sure bulbs are given sufficient time to cool before removal. Do not subject glass parts to any shock while in operation or shattering October result.

Do not touch the bulb with bare hands use a cloth or glove.

### Package Contents

| Part | Description        | Quantity |
|------|--------------------|----------|
| A    | Inner Backplate    | 1 pc.    |
| B    | Mounting Screw     | 2 pcs.   |
| C    | G9 Bulb            | 4 pcs.   |
| D    | Socket Collar      | 4 pcs.   |
| E    | Steel Washer       | 4 pcs.   |
| F    | Socket Collar Tool | 1 pc.    |
| G    | Shade              | 4 pcs.   |
| H    | Fixture Body       | 1 pc.    |
| I    | Bulb Shield        | 4 pcs.   |

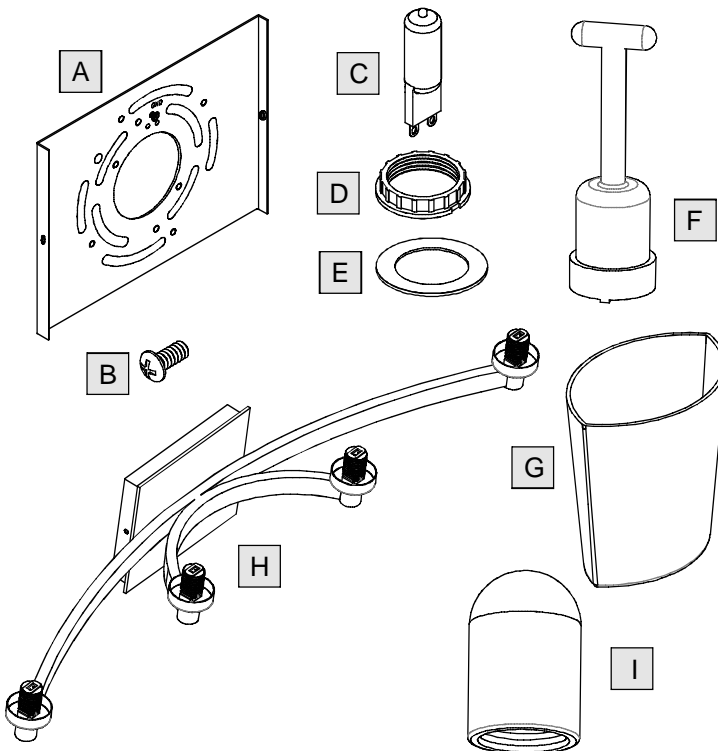

Thank you for purchasing a Quoizel product.

Need assistance with parts or assembly? Call Quoizel customer service at 1-631-273-2700  
or visit us on-line at [www.quoizel.com](http://www.quoizel.com)

WSN8604Z

FINISH: MEDICI BRONZE

3

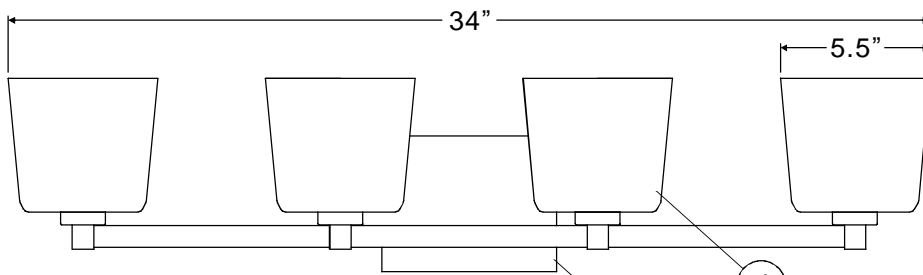
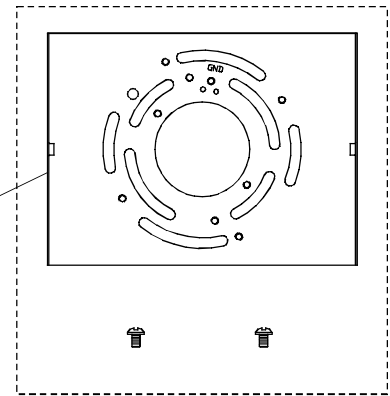

4

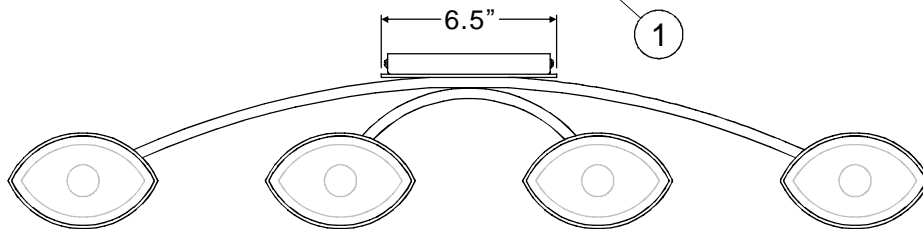
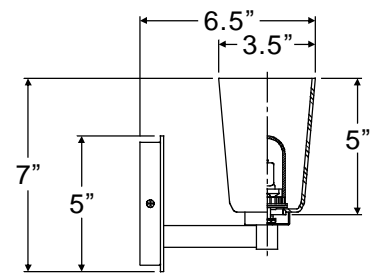

1

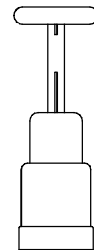

2

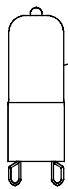

(4) 60W Frosted  
G9 Halogen Bulbs  
(Supplied)

NOTE: ALL DIMENSIONS ARE ROUNDED UP TO THE NEAREST 1/2"

| NO. | PART NUMBER | REPLACEMENT PART DESCRIPTION        | REQ. |
|-----|-------------|-------------------------------------|------|
| 1   | 18604ZWSN   | BASE WSN8604Z                       | 1    |
| 2   | I830SF      | BULB 130V 60W HALOGEN G9 FROSTED    | 4    |
| 3   | 9553KIT     | MOUNTING HARDWARE MEDICI BRONZE 4"D | 1    |
| 4   | G3292SH     | SHADE OPAL ETCHED GLASS 5"H x 3.5"D | 4    |

# Assembly Instruction Sheet #IS-WSN8604Z

## For Style WSN8604Z

### STEP 1 - Attach Inner Backplate to Outlet Box

- A. Attach the Inner Backplate (A) to Outlet Box and secure by threading Outlet Box Screws (not supplied) into the Mounting Holes on the Outlet Box. Tighten until snug.

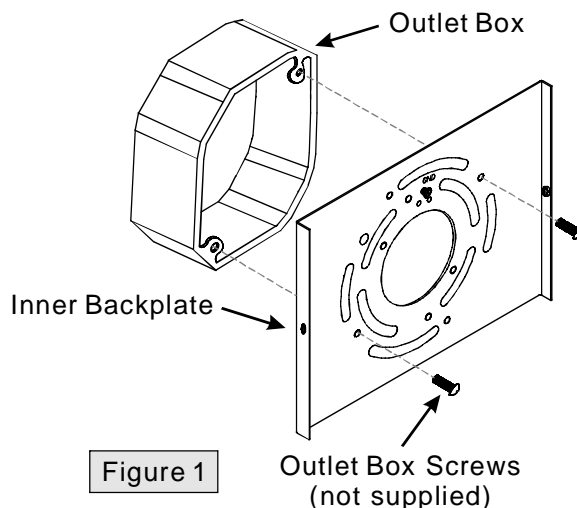

### STEP 2 - Make Wire Connections

- A. Use standard wire connectors to make all wire connections. (Connectors are not included with fixture.) Strip and prepare wire ends according to instructions supplied with connectors.
- B. Connect White Supply Wire from the Outlet Box to White Wire from fixture.
- C. Connect Black (or Red) Supply Wire from the Outlet Box to Black Wire from fixture.
- D. Connect Ground Wire from the Outlet Box to Ground Wire from fixture.
- E. Twist connectors until wires are tightly joined together.
- F. Wrap each connection with approved electrical tape and carefully stuff all the connected wires into the Outlet Box.

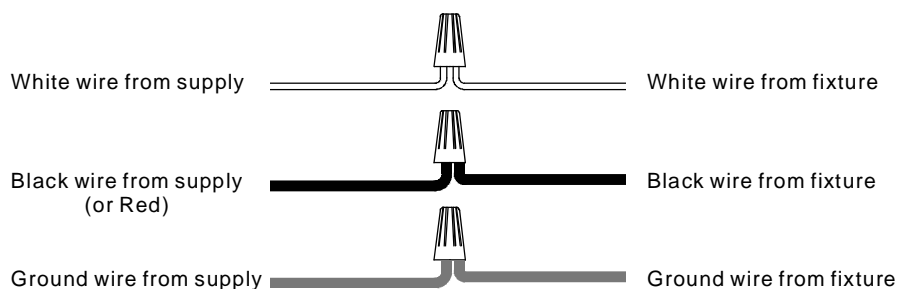
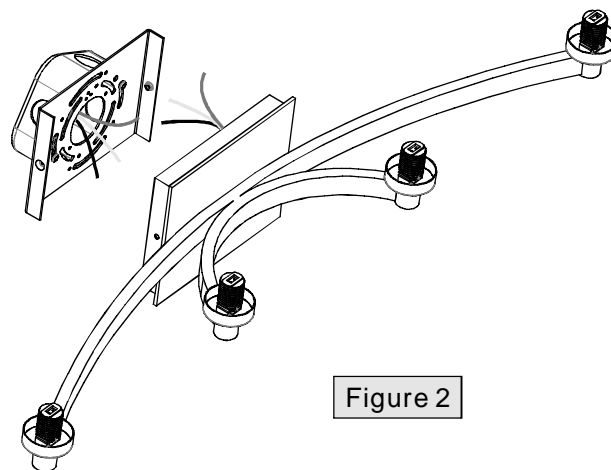

Figure 3

Thank you for purchasing a Quoizel product.

Need assistance with parts or assembly? Call Quoizel customer service at 1-631-273-2700 or visit us on-line at [www.quoizel.com](http://www.quoizel.com)

# Assembly Instruction Sheet #IS-WSN8604Z

## For Style WSN8604Z

### STEP 3 - Attach Fixture Body to Inner Backplate

- A. Place the backplate of the Fixture Body (H) onto the Inner Backplate (A). Line up holes on the side of the backplate and the mounting holes on the side of the Inner Backplate (A). Secure them together by threading Mounting Screws (B) into the mounting holes on the Inner Backplate (A). Hand tighten until snug.

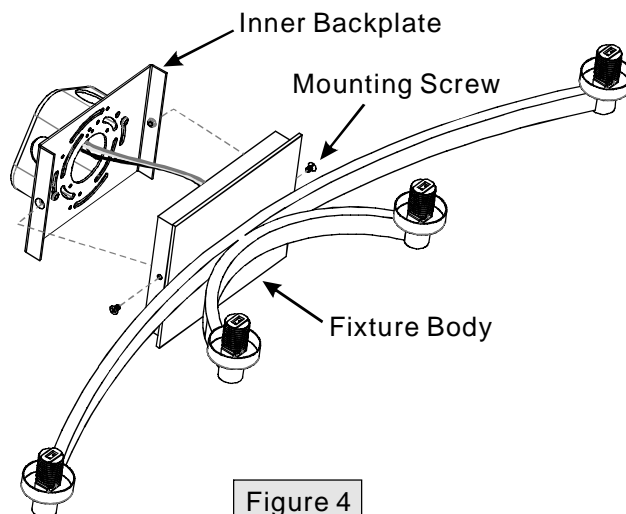

### STEP 4 - Attach Shade to Fixture Body

- A. Place the Shade (G) and the Steel Washer (E) over the Socket as shown. By using the Socket Collar Tool (F), thread the Socket Collar (D) onto the Socket to secure them. Hand tighten until snug.

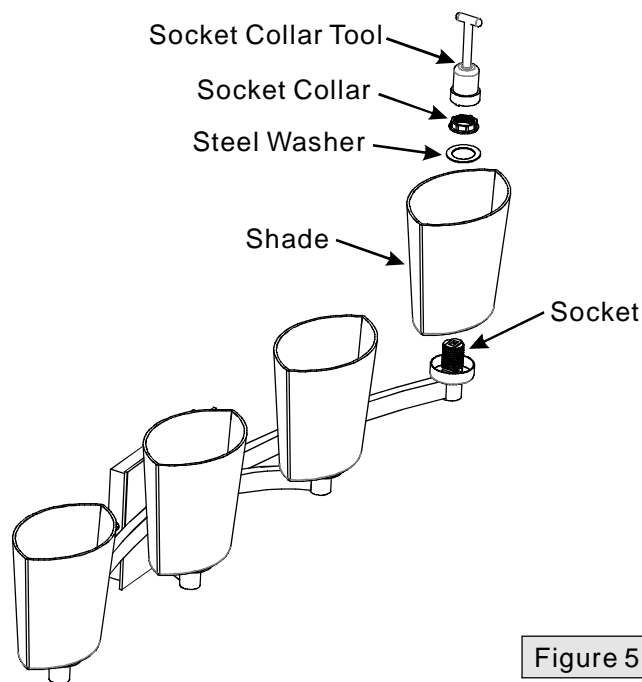

Thank you for purchasing a Quoizel product.

Need assistance with parts or assembly? Call Quoizel customer service at 1-631-273-2700  
or visit us on-line at [www.quoizel.com](http://www.quoizel.com)

# Assembly Instruction Sheet #IS-WSN8604Z For Style WSN8604Z

## STEP 5 - Install Bulb and Bulb Shield

- A. This fixture uses Frosted G9 Halogen Bulbs. Maximum 60 watts.
- B. Insert bulb and seat properly into place.
- C. Screw Bulb Shield (I) onto the Socket and hand tighten until snug.

**IMPORTANT:** Do not touch the bulb with bare hands use a cloth or glove.

Your fixture is now assembled and ready to use. Enjoy!

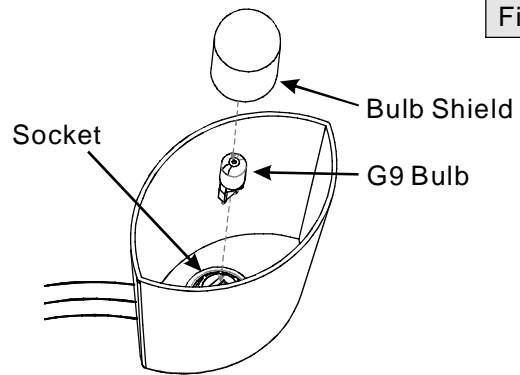

Figure 6

## CAUTION FOR BULB REPLACING

- A. When replace bulb, turn off power and allow lamp to cool. For safety purpose, wear gloves and eye protection.
- B. If bulb is scratched or cracked, DO NOT use the lamp to avoid breakage during use or installation.
- C. Use only in fixtures rated for lamps wattage and voltage.
- D. Lamp operate under high pressure generating intense heat. Prevent contact with liquid and combustible materials.

Thank you for purchasing a Quoizel product.

Need assistance with parts or assembly? Call Quoizel customer service at 1-631-273-2700  
or visit us on-line at [www.quoizel.com](http://www.quoizel.com)