



## ASSEMBLY AND INSTALLATION

### INSTRUCTION

*Please read carefully and save this instruction, as you may need them at a later date.*

### CAUTION

Turn off the main power at the circuit breaker before installing the fixture, in order to prevent possible shock. If you are unfamiliar with proper electrical wiring connections, please consult of a qualified electrician before installing

#### Installing Step:

Remove the fixture and the mounting package from the box and make sure that no parts are missing in the box.

1. Install bulbs: (Bulbs are not including in the package)  
(Please don't exceed the maximum capacity that recommended on the Sockets)
2. Screw the Nipple (2) into the Connector (1) with Hex Nut.
3. Attach the Metal Tube (3), Cover (4) and Cover (5), then screw with the Hex nut (6).
4. Attach the Glass (7), Plastic Washer (8), Metal Washer (9) to the Glass (7), then screw with the connector (10).
5. Attach the bottom cover (11), then screw with the Finial (12) until tight.

INSTALLATION IS NOW COMPLETED.

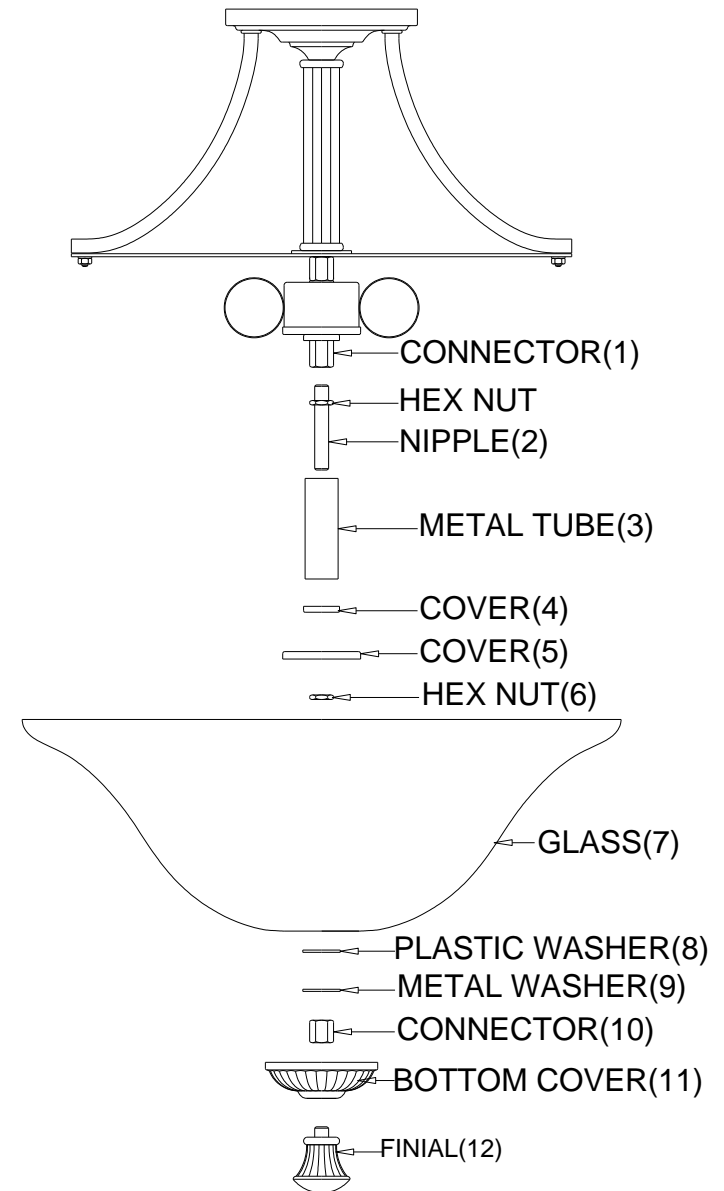

**6-8002-2-109**