

Instructions for electrician

WARNING: THIS LUMINAIRE MUST BE MOUNTED OR SUPPORTED INDEPENDENTLY OF AN OUTLET BOX.

STEPS 2 - 21

WARNING:

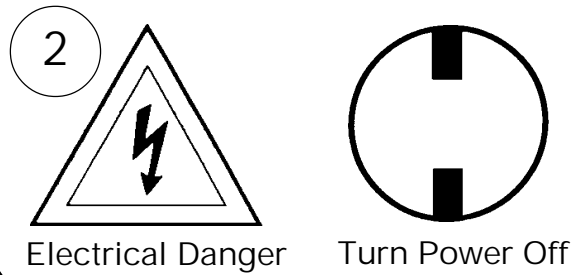

All electrical components must be installed by a licensed electrician in accordance with the National Electric Code and the appropriate local electrical codes.

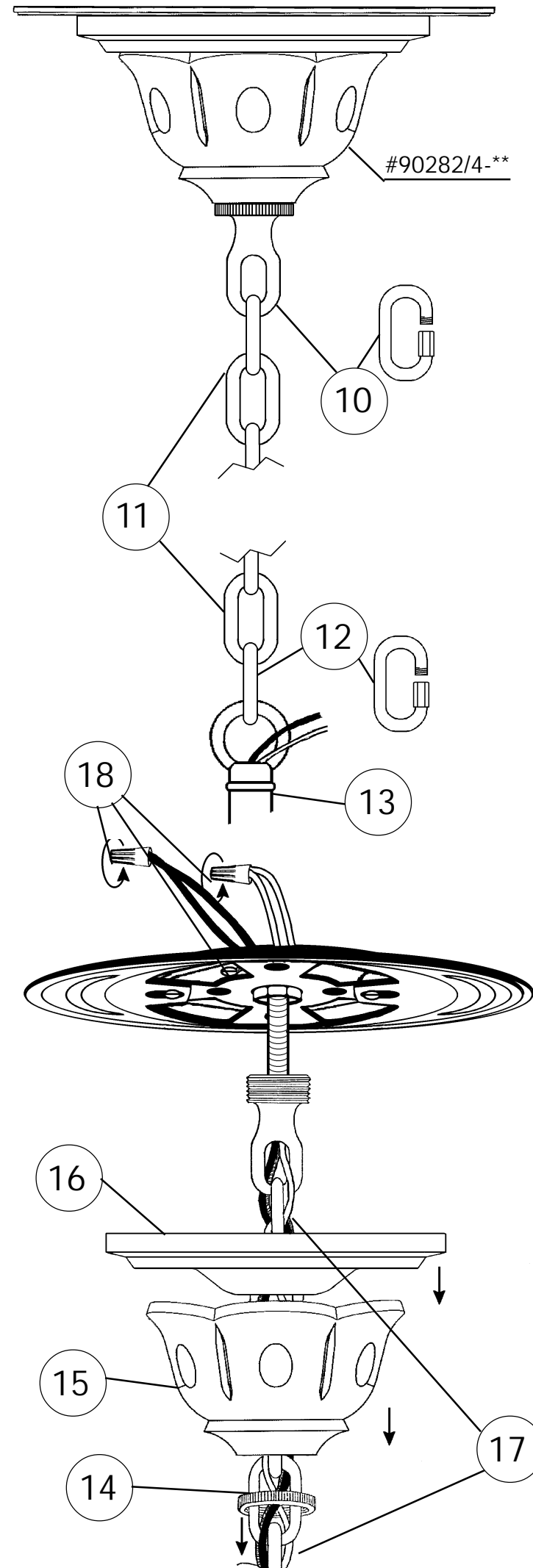
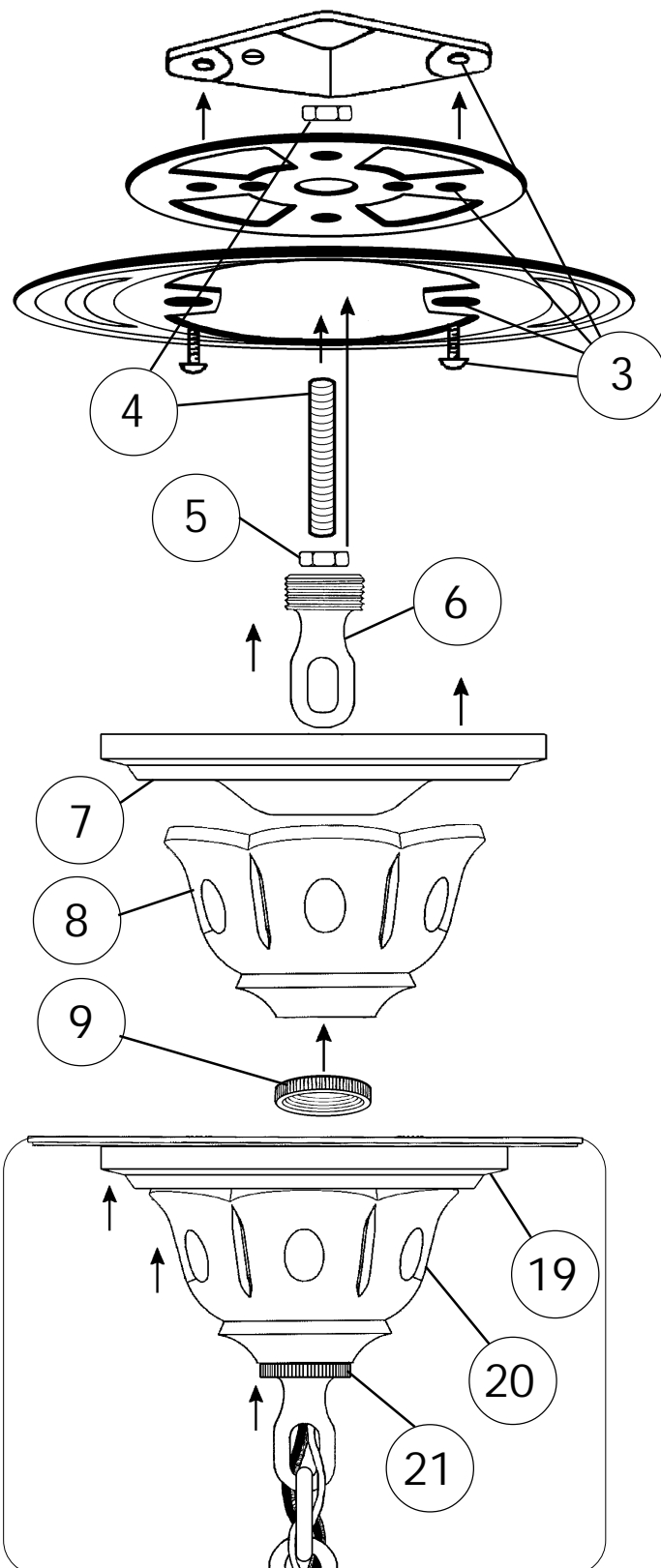

CHANDELIER 5335- _____ TRIM DIAGRAM

(Finish Option) (Trim Option)



8 + 4 Lights
Diameter: 33"
Body Length: 37"
Weight: 72lbs.

THIS DESIGN IS THE PROPRIETARY
TRADE DRESS/TRADEMARK OF
SCHONBEK WORLDWIDE LIGHTING INC.

SCHONBEK®

See diagram on back page
Follow steps in exact order
Save this trim diagram for future reference

IMPORTANT
1 Person who opens carton should record the following information for future service.
CODE # _____ Four-digit number on outside of carton.
PACKER # _____ See crystal package label.
ORDER # _____ See crystal package label.

Instructions for crystal trimming
STEPS 22 - 33



22

You will need 12 - C10
25 Watts Recommended
60 Watts Max

Install bulbs and be
sure to test fixture
BEFORE trimming.

FIXTURE INCLUDES:
Hanger Hardware
Trim - Frame

DOES NOT INCLUDE:
C10 - Light Bulbs

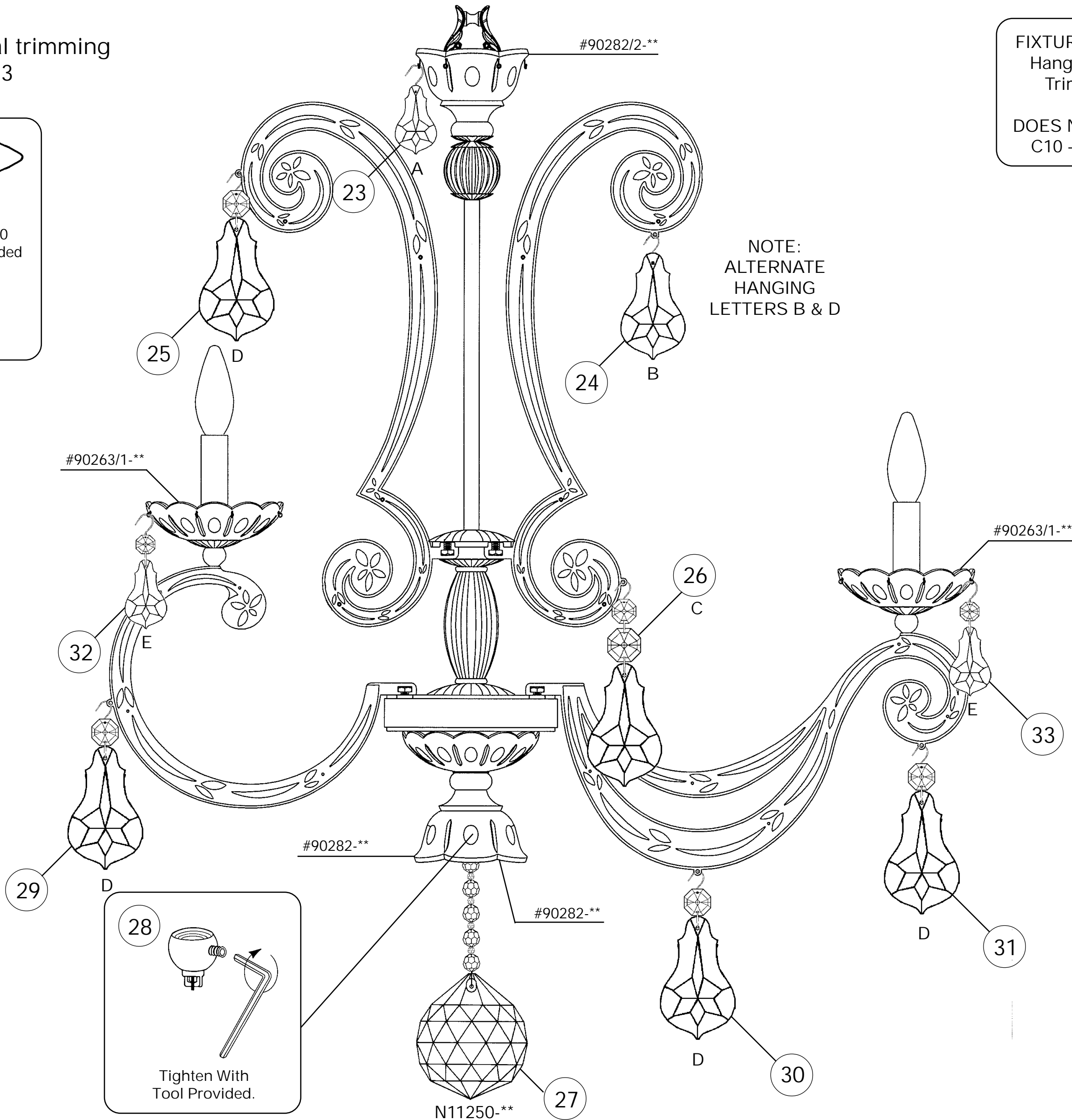

28

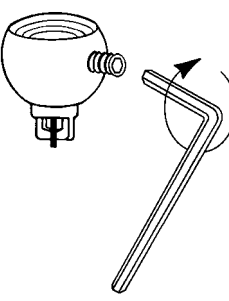

Tighten With
Tool Provided.