

CHANDELIER 9802-____ TRIM DIAGRAM

(Finish Option)

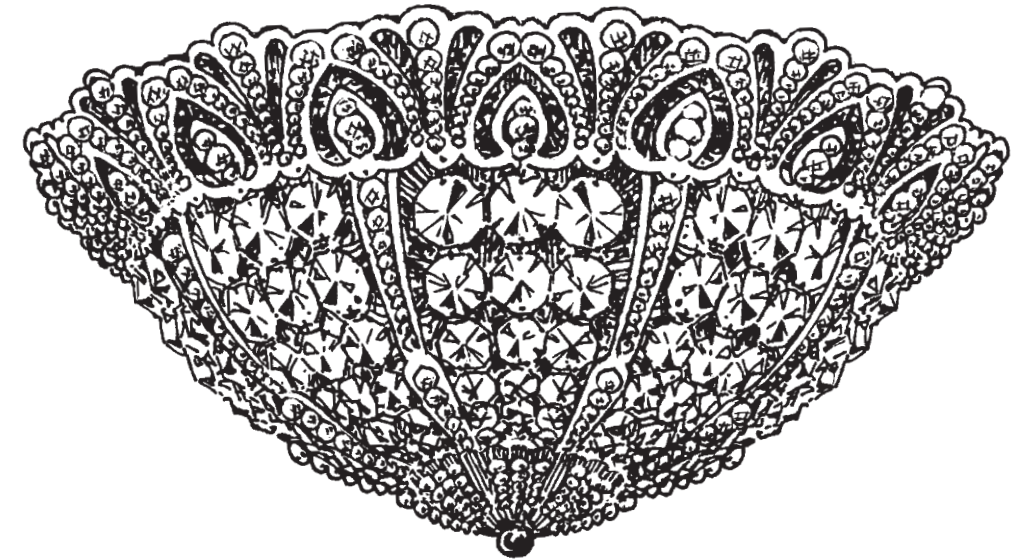
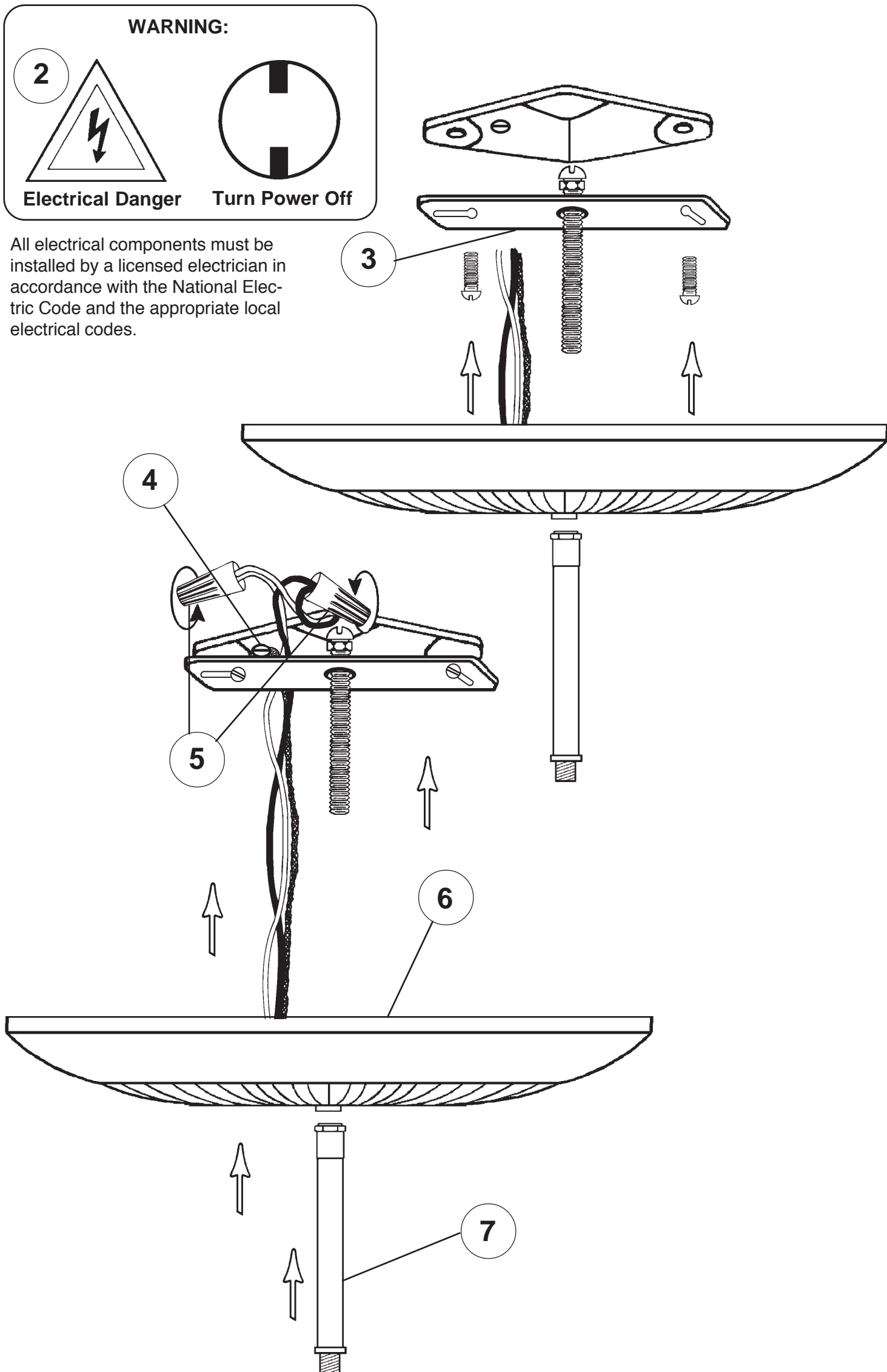

THIS DESIGN IS THE PROPRIETARY
TRADE DRESS/TRADEMARK OF
SCHONBEK WORLDWIDE LIGHTING INC.

6 Lights
Diameter: 18"
Body Length: 7"
Hanging Weight: 8 lbs.

SCHONBEK®

See diagram on back page
Follow steps in exact order
Save this trim diagram for future reference

1

IMPORTANT
Please record the following
information for future service.

CODE # _____ Four-digit number on outside of carton.
PACKER # _____ See crystal package label.
ORDER # _____ See crystal package label.

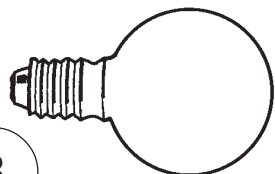

8

You will need:
6 - G16-1/2
40 Watts Max
25 Watts Recommend
MIN 75°C SUPPLY
CONDUCTORS

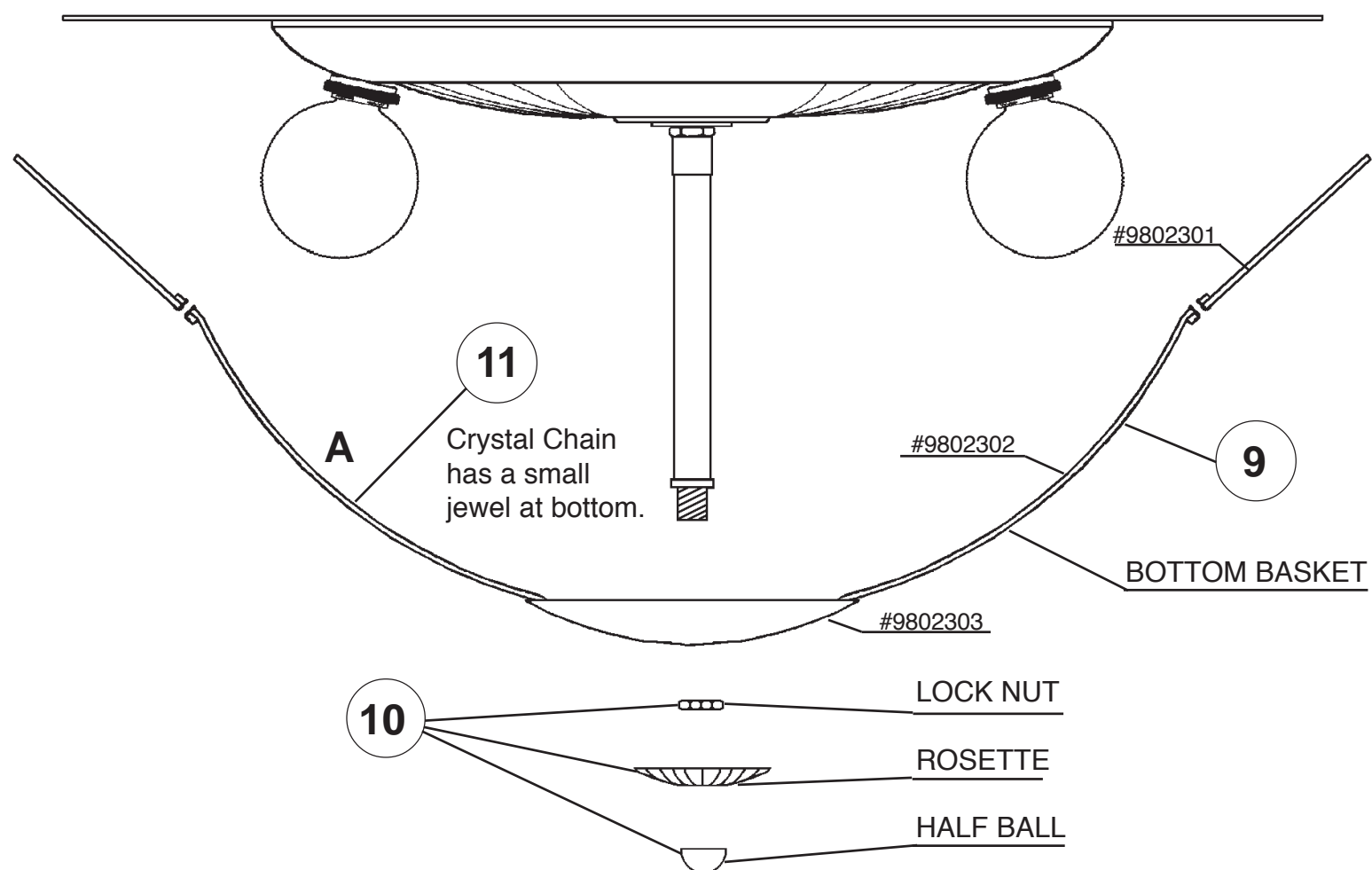

PART NUMBERS FOR SPARE PARTS

