

Trim Diagram
Refrax™ Pendant RE0409-**

Important: Label on back
contains important information on
your crystal option. Please save in
case you ever need to order matching
crystal.

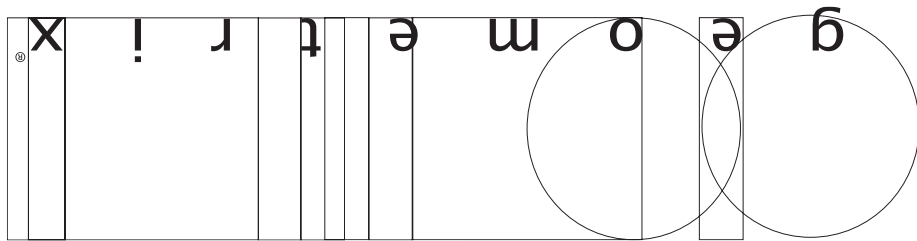

Schonbek Worldwide Lighting Inc., 61 Industrial Blvd., Plattsburgh NY 12901-1908
Tel: 800.836.1892 or 518.563.7500 www.schonbek.com

© 2006 SCHONBEK WORLDWIDE LIGHTING INC., A. SCHONBEK & CO. LTD. WORLDWIDE COPYRIGHT RESERVED

US PATENT: #5,109,325

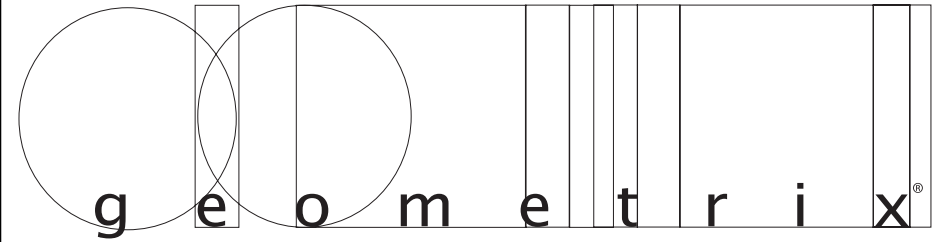

Trim Diagram
Refrax™ Pendant RE0409-**

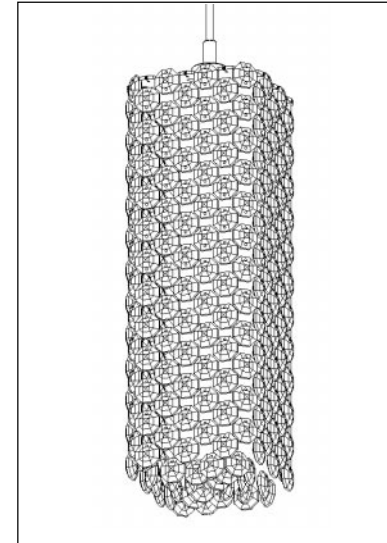

1 Light
Length: 4", Width: 4", Height: 9"

Geometrix™ is designed by Schonbek
with Strass® crystal by Swarovski.



This design is the proprietary trade
dress/trademark of Schonbek Worldwide Lighting Inc

Please save your trim diagram for future reference.

IMPORTANT: Label on back contains important
information on your crystal option. Please save in
case you ever need to order matching crystal.



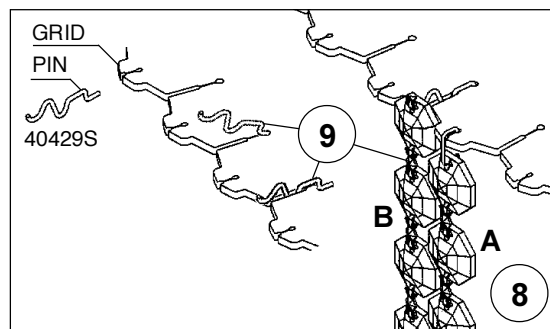
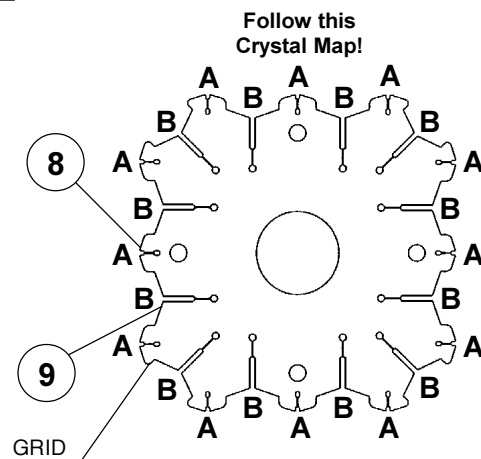
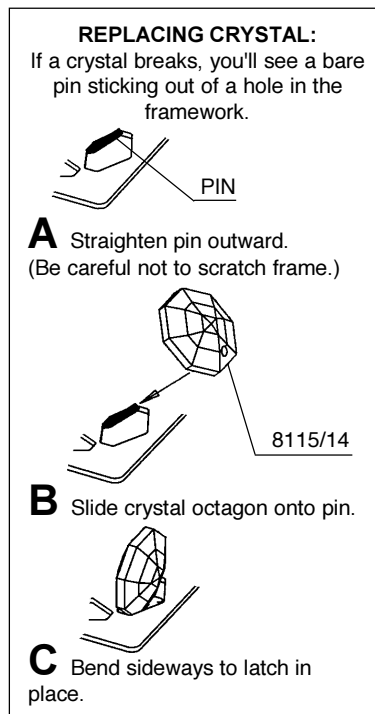
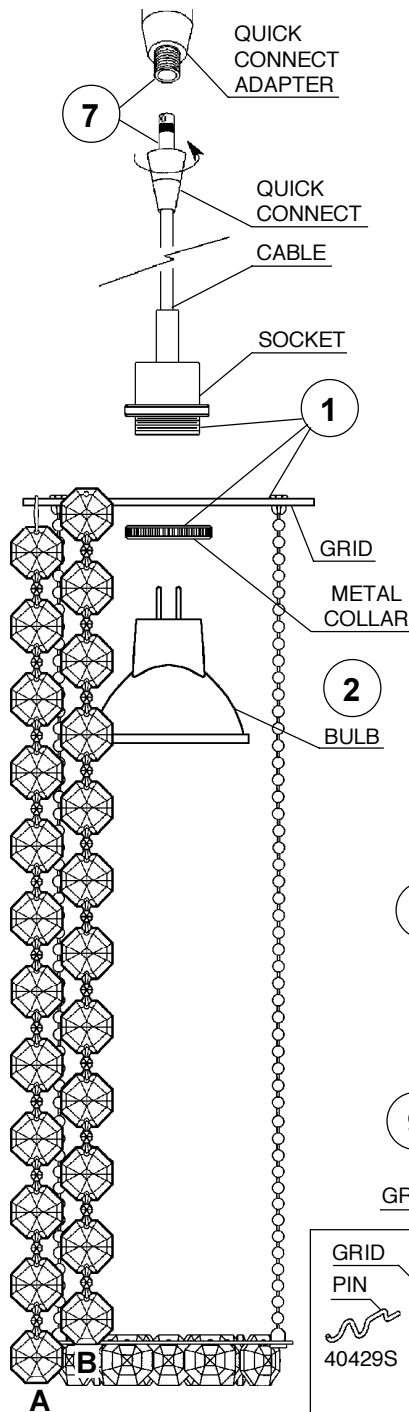
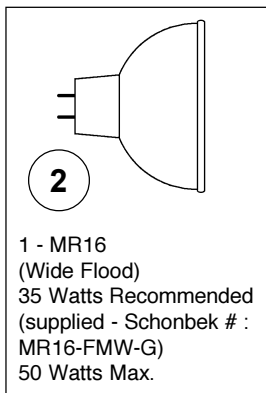

How to Install MR16 Bulb and Refrax™ Pendant:

Pendants may be mounted to monorail systems, monopoints or line voltage track by coupling to the quick connect transformer adapter. Attached to the socket is a cable that may be cut on site during installation to any length (see instructions below).

1 Position the pendant grid against the socket and secure in place by screwing the metal collar onto the socket.

2 Plug bulb carefully but completely into socket. Use only an MR16 glass covered lamp bulb.

How to Shorten the Cable:

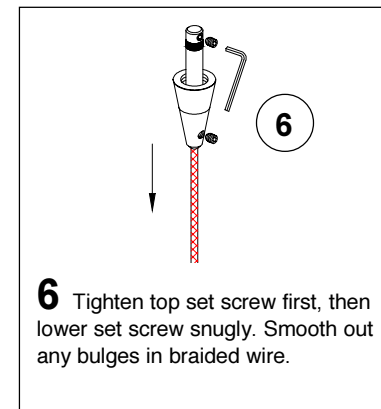
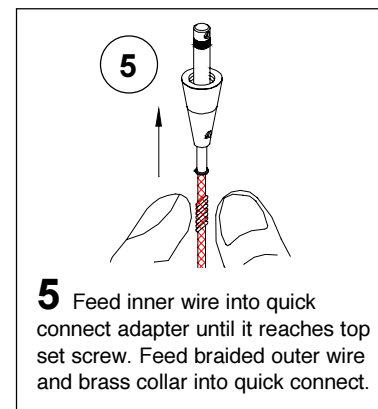
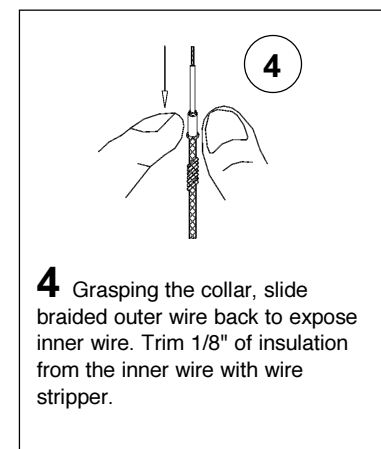
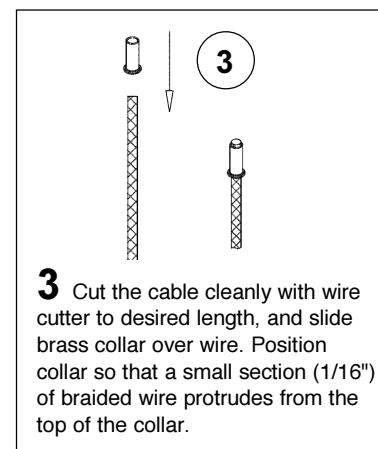

7 Screw quick connect into quick connect adapter until it seats. If you adjust the orientation of the pendant, be careful not to loosen the connection.

8 Hang A chains first, following the crystal map. Hook the connectors into the pinholes located towards the outside of the grid. See illustration to the left.

9 Insert pins into grid. Hang B chains by sliding the octagon with an open hole onto the pin. Chains B will nest into position between A chains. See illustration to the left.

