

Important: Label on back contains important information on your crystal option. Please save in case you ever need to order matching crystal.

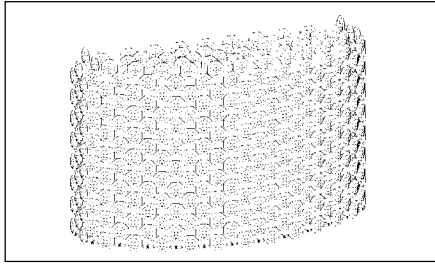

Trim Diagram  
Refrax™ Pendant REW1006-\*\*

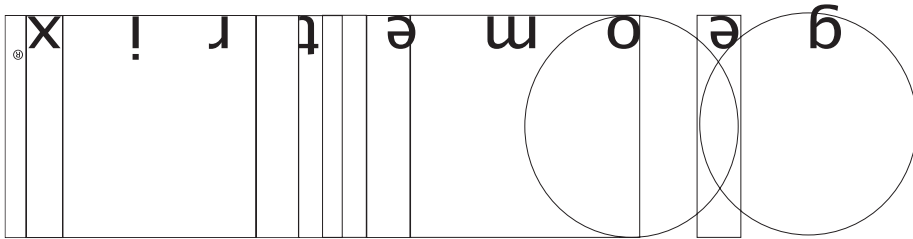

Schonbek Worldwide Lighting Inc., 61 Industrial Blvd., Plattsburgh NY 12901-1908  
Tel: 800.836.1892 or 518.563.7500 [www.schonbek.com](http://www.schonbek.com)

© 2006 SCHONBEK WORLDWIDE LIGHTING INC., A. SCHONBEK & CO. LTD. WORLDWIDE COPYRIGHT RESERVED  
US PATENT: #5,109,325

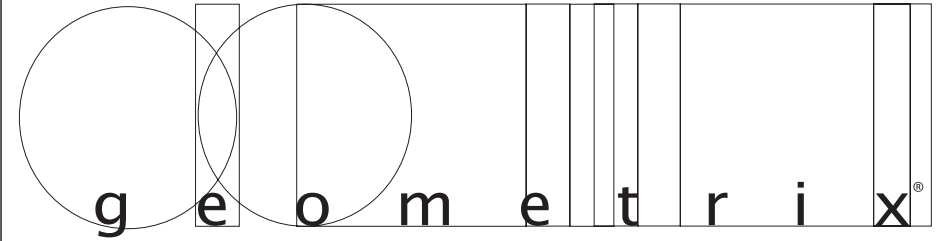

Trim Diagram  
Refrax™ Pendant REW1006-\*\*

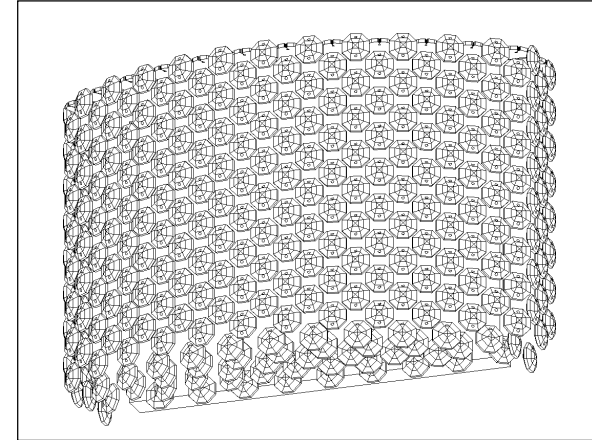

5 Lights  
Length: 9½", Width: 4", Height: 6½"

Geometrix™ is designed by Schonbek with Strass® crystal by Swarovski.



This design is the proprietary trade dress/trademark of Schonbek Worldwide Lighting Inc

Please save your trim diagram for future reference.

IMPORTANT: Label on back contains important information on your crystal option. Please save in case you ever need to order matching crystal.



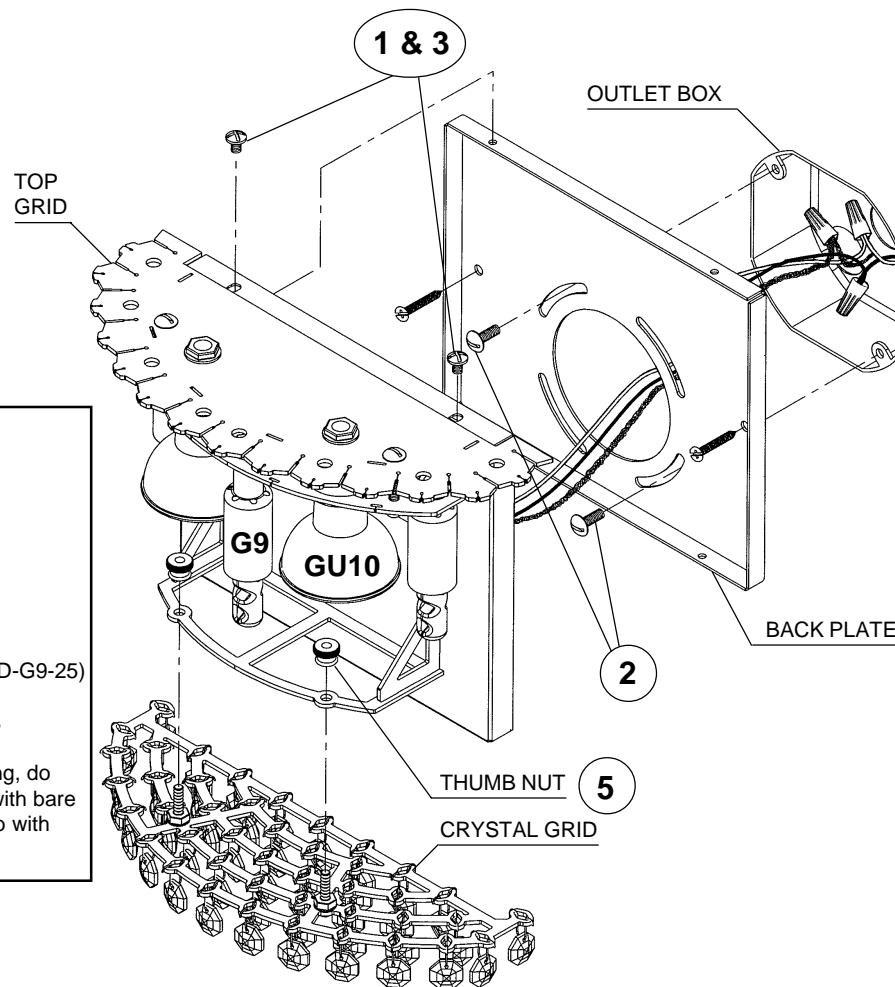

**7** Insert pins into top grid. Hang B chains by sliding the octagon with an open hole onto the pin. Chains B will nest into position between A chains. See illustration to the left.

