

SEMI-FLUSH FIXTURE INSTALLATION INSTRUCTIONS

Please read carefully and save these instructions,as you may need them a later date.

CAUTION

Turn off the main power at the circuit breaker before installing the fixture,in order to prevent possible shock.

GENERAL

All electrical connections must be in accordance with local and National Electrical Code(N.E.C) standards.If you are unfamiliar with proper electrical wiring connections obtain the services of a qualified electrician.

Remove the fixture and the mounting package from the box and make sure that no parts are missing by referencing the illustrations on the installation instructions.

ASSEMBLY AND INSTALLATION

1. Put the Shade(13) onto the connector (26), slide the Washer (12) to the connector(26), then Screw the Nipple (25) onto the connector (26),
2. Spin the Fixture screw(long) (9) to the Mounting bar (3), put the hex nut (4) onto screw on the other side of mounting bar (3). Secure the mounting bar assembly pieces to outlet box (1) by outlet screw(short) (5).
3. Pull out the outlet wire and ground wire from the Outlet Box. Make wire connections:
---White wire from light to White Wire(2) from power source.
---Black wire from light to Black Wire(7) from power source.
---Loop the Ground Wire(10) to Mounting bar(3) with a Green Screw(11).
4. Place the canopy against the outlet box through the fixture screw (9), secure with the cap nut (6).
- 5.Install bulbs:(bulbs not included)
(Please don't exceed the maximum capacity that recommended on the Sockets).
- 6, Thread Thread pipe(14) to Connector(17). Place the Tube(15), Tube cap(16), Flat washer(17), Rubber washer(18),Glass(19), Rubber washer(20), Flat washer(21) onto the thread pipe (14) in the order. Secure with Hex nut(22).
7. Attach the Cap(23) to the fixture then secure with the Finial(24)

INSTALLATION IS NOW COMPLETED.

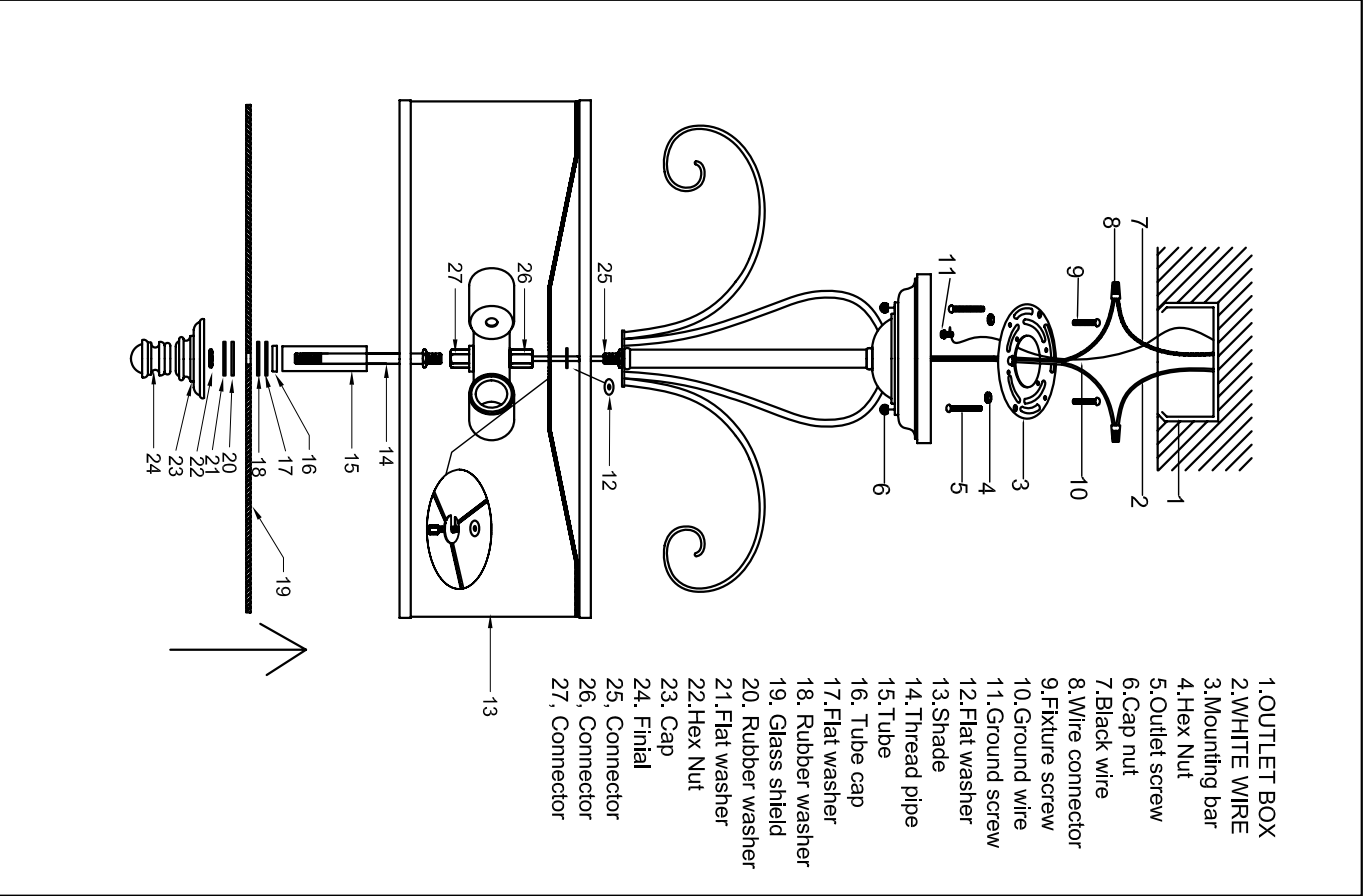

FOR ITEM 2001 SF