



INSTALLATION INSTRUCTIONS

IMPORTANT

Before assembling your access lighting fixture, please make sure that you carefully read through these instruction sheets. Consider having your fixture installed by a qualified licensed electrician.

NOTE: The important safeguards and instructions that appear in this manual are not meant to cover all possible conditions and situations that may occur. It must be understood that common sense, caution and care, are factors that can't be built into any product. These factors must be supplied by the person(s) caring for and operating the fixture.

GENERAL INFORMATION

All electrical connections must be in accordance with all ordinances, Local and National Electrical Codes. These fixtures are intended for mounting to a standard 4" x 2 1/2" metal octagon outlet box. The box must be directly supported by the building structure and U.L. Recognized.

STEP BY STEP INSTRUCTIONS

Before starting your installation disconnect the Power by turning off the Circuit Breaker or by removing the fuse at the fuse box. Just turning the light off at the light switch is not sufficient to prevent electrical shock.

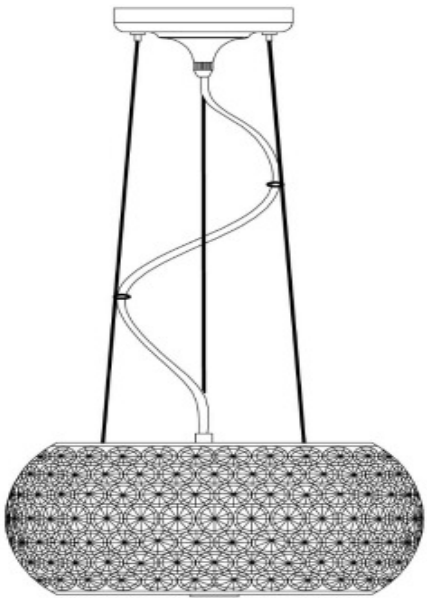

COLLECTION	APPLICATION	MODEL NO.
Pizazz	Pendant	51001

WHAT WE PROVIDE

- Crossbar
- Mounting Hardware
- Canopy with Fixture
- 1 x Crystal Shade
- 1 x Bottom Glass Shade

WHAT YOU NEED

- Screwdriver
- Wire Cutters
- Wiring Supplies as Specified by Electrical Code
- 6 x 60W/E26/Candelabra



RELEASE THE CANOPY

1

If there is an existing fixture remove it. Expose the supply wires from the J-box. Unscrew the finial on the canopy allowing the canopy to slide down the fixture power wire.

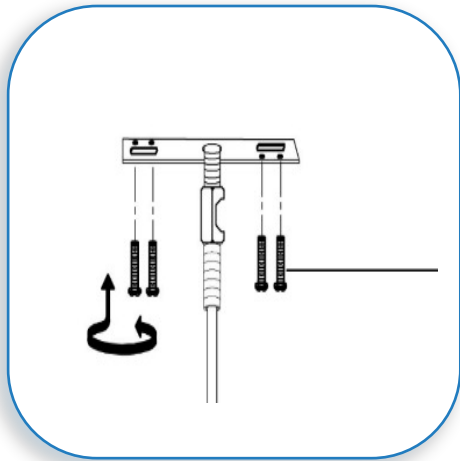

2

MOUNT THE CROSSBAR

Determine the desired length of your fixture. Loosen the strain relief, adjust the fixture wire to the desired length and then re-tighten the strain relief. Using the supplied screws, mount the crossbar to the J-box.

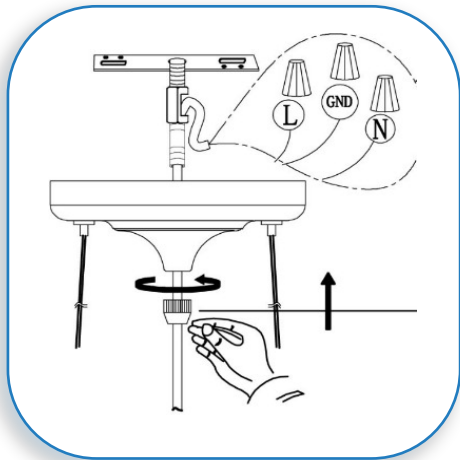

3

MAKE THE WIRE CONNECTIONS

Connect the exposed supply wires to the fixture wires. Connect the black supply wire to the black fixture wire. Secure with the supplied wire nuts. Connect the white supply wire to the white fixture wire. Secure with the supplied wire nuts. Either wrap the green wire around one of the protruding screws or connect it to the supply ground wire.

Secure all wire with electrical tape (not supplied).

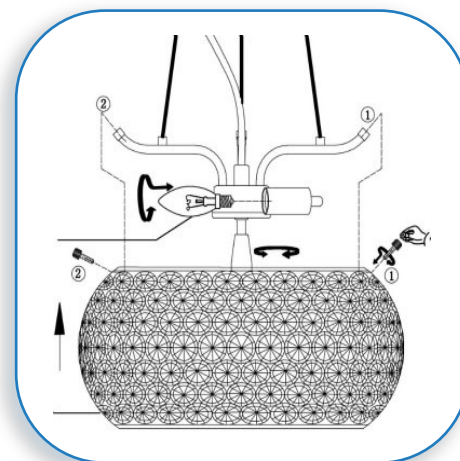

4

INSERT THE BULBS - SECURE GLASS SHADE

Insert the bulbs (not supplied), ensuring that you do not exceed the recommended wattage stated in this installation instruction and on the caution label.

MAXIMUM 60 WATTS-E12-candelabra.

Secure the glass shade by holding the crystal shade up to the fixture socket. Align the holes in the crystal shade with the holes on bars 1 and 2. Use the supplied thumb screws to secure.

DO NOT EXCEED THE RECOMMENDED WATTAGE AS STATED ON THE WARNING LABEL.

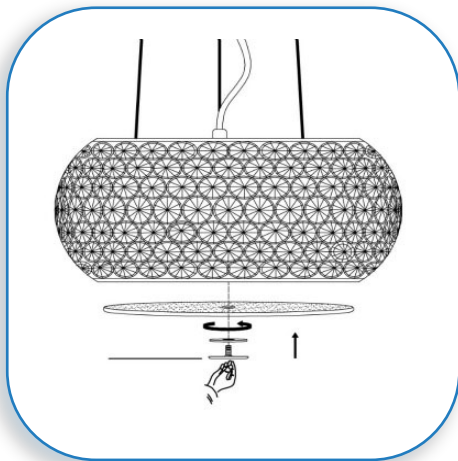

5

SECURE BOTTOM GLASS-ADJUST HEIGHT

Secure the bottom glass by holding it up to the bottom of the crystal shade, inserting the thumb screw and tightening down until secure.

Adjust the height and ensure that your fixture is level by using the grip locks, located on the fixture canopy.

Simply push the button adjust the wire, then release the button.

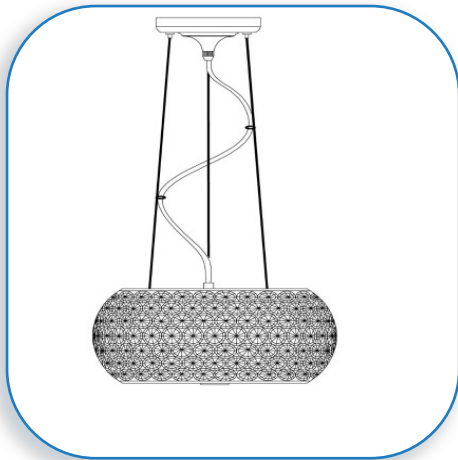

6

RESTORE THE ELECTRICITY AND CHECK THE OPERATION OF YOUR NEW ACCESS FIXTURE

CAUTION

Please ensure that the fitting is cool and switched off before replacing the bulb. DO NOT use bulbs that might exceed the maximum wattage, stated on caution label.