

access

LIGHTING

INSTALLATION INSTRUCTIONS

IMPORTANT

Before assembling your access lighting fixture, please make sure that you carefully read through these instruction sheets. Consider having your fixture installed by a qualified licensed electrician.

NOTE: The important safeguards and instructions that appear in this manual are not meant to cover all possible conditions and situations that may occur. It must be understood that common sense, caution and care, are factors that can't be built into any product. These factors must be supplied by the person(s) caring for and operating the fixture.

GENERAL INFORMATION

All electrical connections must be in accordance with all ordinances, Local and National Electrical Codes. These fixtures are intended for mounting to a standard 4" x 2 1/2" metal octagon outlet box. The box must be directly supported by the building structure and U.L. Recognized.

STEP BY STEP INSTRUCTIONS

Before starting your installation disconnect the Power by turning off the Circuit Breaker or by removing the fuse at the fuse box. Just turning the light off at the light switch is not sufficient to prevent electrical shock.

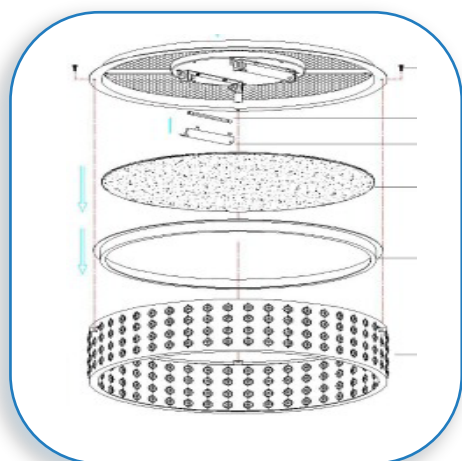

COLLECTION

Aura

APPLICATION

Pendant

MODEL NO.

62279

WHAT WE PROVIDE

- Universal Crossbar
- Mounting Hardware
- Canopy with Fixture
- 3 x Rods
- 2 x Glass Diffusers
- 1 x Metal Ring
- 1 x Metal Drum
- 2 x 100w J118mm Bulbs

WHAT YOU NEED

- Screwdriver
- Wire Cutters
- Wiring Supplies as Specified by Electrical Code

PREPARE FIXTURE

Insert the metal ring into the metal drum.

Insert the bottom glass diffuser. Insert the supplied bulbs, make sure that you handle the bulbs with the supplied cloth and not your bare hands. Attach the supplied bulb covers.

DO NOT EXCEED THE RECOMMENDED WATTAGE AS STATED ON THE WARNING LABEL AND INSTRUCTION SHEETS.

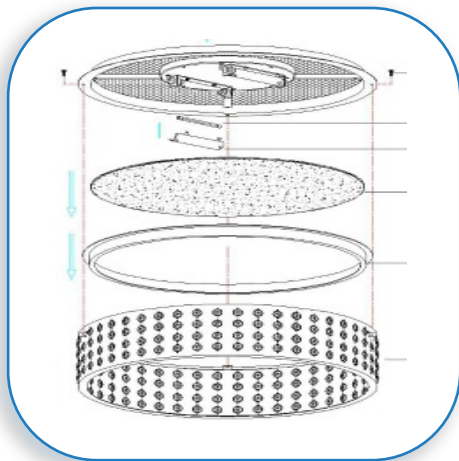

2

SECURE THE DIFFUSER TO THE DRUM

Position the top diffuser onto the metal drum so that the dedicated screw holes align. Secure the top diffuser by inserting the supplied screws through the top diffuser and into the holes in the metal drum.

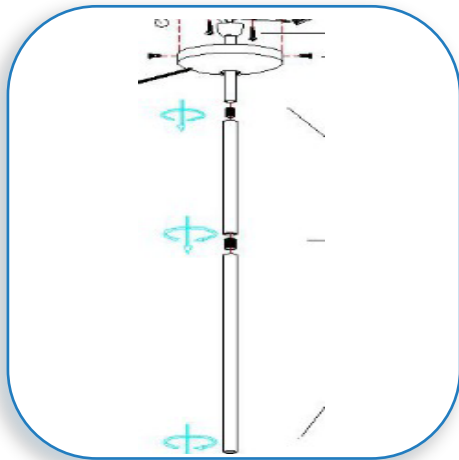

3

DETERMINE THE DESIRED LENGTH

If there is an existing fixture remove it.
Expose the supply wire from the outlet box .
Determine the desired length of your fixture.
Feed the fixture wires through the rods based upon the desired length. Screw the bottom rod to the socket plate and follow suit with additional rods.
Feed the wire through the hole in the canopy and secure the top rod to the ball in the canopy.

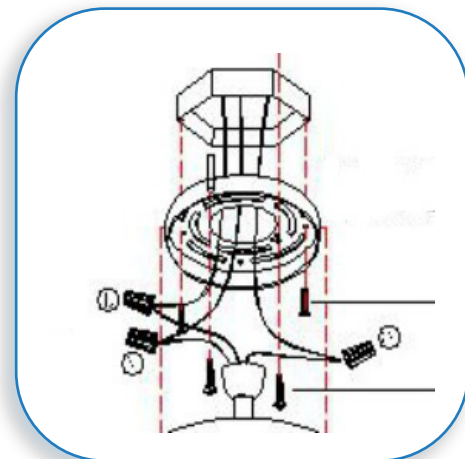

4

SECURE THE UNIVERSAL CROSSBAR

Hold the universal crossbar up to the junction box.
With a pencil mark the location for the additional support. Insert the supplied anchors in the mounting surface. Using the supplied screws, attach the universal crossbar to the junction box. Provide additional support by inserting the additional screws into the anchors.

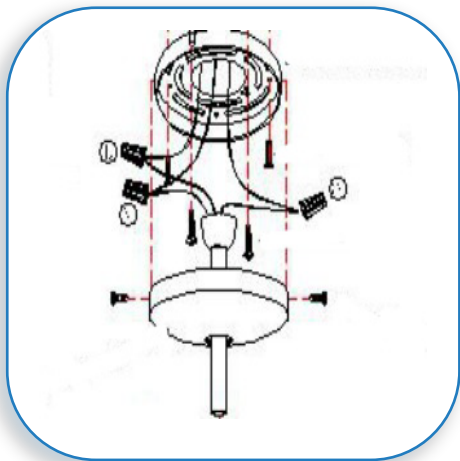

5

MOUNT THE CANOPY

Hold the fixture canopy up to the universal crossbar. Align the screw holes on the sides of the crossbar and canopy. Insert the supplied screws and tighten to secure.



6

RESTORE THE ELECTRICITY AND CHECK THE OPERATION OF YOUR NEW ACCESS FIXTURE

CAUTION

Please ensure that the fitting is cool and switched off before replacing the bulb. DO NOT use bulbs that might exceed the maximum wattage, stated on caution label.