

CRYST RAMA

1958

95 Cantiague Rock Road, Westbury NY 11590

ph: 516.931.9090 fax: 516.931.1254

info@crystorama.com • www.crystorama.com

ASSEMBLY INSTRUCTIONS FOR 405-GA

IMPORTANT
TURN OFF THE POWER AT THE MAIN FUSE
OR CIRCUIT BREAKER BOX
BEFORE STARTING INSTALLATION

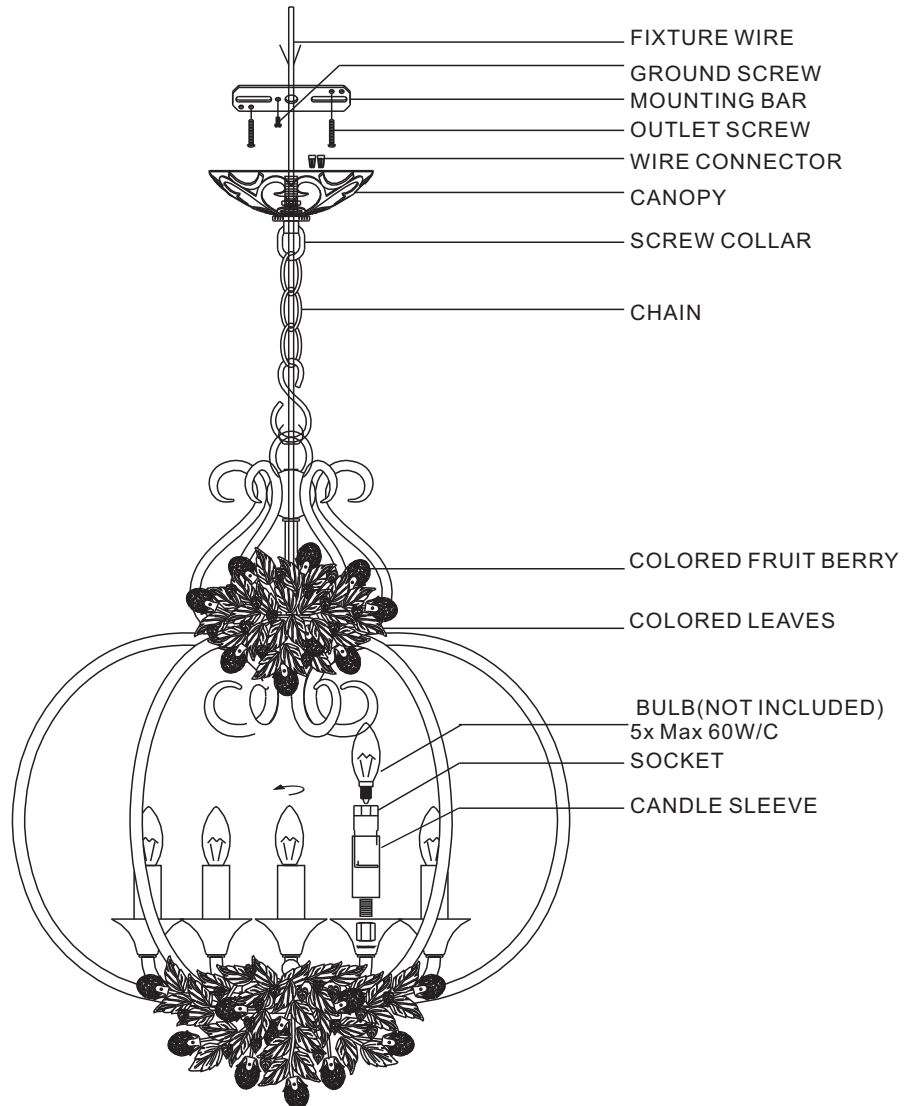

LOOP



Wrap the leaf around the loop

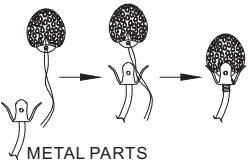

Wrap the fruit berry around the metal parts

styro foam

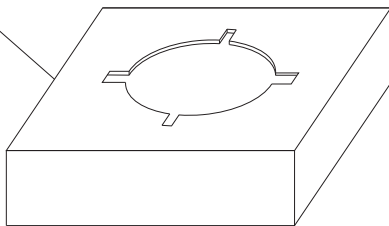

Notice: Please rest your fixture on the styro foam inside the packaging carton during the installation of the fixture in order to not damage the bottom glass leaves.

Please Note:

Each Blown Glass floral that adorns the Fiore Collection is tied by hand. Due to its delicate nature, it is not uncommon for these florals to fall off in transit or if moved too aggressively.

Once taken out of the box, the flower cluster will need to be gently groomed by hand to make sure the glass leaves look vibrant and alive. Should a glass leaf break off, simply tuck the exposed wire back into the flower cluster and continue to gently groom the rest of the floral grouping.

The Fiore Collection was designed with this in mind; therefore, we have added extra glass leaf florals with each fixture.

Please see diagram for illustration on how to tie the replacement florals to the fixture.

2010-04