

CRYST RAMA

1958

95 Cantiague Rock Road, Westbury NY 11590
 ph:516.931.9090 fax:516.931.1254
 info@crystorama.com • www.crystorama.com

MODEL#:522-SA ASSEMBLY AND DRESSING INSTRUCTIONS



All electrical components must be installed by a licensed electrician in accordance with the National Electric Code and the appropriate local electrical codes.

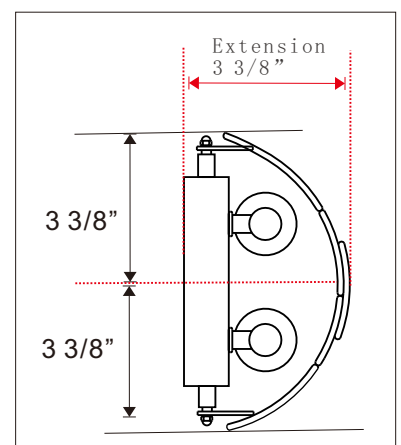
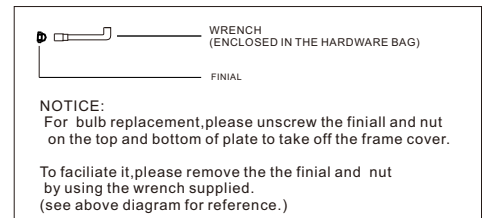
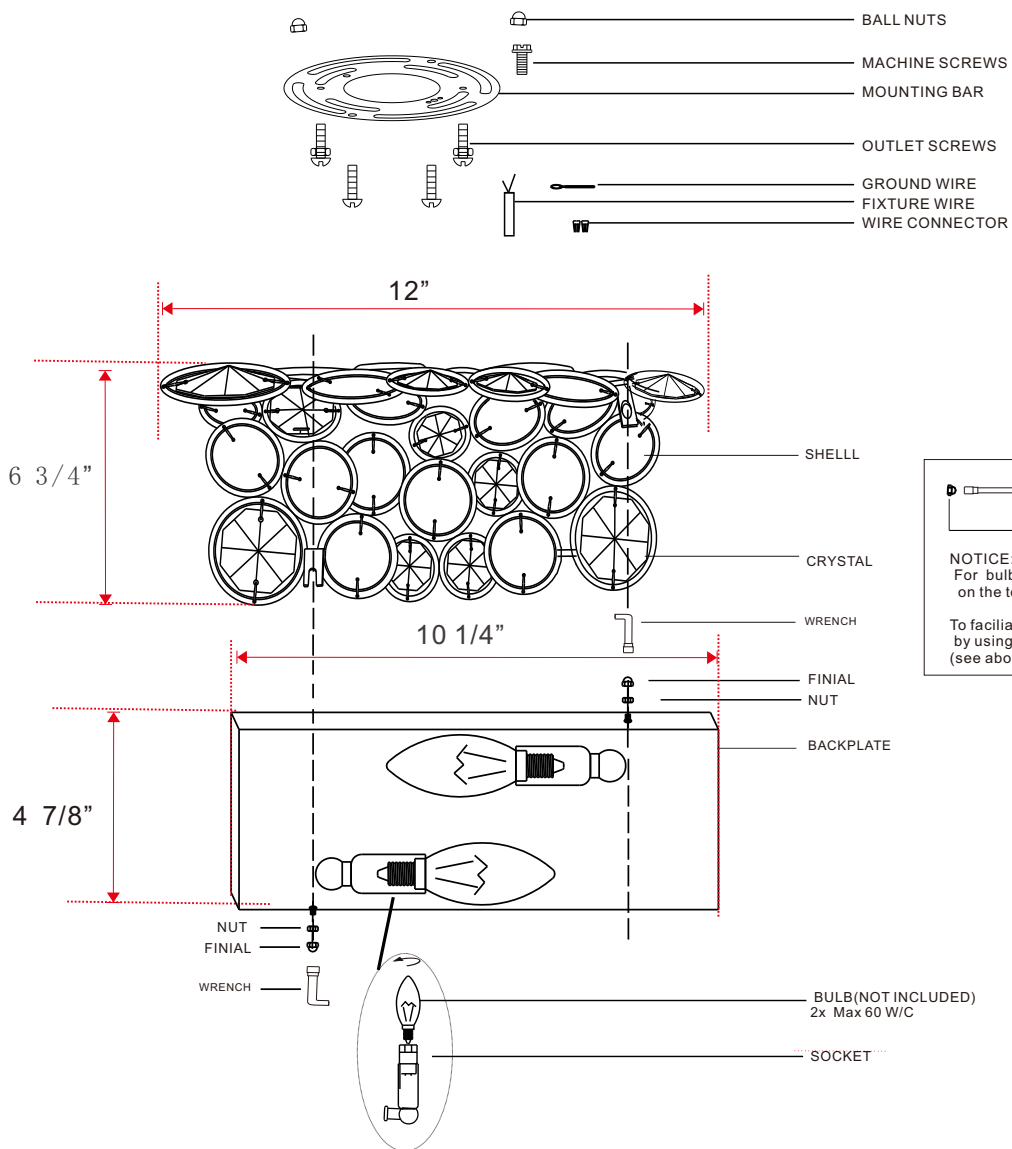
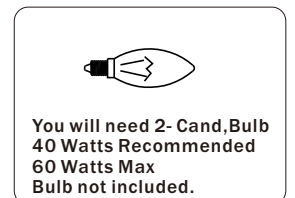

Please Note :

We have included 2pcs extra shell and 1pc extra crystal for each Palla Collection fixture.
 If needed, please reference the given illustration on how to replace the shell.

2015/06

