

Trade Mark:
CRYSTAL WORLD INC

Product Name: Wall lamp
Model :5318W10ST
120Vac, 60Hz,AC ONLY
Lamp Size:W10"xH12"xE5"

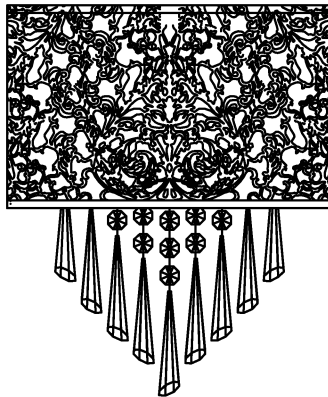

WALL LAMP ASSEMBLY INSTRUCTIONS

1.Place fixture(A) onto Butterfly (EE).
Secure with cap nuts (AA).

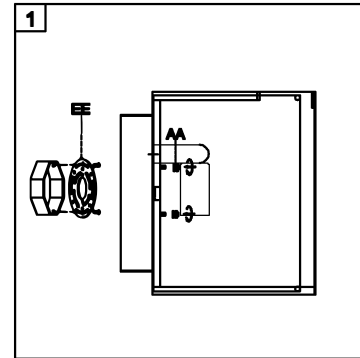

Hardware Used

AA Cap nut  X 2

2.Please hang the crystal(1) (2) (3) (4) (5) to the fixture .

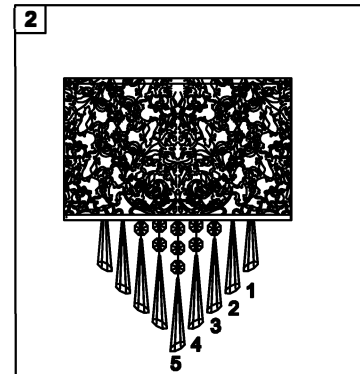
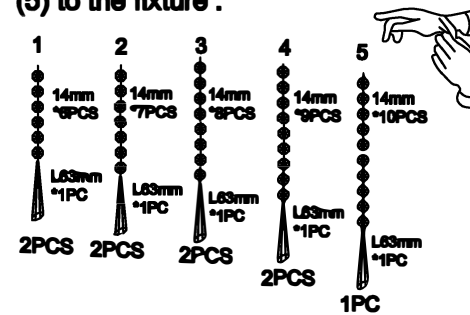

3.Install light bulbs (not included).

Use bulb
120V G9  2*40W Max.

