

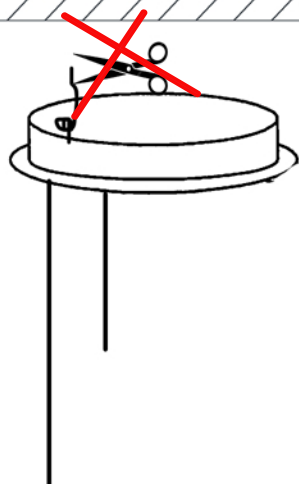

Contemporary
Lighting™

Installation Instructions

Model E22775-91PC



Strain relief



Push strain relief up
and ONLY then pull
or thread cord

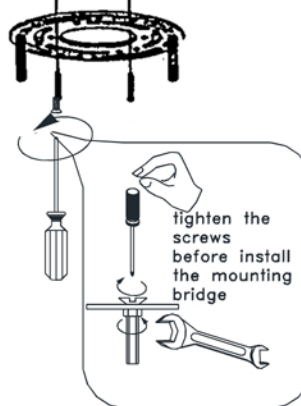

**Warning: DO NOT CUT WIRES
FOR LENGTH ADJUSTMENT!**

1. Turn breaker off for circuit on outlet where fixture will be installed.

2. Loosen knot. Adjust wire to your desired height by pushing in the strain relief to loosen hold on wire. **ONLY** then should you pull or thread wire into canopy. Tighten knot for extra protection. (Fig. 1)

*** DO NOT CUT WIRE FOR LENGTH ADJUSTMENT ***

3. Remove mounting bracket from fixture and install to electrical box. (Fig. 2)

4. Wire fixture to wires in outlet box
- Green wire is for ground (Fig. 3)

5. Install fixture to back plate and tighten with nuts so fixture meets ceiling (Fig. 4)

6. Remove protective paper from canopy. Peel slowly so not to leave residue (Fig. 5)

7. Install glass into holders using 2 screws supplied. (Fig. 6)

Note: This fixture may be dimmed using a standard triac dimmer. For maximum adjustability, we recommended Lutron CL series dimmers.

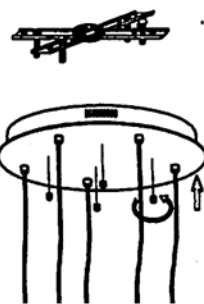
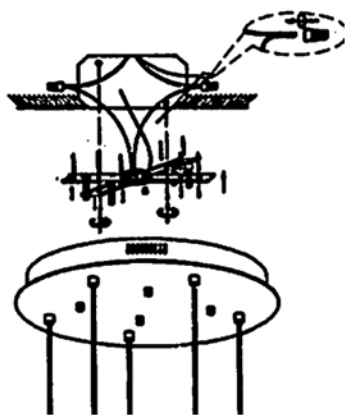

4.



5.

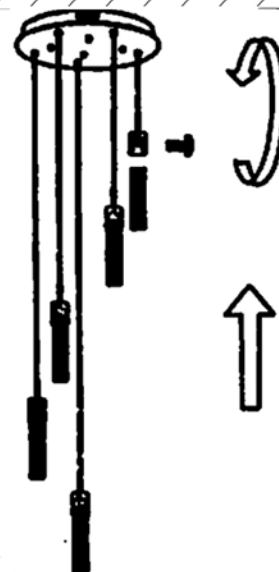

6.

3.