

E30010-11/E31010-11

ASSEMBLY INSTRUCTION:

Carefully remove all parts from the box and remove all plastic coverings.

- 1) Rotate the iron(C) which use to fix the glass from socket(A).
- 2) Put glass(B) into socket(A).
- 3) Connect iron(C) and socket(A) by provided spanner(D).
- 4) Install the bulb(120V,40W).
- 5) Use screw(I) to fix the ceiling iron(F) to the wall.
- 6) Use screw(O) to connect the light body and the ceiling iron(the iron already fixed on the wall).

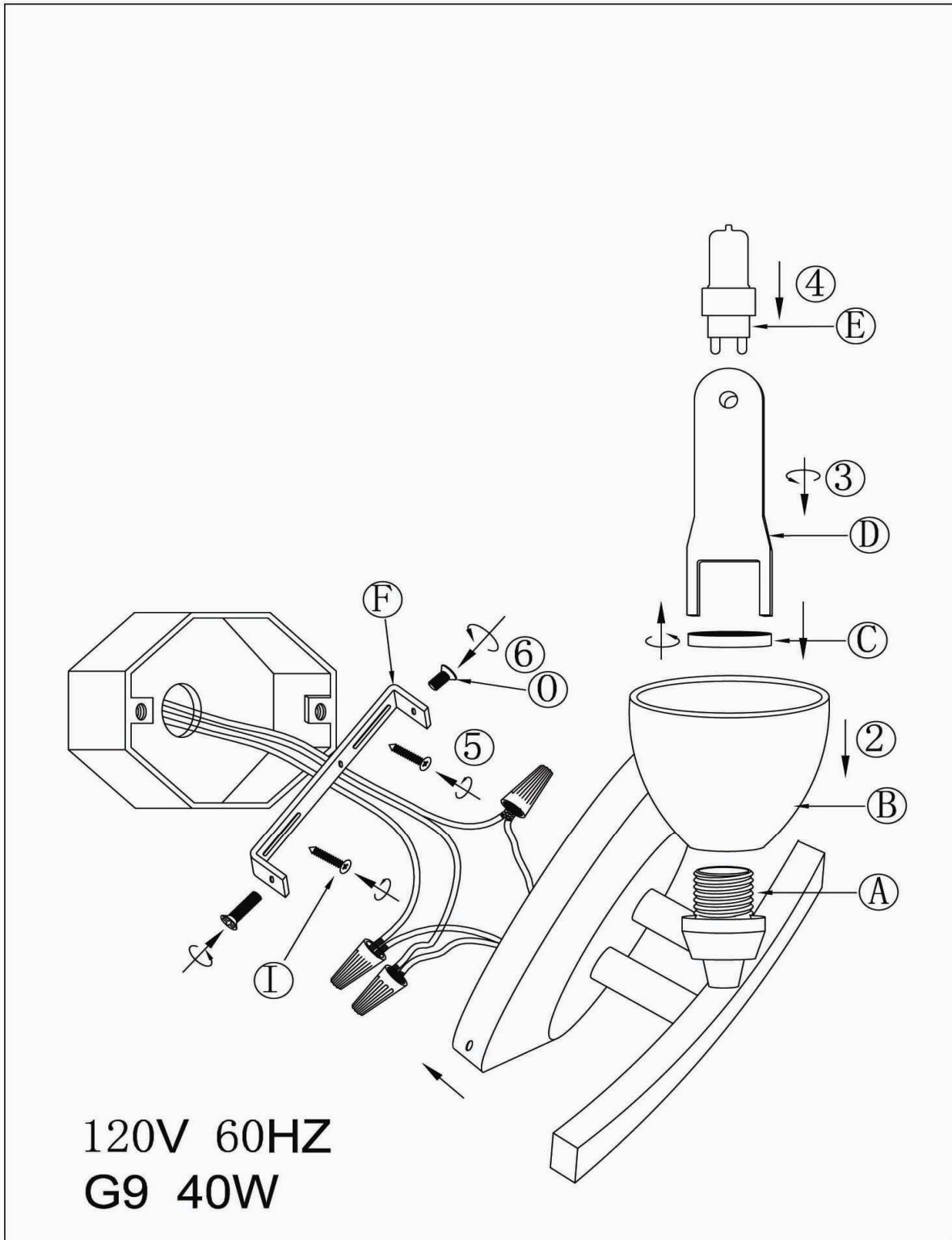

WARNING:

Do not use polishes or cleaners on your lamp.
WIPE CLEAN WITH SOFT DRY CLOTH.