

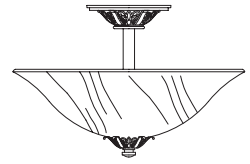

# assembly instructions

Family: Valencia | Item No. 4352 RB

▼ start here



### Drawing 1 - Strap Detail

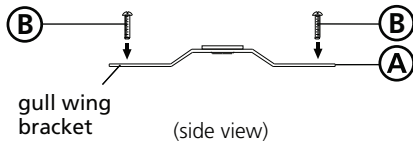

## Drawing 2 - Fixture Mounting

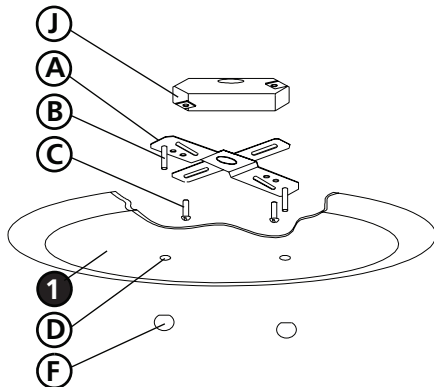

### Drawing 3 - Glass Installation

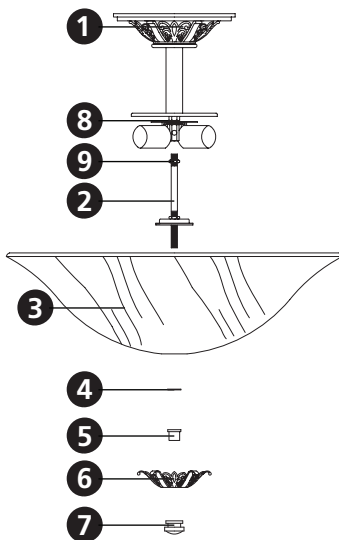

1

1. Find a clear area in which you can work.
2. Unpack fixture and glass from carton.
3. Carefully review instructions prior to assembly.

**\*\*\* The construction of this fixture will be accomplished by first assembling the main body of the fixture, mounting the mounting strap to the junction box, making all necessary electrical connections, hanging the fixture from the ceiling, and then installing the glass.**

2

1. To assemble fixture, thread nipple **(2)** into coupler **(8)**, located in the center of the socket assembly on ceiling pan **(1)**, approximately 3/8" - see **Drawing 3**.
2. Thread hex nut **(9)** up against coupler **(8)** to secure nipple **(2)**.

3

1. Prepare gem strap **(A)** for mounting by threading two screws **(B)** provided into back of gull wing bracket of gem strap **(A)** - see **Drawing 1**.
  - Be sure the holes into which the screws are threaded match the spacing of holes **(D)** in the ceiling pan **(1)** - see **Drawings 1 and 2**.
3. Mount gem strap **(A)** to junction box **(J)**, using the two 1" screws **(C)** provided.

**SAFETY WARNING: READ WIRING AND GROUNDING INSTRUCTIONS (I.S. 18) AND ANY ADDITIONAL DIRECTIONS. TURN POWER SUPPLY OFF DURING INSTALLATION. IF NEW WIRING IS REQUIRED, CONSULT A QUALIFIED ELECTRICIAN OR LOCAL AUTHORITIES FOR CODE REQUIREMENTS.**

4

Make electrical connections from supply wire to fixture lead wires. Refer to instruction sheet **(I.S. 18)** and follow all instructions to make all necessary wiring connections. Then refer back to this sheet to continue installation of this fixture.

5

1. Hang the fixture by slipping the holes **(D)** in the ceiling pan **(1)** over the screws **(B)** in the mounting strap **(A)** - see **Drawing 2**.
2. Thread on ball knobs **(F)** to secure fixture to the ceiling.

6

1. Before installing glass, fixture can now be lamped accordingly.
2. To install glass, slip glass **(3)** onto nipple **(2)** and hold it in position against the ceiling pan **(1)**.
3. Slip metal washer **(4)** onto nipple **(2)** and hold in position.
4. Thread spacer **(5)** onto nipple **(2)** and tighten up against metal washer **(4)** to secure glass.
5. Slip decorative cap **(6)** onto nipple **(2)** and hold in position.
6. Thread knob **(7)** onto end of nipple **(2)** and tighten.

Note: Maximum wattage for 4352 fixture is 75 watts per bulb.

**4352**

2.7.08