

Drawing 1 - Fixture Assembly

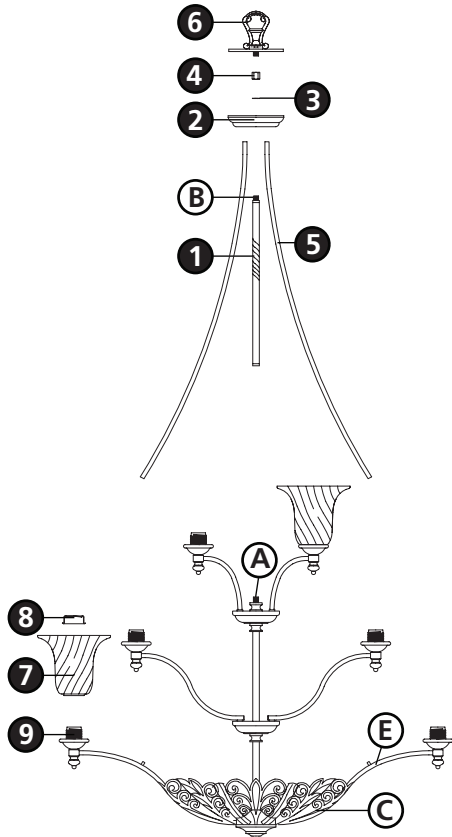

## ▼ start here

1

1. Find a clear area in which you can work.
2. Unpack fixture and glass from carton.
3. Carefully review instructions prior to assembly.

**\*\*\* The construction of this fixture will be accomplished by first assembling the main body of the fixture, making all necessary electrical connections, hanging the fixture from the ceiling, and then installing the glass.**

**SAFETY WARNING: READ WIRING AND GROUNDING INSTRUCTIONS (I.S. 18) AND ANY ADDITIONAL DIRECTIONS. TURN POWER SUPPLY OFF DURING INSTALLATION. IF NEW WIRING IS REQUIRED, CONSULT A QUALIFIED ELECTRICIAN OR LOCAL AUTHORITIES FOR CODE REQUIREMENTS.**

2

1. To assemble fixture, while holding wires tight, slip center stem (1) along wire and thread onto nipple (A).
2. Slip body (2) over nipple (B) on the end of center stem (1).
3. Slip lockwasher (3) over nipple (B) on the end of center stem (1).
4. Thread coupler (4) onto end of nipple (B) and tighten. Making sure square holes in body (2) line up with the arms (C) on the main fixture body (D).
5. Slip one end of upright (5) into square hole of body (3).
6. Slip other end of upright (5) over peg (E) located on top of arm (C).
7. Slip loop and cap (6) along wire and thread into coupler (4).
8. Please refer to the hanging instruction sheet (I.S. 19-50) provided to hang fixture. Then refer back to this sheet to install fixture glass.

3

1. To install glass, remove threaded socket ring (8) from socket (9).
2. Place glass (7) over exposed section of socket (9).
3. Place threaded socket ring (8) onto socket (9).
4. Repeat steps 1-3 for remaining glass.
5. Fixture can now be lamped accordingly.

Note: Maximum wattage for 4359 fixture is 40 watts per bulb.

2.7.08