

Family: Rosetti | Item No. 4525 VR

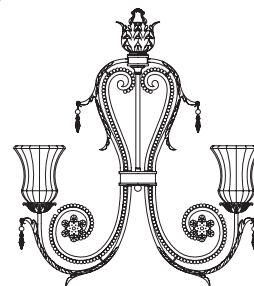

Drawing 1 - Glass Installation

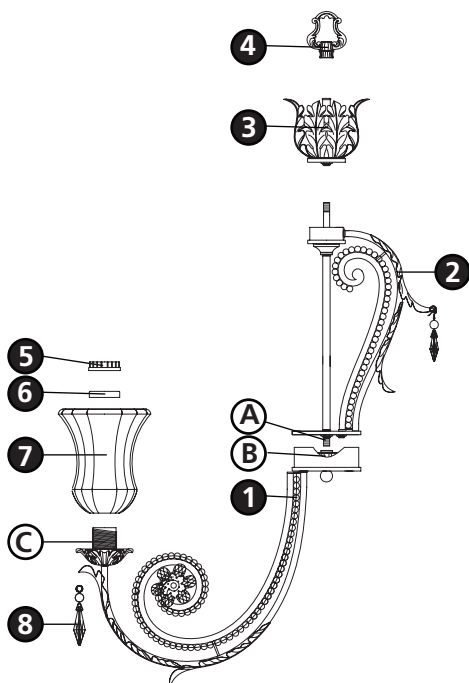

## ▼ start here

1

1. Find a clear area in which you can work.
2. Unpack fixture and glass from carton.
3. Carefully review instructions prior to assembly.

**\*\*\* The construction of this fixture will be accomplished by first assembling the main body of the fixture, installing the mounting hardware, making all necessary electrical connections, hanging the fixture from the ceiling, and then installing the glass.**

**SAFETY WARNING: READ WIRING AND GROUNDING INSTRUCTIONS (I.S. 18) AND ANY ADDITIONAL DIRECTIONS. TURN POWER SUPPLY OFF DURING INSTALLATION. IF NEW WIRING IS REQUIRED, CONSULT A QUALIFIED ELECTRICIAN OR LOCAL AUTHORITIES FOR CODE REQUIREMENTS.**

2

1. To assemble main body, slip center column (2) along wire and thread center stem (A) into coupler (B), located in the center body of arm assembly (1).
2. Slip leaf assembly (3) along wire and slip over center stem (A).
3. Slip loop (4) along wire and thread onto end of center stem (A) to complete assembly of center column.
4. Please refer to the hanging instruction sheet (I.S. 19) provided to hang fixture. Then refer back to this sheet to install glass.

3

1. To install glass, remove socket ring (5) and socket spacer (6) from socket (C).
2. Slip glass (7) over socket (C).
3. Slip spacer (6) and thread socket ring (5) to secure glass (7).
4. Hang crystal pendalogues (8) in areas indicated.
5. Repeat steps 1-3 for remaining glass.
6. Fixture can now be lamped accordingly.

Note: Maximum wattage for 4525 fixture is 60 watts per bulb.

2.7.08