

WIRING DIAGRAM AND ASSEMBLY

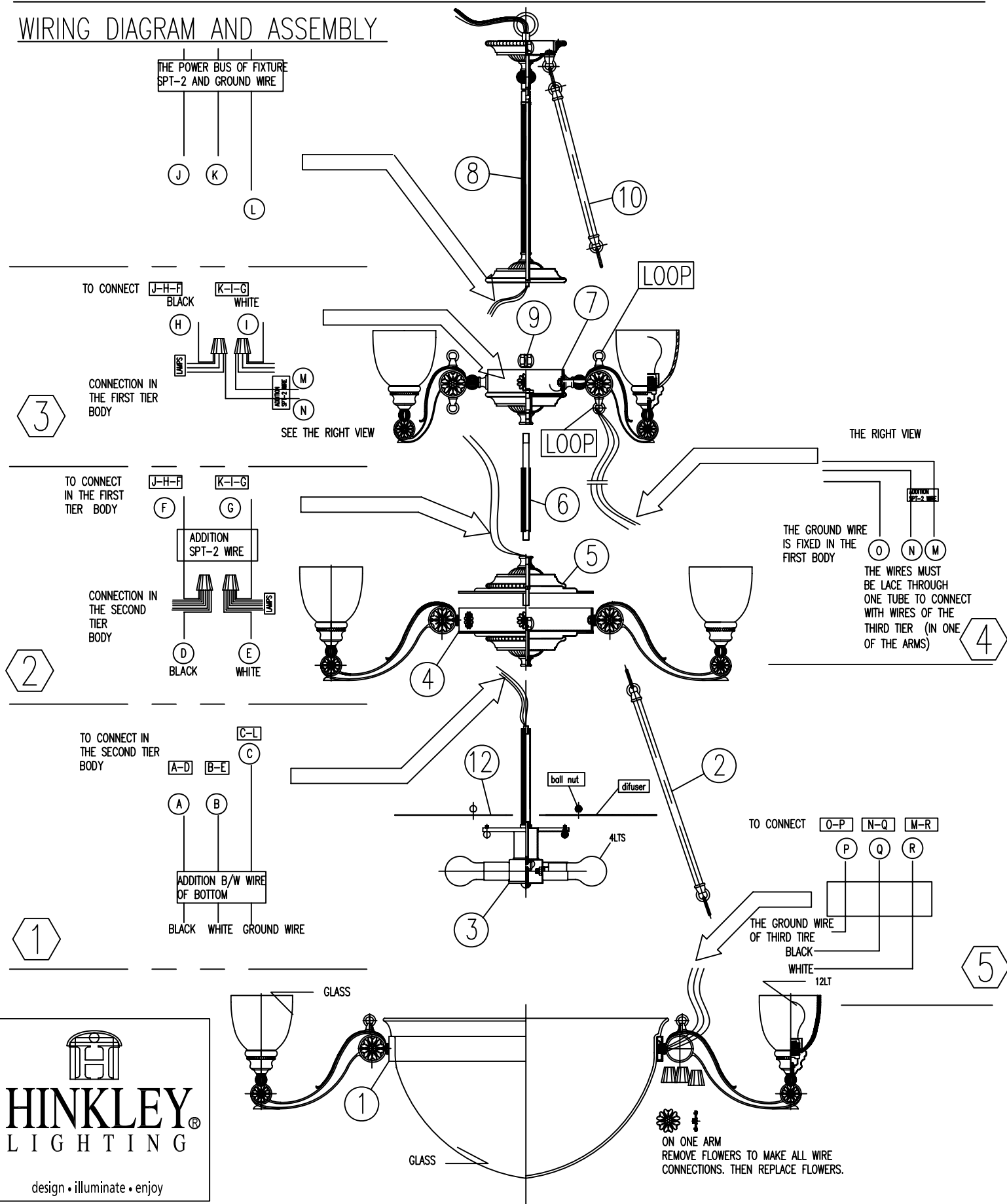

General assembly instructions

1. UNPACK LARGE 3RD TIER ASSEMBLY (1). ATTACH UPRIGHTS (2) TO ARMS WITH LOOPS, USING CHAIN LINKS PROVIDED.
2. BEGIN CENTER COLUMN ASSEMBLY BY THREADING SOCKET ASSEMBLY (3) INTO BOTTOM OF SECOND TIER BODY (4). MAKING SURE TO SLIP WIRE THROUGH SIDE AND OUT CENTER HOLE OF HICKEY.
(SEE SKETCH BELOW FOR DETAILS)
3. WIRE SECOND TIER PER WIRING DIAGRAM ON PAGE 1. THREAD JUMPER WIRES F&G THROUGH SIDE AND CENTER HOLE OF HICKEY.
PASS WIRES THROUGH CENTER OF BODY COVER (5) AND THREAD ONTO SECOND TIER BODY.
4. THREAD WIRES THROUGH STEM (6). THREAD STEM INTO TOP OF SECOND TIER BODY (4).
5. SLIP WIRE THROUGH CENTER HOLE OF TOP TIER (7) AND THREAD TOP TIER ONTO STEM.
6. TAKE COLUMN ASSEMBLY (8) AND TAKE APART. NOTE HOW ASSEMBLY IS PUT TOGETHER FOR LATER ASSEMBLY.
7. THREAD HICKEY (9) ONTO STEM INSIDE TOP TIER (7). THREAD CENTER STEM FROM COLUMN ASSEMBLY (8) INTO TOP OF HICKEY (9).
8. SLIP WIRE FROM HARDWARE PACKAGE THROUGH CENTER STEM, FROM COLUMN ASSEMBLY (8). WIRE SHOULD EXIT OUT SIDE OF HICKEY. FOLLOW WIRING INSTRUCTIONS ON PAGE 1.
9. RE-ASSEMBLY COLUMN ASSEMBLY (8).
10. ATTACH UPRIGHTS (10) TO TOP TIER ARMS WITH LOOPS, USING CHAIN LINKS PROVIDED.

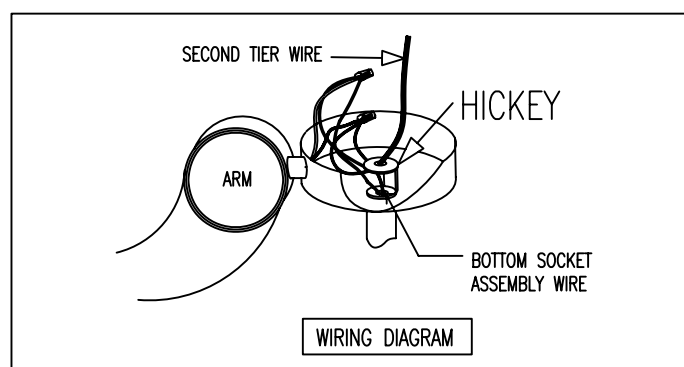

General assembly instructions

11. WITH POWER OFF HANG THE FIRST TWO TIERS OF THE FIXTURE. FOLLOW INSTRUCTIONS ON I.S. 195 INCLUDED IN CANOPY.
12. WITH POWER STILL OFF ATTACH TWO OF THE UPRIGHTS (2) FROM THE BOTTOM TIER, TO LOOPS ON THE BOTTOM OF THE ARMS OF THE TOP TIER (7).
13. SLIP GLASS INTO RING AND ATTACH LAST REMAINING UPRIGHT TO LOOP.
14. SLIP WIRE FROM TOP TIER (8) THROUGH UPRIGHT FROM BOTTOM TIER (2).
15. FOLLOW WIRING INSTRUCTIONS ON PAGE 1.
16. ATTACH BULB DIFUSER (12) USING BALL NUTS PROVIDED.
17. ATTACH GLASS TO FIXTURE USING RETAINING RINGS.
18. FIXTURE IS READY FOR LAMPING.



Hanging instructions for fixtures that weight more than 50lbs

Drawing 1 - Fixture Assembly

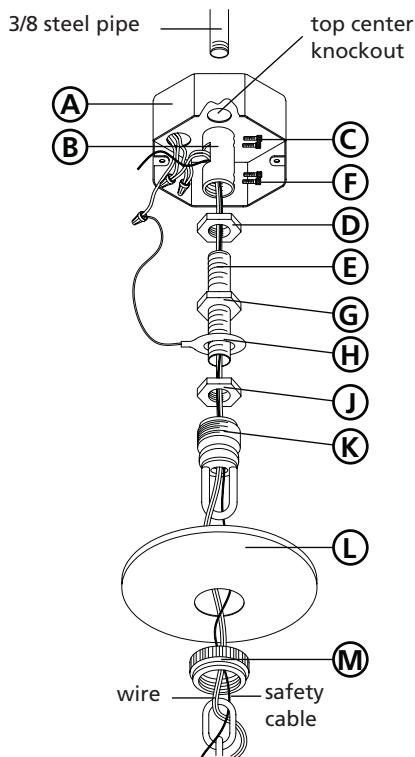

Drawing 2 - Installation Example

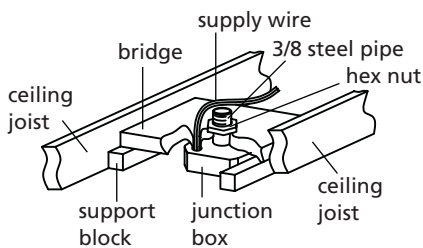

▼ start here

1

1. Shut off electrical current before starting. If the fixture you are replacing is turned on and off by a wall switch, simply turn the switch off. If not, remove the appropriate fuse (or open the circuit breakers) until the fixture is dead.

• **DO NOT RESTORE CURRENT - EITHER BY FUSE, BREAKER, OR SWITCH - UNTIL THE NEW FIXTURE IS COMPLETELY WIRED AND IN PLACE.**

2. Supply wires shall enter the outlet box (A) through any knockout EXCEPT the top center knockout - see **Drawing 1**.

2

1. Fixture is to be mounted by a 3/8 steel pipe with 3/8 -18 NPSM thread, 3/4" threads at both ends (not supplied). Pipe should be anchored to structure or bridging member with sufficient strength to support 4 times the fixtures weight - see **Drawing 2**.

2. Adjust pipe so 1/2" of 3/8 steel pipe extends into the junction box, at the center knockout.

3. Please refer to the back of this sheet to the **safety cable installation** instructions and **ONLY** complete steps 1 and 2 at this time.

3

1. Thread pipe coupler (B) onto protruding pipe inside outlet box. Secure in place by tightening allen head screw (C) - see **Drawing 1**.

2. Thread hexnut (D) onto threaded nipple (E). Thread nipple (E) into coupler (B). Secure in place by tightening hexnut (D) against coupler (B) and then tightening allen screw (F).

3. Thread hexnut (G) onto nipple (E). Slip ground wire loop (H) over nipple (E) and thread hexnut (J) onto nipple (E). DO NOT tighten hexnuts (F) and (H) at this time.

4. Thread screw collar loop (K). Adjust loop height so the half of the exterior thread on screw collar loop (K) is exposed when canopy (L) is held up to the ceiling.

4

1. Determine length of chain you will require. Attach one end of length of chain to fixture.

2. Slip threaded ring (M) and canopy (L) onto chain - see **Drawing 1**.

3. Attach fixture with chain to screw collar loop (K). Please get assistance, weight and size of fixture is difficult to manage alone.

4. Weave ground wire, supply wire, and safety cable through chain, up through center of screw collar loop (K), through center of nipple (E), and out the opening on the side of coupler (B).

5. Please refer back to safety cable installation instructions on the back of this sheet and complete steps 3 and 4.

safety cable installation

WARNING: TO AVOID ELECTRICAL SHOCK, THIS SECTION OF THE INSTRUCTION SHEET IS FOR THE SOLE PURPOSE OF SAFETY CABLE INSTALLATION, AND IS NOT TO BE USED TO MAKE ANY ELECTRICAL CONNECTIONS.

- The safety cable must be attached to a ceiling joist or other permanent structure independent of the junction box
1. Using a 1/8" dia., drill a pilot hole **(1)**. It must be drilled into the permanent structure or through the junction box on joist side where the safety cable is to be attached - see **Drawing 3**.
 2. Insert and thread a 1/4" hex head lag screw **(2)** (not included) into pilot hole.
 3. Continue back to step 6 above to continue installation of this fixture.
 4. Wrap safety cable **(3)** around hex head lag screw **(2)** and tighten to secure cable - see **Drawing 3**.

SAFETY WARNING: READ WIRING AND GROUNDING INSTRUCTIONS (I.S. 18) AND ANY ADDITIONAL DIRECTIONS. TURN POWER SUPPLY OFF DURING INSTALLATION. IF NEW WIRING IS REQUIRED, CONSULT A QUALIFIED ELECTRICIAN OR LOCAL AUTHORITIES FOR CODE REQUIREMENTS.

Make electrical connections from supply wire to fixture lead wires. Refer to instruction sheet **(I.S. 18)** and follow all instructions to make all necessary wiring connections.

Drawing 3 - Safety Cable Installation

