

# ASSEMBLING & INSTALLATION INSTRUCTIONS PRODUCT# 1361 1362 1363 1364 1365 For Wall Mount Fixture

**WARNING! SHUT POWER OFF AT FUSE OR CIRCUIT BREAKER .**

## MOUNTING THE FIXTURE

### Installation (see fig.1)

1. Disconnect power at main electrical panel before installation.
2. Attach the mounting plate to the junction box using two junction box screws. The side of the mounting plate marked "GND" must face out.
3. Guide fixture wires through hole in center of mounting plate.
4. Follow wiring instructions carefully (see fig.2)
5. Place the fixture body (F) over the mounting plate, aligning the backplane holes with screw hole of the mounting plate in side, then lock it securely with mounting screws.
6. Raise the glass shade(E) and collar ring(D) onto the lamp holder, attach the check ring(C) insert to the bottom hole of socket wrench(B), lock them securely with socket wrench. **NOTE: remove the socket wrench and save it.**
7. **Install the light bulbs in accordance with the fixture's specifications ( "A", THE LIGHT BULB WITH A CLEAN COTTON CLOTH TO WRAP THE GLASS SHELL). DO NOT EXCEED THE MAXIMUM WATTAGE RATING!**

### Wiring (see fig.2)

1. Connect the electrical wires as follows. Connect the Black wire from the fixture to the black house (hot) Wire. Connect the white wire from the fixture to the white (neutral) house wire. Make sure all wire nuts are secured. You may wrap the connections with electrical tape. If your outlet box has a ground wire (green or bare copper) connect fixture's ground wire to it. Otherwise attach the bare copper fixture wire to the green ground screw on the mounting plate.
2. Tuck the wire connections neatly into the wall junction box.

**Fig.1**

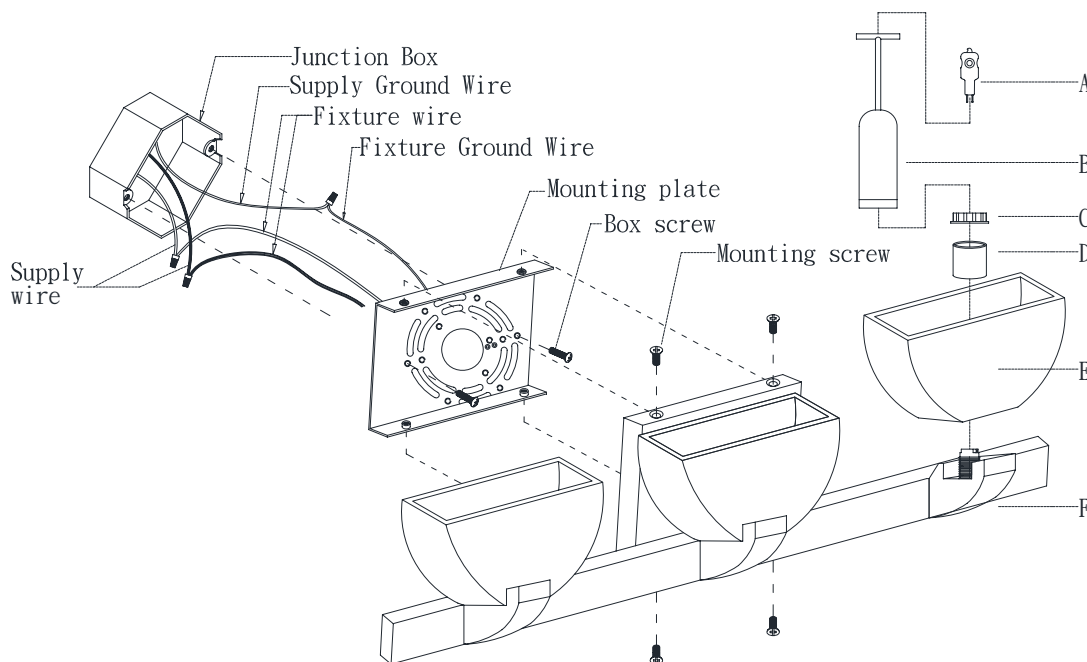

**Fig.2**

<b>FIXTURE WIRES</b> Black or Smooth		<b>FIXTURE WIRES</b> White or Ribbed		<b>FIXTURE WIRES</b> Bare Copper (Ground)	
<b>HOUSE WIRES</b> Black (Hot)		<b>HOUSE WIRES</b> White (Neutral)		<b>HOUSE WIRES</b> Green or Bare Copper (Ground)	

**LIVEX<sup>®</sup>**  
**LIGHTING**