

# Assembly Instructions For **F2308/6, F2310/8+4** (E) 10/07

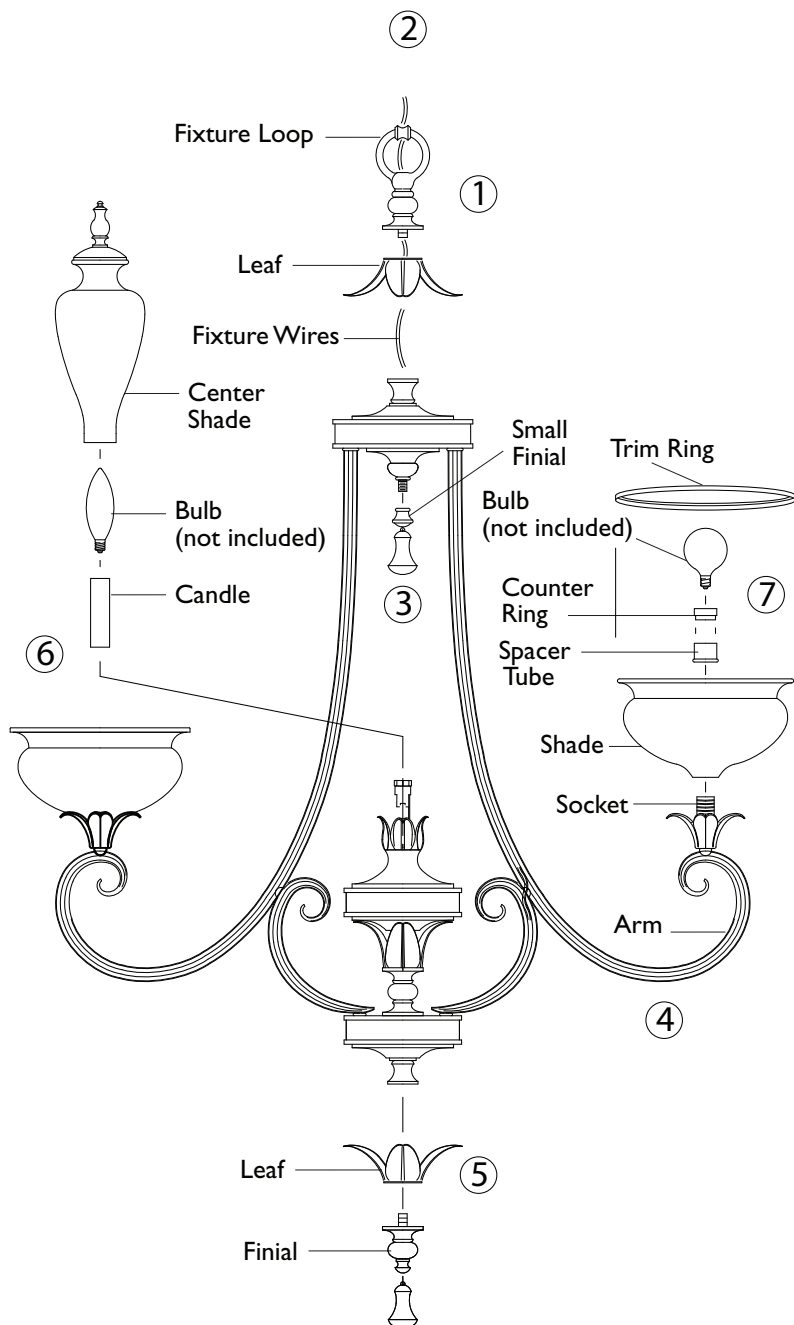

## **IMPORTANT TURN OFF THE POWER AT THE MAIN FUSE OR CIRCUIT BREAKER BOX BEFORE STARTING INSTALLATION**

Carefully unpack and identify all parts before assembly.  
Bulb not included.

1. A. Slip leaf and fixture loop through fixture wires.  
B. Place leaf on top of fixture. And secure by fastening with fixture loop.
2. Follow enclosed supplement installation instructions for electrical and fixture installation onto house outlet box. If you do not have an outlet box at desired location to attach the fixture than hire a qualified electrician to create one.
3. Install small finial by carefully screwing onto upper inside of fixture. See illustration for correct location.
4. Spread open all arms so that they are equally spaced apart from each other.
5. Slip leaf onto finial. Then install finial by carefully screwing onto bottom of fixture.
6. A. Slip candle tube onto center socket.  
B. Install bulb (type-B candelabra base of 25 Watt maximum / not included) by screwing into socket.  
C. Install center shade by fitting spring clip into inside opening of shade.
7. A. Install shade onto socket located at arms. Secure shade by slipping spacer tube and tightening with counter ring. Note: The bent rim of spacer tube must face shade.  
B. Install bulb (type-G 16-1/2 candelabra base of 60 Watt maximum / not included) by screwing into sockets.  
C. Place trim ring on top of shades.

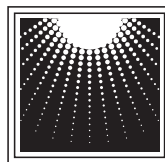

**MURRAY  
FEISS**

Generation Brands™