

Assembly Instructions For

F2341/3

(E) 5/09

	1	2	3	4	5
			5 bead 		17 bead
Required	x 1	x 3	x 1	x 6	x 3
Extra		1	1	2	1

Extra PIN Qty.	PIN PART	PIN DESCRIPTION
4		S Hook
8		Small Bead Hook

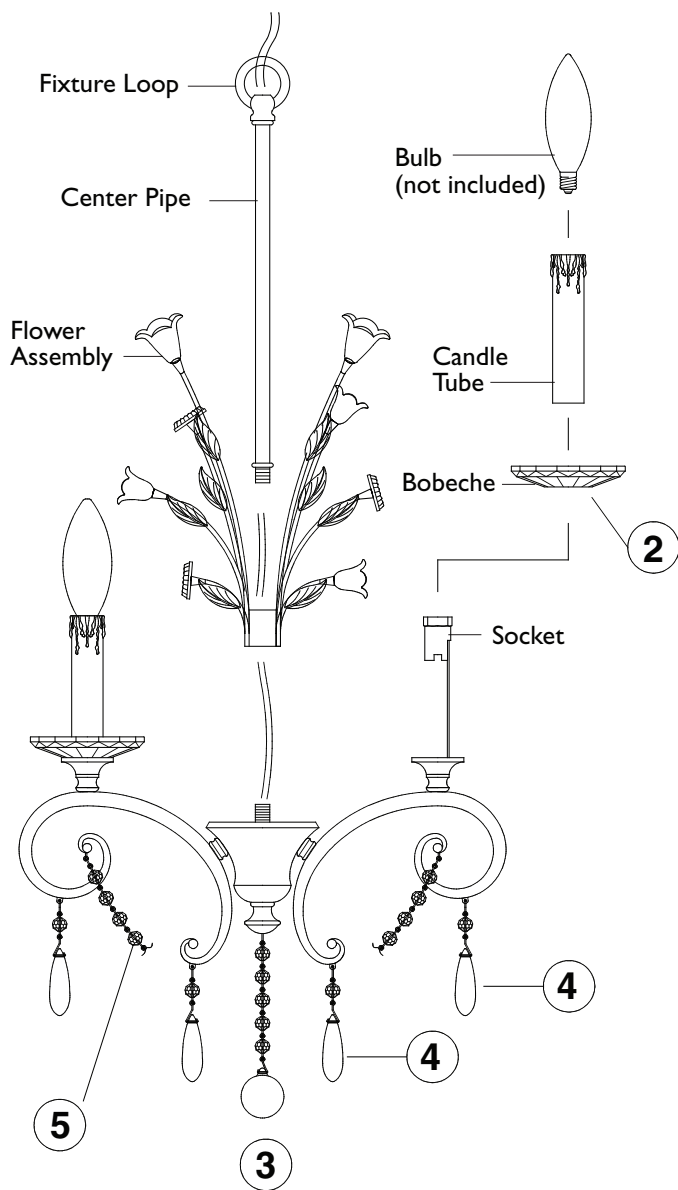
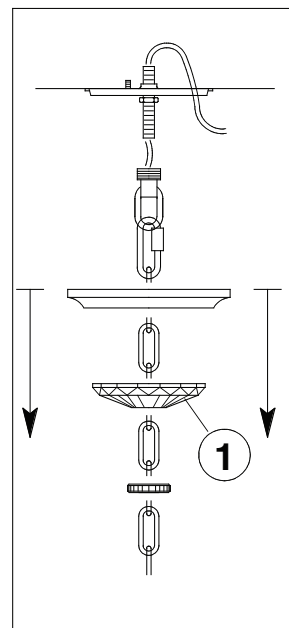

IMPORTANT TURN OFF THE POWER AT THE MAIN FUSE OR CIRCUIT BREAKER BOX BEFORE STARTING INSTALLATION

Carefully unpack and identify all parts before assembly. Bulbs not included.

1. A. Gently slip flower assembly through fixture wires and then secure by screwing onto top of fixture.
B. Slip center pipe through fixture wires and then secure by screwing onto top of flower assembly.
2. Follow enclosed supplement installation instructions for electrical and fixture installation onto house outlet box. If you do not have an outlet box at desired location to attach the fixture then hire a qualified electrician to create one.
IMPORTANT: WHEN FOLLOWING SUPPLEMENT INSTRUCTIONS STEP #6, MAKE CERTAIN TO SLIDE CRYSTAL BOBECHES (IN BETWEEN COLLAR RING AND CANOPY) DOWN THE CHAIN. See above illustration.
3. A. Install crystal bobeches by slipping through sockets.
B. Install candle tube by slipping through sockets.
C. Install type-B, candelabra base, of 60 Watt maximum bulbs (not included).
4. Hang all crystal glass parts as shown on drawing.
NOTE: To replace broken crystal or pin, extras are included in hardware bag. Replace by gently bending open pin, remove broken crystal or pin, hook new one, then close back pin. Avoid bending pin into sharp angle.

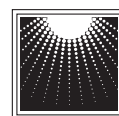

**MURRAY
FEISS**
Generation Brands™