

Assembly Instructions For

F2590/6 (E) 5/10

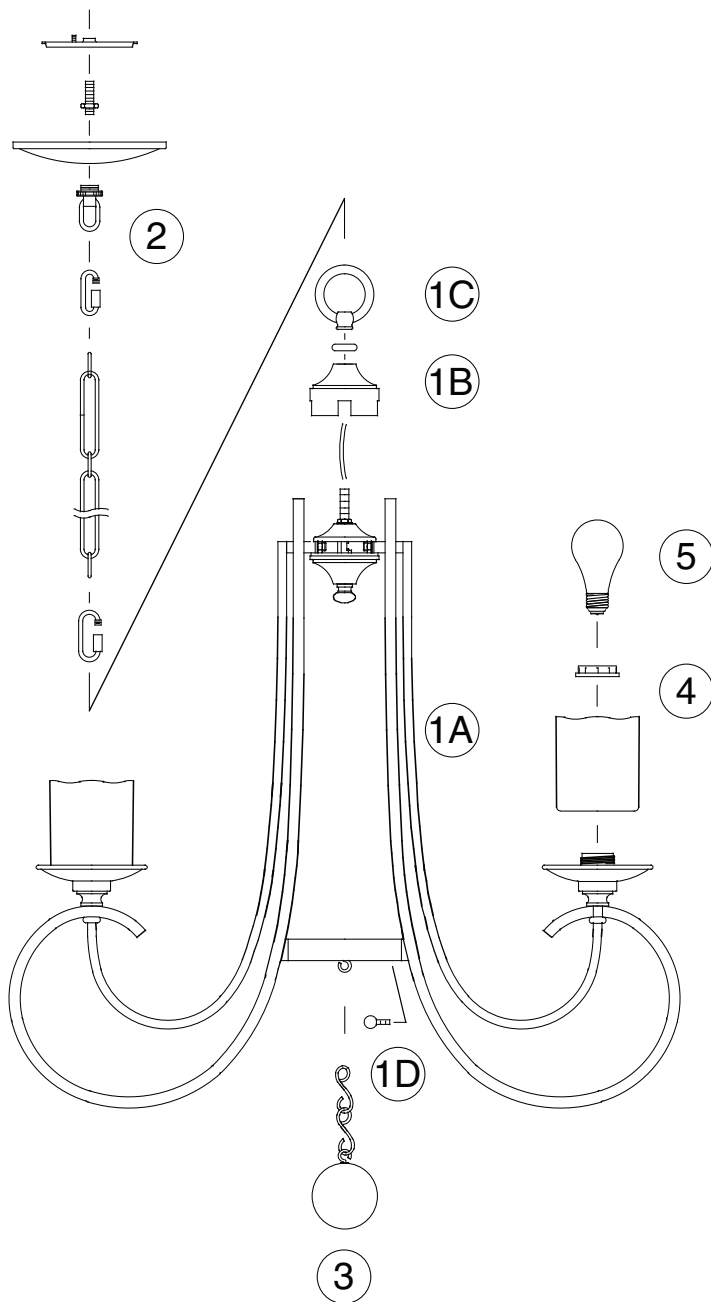

IMPORTANT

TURN OFF THE POWER AT THE MAIN FUSE OR CIRCUIT BREAKER BOX BEFORE STARTING INSTALLATION

Carefully unpack and identify all parts before assembly. Bulbs not included.

1. A. Turn arms so they are equally spaced apart from each other.
B. Install notched cover, making certain it's notches are locked onto arms, by fastening with round nut.
C. Slip fixture loop and then screw onto protruding threaded pipe.
D. Lock arms onto ring by fastening with cap screws.
2. Follow enclosed supplement installation instructions for electrical and fixture installation onto house outlet box. If you do not have an outlet box at desired location to attach the fixture then hire a qualified electrician to create one.
3. Install ball by hooking onto bottom of ring.
4. Install shade by fastening with counter ring.
5. Install light bulb (not included). See relamping label at socket area for type and maximum allowed wattage.

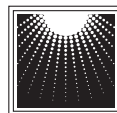

MURRAY
FEISS

GENERATION
BRANDS™