

Assembly Instructions For **F2637/4** (E) 12/10

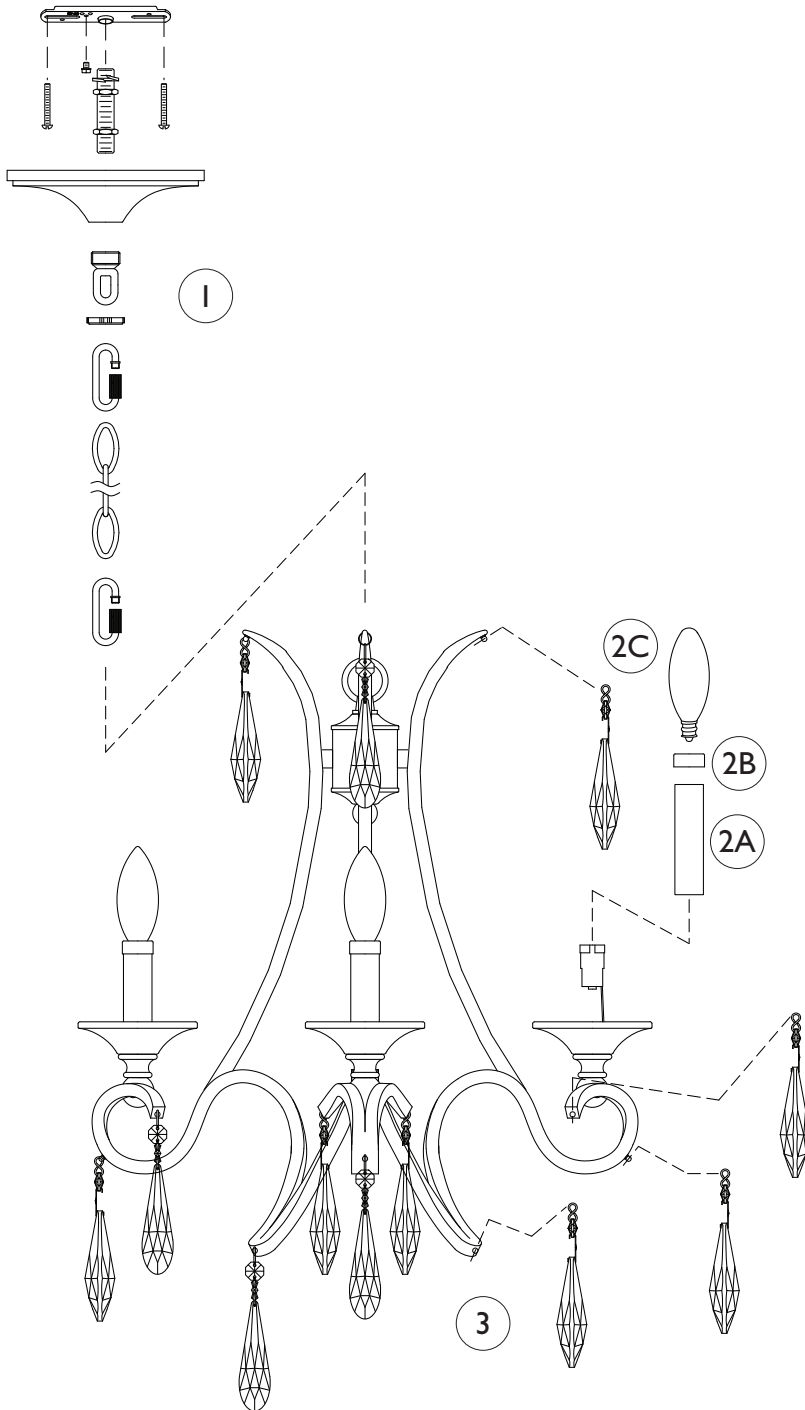

IMPORTANT
TURN OFF THE POWER AT THE MAIN FUSE
OR CIRCUIT BREAKER BOX
BEFORE STARTING INSTALLATION

Carefully unpack and identify all parts before assembly. Bulbs not included.

1. Follow enclosed supplement installation instructions for electrical and fixture installation onto house outlet box. If you do not have an outlet box at desired location to attach the fixture then hire a qualified electrician to create one.
2. A. Install candle tube by slipping through sockets.
B. Slip candle follower on top of candle tubes.
C. Install type-B, candelabra base, of 60 Watt maximum bulbs (not included).
3. Hang all crystal glass parts as shown on diagram.
NOTE: To replace broken crystal or pin, extras are included in hardware bag. Replace by gently bending open pin, remove broken crystal or pin, hook new one, then close back pin. Avoid bending pin into sharp angle.

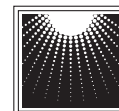

MURRAY
FEISS

GENERATION
BRANDS™