

Assembly Instructions For

OL8013 (E) 1/11

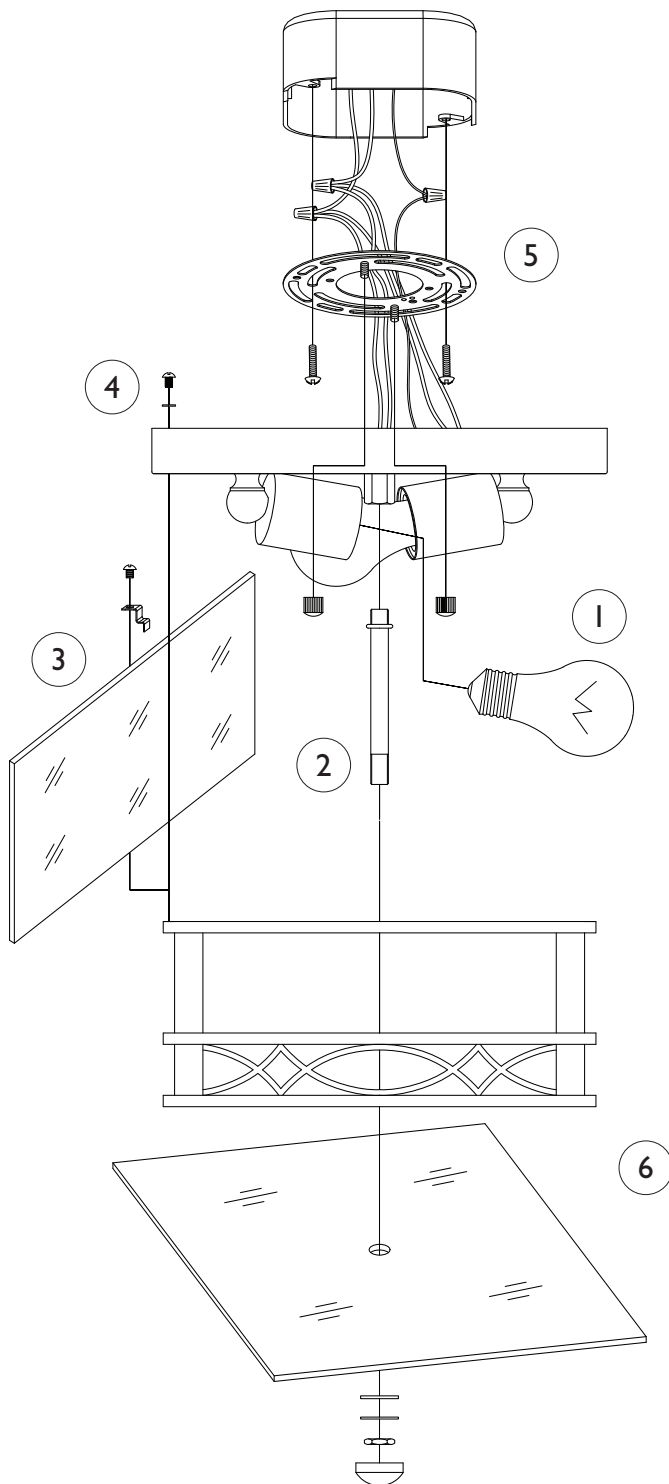

IMPORTANT TURN OFF THE POWER AT THE MAIN FUSE OR CIRCUIT BREAKER BOX BEFORE STARTING INSTALLATION

Carefully unpack and identify all parts before assembly.
Bulbs not included.

1. Install bulb (not included). See relamping label located at socket area for type and maximum allowed wattage.
2. Install long threaded pipe by screwing into bottom of coupler. Note correct position of center pipe at illustration.
3. Install glass panels onto main frame with tabs and screws as shown.
4. Install the main frame to the ceiling pan and secure with screws.
5. Follow enclosed supplement installation instructions for electrical and fixture installation onto house outlet box. If you do not have an outlet box at desired location to attach the fixture then hire a qualified electrician to create one.
6. Slip bottom glass through long threaded pipe until it checks inside of main frame. Then slip cover and lock into position by fastening with finial. Do not over tighten.

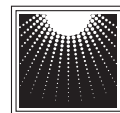

**MURRAY
FEISS**

GENERATION
BRANDS™