

Assembly Instructions For

OLPL10207

(E) 11/09

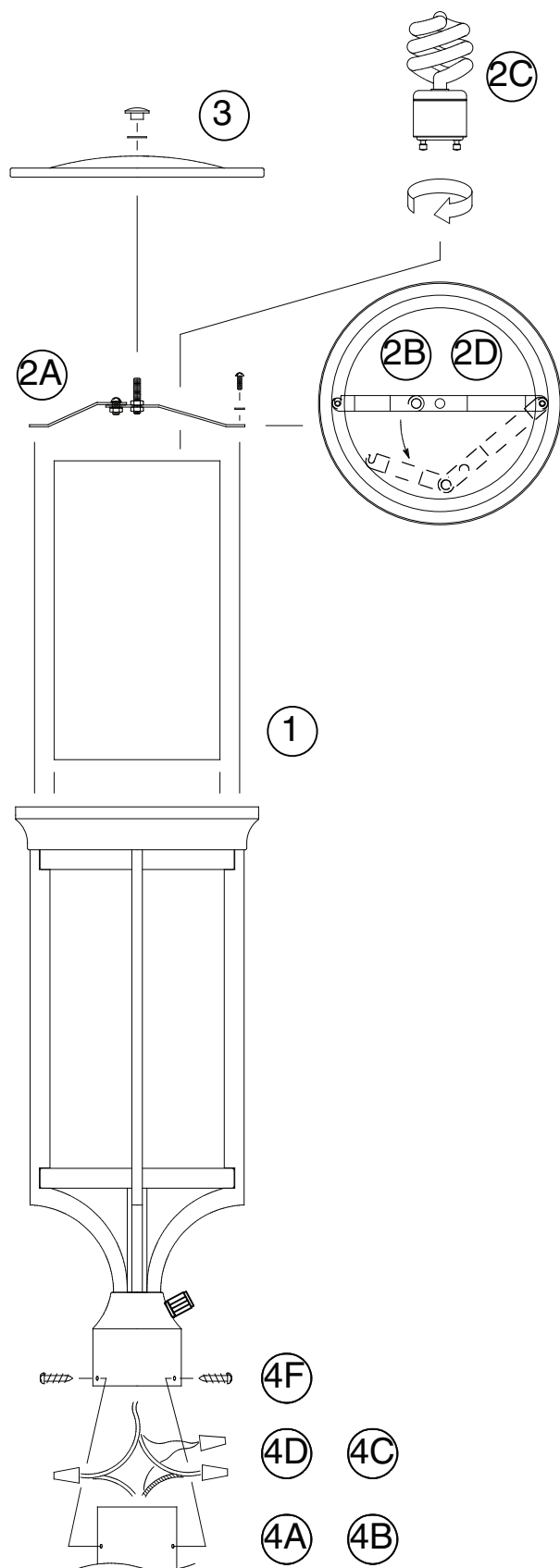

IMPORTANT

TURN OFF THE POWER AT THE MAIN FUSE OR CIRCUIT BREAKER BOX BEFORE STARTING INSTALLATION

Carefully unpack and identify all parts before assembly.

1. Gently slip shade inside of lantern until it securely sits inside of bottom ring.
2. A. Install bridge onto top of lantern by fastening with lock washer and short machine screw.
B. Swing the bridge aside.
C. Install compact fluorescent lamp by inserting into slots in socket base, and then twist and lock. See illustration.
D. Swing back the bridge until it hooks onto screw.
3. Install cover on top of lantern by fastening with rubber washer and finial.
4. Electrical installation onto post: If you are replacing an existing fixture, disconnect and remove the old fixture.

A) Slip post cup over post. Mark position of holes in post cup on post.

B) Remove post cup and expose the supply wiring from above post. Drill 1/8" (3mm) diameter pilot holes in post at places where marked.

C) Connect white fixture wire to white supply wire from post with wire connector. Connect black fixture wire to black supply wire from post with wire connector.

NOTE: Black wire from post may be red, round and smooth and/or have copper conductor. White wire from post may be square and ridged and/or have a silver conductor.

D) Connect fixture ground wire (without plastic insulation) to ground wire from post (usually with green insulation) with wire connector.

IMPORTANT: Never connect ground wire to black or white supply wires.

E) Tuck all wires inside of post.

F) Slip post cup onto post. Align holes in post cup with holes in post. Secure them together by fastening with sheet metal screws (enclosed).

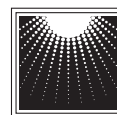
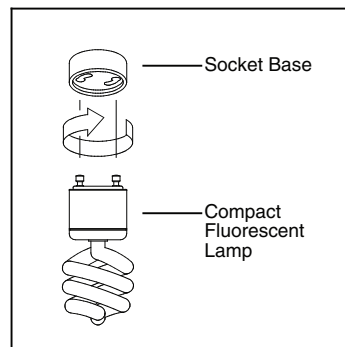

**MURRAY
FEISS**

GENERATION
BRANDS™