

ASSEMBLY INSTRUCTIONS FOR OLPL5001, OLPL5002, OLPL5003 (E) 4/27/06

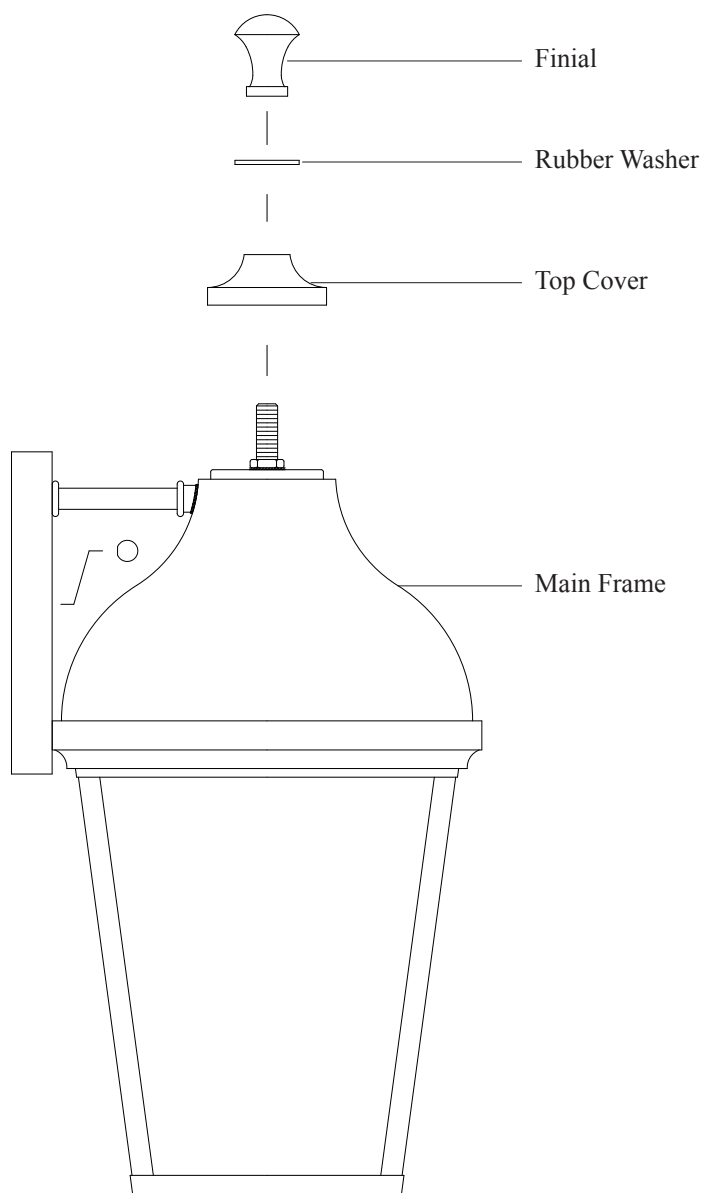

IMPORTANT
TURN OFF THE POWER AT THE
MAIN FUSE OR CIRCUIT BREAKER
BOX BEFORE STARTING INSTALLATION

Carefully unpack and identify all parts before beginning assembly.

1. Slide top cover thru center pipe till checks onto main frame. Lock them into position with rubber washer and finial.
2. Install lamp by pushing into socket. Do not twist.
3. Follow enclosed “**Standard Outdoor Mounting plate installation Instructions**” for electrical and fixture installation onto wall outlet box.

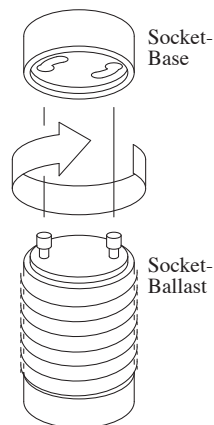

TO REPLACE DEFECTIVE SOCKET-BALLAST:

1. Remove old defective socket-ballast by unscrewing from socket-base.
2. Install new socket-ballast by inserting into slots in socket-base, and then twist and lock.

