

# Assembly Instructions For

# SF274

(E) 10/09

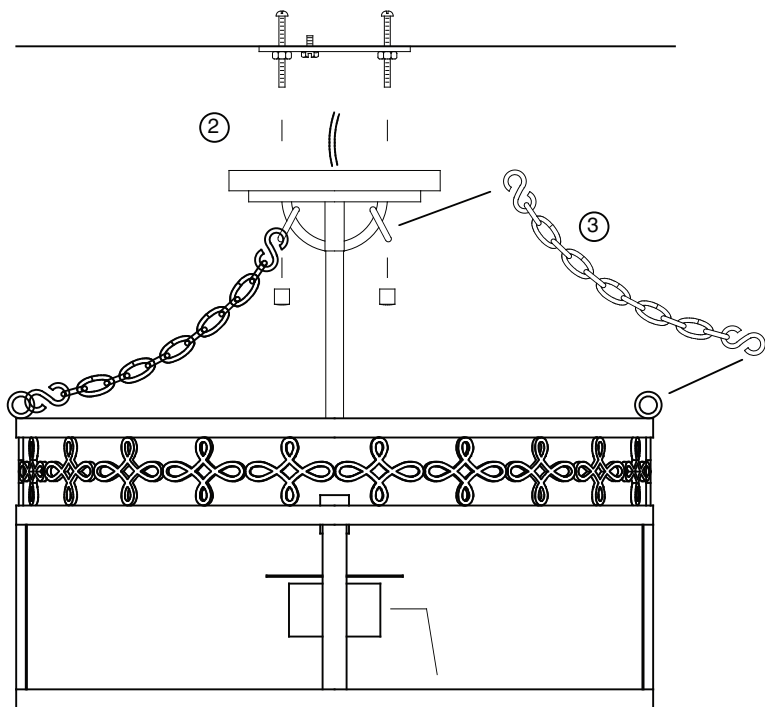
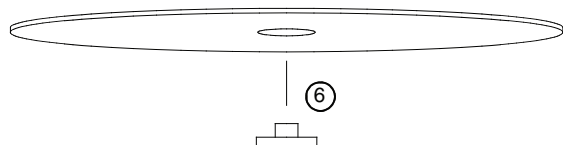
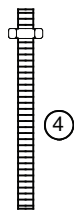
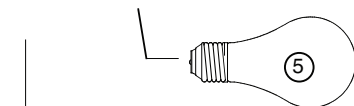
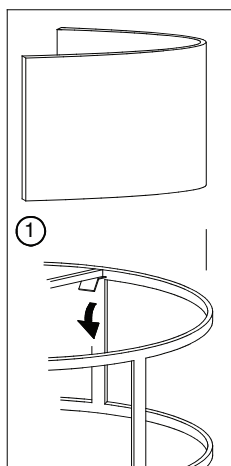

Fig. 1



## IMPORTANT TURN OFF THE POWER AT THE MAIN FUSE OR CIRCUIT BREAKER BOX BEFORE STARTING INSTALLATION

Carefully unpack and identify all parts before assembly. Bulbs not included.

1. Install glass panels: (see fig.1)
  - A. Gently grabbing onto a glass panel, slip inside of main frame. Make certain bottom edge of panel sits inside of bottom tabs.
  - B. Secure glass panel by bending tabs located at top.
  - C. Repeat rest panels.
2. Follow enclosed supplement installation instructions for electrical and fixture installation onto house outlet box. If you do not have an outlet box at desired location to attach the fixture then hire a qualified electrician to create one.
3. Hook decorative chains first onto the column and then proceed to hook onto loops located on top of main frame.
4. Install a hex nut onto one end of long threaded pipe leaving about 3/8" (10 mm) thread exposed. Screw same end of threaded pipe into bottom of socket assembly. Tighten hex nut.
5. Install light bulb (not included). See relamping label at socket area for type and maximum allowed wattage.
6. Slip glass plate through long threaded pipe until it checks inside of main frame. Lock glass plate by fastening with finial. Do not over tighten.

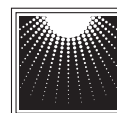

**MURRAY  
FEISS**

GENERATION  
BRANDS™