

# Assembly Instructions For

# VS19003 (E) 4/11

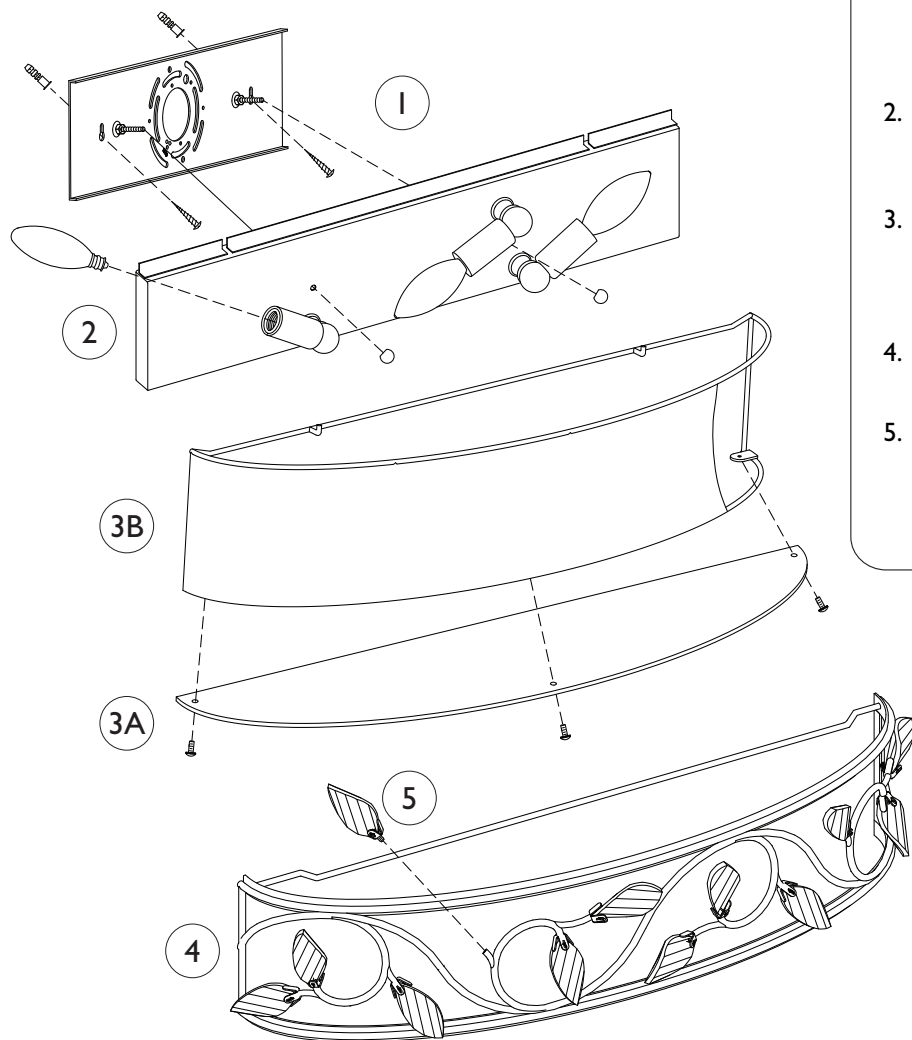
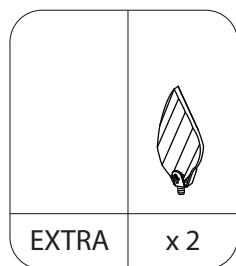

## IMPORTANT

### TURN OFF THE POWER AT THE MAIN FUSE OR CIRCUIT BREAKER BOX BEFORE STARTING INSTALLATION

Carefully unpack and identify all parts before assembly. Bulb not included.

1. Follow enclosed supplement installation instructions for electrical and fixture installation onto house outlet box. If you do not have an outlet box at desired location to attach the fixture then hire a qualified electrician to create one.
2. Install light bulb (not included). See relamping label at socket area for type and maximum allowed wattage.
3. A. Install the glass plate onto the bottom of the shade with the provided screws.  
B. Hook the shade onto the top of the fixture plate as shown.
4. Install the metal frame onto the shade and secure by hooking the frame onto the fixture plate.
5. Install all crystal glass parts as shown on drawing.  
NOTE: To replace broken crystal, extras are included in hardware bag.

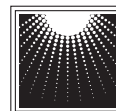

**MURRAY  
FEISS**

GENERATION  
BRANDS™ 