

Assembly Instructions For

WB1347 (E) 10/07

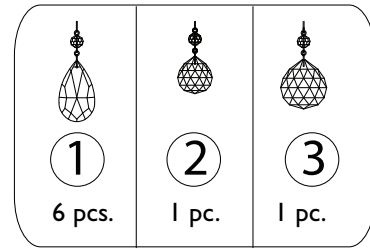
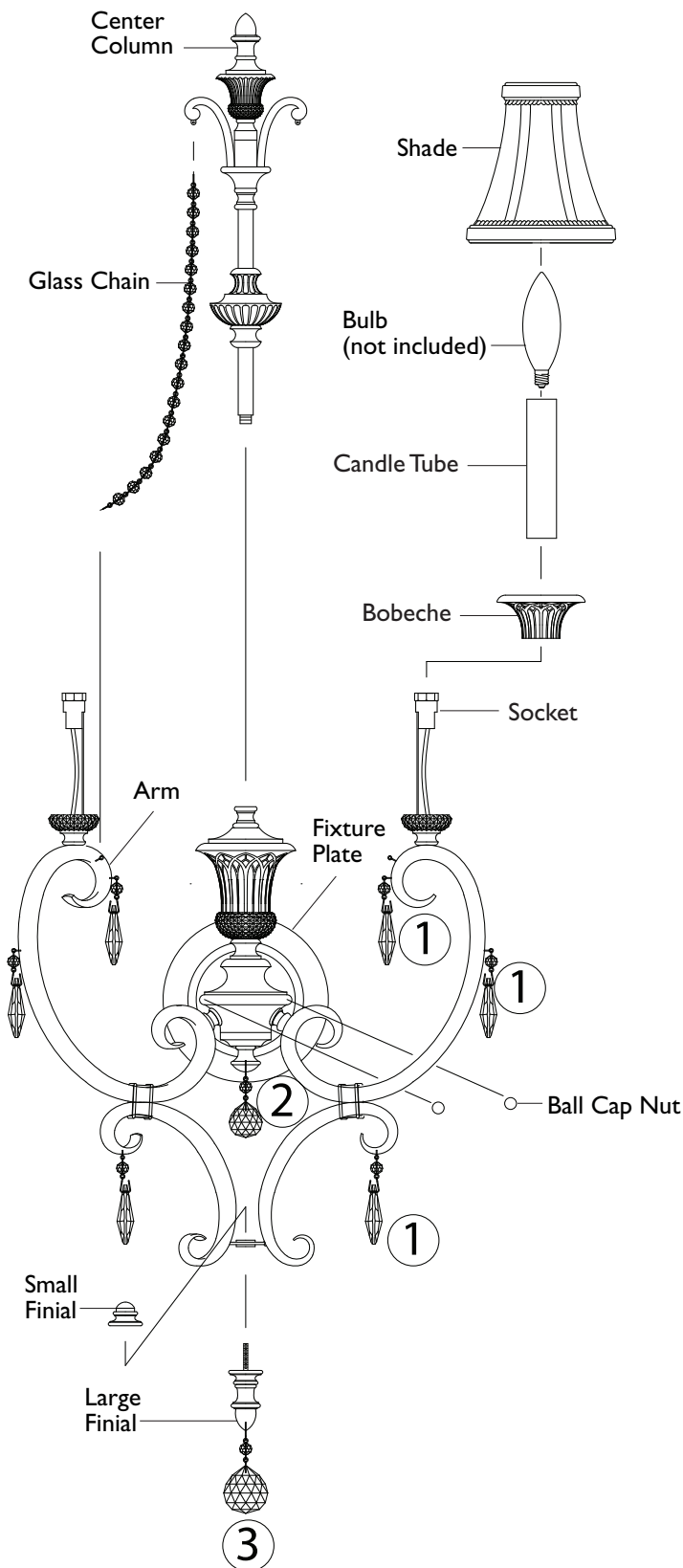

IMPORTANT

TURN OFF THE POWER AT THE MAIN FUSE OR

CIRCUIT BREAKER BOX

BEFORE STARTING INSTALLATION

Carefully unpack and identify all parts before assembly. Bulb not included.

1. Install center column by screwing onto top of fixture. Make certain the two curls are located parallel against the wall.
2. Insert large finial into center plate from below. Secure by fastening small finial from above.
3. Follow enclosed supplement installation instructions for electrical and fixture installation onto house outlet box. If you do not have an outlet box at desired location to attach the fixture than hire a qualified electrician to create one.
4. Slip bobèche and candle tube onto sockets.
5. Install bulb (not included). See relamping label located near socket area for type and maximum allowed wattage.
6. Install shade onto bulbs.
7. Install glass chain by hooking onto curl located at center column and then other end onto curl located at arm. Repeat other side.
8. Hang all crystal glass parts as shown on drawing. NOTE: To replace broken crystals extras are included in hardware bag. Replace by gently bending open pin, remove broken crystal, hook new one, then close back pin. Avoid bending pin into sharp angle.

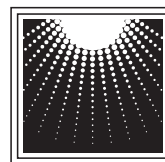

MURRAY
FEISS

Generation Brands™